



Door Closer

ASSA ABLOY

The global leader in
door opening solutions

ASSA ABLOY Door Closers

Features & Benefits

Door Closer

Key features:

- Non-handed system
- 5,00,000 cycles tested
- Fire rated

Benefits:

- Versatile usage
- High durability
- Suitable for fire doors

Standard & Certification

EN1154
EN1155
CE Marked

Technical details:

- Adjustable power size
- Suitable for wood, glass, metal and fire rated doors
- Available finishes - Silver EV1, White, customize finish available on request
- Additional accessories: Smoke detector, fire alarm, fire indication

Closer Selection Chart:

Door width (mm)	Max door weight (kg)	Closer size
<750	20kg	1
850	40kg	2
950	60kg	3
1100	80kg	4
1250	100kg	5
1400	120kg	6
1600	160kg	7

*All dimensions are in mm



ASSA ABLOY Door Closers

Cam Motion® for optimum convenience in opening doors

Cam Motion® for optimum convenience in opening doors

Cam Motion® Technology:

ASSA ABLOY Cam Motion® Technology enables guide rail Door Closers to comply with CEN TR 15894 requirements.

Safe in an emergency:

You'll be on the safe side with ASSA ABLOY since our Door Closers meet national and international provisions and regulations. Smoke protection and fire doors may only be fitted with Door Closer systems complying with EN1154/EN1155/EN1158. ASSA ABLOY supplies approved Door Closer systems for single and double leaf smoke and fire doors with different usage requirements.

Rapidly decreasing torque in a Cam Motion® Door Closer from ASSA ABLOY

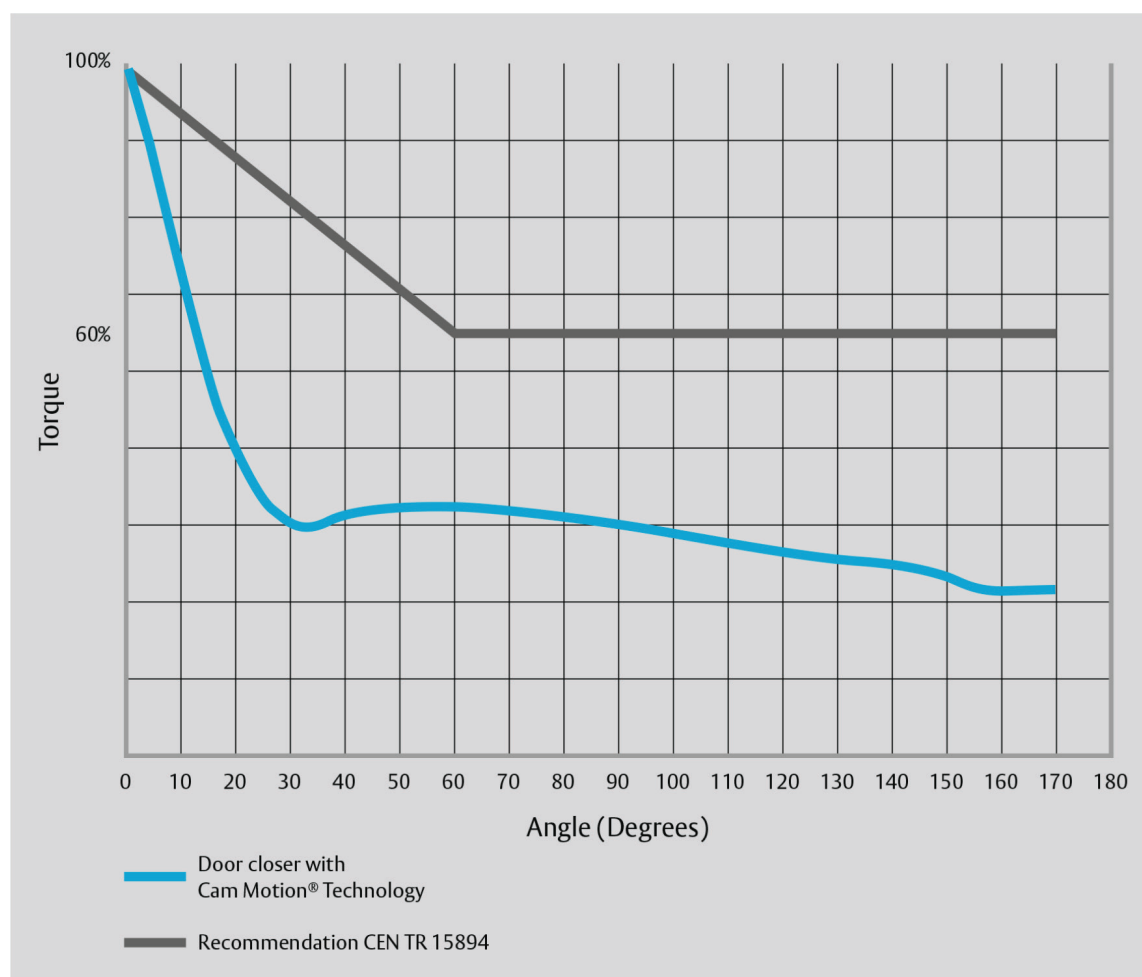

ASSA ABLOY Door Closers

use state-of-the-art technology

Door Closers Overview of functions		DC110	DC120	DC135	DC140	DC200
	Type	Surface Mounted	Surface Mounted	Surface Mounted	Surface Mounted	Surface Mounted
	EN Size	EN3	EN2/3/4	EN3	EN2/3/4/5	EN2-4
	Recommended door max. width (mm)	950	850-1100	950	850-1250	850-1100
	Door swing directions	Non-handed	Non-handed	Non-handed	Non-handed	Non-handed
	Closing speed	Variable between 180°-15°	Variable between 180°-15°	Variable between 180°-15°	Variable between 180°-15°	Variable between 180°-15°
	Latching speed	Variable between 15°-0°	Variable between 15°-0°	Variable between 15°-0°	Variable between 15°-0°	Variable between 15°-0°
	Back-check	-	Variable above 75°	Variable above 75°	Variable above 75°	Variable above 75°
	Delayed action	-	-	-	-	-
	Fire doors (CE)	✓	✓	✓	✓	✓
	Dimension L x D x H (mm)	182 x 60 x 41	220 x 47 x 52	233 x 43 x 60	206 x 40 x 55	223 x 47 x 60

	DC300	DC300 Tandem	DC500	DC700	DC860
Type	Surface Mounted	Surface Mounted	Surface Mounted	Surface Mounted	Concealed
EN Size	EN3-6	EN>7(2 X DC300)	EN1-4	EN3-6	EN1-5
Recommended door max. width (mm)	950-1400	1800	750-1100	950-1400	750/1250
Door swing directions	Non-handed	Non-handed	Non-handed	Non-handed	Non-handed
Closing speed	Variable between 180°-15°	Variable between 180°-15°	Variable between 170°-15°	Variable between 170°-15°	Variable between 120°-7°
Latching speed	Variable between 15°-0°	Variable between 15°-0°	Variable between 15°-0°	Variable between 15°-0°	Variable between 7°-0°
Back-check	Variable above 75°	-	Variable above 75°	Variable above 75°	Variable above 75°
Delayed action	O	-	-	O	-
Fire doors (CE)	✓	✓	✓	✓	✓
Dimension L x D x H (mm)	260 x 47 x 60	260 x 52 x 125	270 x 57 x 64	270 x 57 x 64	290 x 40 x 54

Door Closer - Surface Mounted DC110

ASSA ABLOY

Door Closer

DC110

ASSA ABLOY DC110:

- Rack and Pinion door closer with link arm
- In compliance with EN1154, size EN3
- For single action doors up to 950mm



Characteristics of DC110:

- Can be used for left and right-handed doors
- Suitable for fire and smoke protection doors
- Closing and latching speed adjustable via regulating valves
- Thermodynamic valves for consistent performance
- Standard colours: Silver EV1; White, similar to RAL9016; Black, similar to RAL9005

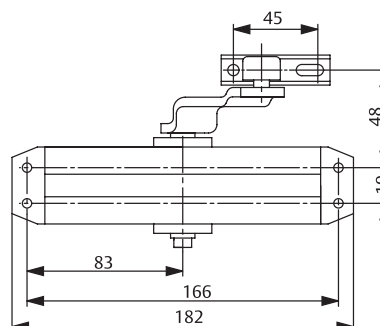
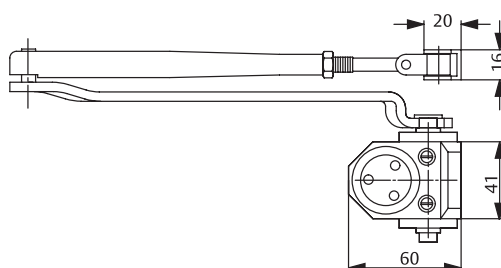
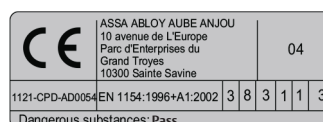

Door Closer

Technical details
for DC110

Technical details:

Closing force	EN3
Door width up to	950mm
Fire and smoke protection	Yes
Door swing directions	Left / right handed
Closing speed	Variable between 180°-15°
Latching speed	Variable between 15°-0°
Weight	1.5kg
Height	41mm
Depth	60mm
Length	182mm
In compliance with	EN1154
CE marking for building products	Yes

Our service for you:

Here you can see the individual advantages of our door closer models for your respective fields of business.

The advantages at a glance:

Customer segment	Advantages
Project planners	- Compact design - Favourably priced, reliable closer model
Builders	- Quick and easy installation - Suitable for left and right-handed doors - Easy to adjust
Trade	- Inexpensive closer model for standard doors - All inclusive package with door closer and link arm
User	- Largely unaffected by temperature fluctuations due to thermodynamic valves - Back-check feature offers optimum protection for doors and walls

Door Closer

Specifications for DC110

Specifications for DC110:

ASSA ABLOY Door Closer DC110 featuring Rack and Pinion technology is in compliance with EN1154.

- Closing force size EN3, for doors up to 950mm wide
- Closing speed and latching speed continuously adjustable
- Suitable for fire and smoke protection doors
- CE approved
- Suitable for left and right-handed doors

Required space on doors:

Left handed shown in diagram, Right handed is the reverse.

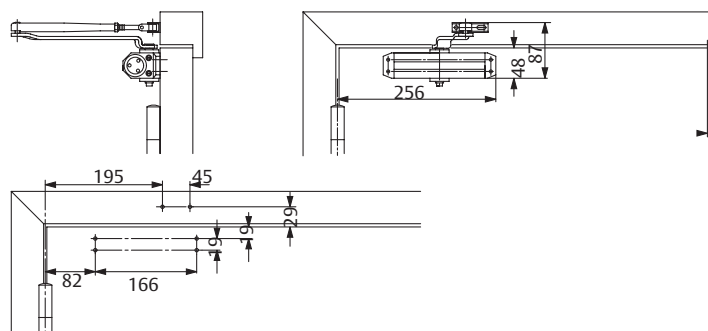

Installation dimensions:

Installation dimensions EN3

Colour:

- Silver EV1
- White, similar to RAL9016
- Black, similar to RAL9005

Door Closer - Surface Mounted DC120

Door Closer

DC120

ASSA ABLOY DC120:

- Rack and Pinion door closer with link arm
- In compliance with EN1154, size EN2/3/4
- For single action doors up to 1100mm

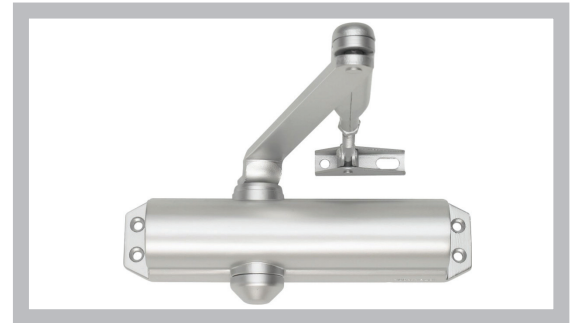

Characteristics of DC120:

- Can be used for left and right-handed doors
- Suitable for fire and smoke protection doors
- Closing speed, latching speed and back-check continuously adjustable using regulating valves
- Thermodynamic valves for consistent performance
- Closing force configurable
- Opening angle up to 180° (105° in mounting position size EN4)
- Standard colours: Silver EV1; White, similar to RAL9016; Black, similar to RAL9005

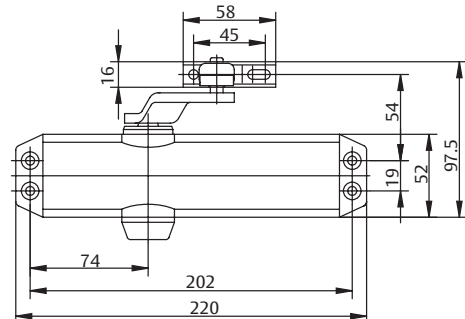
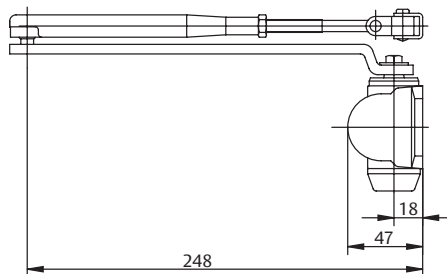

Door Closer

Technical details
for DC120

Technical details:

Closing force	EN2/3/4
Door width up to	1100mm
Fire and smoke protection	Yes
Door swing directions	Left / right handed
Closing speed	Variable between 180°-15°
Latching speed	Variable between 15°-0°
Back-check	Variable above 75°
Weight	1.6kg
Height	52mm
Depth	47mm
Length	220mm
In compliance with	EN1154
CE marking for building products	Yes

Our service for you:
Here you can see the individual advantages of our door closer models for your respective fields of business.

The advantages at a glance:

Customer segment	Advantages
Project planners	- Compact design - Favourably priced, reliable closer model
Builders	- Quick and easy installation - Suitable for left and right-handed doors - Easy to adjust
Trade	- Inexpensive closer model for standard doors - All inclusive package with door closer and link arm
User	- Largely unaffected by temperature fluctuation due to thermodynamic valves - Back-check feature offers optimum protection for doors and walls

Door Closer

Specifications for DC120

Specifications for DC120:

ASSA ABLOY Door Closer DC120 featuring Rack and Pinion technology is in compliance with EN1154.

- Closing force configurable, size EN 2/3/4, for doors up to 1100mm wide
- Closing speed, latching speed and back-check continuously adjustable
- Suitable for fire and smoke protection doors
- CE approved
- Suitable for left and right-handed doors

Required space on doors:

Left handed shown in diagram, Right handed is the reverse.

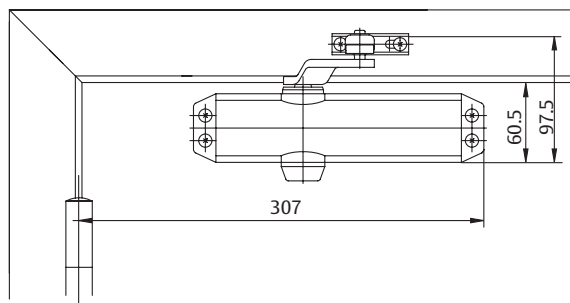

Colour:

- Silver EV1
- White, similar to RAL9016
- Black, similar to RAL9005

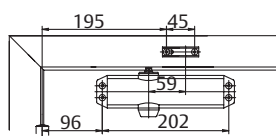

Installation dimensions EN2

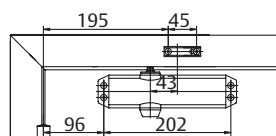

Installation dimensions EN3

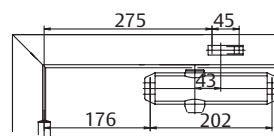

Installation dimensions EN4

Door Closer - Surface Mounted DC135

ASSA ABLOY

Door Closer

DC135

ASSA ABLOY DC135:

- Rack and Pinion door closer with guide rail
- In compliance with EN1154, size EN3
- For single action doors up to 950mm



Characteristics of DC135:

- Can be used for left and right-handed doors
- Opening angle up to 180°
- Closing speed, latching speed and back-check continuously adjustable using regulating valves
- Thermodynamic valves for consistent performance
- Standard colours: Silver EV1; White, similar to RAL9016; Black, similar to RAL9005; Brown similar to RAL8014

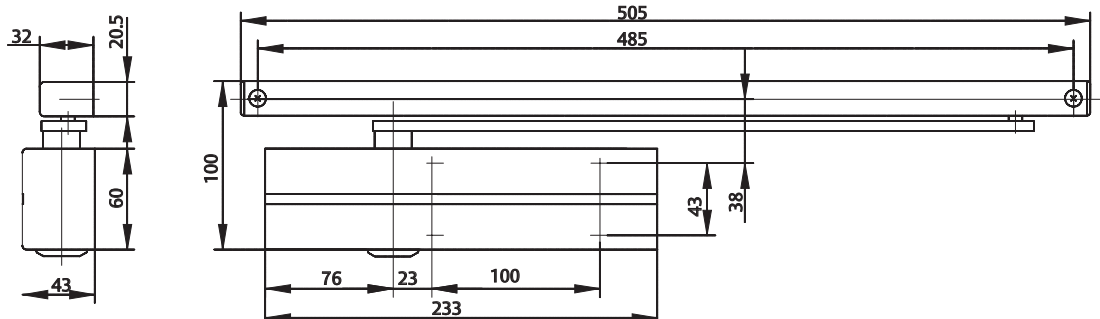
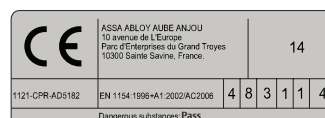

Door Closer

Technical details for
DC135

Technical details:

Closing force	EN3
Door width up to	950mm
Fire and smoke protection	Yes
Door swing directions	Left / right handed
Closing speed	Variable between 180°-15°
Latching speed	Variable between 15°-0°
Back-check	Variable above 75°
Weight	2.4kg
Height	60mm
Depth	43mm
Length	233mm
In compliance	EN1154
CE marking for building products	Yes

Our service for you:

Here you can see the individual advantages of our door closer models for your respective fields of business.

The advantages at a glance:

Customer segment	Advantages
Project planners	- Modern and compact design - Favourably priced, reliable closer model
Builders	- One drilling template overall - Quick and easy installation - Suitable for left and right handed doors - Easy to adjust
Trade	- Inexpensive closer model for standard doors - All inclusive package with door closer and guide rail
User	- Largely unaffected by temperature fluctuation due to thermodynamic valve - Back-check feature offers optimum protection for doors and walls

Door Closer
Specifications for DC135

Door Closer Specifications for DC135:

ASSA ABLOY Door Closer DC135 featuring Rack and Pinion technology with guide rail in compliance with EN1154.

- Closing force size EN3, for doors up to 950mm wide
- Closing speed, latching speed and back-check continuously adjustable
- Suitable for fire and smoke protection doors
- CE approved
- Suitable for left and right handed doors

Accessories:

- Mounting plate A187
- Mechanical opening damper A153
- Mechanical hold-open device A152
(Not for fire and smoke protection door)
- Mounting plate A130 for guide rails

Colour:

- Silver EV1
- White, similar to RAL9016
- Black, similar to RAL9005
- Brown , similar to RAL8014

Door Closer

Specifications for DC135

Required space on doors:

Left handed shown in diagram, Right handed is the reverse.

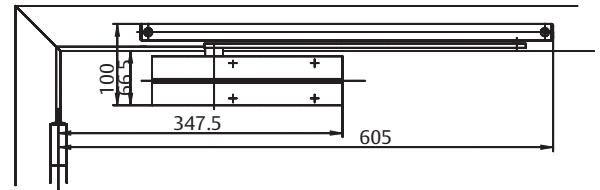
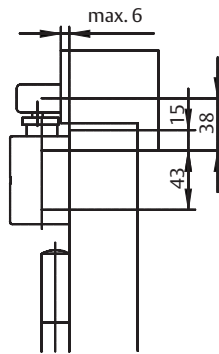

Installation dimensions for direct standard mounting on hinge side:

Left handed shown in diagram, Right handed is the reverse.

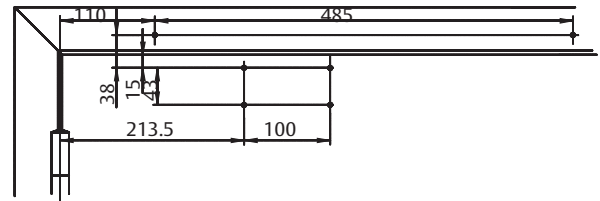
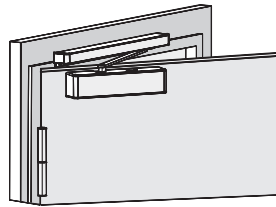

Installation dimensions for direct standard mounting on hinge side:

Left handed shown in diagram, Right handed is the reverse.

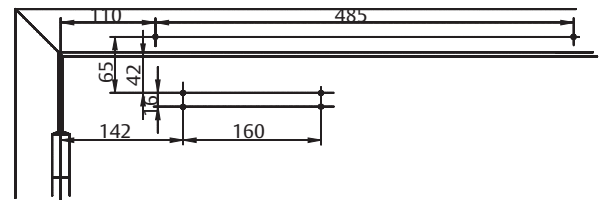

Installation dimensions when mounted directly on to the frame non-hinge side:

Left handed shown in diagram, Right handed is the reverse.

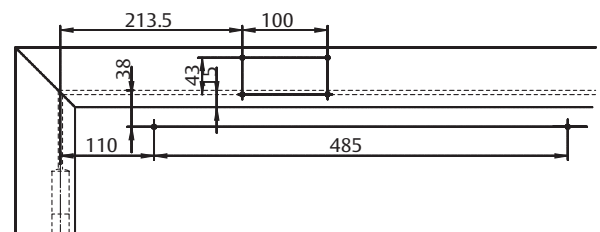
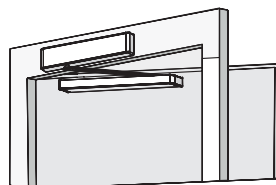

Installation dimensions with mounting plate for frame mounting non-hinge side:

Left handed shown in diagram, Right handed is the reverse.

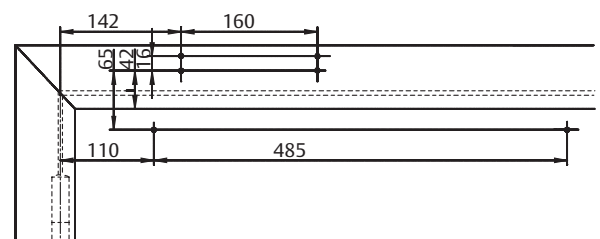

Door Closer

Accessories and order placement information for DC135

Mounting Plate A187:

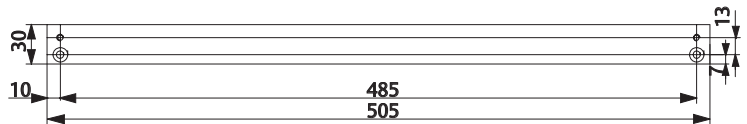
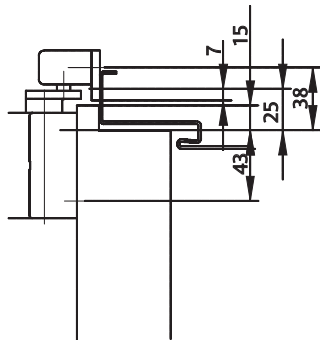
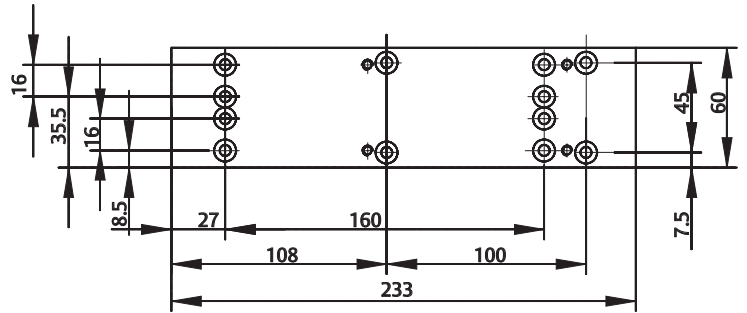
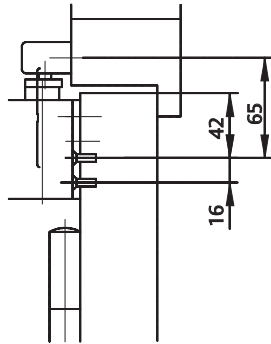

Hold open device A152:

- Mechanical hold-open device for doors which sometimes need to be secured in the open position
- Simple fitting into guide rails
- Hold open angle max. 130°
- Adjustable hold open force
- Not approved for use on fire and smoke protection doors



Opening damper A153:

- Helps to prevent the door and door handle from hitting a return wall
- Simple fitting into guide rail
- Opening damper continuously adjustable up to an opening angle of max. 130°
- Does not replace door stop



Door Closer - Surface Mounted DC140

ASSA ABLOY

Door Closer

DC140

ASSA ABLOY DC140:

- Rack and Pinion door closer with link arm
- In compliance with EN1154, size EN2/3/4/5
- For single action doors up to 1100mm wide



Characteristics of DC140:

- Can be used for left and right-handed doors
- Suitable for fire and smoke protection doors
- Closing speed, latching speed and back-check adjustable via front facing regulating valves
- Thermodynamic valves for consistent performance
- Closing force configurable
- Opening angle up to 180°
- Standard colours: Silver EV1; White, similar to RAL9016; Brown, similar to RAL8014; Black, similar to RAL9005



similar to RAL9005

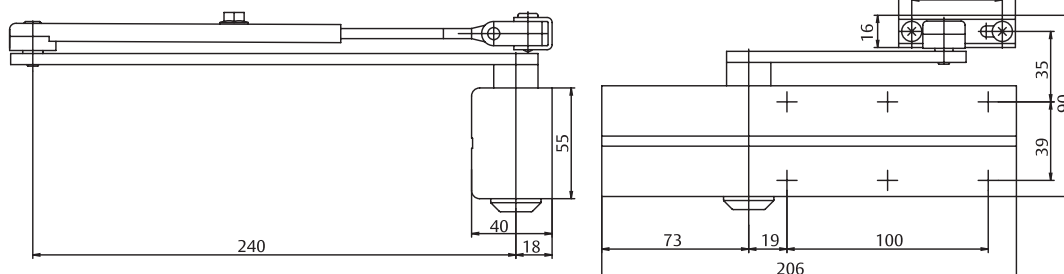

Door Closer

Technical details
for DC140

Technical details:

Closing force	EN2/3/4/5
Door width up to	1250mm
Fire and smoke protection	Yes
Door swing directions	Left / right handed
Closing speed	Variable between 180°-15°
Latching speed	Variable between 15°-0°
Back-check	Variable above 75°
Weight	1.75kg
Height	55mm
Depth	40mm
Length	206mm
In compliance with	EN1154
CE marking for building products	Yes

Our service for you:

Here you can see the individual advantages of our door closer models for your respective fields of business.

The advantages at a glance:

Customer segment	Advantages
Project planners	- Modern and compact design - Favourably priced, reliable closer model
Builders	- One drilling template overall - Quick and easy installation - Suitable for left and right-handed doors - Easy to adjust
Trade	- Inexpensive closer model for standard doors - All inclusive package with door closer and guide rail
User	- Largely unaffected by temperature fluctuation due to thermodynamic valves - Back-check feature offers optimum protection for doors and walls

Door Closer
Specifications for DC140

Door Closer Specifications for DC140:

ASSA ABLOY Door Closer DC140 featuring Rack and Pinion technology is in compliance with EN1154.

- Closing force size EN2/3/4/5, for doors up to 1250mm wide
- Closing speed, latching speed and back-check continuously adjustable
- Suitable for fire and smoke protection doors
- CE approved
- Suitable for left and right-handed doors

Required space on doors:

Left handed shown in diagram, Right handed is the reverse.

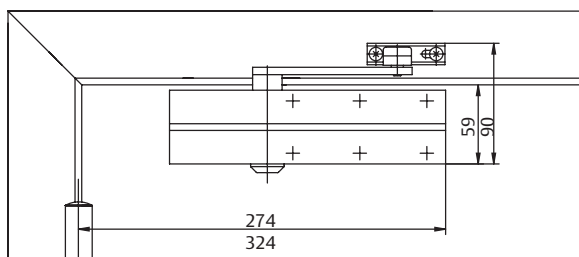

Colour:

- Silver EV1
- White, similar to RAL9016
- Black, similar to RAL9005
- Brown, similar to RAL8014

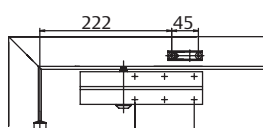

Installation dimensions EN2

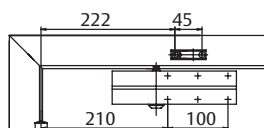

Installation dimensions EN3

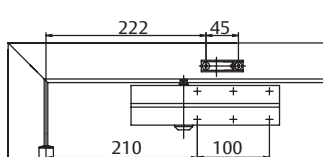

Installation dimensions EN4

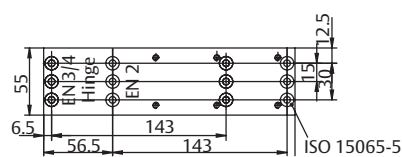

Mounting Plate A161

Door Closer - Surface Mounted DC200

Door Closer

DC200

ASSA ABLOY DC200:

- Rack and Pinion door closer with link arm L190
- In compliance with EN1154, size 2-4
- For single action doors up to 1100mm wide
- Suitable for fire and smoke protection doors



Characteristics of DC200:

- Can be used with integrated concealed mounting plate, suitable for fire and smoke protection doors
- Can be used for left and right-handed doors
- Link arm height-adjustable up to 14mm
- Closing speed, latching speed and back-check adjustable via front facing regulating valves
- Thermodynamic valves for consistent performance
- Adjustable closing force
- Opening angle up to 180°
- Effective back-check and latching speed range adjustable
- Large range of applications
- Standard colours: Silver EV1; White, similar to RAL9016; Brown, similar to RAL8014; Black, similar to RAL9005
- Customized finishes available on request

CE	ASSA ABLOY				
	Sicherheitstechnik GmbH Bildstockstraße 20 72458 Albstadt	10			
1162-CPD-0484	EN 1154:1996+A1:2002	4	8	4	1
Dangerous substances: None					



Characteristics for hold open link arm L191:

- Hold-open angle adjustable up to 150°
- Hold-open mode can be enabled and disabled as required
- Same installation as link arm
- Cannot be used with fire and smoke protection doors

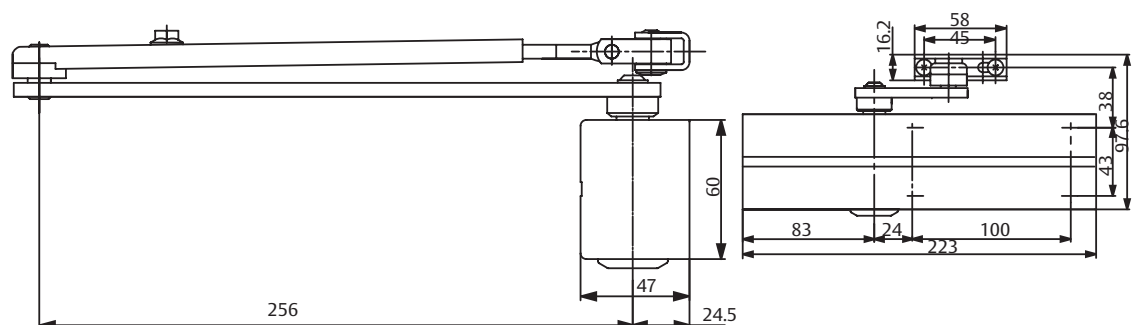

Door Closer

**Technical details
for DC200**

Technical details:	
Closing force	EN2-4
Door width up to	1100mm
Fire and smoke protection	Yes
Door swing directions	Left / right handed
Closing speed	Variable between 180°-15°
Latching speed	Variable between 15°-0°
Back-check	Variable above 75°
Hold-open mode (with hold-open link arm L191)	Adjustable 75°-150°, can be enabled and disabled
Weight	1.6kg
Height	60mm
Depth	47mm
Length	223mm
In compliance with	EN1154
CE marking for building products	Yes

Our service for you:

Here you can see the individual advantages of our door closer models for your respective fields of business.

The advantages at a glance:

Customer segment	Advantages
Project planners	<ul style="list-style-type: none"> - Extensive range of uses: Fire and smoke protection doors as well as standard doors - Modern and compact design - Fulfils barrier-free building requirements - Same dimensions and design with and without mounting plate - One drilling template overall
Builders	<ul style="list-style-type: none"> - Adjustable to nearly all door and frame types - Quick and easy installation, and easy adjustable - Suitable for left and right-handed doors in both door and frame mounted application
Trade	<ul style="list-style-type: none"> - Reduced inventory costs due to modular product range - One single product suitable for a large variety of mounting positions - Complementary accessories available for the whole product range
User	<ul style="list-style-type: none"> - Largely unaffected by temperature fluctuations thanks to thermodynamic valves - Easier door opening and improved accessibility due to rapidly decreasing torque - Back-check feature offers optimum protection for doors and walls

Door Closer

Dimensional drawings for DC200

Required space on doors:

Left handed shown in diagram, Right handed is the reverse.

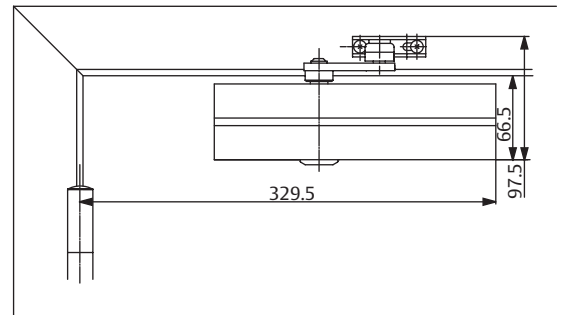
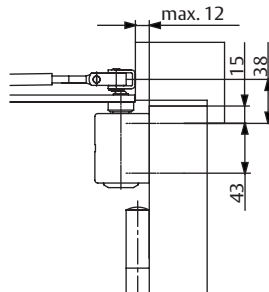

Installation dimensions for direct mounting:

Left handed shown in diagram, Right handed is the reverse.

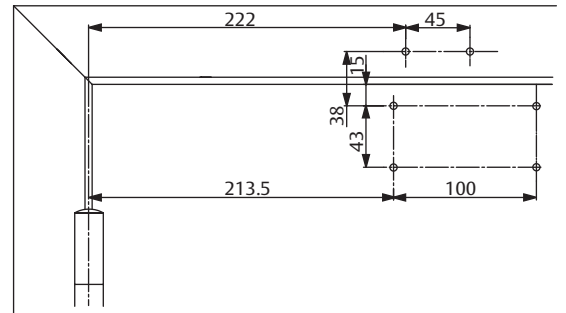
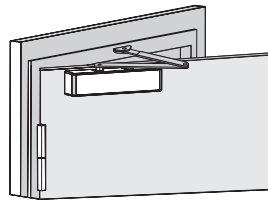

Installation dimensions with mounting plate:

In compliance with EN1154, Supplement 1, or for doors where direct mounting is not possible. Left handed shown in diagram, Right handed is the reverse.

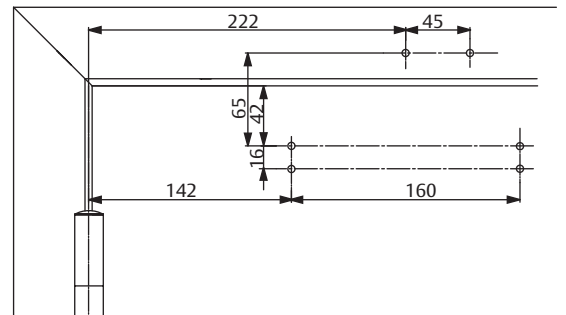

Frame mounting:

Closer on non-hinge side of door frame. Right handed door shown in diagram. Left handed door is the reverse.

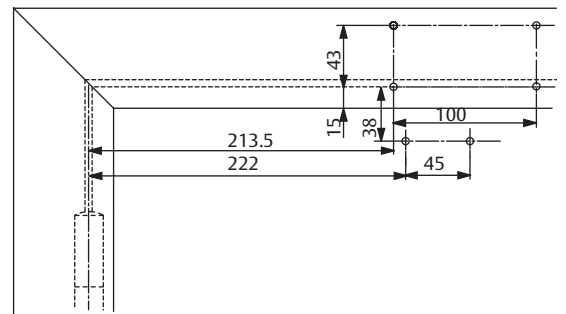
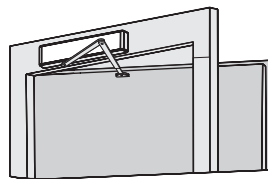

Installation dimensions with mounting plate for frame mounting:

Closer on non-hinge side of door frame. For doors where direct mounting is not possible. Right handed door shown in diagram. Left handed door is the reverse.

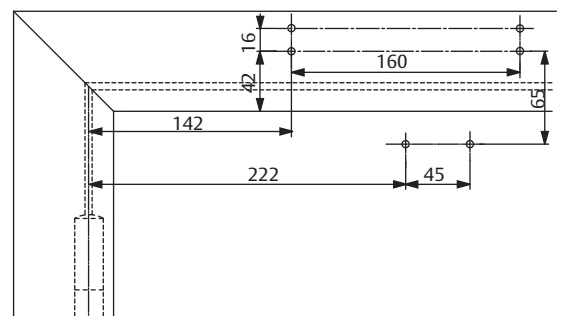

Door Closer

Accessories for DC200

Mounting plate A120:

For mounting with drilling template according to EN1154 Supplement 1 (fire and smoke protection doors) and for universal use.

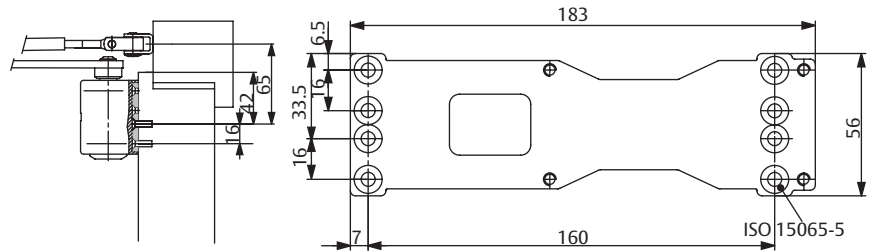

Angle bracket A122:

For frame mounting in case of deep jamb, headroom reduced by 70mm. Check suitability for use on fire and smoke protection doors.

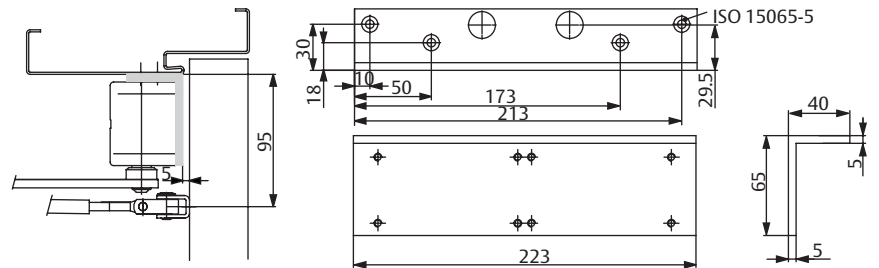

Parallel arm bracket A154:

For frame mounting in case of deep jamb, headroom reduced by 70mm. Check suitability for use on fire and smoke protection doors.

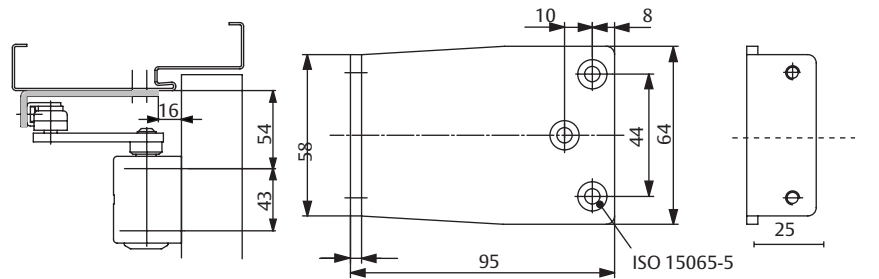

Door Closer

Specifications for DC200

Door Closer Specifications for DC200:

- Closing power adjustable, size EN2-4, for doors up to 1100mm wide
- Closing speed, latching speed and back-check adjustable via front facing regulating valves
- Can be used with integrated concealed mounting plate, suitable for fire and smoke protection doors
- CE approved
- 14mm height adjustable arm system for ease of fitting
- Suitable for left and right-handed doors

Colour:

- Silver EV1
- White, similar to RAL9016
- Brown, similar to RAL8014
- Black, similar to RAL9005
- Customized finish

Accessories:

- Link arm L190
- Hold-open link arm L191
- Mounting plate A120
- Angle bracket A122
- Parallel arm bracket for parallel arm mounting A154

Door Closer - Surface Mounted DC300

ASSA ABLOY

Door Closer

DC300

ASSA ABLOY DC300:

- Rack and Pinion door closer with link arm L190
- In compliance with EN1154, size EN3-6
- For single action doors up to 1400mm wide
- Suitable for fire and smoke protection doors



Characteristics of DC300:

- Can be used with integrated concealed mounting plate, suitable for fire and smoke protection doors
- Can be used for left and right-handed doors
- Link arm height-adjustable up to 14mm
- Closing speed, latching speed and back-check adjustable via front facing regulating valves
- Thermodynamic valves for consistent performance
- Adjustable closing force
- Opening angle up to 180°
- Effective back-check and latching speed range adjustable
- Large range of applications
- Standard colours: Silver EV1; White, similar to RAL9016; Brown, similar to RAL8014; Black, similar to RAL9005
- Customized finishes available on request

CE	ASSA ABLOY				
	Sicherheitstechnik GmbH Bildstockstraße 20 72458 Albstadt	10			
1162-CPD-0485	EN 1154:1996+A1:2002	4	8	6 3	1 1 4
Dangerous substances: None					



Characteristics for hold open link arm L191:

- Hold-open angle adjustable up to 150°
- Hold-open mode can be enabled and disabled as required
- Same installation as link arm
- Cannot be used with fire and smoke protection doors

Characteristics for special model DC300DA:

- Delayed closing adjustable from front
- Other features as in Model DC300

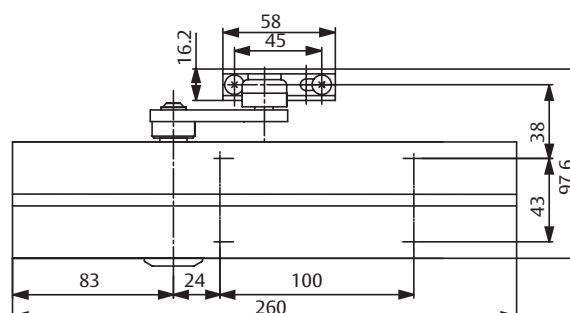
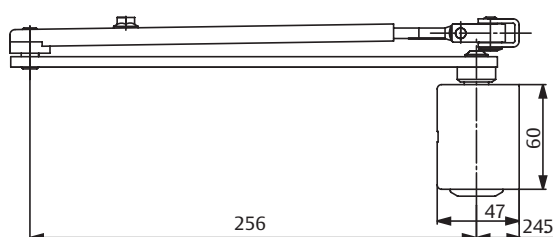

All dimensions are in mm

Our service for you:

Here you can see the individual advantages of our door closer models for your respective fields of business.

Technical details:	
Closing force	Size EN3-6
Door width up to	1400mm
Fire and smoke protection	Yes
Door swing directions	Left / right handed
Closing speed	Variable between 180°-15°
Latching speed	Variable between 15°-0°
Back-check	Variable above 75°
Delayed closing (DC300DA)	Yes
Hold-open mode (with hold-open link arm L191)	Adjustable 75°-150°, can be enabled and disabled
Weight	1.9kg
Height	60mm
Depth	47mm
Length	260mm
In compliance with	EN1154
CE marking for building products	Yes

Door Closer

Technical details for DC300

The advantages at a glance:	
Customer segment	<p>Advantages</p> <ul style="list-style-type: none"> - Extensive range of uses: Fire and smoke protection doors as well as standard doors - Modern and compact design - Fulfils barrier-free building requirements - Same dimensions and design with and without mounting plate - Comprehensive functions, standard and optional
Builders	<ul style="list-style-type: none"> - One drilling template overall - Adjustable to nearly all door and frame types - Quick and easy installation and easy adjustable - Suitable for left and right-handed doors, in both door and frame mounted applications
Trade	<ul style="list-style-type: none"> - Reduced inventory costs due to modular product range - One single product suitable for a large variety of mounting positions - Complementary accessories available for the whole product range - Largely unaffected by temperature fluctuations thanks to thermodynamic valves
User	<ul style="list-style-type: none"> - Easier door opening and improved accessibility due to rapidly decreasing torque - Back-check feature offers optimum protection for doors & walls

Door Closer
Dimensional drawings for DC300

Required space on doors:

Left handed shown in diagram, Right handed is the reverse.

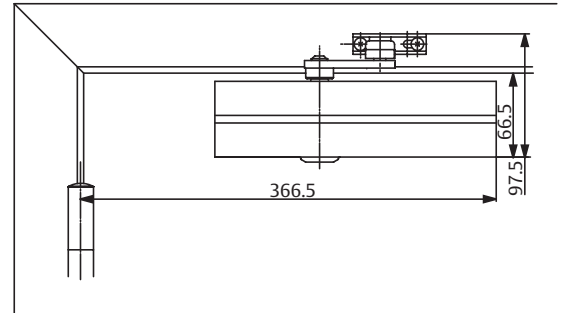
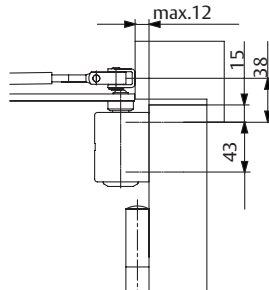

Installation dimensions for direct mounting:

Left handed shown in diagram, Right handed is the reverse.

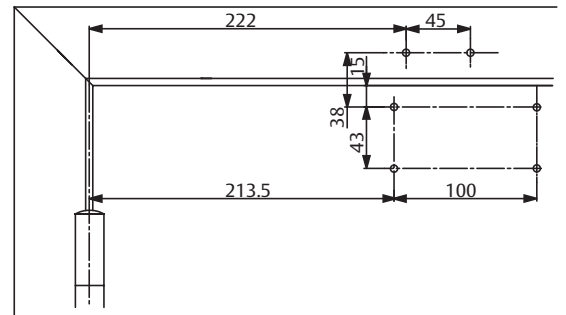
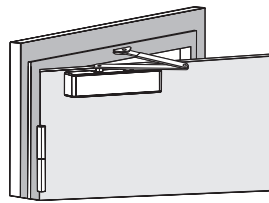

Installation dimensions with mounting plate:

In compliance with EN1154, Supplement 1, or for doors where direct mounting is not possible. Left handed shown in diagram, Right handed is the reverse.

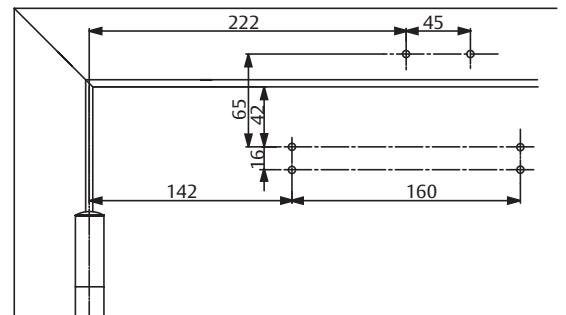

Frame mounting:

Closer on non-hinge side of door frame right handed door shown in diagram, Left handed door is the reverse.

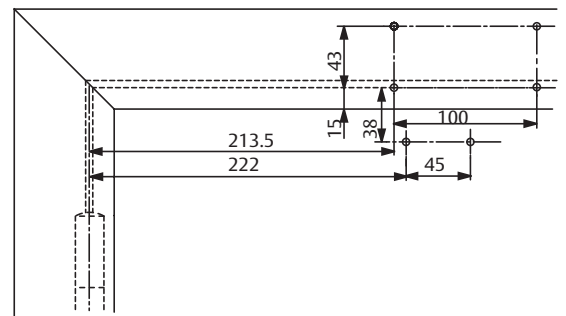
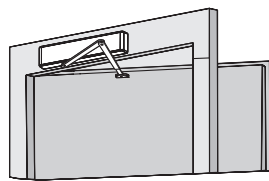

Installation dimensions with mounting plate for frame mounting:

Closer on non-hinge side of door frame. For doors where direct mounting is not possible. Right-handed door shown in diagram. Left-handed door is the reverse.

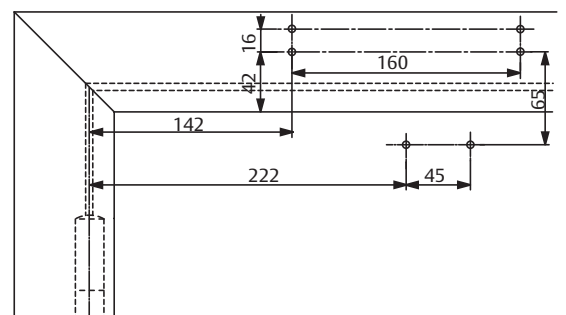

Door Closer
Accessories for DC300

Mounting plate A120:

For mounting with drilling template according to EN1154 Supplement 1 (fire and smoke protection doors) and for universal use.

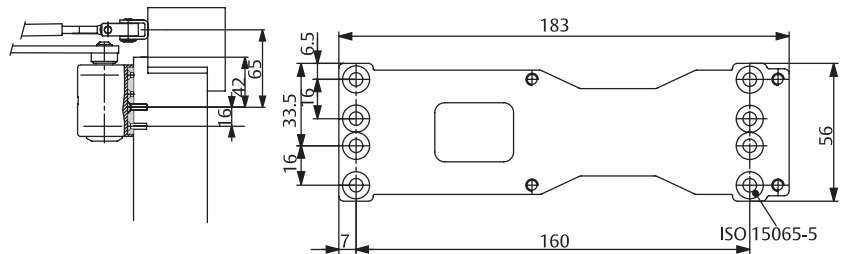

Angle bracket A123:

For frame mounting in case of deep jamb, headroom reduced by 70 mm. Check suitability for use on fire and smoke protection doors.

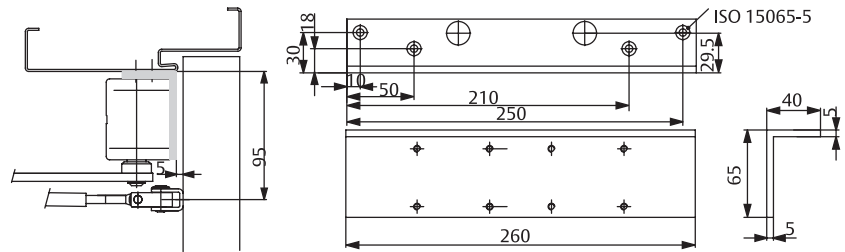

Parallel arm bracket A154:

For parallel arm installation. Check suitability for use on fire and smoke protection doors.

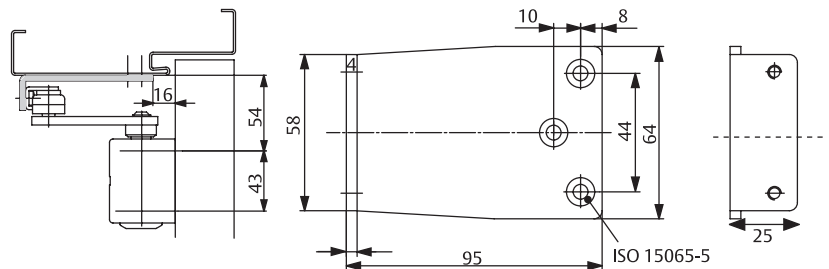

Door Closer
Specifications for DC300

Door Closer Specifications for DC300:

ASSA ABLOY Door Closer DC300 featuring Rack and Pinion technology is in compliance with EN1154.

- Closing power adjustable, size EN 3-6, for doors up to 1400mm wide
- Closing speed, latching speed and back-check adjustable via front facing regulating valves
- Can be used with integrated concealed mounting plate, suitable for fire and smoke protection doors
- CE approved
- 14mm height adjustable arm system for ease of fitting
- Suitable for left and right-handed doors

Colour:

- Silver EV1
- White, similar to RAL9016
- Brown, similar to RAL8014
- Black, similar to RAL9005
- Customized finish

Accessories:

- Link arm L190
- Hold-open link arm L191
- Mounting plate A120
- Angle bracket A122
- Parallel arm bracket for parallel arm mounting A154

Door Closer - Surface Mounted DC300 Tandem

ASSA ABLOY

Door Closer

DC300 Tandem

ASSA ABLOY DC300 Tandem:

- Rack and Pinion door closer with link arm L190
- Two door closer are interlinked for extra wide and heavy doors
- Double closing torque of DC300, EN size >7
- For single action doors up to 1800mm wide



Characteristics of DC300 Tandem:

- Suitable for fire and smoke protection doors
- Tandem mounting plate A121 generally required
- Can only be used with a link arm
- Can be used for left and right-handed doors
- Link arm height-adjustable up to 14mm
- Closing speed, latching speed and back-check adjustable via front facing regulating valves
- Thermodynamic valves for consistent performance
- Adjustable closing force
- Opening angle up to 180°
- Effective back-check and latching speed range adjustable
- Large range of applications
- Standard colours: Silver EV1

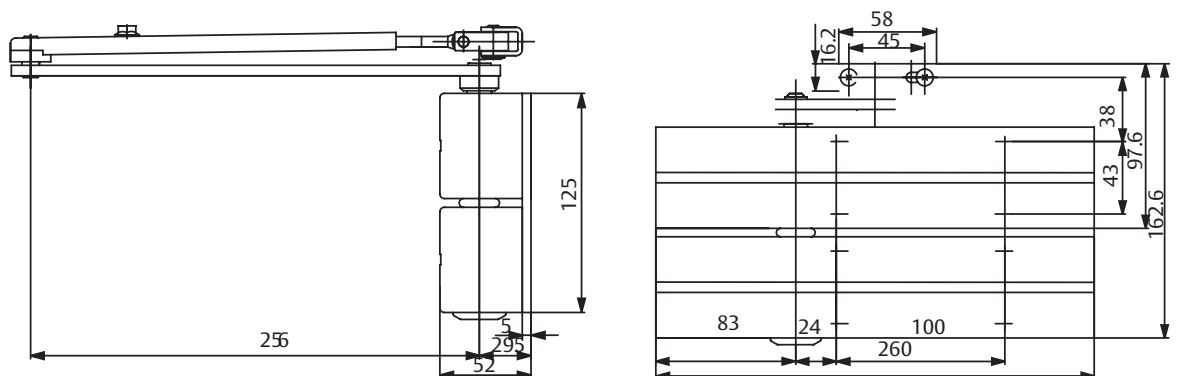

Door Closer

**Technical details
for DC300 Tandem**

Technical details:

Adjustable closing force	EN >7 (2 x DC300)
Door width up to	1800mm
Door swing directions	Left / right handed
Closing speed	Variable between 180°-15°
Latching speed	Variable between 15°- 0°
Back-check	Variable above 75°
Hold-open mode	e.g. for external holding magnet
Weight	4.8kg
Height	125 mm
Depth	52 mm
Length	260 mm
In compliance with	EN1154 (DC 300)
CE marking for building products	Yes (DC300)

Our service for you:

Here you can see the individual advantages of our door closer models for your respective fields of business.

The advantages at a glance:

Customer segment	Advantages
Project planners	- Extensive range of uses: also for extra large and heavy doors
Builders	- One drilling template overall - Standard door closers DC300 can be used with tandem mounting plates - Quick and easy installation and easy adjustable - Suitable for left and right-handed doors and frame mounted applications - Easily retrofitted with minimal rework
Trade	- Reduced inventory costs due to modular product range
User	- No reworking of door element for upgrade to tandem

Consists of:

- 2 pieces of DC300
- 1 piece mounting plate A121
(One piece of accessory pack contains mounting plate A121, extra long spindle and screw pack)
- 1 piece link arm L190

Colour:

- Silver EV1

Door Closer
Dimensional drawings for DC300 Tandem

Required space on doors:
Left handed shown in diagram,
Right handed is the reverse.

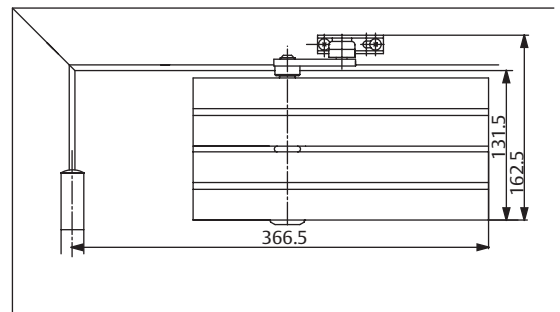
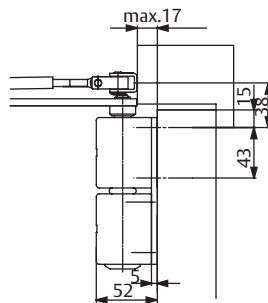

Installation dimensions for direct mounting:
Left handed shown in diagram,
Right handed is the reverse.

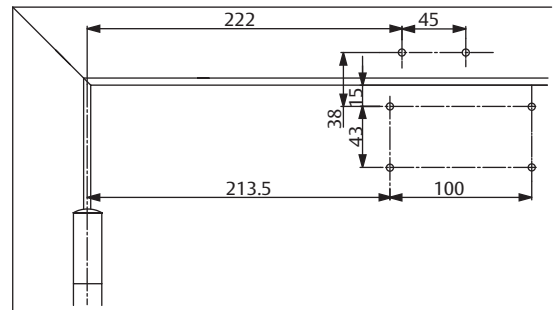
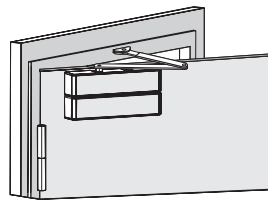

Installation dimensions with mounting plate:
In compliance with EN1154, Supplement 1, or for doors where direct mounting is not possible. Left handed shown in diagram,
Right handed is the reverse.

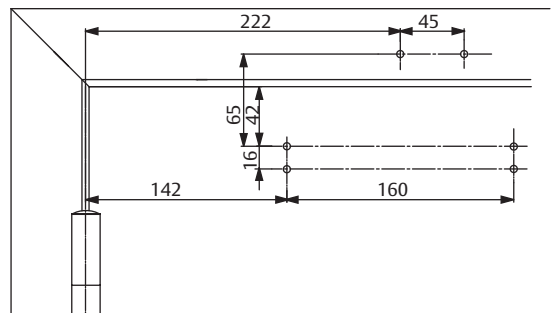

Door Closer
Accessories for DC300 Tandem

Mounting plate A121:
For mounting with drilling template according to EN1154 Supplement 1 (fire and smoke protection doors) and for direct mounting.

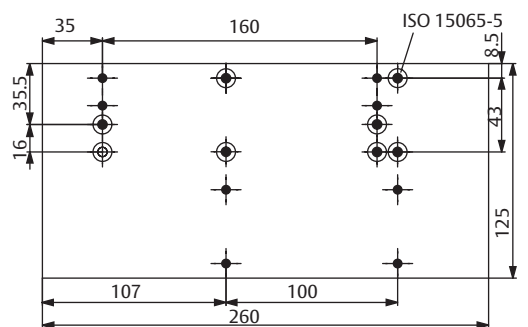
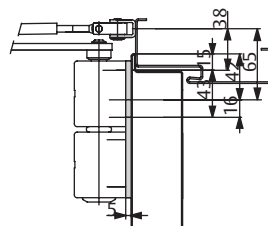

Specifications for DC300 Tandem:

- ASSA ABLOY Door Closer DC300 Tandem with link arm
- Closing power continuously adjustable, size EN >7, for doors up to 1800 mm wide
 - Closing speed, latching speed and back-check adjustable via front facing regulating valves
 - Can be used with mounting plate for fire and smoke protection doors
 - 14mm height adjustable arm system for ease of fitting
 - Suitable for left and right-handed doors

Door Closer - Surface Mounted DC500

ASSA ABLOY

Door Closer

DC500 Cam Motion

ASSA ABLOY DC500

- Door closer with Cam Motion technology and height-adjustable guide rail G195 or standard guide rail G193
- Fulfils barrier-free building requirements (DDA/ CEN TR 15894)
- Certified in compliance with EN1154, size EN1-4
- Suitable for fire and smoke protection doors
- For single action doors up to 1100mm wide
- Can be used in four installation types: Hinge and non-hinge side in standard and frame installation



CE	Abloy OY PO Box 108 80101 Joensuu, Finland	10					
	1162-CPD-0464	EN 1154:1996+A1:2002	3	8	4 1	1	1



Characteristics of DC500:

- Can be used with integrated concealed mounting plate, suitable for fire and smoke protection doors
- Can be used for left and right-handed doors
- Axis continuously height adjustable up to 14mm
- Closing speed, latching speed and back-check adjustable via front facing regulating valves
- Thermodynamic valves for consistent performance
- Adjustable closing force
- Opening angle up to 170°
- Effective back-check and latching speed range adjustable
- Large range of applications
- Standard colours: silver EV1; White, similar to RAL9016; Brown, similar to RAL8014; Black, similar to RAL9005
- Customized finishes available on request

Characteristics for guide rail G195:

- Height-adjustable by 2mm for tolerance
- Concealed fastening screws
- Installation dimensions: see diagram doors

Characteristics of standard guide rail G193:

- Without protective cover
- Visible fastening screws
- Installation dimensions: see diagram (dimensions in brackets)

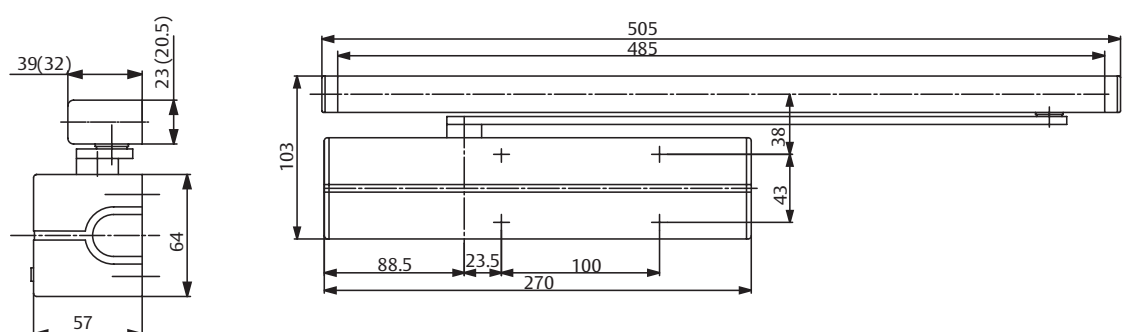

Door Closer

Technical details for DC500

Technical details:	
Adjustable closing force	EN1-4
Door width up to	1100mm
Fire and smoke protection	Yes
Door swing directions	Left / right handed
Standard and frame installation	Yes
Closing speed	Variable between 170°-15°
Latching speed	Variable between 15°-0°
Back-check	Variable above 75°
Opening angle hinge side	ca. 170°
Opening angle non-hinge side	ca. 102°
Weight	2.7kg
Height	64mm
Depth	57mm
Length	270mm
In compliance with	EN1154
CE marking for building products	Yes

Our service for you:

Here you can see the individual advantages of our door closer models for your respective fields of business.

The advantages at a glance:	
Customer segment	Advantages
Project planners	<ul style="list-style-type: none"> - Extensive range of uses: Fire and smoke protection doors as well as standard doors - Modern and compact design - Fulfils barrier-free building requirements (DDA, CEN/TR 15894) - Same dimensions and design with and without mounting plate
Builders	<ul style="list-style-type: none"> - One drilling template overall - Quick and easy installation - Quickly and easily adjustable - Adjustable to nearly all door and frame types - Suitable for left and right-handed doors for standard and frame mounting on hinge and non-hinge side
Trade	<ul style="list-style-type: none"> - Reduced inventory costs due to modular product range - One single product suitable for a large variety of mounting positions - Complementary accessories available for the whole product range
User	<ul style="list-style-type: none"> - Largely unaffected by temperature fluctuations due to thermodynamic valves - Easier door opening and improved accessibility due to Cam Motion technology

Door Closer
Dimensional drawings for DC500

Space required on doors for standard installation on hinge side: Left handed shown in diagram, Right handed is the reverse.

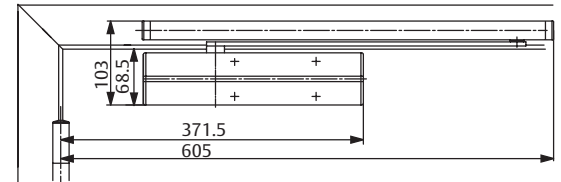
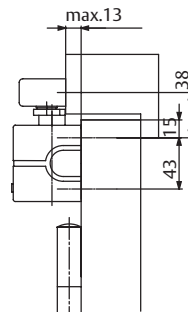

Installation dimensions for direct standard mounting on hinge side: Left handed shown in diagram, Right handed is the reverse.

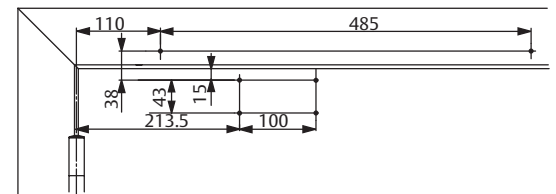
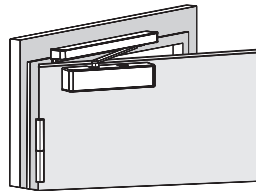

Installation dimensions with mounting plate for standard mounting on hinge side: In compliance with EN1154, supplement 1, or for doors where direct mounting is not possible. Left handed shown in diagram, Right handed is the reverse.

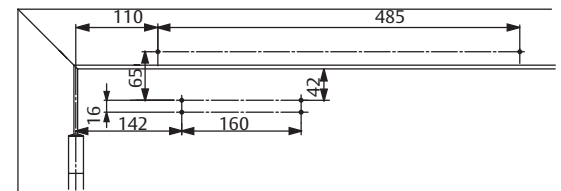

Installation dimensions for direct frame mounting on hinge side: Closer on hinge side of door frame. Left handed shown in diagram, Right handed is the reverse.

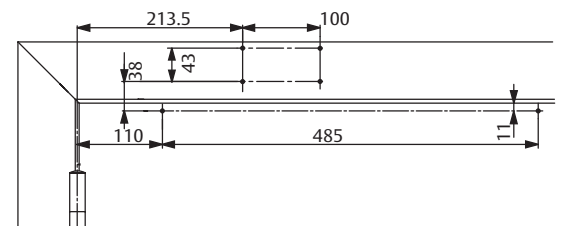
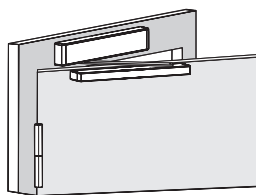

Installation dimensions with mounting plate for frame mounting on hinge side: Closer on hinge side of door frame. For doors where direct mounting is not possible. Left handed shown in diagram, Right handed is the reverse.

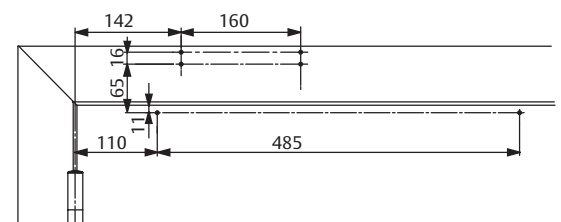

Door Closer
Dimensional drawings for DC500

Installation dimensions for direct standard mounting non-hinge side: Right-handed door shown in diagram, Left handed door is the reverse.

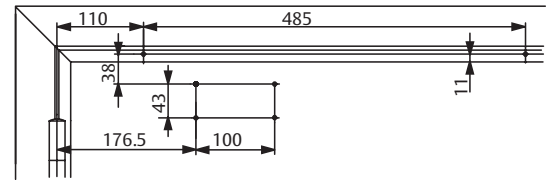
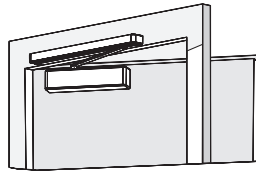

Installation dimensions with mounting plate for standard mounting non-hinge side: For doors where direct mounting is not possible. Right handed door shown in diagram, Left handed door is the reverse.

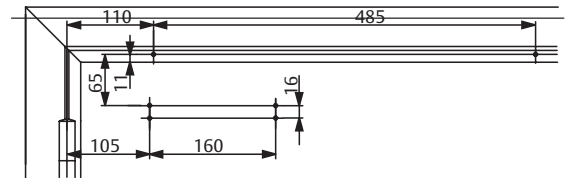

Installation dimensions when mounted directly on to the frame hinge side: Closer on non-hinge side of door frame. Right handed door shown in diagram, Left handed door is the reverse.

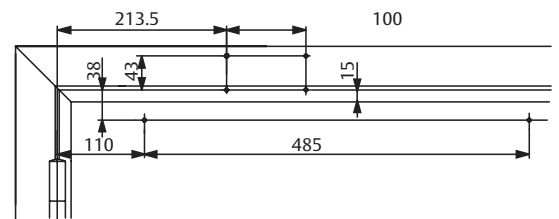
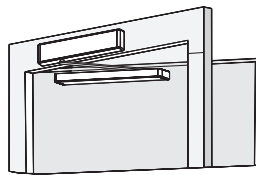

Installation dimensions with mounting plate for frame mounting non-hinge side: Closer on non-hinge side of door frame. For doors where direct mounting is not possible. Right-handed door shown in diagram, Left handed door is the reverse.

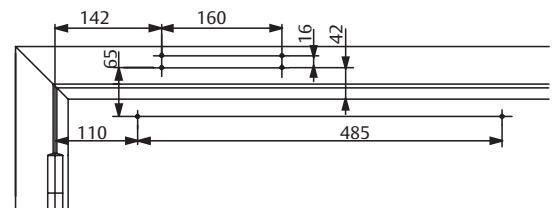

Door Closer

Accessories for DC500

Hold-open device A152:

- Mechanical hold-open device for doors which sometimes need to be secured in the open position
- Simple fitting into guide rail G193 and G195.
- Hold open angle: 130° (max.)
- Adjustable hold-open force
- Not approved for use on fire and smoke protection doors



Opening damper A153:

- Helps to prevent the door and door handle from hitting a return wall
- Simple fitting into guide rail G193 and G195
- Opening damper continuously adjustable up to an opening angle of max. 130°
- Does not replace a door stop



Door Closer

Specifications for DC500

Specifications for DC500 :

ASSA ABLOY Door Closer DC500 with Cam Motion technology and guide rail is in compliance with EN1154.

- Closing power continuously adjustable, EN1-4, for doors up to 1100mm wide
- Closing speed, latching speed and back-check adjustable via front facing regulating valves
- Can be used with integrated concealed mounting plate, suitable for fire and smoke protection doors
- CE approved
- 14mm height adjustable arm system for ease of fitting
- Standard and frame mounting on hinge and non-hinge side of the door
- Suitable for left and right-handed doors

Colour:

- Silver EV1
- White, similar to RAL9016
- Brown, similar to RAL8014
- Black, similar to RAL9005
- Customized finish

Accessories:

- Standard guide rail G193
- Height-adjustable guide rail G195
- Mounting Plate A120
- Mounting Plate A130 for guide rail G193 and G1 193 and G 195
- Angle bracket A104 for guide rail G193
- Mechanical opening damper A153
- Mechanical hold open device A152
(not for fire and smoke protection doors)

Door Closer - Surface Mounted DC700

ASSA ABLOY

Door Closer

DC700 Cam Motion

ASSA ABLOY DC700

- Door closer with Cam Motion technology and height-adjustable guide rail G195 or standard guide rail G193
- Fulfils barrier-free building requirements (DDA/ CEN TR 15894)
- In compliance with EN1154, size EN3-6
- Suitable for fire and smoke protection doors
- For single action doors up to 1400mm wide
- Can be used in four installation types: Hinge and non-hinge sides in standard and frame installation



CE	Abloy OY PO Box 108 80101 Joensuu, Finland	10			
	1162-CPD-0464	EN 1154:1996+A1:2002	3	8	$\frac{6}{3}$ 1 1 4



Characteristics of DC700:

- Can be used with integrated concealed mounting plate, suitable for fire and smoke protection doors
- Can be used for left and right-handed doors
- Axis continuously height adjustable up to 14mm
- Closing speed, latching speed and back-check adjustable via front facing regulating valves
- Thermodynamic valves for consistent performance
- Adjustable closing force
- Opening angle up to 170°
- Optional delayed action
- Large range of applications
- Standard colours: Silver EV1; White, similar to RAL9016; Brown, similar to RAL8014; Black, similar to RAL9005
- Customized finishes available on request

Characteristics of standard guide rail G193:

- Without protective cover
- Visible fastening screws
- Installation dimensions: see diagram (dimensions in brackets)

Characteristics for guide rail G195:

- Height-adjustable by 2mm for tolerance
- Concealed fastening screws
- Installation dimensions: see diagram doors

Characteristics of special model DC700AC:

- Opening angle of 180° for standard installation on hinge side
- Other features as in Model DC700

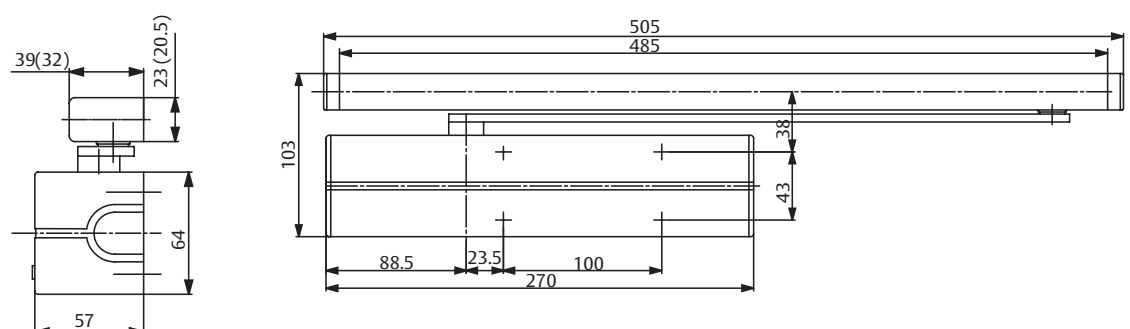

Door Closer
Technical details for DC700

Technical details:	
Adjustable closing force	EN3-6
Door width up to	1400mm
Fire and smoke protection	Yes
Door swing directions	Left / right handed
Standard and frame installation	Yes
Closing speed	Variable between 170°-15°
Latching speed	Variable between 15°-0°
Back-check	Variable above 75°
Delayed closing (DC700DA)	Yes
Opening angle hinge side (DC700)	ca. 170°
Opening angle hinge side (DC700 AC)	180°
Opening angle non-hinge side (DC700 AC)	ca. 120°
Weight	2.7kg
Height	64mm
Depth	57mm
Length	270 mm
In compliance with	EN1154
CE marking for building products	Yes

Our service for you:
Here you can see the individual advantages of our door closer models for your respective fields of business.

The advantages at a glance:	
Customer segment	Advantages
Project planners	<ul style="list-style-type: none"> - Extensive range of uses: Fire and smoke protection doors as well as standard doors - Modern and compact design - Fulfills barrier-free building requirements (DDA, CEN/TR 15894) - Same dimensions and design with and without mounting plate - Comprehensive functions, standard and optional
Builders	<ul style="list-style-type: none"> - One drilling template overall - Quick and easy installation - Quickly and adjustable - Suitable for left and right-handed doors, in both door and frame mounted applications - Easily retrofitted with minimal rework - Reduced inventory costs due to modular product
Trade	<ul style="list-style-type: none"> - One single product suitable for a large variety of mounting positions - Complementary accessories available for the whole product range
User	<ul style="list-style-type: none"> - Largely unaffected by temperature fluctuations thanks to thermodynamic valves - Easier door opening and improved accessibility due to Cam Motion technology

Door Closer

Dimensional drawings for DC700

Space required on doors for standard installation on hinge side: Left handed shown in diagram, Right handed is the reverse.

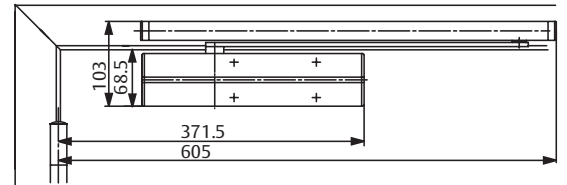
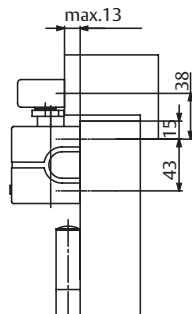

Installation dimensions for direct standard mounting on hinge side: Left handed shown in diagram, Right handed is the reverse.

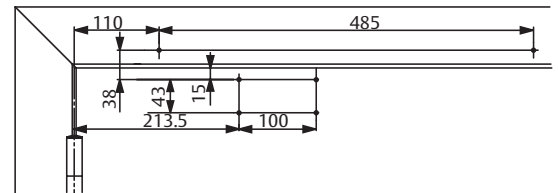
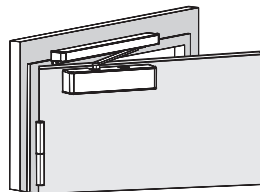

Installation dimensions with mounting plate for standard mounting on hinge side: In compliance with EN 1154, supplement 1, or for doors where direct mounting is not possible. Left handed shown in diagram, Right handed is the reverse.

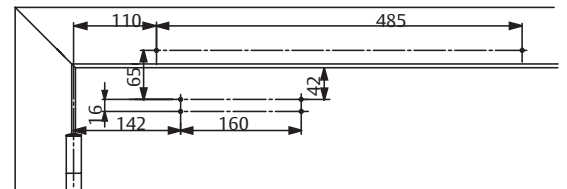

Installation dimensions for direct frame mounting on hinge side: Closer on hinge side of door frame. Left handed shown in diagram, Right handed is the reverse.

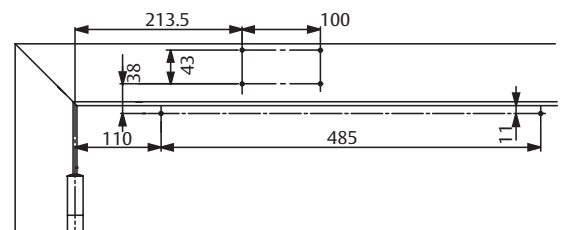
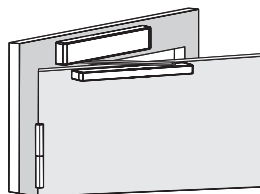

Installation dimensions with mounting plate for frame mounting on hinge side: Closer on hinge side of door frame. For doors where direct mounting is not possible. Left handed shown in diagram, Right handed is the reverse.

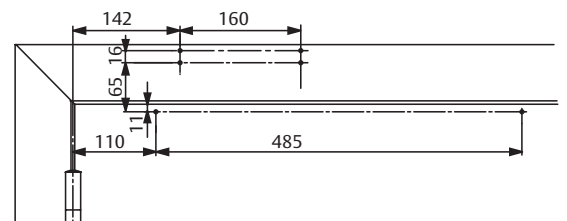

Door Closer
Dimensional drawings for DC700

Installation dimensions for direct standard mounting non-hinge side: Right handed door shown in diagram, Left handed door is the reverse.

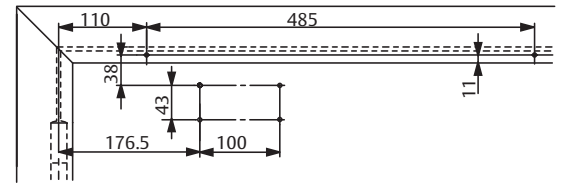
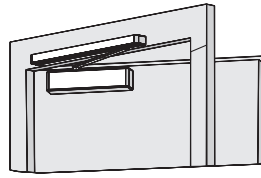

Installation dimensions with mounting plate for standard mounting non-hinge side: For doors where direct mounting is not possible. Right-handed door shown in diagram, Left handed door is the reverse.

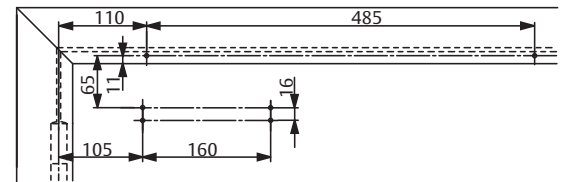

Installation dimensions when mounted directly on to the frame hinge side: Closer on non-hinge side of door frame. Right-handed door shown in diagram, Left handed door is the reverse.

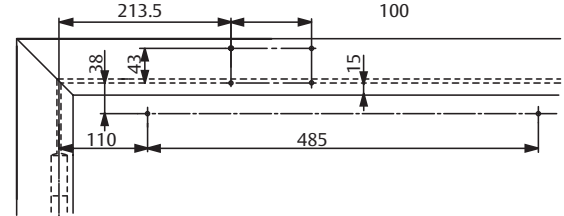
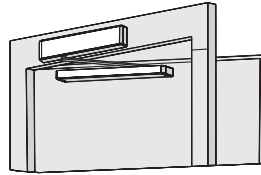

Installation dimensions with mounting plate for frame mounting non-hinge side: Closer on non-hinge side of door frame. For doors where direct mounting is not possible. Right-handed door shown in diagram, Left handed door is the reverse.

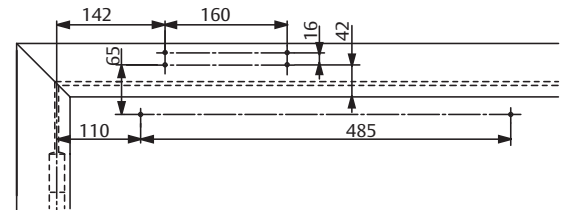

Door Closer
Accessories for DC700

Mounting Plate A120:

For mounting with drilling template according to EN1154 Supplement 1 and for universal use

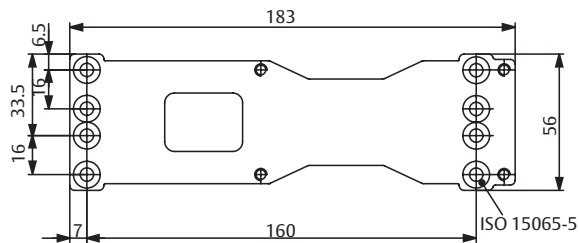
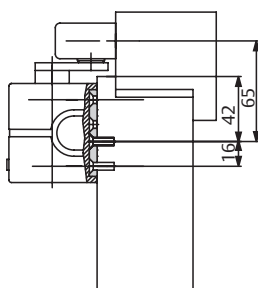

Mounting Plate A130:

For guide rail G193 and G195

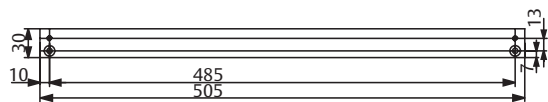
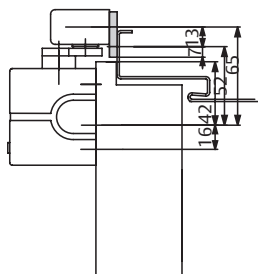

Angle Bracket A104:

Only for standard guide rail G193

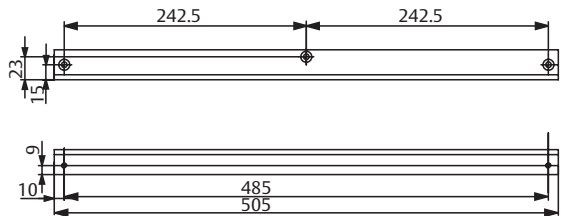
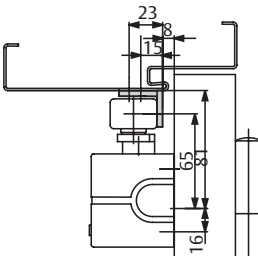

Replacement Plate A124:

Replacement Plate A124

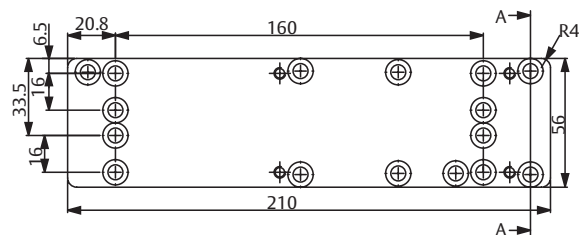
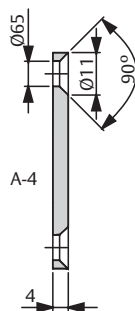

Door Closer

Accessories for DC700

Hold-open device A152:

- Mechanical hold-open device for doors which sometimes need to be secured in the open position
- Simple fitting into guide rail G193 and G195
- Hold open angle: 130° (max.)
- Adjustable hold-open force
- Not approved for use on fire and smoke protection doors



Opening damper A153:

- Helps to prevent the door and door handle from hitting a return wall
- Simple fitting into guide rail G193 and G195
- Opening damper continuously adjustable up to an opening angle of max. 130°
- Does not replace a door stop



Door Closer

Specifications for DC700

Specifications for DC700 :

ASSA ABLOY Door Closer DC700 with Cam Motion technology and guide rail is in compliance with EN1154.

- Closing power continuously adjustable, size EN3-6, for doors up to 1400mm wide
- Closing speed, latching speed and back-check adjustable via front facing regulating valves
- Can be used with integrated concealed mounting plate, suitable for fire and smoke protection doors
- CE approved
- 14mm height adjustable arm system for ease of fitting
- Standard and frame mounting on hinge and non-hinge side of the door
- Suitable for left and right-handed doors

Accessories:

- Standard guide rail G193
- Height-adjustable guide rail G195
- Mounting plate A120
- Mounting plate A130 for guide rail G193
- Angle bracket A104 for guide rail G193
- Mechanical opening damper A153
- Mechanical hold open device A152
(not for fire and smoke protection doors)

Colour:

- Silver EV1
- White, similar to RAL9016
- Brown, similar to RAL8014
- Black, similar to RAL9005
- Customized finish

Door Closer - Surface Mounted DC700G-FT

Door Closer

DC700G-FT
Cam Motion

ASSA ABLOY DC700G-FT:

- ASSA ABLOY Door Closer with Cam Motion technology, extended mounting plate and integrated latch bolt lock, extended guide rail with integrated escape door strike
- Suitable for retrofitting to fire doors with guide rail door closers and fastening using drilling template according to EN1154, Supplementary Sheet 1:2003-11
- In compliance with EN 1154, size EN3-6
- Escape door strike 332, tested in compliance with the German guidelines for electrical locking systems for doors along escape routes
- For single leaf doors, doors between 850mm - 1,200mm wide



CE	Abloy OY PO Box 108 80101 Joensuu, Finland	10					
	1162-CPD-0464	EN 1154:1996+A1:2002	3	8	⁶ / ₃	1	1



ASSA ABLOY DC700G-FT:

- Integrated escape door strike 332 in extended guide rail
- Integrated latch bolt lock 807 on extended mounting plate
- With 4m connecting cable
- Flush or surface installation of wiring possible
- Suitable for fire and smoke protection doors
- Suitable for left and right-handed doors
- Standard installation on hinge side
- Adjustable closing force
- Closing speed, latching speed and back-check continuously adjustable
- Thermodynamic valves for consistent performance
- Door closer axis height continuously adjustable by 14mm
- Standard colours: Silver EV1

Characteristics of escape door locking system:

- Holding force of 2,000 N
- Latch position continuously adjustable between 12mm and 17mm
- Latch position adjustable horizontally between -3mm and +6mm
- Latch bolt lock can be adjusted vertically in 4mm increments (-4/ 0/ +4/ +8)
- Escape door strike using FaFix®, adjustable by 2mm (0.5 mm increments)

Characteristics of standard guide rail G193:

- Height-adjustable by 2mm for tolerance
- Concealed fastening screws

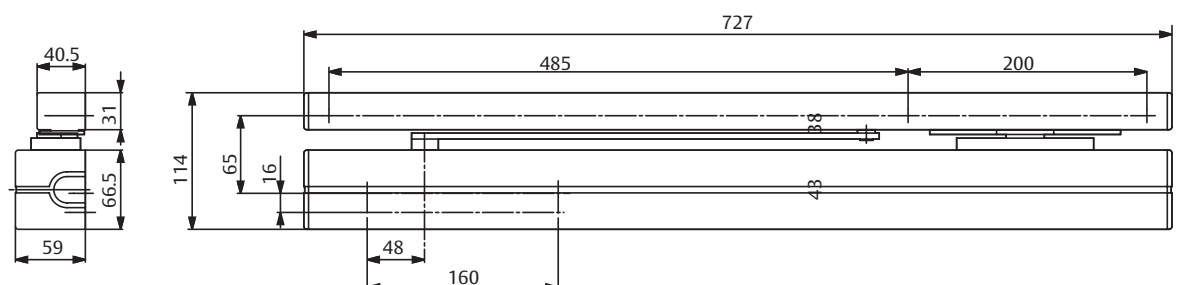

Door Closer

Technical details for DC700G-FT

Technical details:

Adjustable closing force	EN 3-6
Door width up to	850mm - 1200mm
Fire and smoke protection	Yes
Door swing directions	Left / right handed
Standard and frame installation	Yes
Closing speed	Variable between 170°-15°
Latching speed	Variable between 15°-0°
Back-check	Variable above 75°
Opening angle hinge side	ca. 170°
In compliance with	EN1154
CE marking for building products	Yes
Mounting plate dimensions	See dimensional drawings
Dimensions of guide rail	See dimensional drawings

Escape door strike:

Holding force	2000N
Rated voltage	12 V DC / 24 V DC
Rated current	190 mA / 12 V; 95 mA / 24 V
Rated operational voltage tolerance	+/- 10 %
Operating temperature range	-15 °C to +40 °C
Switching capacity - monitoring contact	24V, 1 A
Armature contact not potential-free	Yes
Free wheeling diode	Yes
In compliance with	EltVTR
Approved system in compliance with EltVTR	Escape route controller

Door Closer

Specifications for DC700G-FT

Specifications for DC700G-FT:

ASSA ABLOY Door Closer with Cam Motion technology; extended mounting plate and integrated latch bolt lock, guide rail with integrated escape door strike 332, 24V DC. End-to-end protective cover for door closers and guide rails; suitable for retrofitting to fire doors with guide rail door closers and for fastening using drilling template according to EN1154, Supplementary Sheet 1:2003-11;

- Closing force continuously adjustable, size EN3-6
- Door closer approved in line with EN1154, with CE mark
- Escape door strike tested in compliance with the German guidelines for electrical locking systems for doors along escape routes
- Closing speed, latching speed and back-check continuously adjustable
- Suitable for fire and smoke protection doors
- Recommended door width: at least 850mm - max. 1,200mm
- Latch position continuously adjustable between 12mm and 17mm
- Latch position adjustable horizontally between -3mm and +6mm
- Latch bolt lock can be adjusted vertically in 4mm increments (-4/ 0/ +4/ +8)
- Escape door strike using FaFix®, adjustable by 2mm
- Suitable for left and right-handed doors
- Standard installation on hinge side

Door Closer

Dimensional drawings for DC700G-FT

Space required on doors for standard mounting on hinge side

Left handed shown in diagram, Right handed is the reverse.

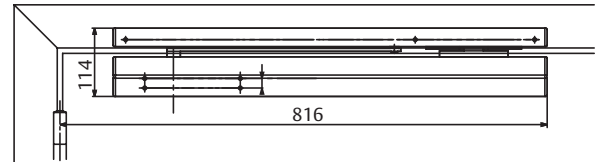
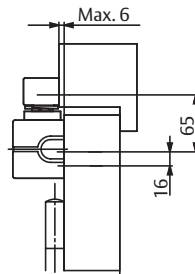

Installation dimensions in compliance with EN 1154 Supplementary Sheet 1; standard hinge-side mounting

Left handed shown in diagram, Right handed is the reverse.

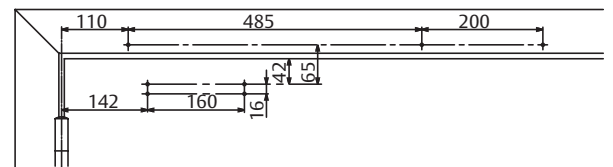

Accessories:

- 5 mm Spacer Plate (narrow rebate) DCFA01
- 15 mm Spacer Plate (wide rebate) DCFA02
- Replacement plate, 5 mm, for Drilling Template DCFA03
- Replacement plate, 15 mm, for External Drilling Template DCFA04
- Mounting plate, 5 mm, for Narrow Frame DCFA05
- Mounting replacement plate, 15 mm, for Narrow Frame DCFA06

Colour:

- Silver EV1

Notice:

The positions of the locking components on the guide rail and mounting plate are designed in such a way that escape door strikes and latch bolt are correctly aligned when installed in a flush position (flush-fitted doors). Adjustment option on electric strike (FaFix®) of +/- 1 mm and latch bolt lock of +6/-3 mm mean that smaller differences in measurements can be compensated for.

In case of doors with an overlapping door leaf (narrow or wide rebate), the following spacer plates must be used to ensure that the guide rail and mounting plate are in a flush position when on top of one another.

Door Closer
Accessories for DC700G-FT

Spacer Plate DCFA01:

For shimming guide rails over ASSA ABLOY drilling pattern. For use on narrow-rebate doors with a max. door leaf overlap of 8mm.

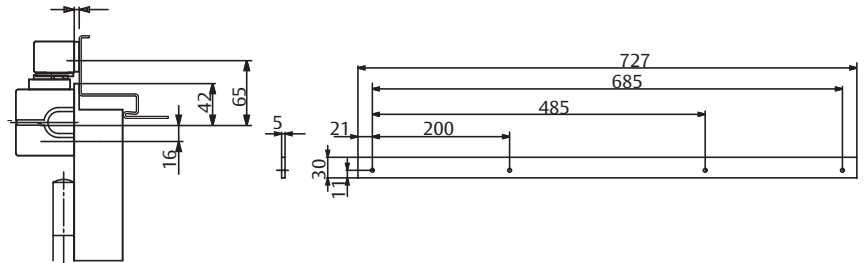

Spacer Plate DCFA02:

For shimming guide rails over ASSA ABLOY drilling pattern. For use on narrow-rebate doors with a max. door leaf overlap of 18mm.

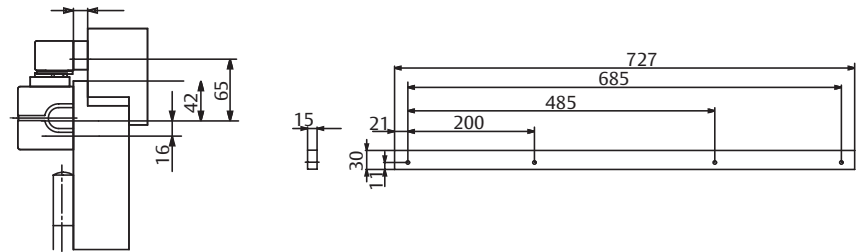

Replacement Plate DCFA03:

For mounting guide rail over existing drill holes from other manufacturers, for flush-fit doors and narrow rebate doors with door leaf overlap up to 8mm.

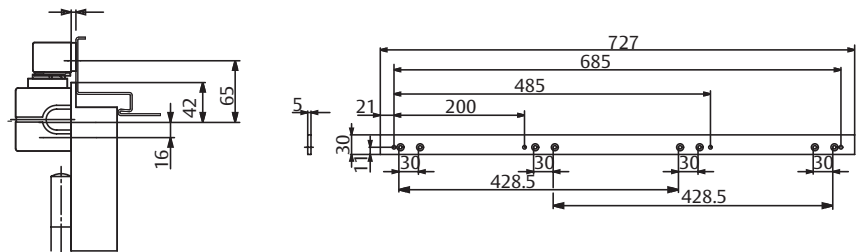

Replacement Plate DCFA04:

For mounting guide rail over existing drill holes from other manufacturers. For flush-fit doors and narrow rebate doors with door leaf overlap up to 18mm.

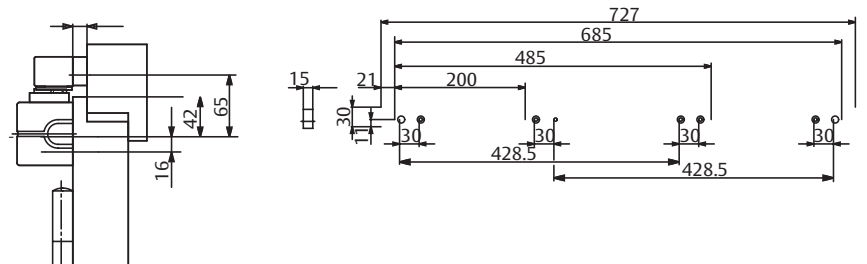

Door Closer

Accessories for DC700G-FT

Spacer Plate DCFA05:

Mounting plate for narrow frames. For mounting over ASSA ABLOY drilling pattern and over existing drill holes from other manufacturers when the guide rail is replaced. For use on wide-rebate doors with a max. door leaf overlap of 8mm.

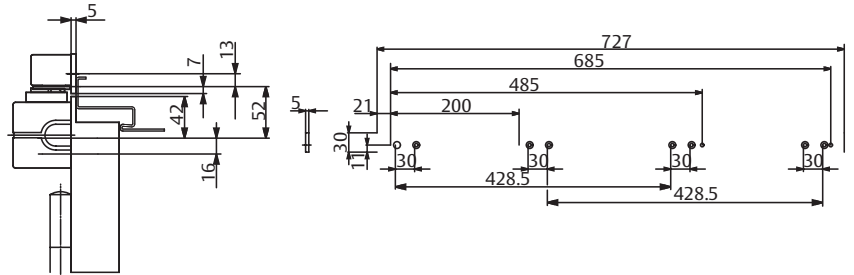

Spacer Plate DCFA06:

Mounting plate for narrow frames. For mounting over ASSA ABLOY drilling pattern and over existing drill holes from other manufacturers when the guide rail is replaced. For use on wide-rebate doors with a max. door leaf overlap of 18mm.

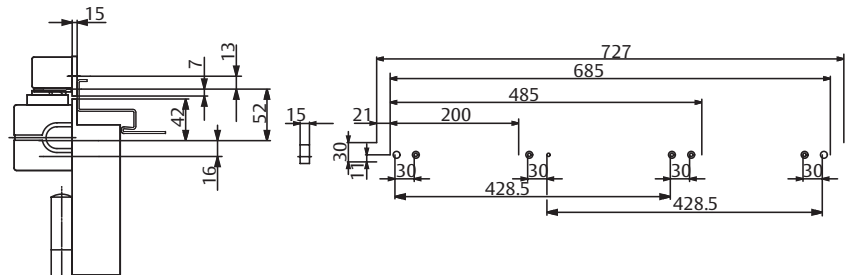

Door Closer - Concealed DC860

Door Closer

DC860 Cam Motion

ASSA ABLOY DC860

- Concealed door closer with Cam Motion technology and small standard concealed guide rail G892 or standard concealed guide rail G893
- Fulfils barrier-free building requirements (DDA/ CEN TR 15894)
- Certified in compliance with EN1154, size EN1-5
- Suitable for fire and smoke protection doors
- For single action doors up to 1250mm wide



CE	Abloy Oy PO Box 108 80101 Joensuu, Finland	11				
	0432-CPD-0047	EN1154:1996+A1:2002	3	8	5 1	1 1 2



Characteristics of DC860:

- Can be used for left and right-handed doors
- Closing speed, latching speed and back-check adjustable via front facing regulating valves
- Built-in back-check
- Thermodynamic valves for consistent performance.
- Opening angle up to 120°
- Large range of applications
- Versions with 4mm and 8mm spindle extensions
- Standard colours: Silver EV1
- Customized finishes available on request

Characteristics of standard guide rail G892:

- Small size guide rail
- For standard applications
- Available with mechanical hold-open device or opening damper
- Installation dimensions: see diagram

Characteristics for guide rail G893:

- Guide rail suitable for equipping with hold-open device and back-check
- Installation dimensions: see diagram (dimensions in brackets)

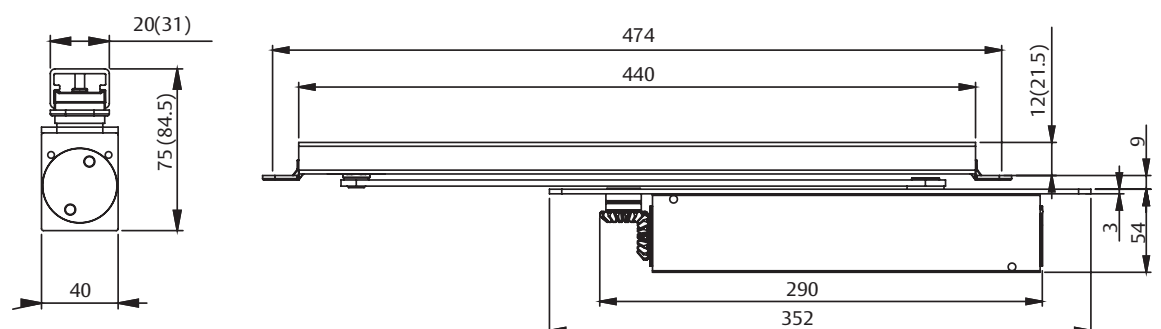

All dimensions are in mm

Door Closer

Technical details for DC860

Technical details:	
Adjustable closing force	EN1-5
Door width up to	1250mm
Fire and smoke protection	Yes
Door swing directions	Left / right handed
Standard and frame installation	Yes
Closing speed	Variable between 120°-7°
Latching speed	Variable between 7°-0°
Opening angle	ca. 120°
Weight	2.3kg
Height	54mm
Depth	40mm
Length	290 mm
In compliance with	EN1154
CE marking for building products	Yes

Our service for you:
Here you can see the individual advantages of our door closer models for your respective fields of business.

The advantages at a glance:	
Customer segment	Advantages
Project planners	<ul style="list-style-type: none"> -Extensive range of uses: Fire and smoke protection doors as well as standard doors -Fulfils barrier-free building requirements (DDA, CEN/TR 15894) -Same dimensions and design with and without mounting plate -Comprehensive functions, standard and optional
Builders	<ul style="list-style-type: none"> -Quick and easy installation and easy adjustable -Suitable for left and right-handed doors -Reduced inventory costs due to modular product range -One single product suitable for a large variety of mounting positions -Complementary accessories available for the whole product range -Easier door opening and improved accessibility due to Cam Motion technology -Largely unaffected by temperature fluctuations due to thermodynamic valves

Door Closer

Dimensional drawings for DC860

Installation dimensions for direct standard mounting on hinge side:

Right-handed door shown in diagram, Left handed door is the reverse.

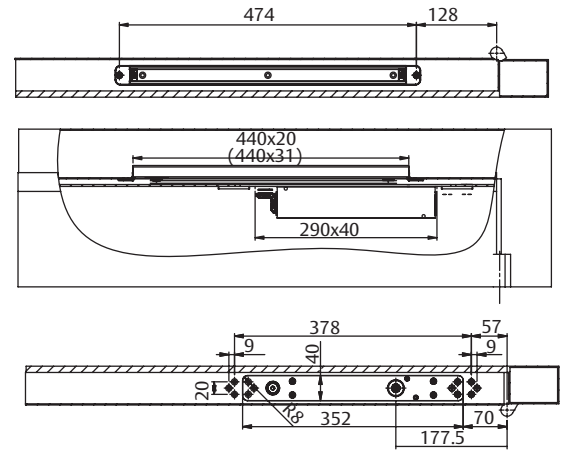
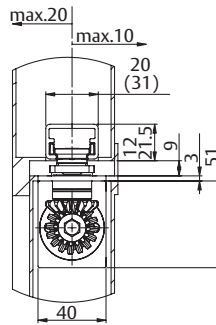

Right-handed door shown in diagram, Left handed door is the reverse.

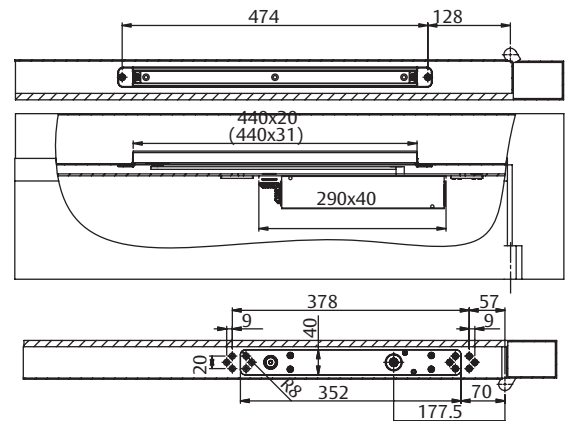
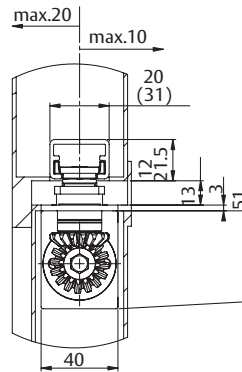

Installation dimensions with 8mm axis extension:

Right-handed door shown in diagram, Left handed door is the reverse.

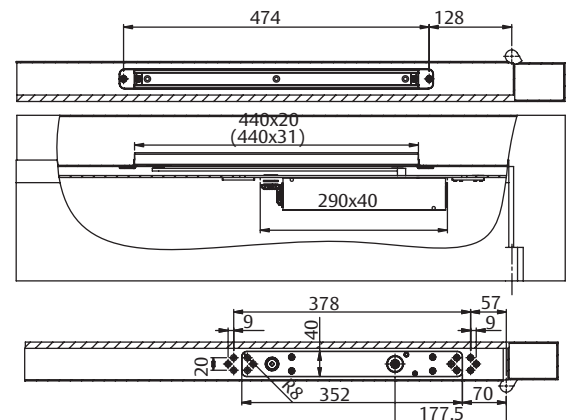
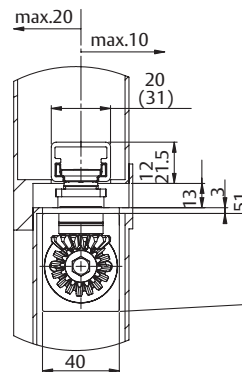

Door Closer

Accessories for DC860

Hold-open device A152:

- Mechanical hold-open device for doors which sometimes need to be secured in the open position
- Simple fitting into guide rail G193 and G195
- Hold open angle max. 130°
- Adjustable hold-open force
- Not approved for use on fire and smoke protection doors

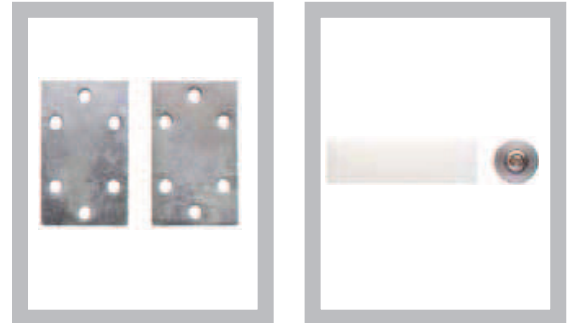

Hold-open device A156:

- For guide rail G892

Opening damper A153:

- Helps to prevent the door and door handle from hitting a return wall
- Simple fitting into guide rail G893, does not replace a door stop
- Adjustable up to an opening angle of 120°



Opening damper A157:

- Helps to prevent the door and door handle from hitting a return wall
- Simple fitting into guide rail G892, does not replace a door stop
- Adjustable up to an opening angle of 120°

Fixing plate A162:

- Mounting plate set for metal doors

Door Closer:

Specifications for DC860

Specifications for DC860 :

ASSA ABLOY Concealed Door Closer DC860 with Cam-Motion technology and concealed guide rail is in compliance with EN1154.

- Closing power continuously adjustable, size EN1-5, for doors up to 1250mm wide
- Closing speed, latching speed and closing force continuously adjustable when installed
- CE approved
- Suitable for left and right-handed doors
- Additional verification of suitability required for fire and smoke protection door

Accessories:

- Small concealed guide rail DC892
- Standard concealed guide rail DC893
- Mechanical hold-open device A152 for G893
- Mechanical hold-open device A156 for G892
- Mechanical opening damper A153 for G893
- Mechanical opening damper A157 for G892
- Fixing plate A162

Colour:

- Silver EV1
- Customized finish

Door Closer

DC860 with G880
Cam Motion

ASSA ABLOY DC860 with G880

- Concealed door closer with Cam-Motion technology and guide rail with electromechanical hold open device for single leaf doors
- Guide rail is in compliance with EN1155, Size EN3-6
- Fulfil barrier-free building requirements (DDA/ CEN TR 15894)
- Hold-open angle continuously adjustable between 80°- 120°
- Suitable for fire and smoke protection doors
- For single action doors up to 1250mm wide

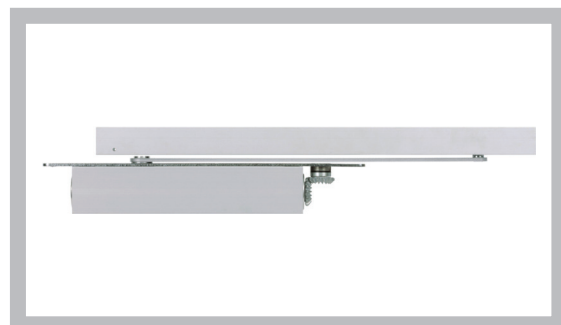

CE	Abloy Oy	10
	PO Box 108 80101 Joensuu, Finland	
0432-BPR-0050	EN1155:1997+A1:2002	3 8 $\frac{6}{3}$ 1 1 0



Characteristics of DC860 with G880:

- Concealed electromechanical hold-open device
- Continuously adjustable holding force
- Hold-open angle continuously adjustable between 80°- 120°
- Can be used for left and right-handed doors
- Closing speed and latching speed adjustable from top via regulating valves
- Built-in back-check
- Thermodynamic valves for consistent performance
- Large range of applications
- Versions with 4mm and 8mm spindle extensions
- Standard colours: Silver EV1
- Customized finishes available on request

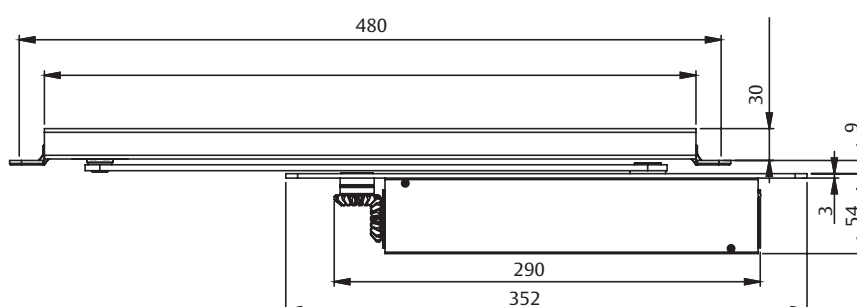
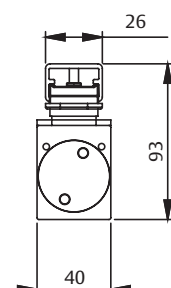

All dimensions are in mm

Door Closer

**Technical details
for DC860 with G880**

Technical details:

Supply voltage	24 V DC
Rated current consumption at 24 V	ca. 60 mA
Continuous duty	100%ED
Hold-open angle (continuously adjustable)	80° - 120°
Weight	30mm
Height	0.9kg
Depth	30mm
Length	26mm
Fire and smoke protection	493mm
In compliance with	EN1155
CE marking for building products	Yes
Facts for door closer	Yes, see DC860

Our service for you:

Here you can see the individual advantages of our door closer models for your respective fields of business.

The advantages at a glance:

Project planners	Advantages
Customer segment	<ul style="list-style-type: none"> - Extensive range of uses: Fire and smoke protection doors as well as standard doors - Fulfils barrier-free building requirements (DDA, CEN/TR 15894) - Comprehensive functions, standard and optional
Builders	<ul style="list-style-type: none"> - Quick and easy installation and easy adjustable - Suitable for left and right-handed doors
Trade	<ul style="list-style-type: none"> - Reduced inventory costs due to modular product range - One single product suitable for a large variety of mounting positions - Complementary accessories available for the whole product range
User	<ul style="list-style-type: none"> - Easier door opening and improved accessibility due to Cam Motion technology - Largely unaffected by temperature fluctuations thanks to thermodynamic valves

Door Closer

Specifications for DC860 with G880

Specifications for DC860 with G880 :

ASSA ABLOY Concealed guide rail with electromechanical hold-open device is used with DC860 concealed Cam Motion door closer.

- Closing force continuously adjustable, size EN1-5, for doors up to 1250mm wide
- Closing speed, latching speed and closing force continuously adjustable when installed
- CE approved
- Can be used for left and right-handed doors
- Hold-open angle continuously adjustable between about 80° and 120°
- Suitable for left and right handed doors
- Adjustable holding force
- Additional verification of suitability required for fire and smoke protection door

Accessories:

- Concealed guide rail G880
- Smoke detector station RZ100
- Ceiling smoke detector ORS 142 / TDS 247
- Smoke protection switch
- Optical smoke detector 60060
- Flush-mounted or surface-mounted release button

Colour:

- Silver EV1
- Customized finish

Door Closer:
Dimensional drawings for DC860 with G880

Installation dimensions for direct standard mounting on Hinge side:

Right-handed door shown in diagram, Left handed door is the reverse.

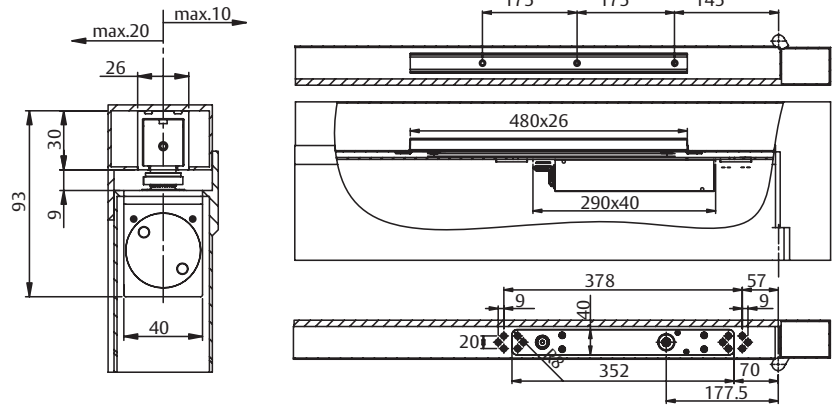

Installation dimensions with 4mm axis extension:

Right-handed door shown in diagram, Left handed door is the reverse.

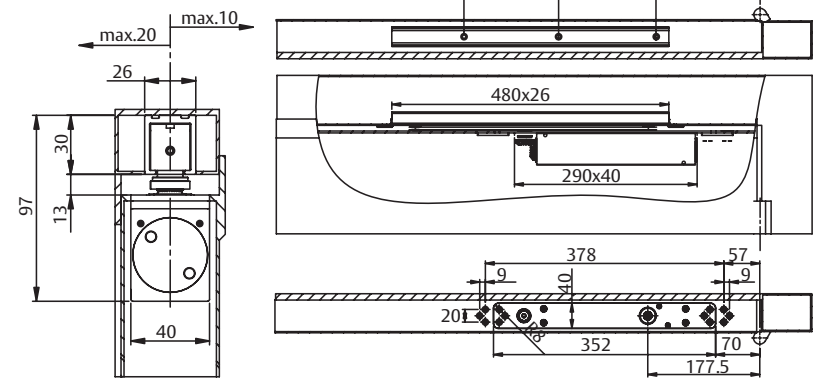

Installation dimensions with 8mm axis extension:

Right-handed door shown in diagram, Left handed door is the reverse.

