

CLCS Range Cell doors

9D001

Police Lambeth Cell Door

Application:

A Chubb Locks Custodial Services Ltd Home Office specification cell door for police cells incorporating a full view 3 position service hatch, hit & miss vertical viewer and Type 1 Chubb 4L55 flush mounted mechanical slam action cell lock with adjustable strike plate. Conforms to the Police Buildings Custody Design Guide and National Police Estates Group Best Practice Document.

Specification:

Specifications, Performance Data & Tolerances

- Conforms to the Police Buildings Custody Design Guide
- Conforms to the National Police Estates Group Best Practice Document
- Gap between Door Leaf and Rebate Maximum 2mm Complies with Home Office Static Load Test
- Gap between Sliding Hatch Plate and Hatch Aperture maximum 0.5mm
- Continuous Hinge Cyclic Tested to a Minimum 1,000,000 cycles and to BS EN 1935 Grade 14 160kg
- Home Office Approved Hit & Miss Vertical Viewer Glass Home Office Type 1 specification Laminated Toughened Glass/Polycarbonate
- Home Office Approved Hatch Tested to a Minimum 400,000 cycles
- Home Office Approved Adjustable Strike Plate 'Bounce' Test pass at Closing Speed 2 metres per sec



Door Frame

- 125x75x8mm Rolled Steel Angle Frame to BS EN 10025:2004
- All Steelwork Shot Blasted to BS EN ISO 11124-4:1997
- 50x25x2mm Rolled Hollow Section Rebates Stainless Steel Grade 304 to BS EN 10088
- All Stainless Steel 180 Grit Dull Polish RA 1.0 – 1.7 EN 1J or 2J
- 75x10mm Flat Steel Threshold Section to BS EN 10025:2004 Cast into Floor
- Steel Fabrication to BS EN ISO 9001: 2000
- Welding to BS EN 1011-2: 2001
- Frame Fixings Hilti HSL-TZ M8/20 CSK Sleeve Anchors 10no. minimum per frame
- Home Office Approved Adjustable Strike Plate ref ARK55

Door Leaf

- 3mm thick Cold Rolled Steel Door Skins Both Sides Electro-Zinc Coated to BS EN 10152:2009
- 3mm thick Cold Rolled Steel Internal Kick Plates to Electro-Zinc Coated to BS EN 10152:2009
- 0.8mm thick Additional Cell Side Door Skin Stainless Steel Grade 304 BA Pattern ref 12LG to BS EN 10088
- 40x40x3mm & 60x40x3mm Internal Rolled Hollow Section Skeleton Framework to BS EN 10025:2004
- Internal Skeleton Framework Shot Blast to BS EN ISO 11124-4:1997
- Steel Fabrication to BS EN ISO 9001: 2000
- Welding to BS EN 1011-2: 2001
- Mineral Wool Insulation RWA45 to all Internal Voids to BS EN 13162:2001
- Ligature Resisting Continuous Hinge either Barrel or Gear Type Capable of Supporting Weight of Door Leaf
- Home Office Approved Hit & Miss Viewer
- Type 1 Chubb 4L55 Flush Mounted Mechanical Slam Action Cell Lock with Ligature-Resisting Handle
- Home Office Approved Full View 3 Position Service Hatch

Standard Dimensions

- Structural Opening 910mm Wide x 2100mm High
- Overall Door Frame 1130mm Wide x 2210mm High (Height From Finished Floor Level as Threshold Cast into Floor)
- Door Leaf 861mm Wide x 2072mm High Excluding Hinge(s) x 47mm Thick
- Frame Clearance 7mm Jamb, 7mm Head
- Door Leaf Clearance 4mm Leading Edge, 15mm hinge, 3mm head, 10mm undercut

Finish:

- Powder Coat Epoxy Primer to BS EN 12206-1:2004

Options:

- Alternative Sizes Available
- Right Hand Open-Out or Left Hand Open-Out (Open-In Not Permitted)
- Polyester Powder Coat Matt 30% Gloss to Any Standard RAL No. to BS EN 12206-1:2004
- Adjustable Rebates 25x25mm Solid Stainless Steel Grade 304 to BS EN 10088
- Home Office Approved 2 Position Service Hatch
- Home Office Approved 2+1 Position Service Hatch
- Hatch Plate Position Contact Switch for Life Signs Monitoring
- Door Position Contact Switch
- Ligature Resisting Gasket Free Circular Viewer with Swivel Cover
- Alternative Chemical Resin Frame Fixings
- Heavy Duty Wall Mounted Door Stop
- Type 1 Chubb 4L56 Surface Mounted Mechanical Slam Action Cell Lock & Surface Mounted Adjustable Strike Plate
- Type 1 Chubb 4L79 Flush Mounted Electro-Mechanical Slam Action Cell Lock with Wired Hinge
- Type 1 Chubb 4A79 ATLAS Flush Mounted Intelligent Electro-Mechanical Slam Action Cell Lock with Wired Hinge

Warranties:

- Defects 12 Months Product Subject to Correct Maintenance and Installation if Applicable Excluding Wilful Damage Caused by Operator or Detainee and Any Paint Decoration & Hardware Supplied by Others if Applicable
- Start Date From Practical Completion on New Build Projects or Installation on Refurbishment/Upgrade Projects
- Extended Warranties Available

CLCS Range

Cell doors

9D001

Police Lambeth Cell Door

Technical Design:

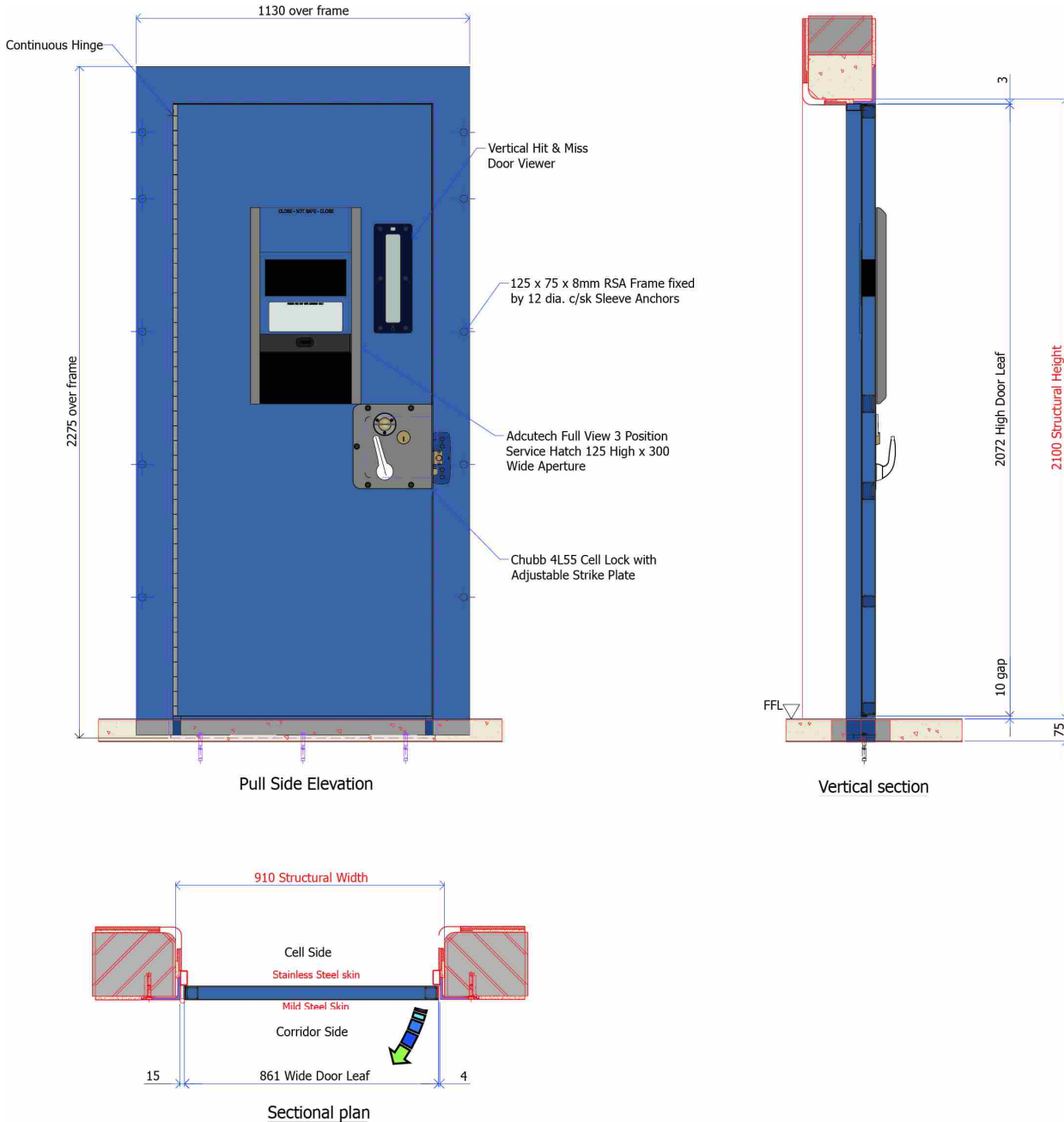

CLCS Range

Cell doors

9D002

Police Vulnerable Detainee Cell Door

Application:

A Chubb Locks Custodial Services Ltd Home Office specification cell door for vulnerable detainee police cells incorporating a 2 position service hatch, large vision panel with sliding cover and Type 1 Chubb 4L55 flush mounted mechanical slam action cell lock with adjustable strike plate. Conforms to the Police Buildings Custody Design Guide and National Police Estates Group Best Practice Document.

Specification:

Specifications, Performance Data & Tolerances

- Conforms to the Police Buildings Custody Design Guide
- Conforms to the National Police Estates Group Best Practice Document
- Gap between Door Leaf and Rebate Maximum 2mm Complies with Home Office Static Load Test
- Gap between Sliding Hatch Plate and Hatch Aperture maximum 0.5mm
- Continuous Hinge Cyclic Tested to a Minimum 1,000,000 cycles min and to BS EN 1935 Grade 14 160kg
- Home Office Approved Glass Home Office Type 1 specification Laminated Toughened Glass/Polycarbonate
- Home Office Approved Hatch Tested to a Minimum 400,000 cycles
- Home Office Approved Adjustable Strike Plate 'Bounce' Test pass at Closing Speed 2 metres per sec



Door Frame

- 125x75x8mm Rolled Steel Angle Frame to BS EN 10025:2004
- All Steelwork Shot Blasted to BS EN ISO 11124-4:1997
- 50x25x2mm Rolled Hollow Section Rebates Stainless Steel Grade 304 to BS EN 10088
- All Stainless Steel 180 Grit Dull Polish RA 1.0 – 1.7 EN 1J or 2J
- 75x10mm Flat Steel Threshold Section to BS EN 10025:2004 Cast into Floor
- Steel Fabrication to BS EN ISO 9001: 2000
- Welding to BS EN 1011-2: 2001
- Frame Fixings Hilti HSL-TZ M8/20 CSK Sleeve Anchors 10no. minimum per frame
- Home Office Approved Adjustable Strike Plate ref ARK55

Door Leaf

- 3mm thick Cold Rolled Steel Door Skin Corridor Side Electro-Zinc Coated to BS EN 10152:2009
- 3mm thick Stainless Steel Cell Side Door Skin Grade 304 to BS EN 10088
- Stainless Steel Door Skin 180 Grit Dull Polish RA 1.0 – 1.7 EN 1J or 2J
- 40x40x3mm & 60x40x3mm Internal Rolled Hollow Section Skeleton Framework to BS EN 10025:2004
- Internal Skeleton Framework Shot Blast to BS EN ISO 11124-4:1997
- Steel Fabrication to BS EN ISO 9001: 2000
- Welding to BS EN 1011-2: 2001
- Mineral Wool Insulation RWA45 to all Internal Voids to BS EN 13162:2001
- Ligature Resisting Continuous Hinge either Barrel or Gear Type Capable of Supporting Weight of Door Leaf
- Home Office Approved Vision Panel with Sliding Privacy Cover & Hit & Miss Viewer
- Type 1 Chubb 4L55 Flush Mounted Mechanical Slam Action Cell Lock with Ligature-Resisting Handle
- Home Office Approved 2 Position Service Hatch
- Heavy Duty Rubber Door Stops to Protect Vision Panel Sliding Cover

Standard Dimensions

- Structural Opening 910mm Wide x 2100mm High
- Overall Door Frame 1130mm Wide x 2210mm High (Height From Finished Floor Level as Threshold Cast into Floor)
- Door Leaf 861mm Wide x 2072mm High Excluding Hinge(s) x 46mm Thick
- Frame Clearance 7mm Jamb, 7mm Head
- Door Leaf Clearance 4mm Leading Edge, 15mm hinge, 3mm head, 10mm undercut

CLCS Range

Cell doors

9D002

Police Vulnerable Detainee Cell Door

Finish:

- Mild Steel Powder Coat Epoxy Primer to BS EN 12206-1:2004
- Stainless Steel Dull Grit Satin Polished Unpainted

Options:

- Alternative Sizes Available
- Right Hand Open-Out or Left Hand Open-Out (Open-In Not Permitted)
- Polyester Powder Coat Matt 30% Gloss to Any Standard RAL No. to BS EN 12206-1:2004
- Adjustable Rebates 25x25mm Solid Stainless Steel Grade 304 to BS EN 10088
- Hatch Plate Position Contact Switch for Life Signs Monitoring
- Door Position Contact Switch
- Alternative Chemical Resin Frame Fixings
- Type 1 Chubb 4L56 Surface Mounted Mechanical Slam Action Cell Lock & Surface Mounted Adjustable Strike
- Type 1 Chubb 4L79 Flush Mounted Electro-Mechanical Slam Action Cell Lock with Wired Hinge
- Type 1 Chubb 4A79 ATLAS Flush Mounted Intelligent Electro-Mechanical Slam Action Cell Lock with Wired Hinge

Warranties:

- Defects 12 Months Product Subject to Correct Maintenance and Installation if Applicable Excluding Wilful Damage Caused by Operator or Detainee and Any Paint Decoration & Hardware Supplied by Others if Applicable
- Start Date From Practical Completion on New Build Projects or Installation on Refurbishment/Upgrade Projects
- Extended Warranties Available

CLCS Range Cell doors

9D002

Police Vulnerable Detainee Cell Door

Technical Design:

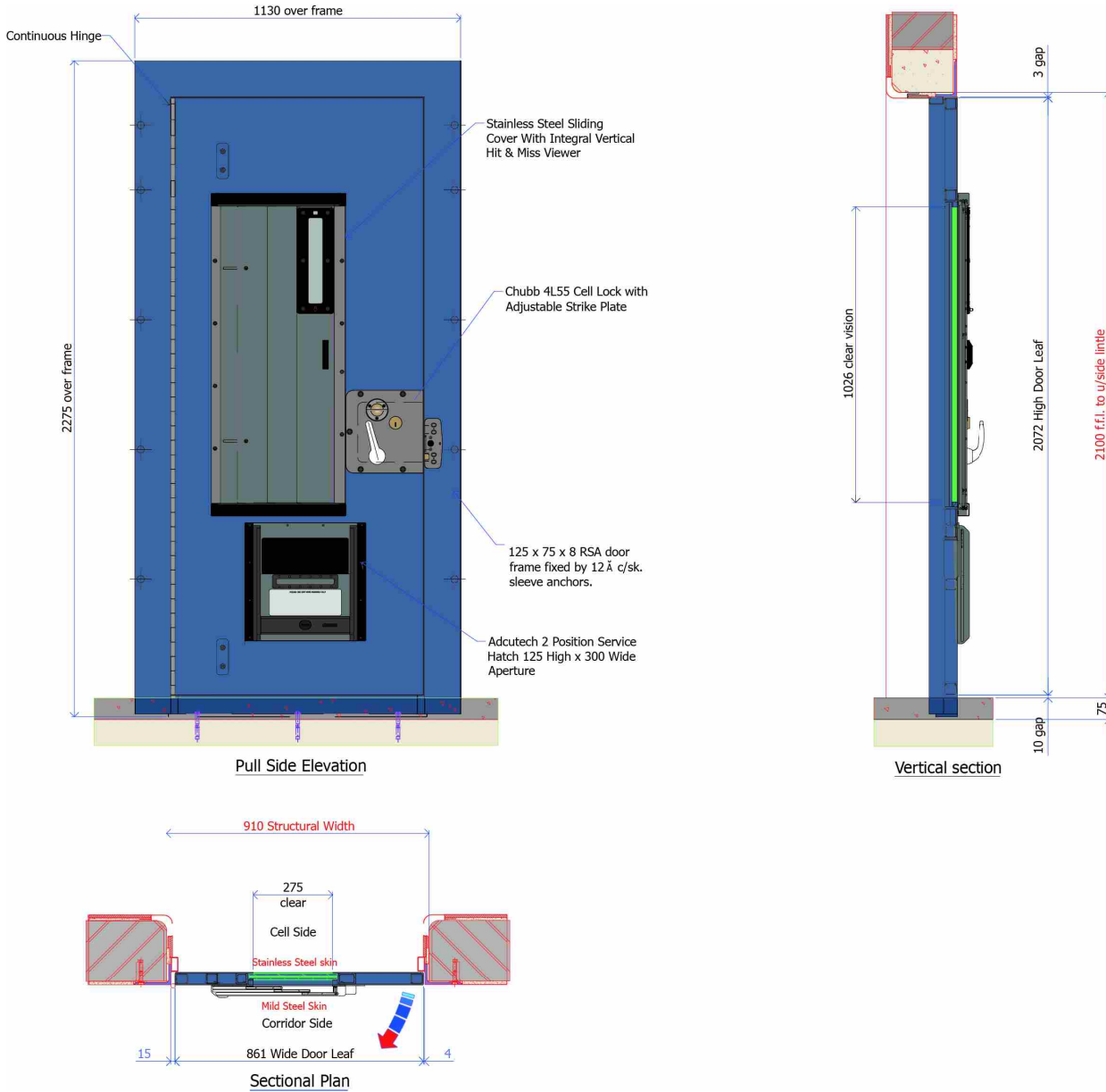

Application:

A Chubb Locks Custodial Services Ltd observation cell door with two large vision panels of Home Office Type 1 specification laminated toughened glass/polycarbonate for maximum visibility, Type 1 Chubb 4L55 slam action cell lock with adjustable strike plate and continuous hinge.

Specification:

Specifications, Performance Data & Tolerances

- Glazing Gasket Holding Room Side 1.5mm Maximum and Double Sided Adhesive to Prevent Pick
- Continuous Hinge Cyclic Tested to a Minimum 1,000,000 cycles min and to BS EN 1935 Grade 14 160kg
- Home Office Approved Glazing Type 1 specification Laminated Toughened Glass/Polycarbonate

Door Frame

- 125x75x8mm Rolled Steel Angle Frame to BS EN 10025:2004
- All Steelwork Shot Blasted to BS EN ISO 11124-4:1997
- 50x25x3mm Rolled Hollow Section Steel Rebates to BS EN 10025:2004
- 75x10mm Flat Steel Threshold Section to BS EN 10025:2004 Cast into Floor
- Steel Fabrication to BS EN ISO 9001: 2000
- Welding to BS EN 1011-2: 2001
- Frame Fixings Hilti HSL-TZ M8/20 CSK Sleeve Anchors 10no. minimum per frame
- Home Office Approved Adjustable Strike Plate ref ARK55

Door Leaf

- 3mm thick Cold Rolled Steel Door Skins Both Sides Electro-Zinc Coated to BS EN 10152:2009
- 40x40x3mm & 60x40x3mm Internal Rolled Hollow Section Skeleton Framework to BS EN 10025:2004
- Internal Skeleton Framework Shot Blast to BS EN ISO 11124-4:1997
- Steel Fabrication to BS EN ISO 9001: 2000
- Welding to BS EN 1011-2: 2001
- Mineral Wool Insulation RWA45 to all Internal Voids to BS EN 13162:2001
- Ligature Resisting Continuous Hinge either Barrel or Gear Type Capable of Supporting Weight of Door Leaf
- Home Office Approved Glazing Type 1 specification Laminated Toughened Glass/Polycarbonate
- Glazing Frames External fixed with CSK Torx/Hex Resist Screws Stainless Steel Grade A2
- Type 1 Chubb 4L55 Flush Mounted Mechanical Slam Action Cell Lock with Ligature-Resisting Handle

Standard Dimensions

- Structural Opening 910mm Wide x 2100mm High
- Overall Door Frame 1130mm Wide x 2210mm High (Height From Finished Floor Level as Threshold Cast into Floor)
- Door Leaf 861mm Wide x 2072mm High Excluding Hinge(s) x 46mm Thick
- Frame Clearance 7mm Jambs, 7mm Head
- Door Leaf Clearance 4mm Leading Edge, 15mm hinge, 3mm head, 10mm undercut

Finish:

- Powder Coat Epoxy Primer to BS EN 12206-1:2004

Options:

- Alternative Sizes Available
- Right Hand Open-Out or Left Hand Open-Out (Open-In Not Permitted)
- Polyester Powder Coat Matt 30% Gloss to Any Standard RAL No. to BS EN 12206-1:2004
- Polished Stainless Steel Internal Door/Side panel Skins Grade 304 to BS EN 10088
- Adjustable Rebates 25x25mm Solid Stainless Steel Grade 304 to BS EN 10088
- 50x25mm Rolled Hollow Section Rebates Stainless Steel Grade 304 to BS EN 10088 Satin Polished
- Intelligent Electronic Privacy Glass Glazing in conjunction with Home Office Type 1 specification Laminated Toughened
- Glass/Polycarbonate
- Door Position Contact Switch
- Alternative Chemical Resin Frame Fixings
- Heavy Duty Wall/Floor Mounted Door Stop
- Type 2 Chubb 3G112 Heavy Duty Mortice Deadlock
- Type 2 Chubb 3G112 Monitored Lock with Wired Hinge
- Type 1 Chubb 4L79 Flush Mounted Electro-Mechanical Slam Action Cell Lock with Wired Hinge
- Type 1 Chubb 4A79 ATLAS Flush Mounted Intelligent Electro-Mechanical Slam Action Cell Lock with Wired Hinge

Warranties:

- Defects 12 Months Product Subject to Correct Maintenance and Installation if Applicable Excluding Wilful Damage Caused by Operator or Detainee and Any Paint Decoration & Hardware Supplied by Others if Applicable
- Start Date From Practical Completion on New Build Projects or Installation on Refurbishment/Upgrade Projects
- Extended Warranties Available

CLCS Range Cell doors 9D003 Observation Cell Door

Technical Design:

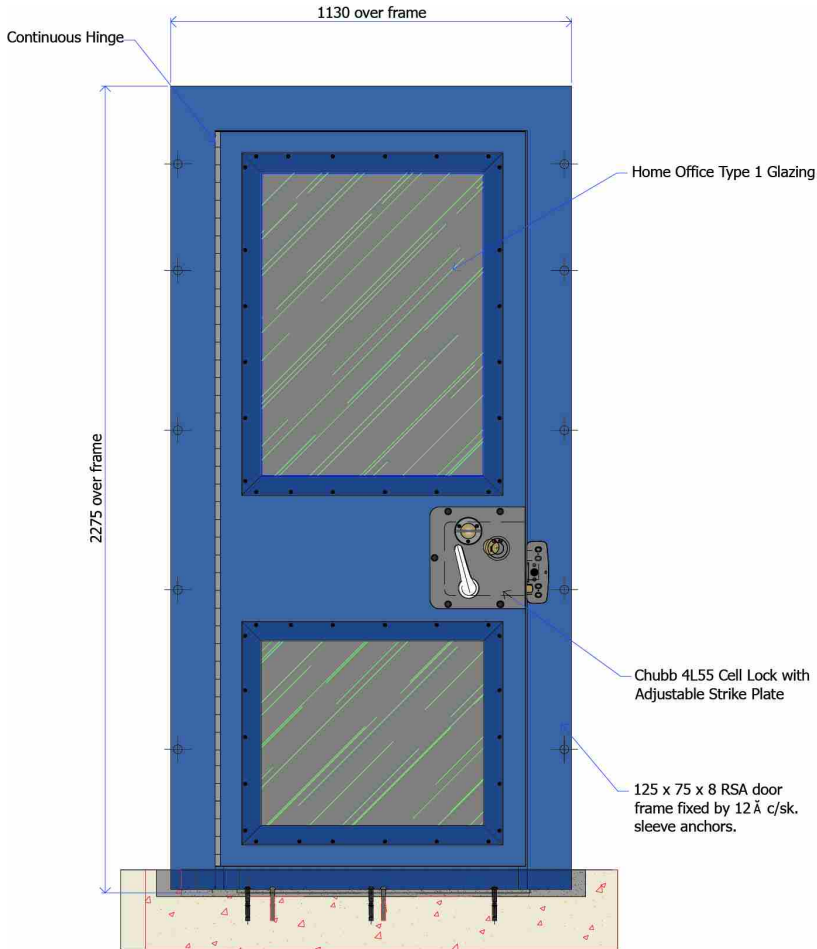

Pull Side Elevation

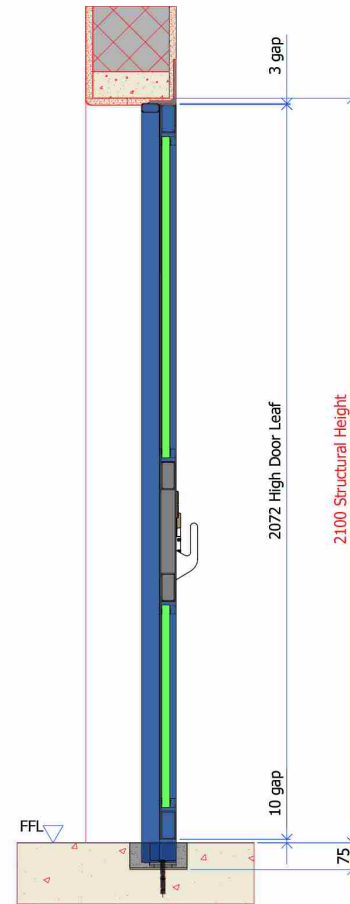

Vertical section

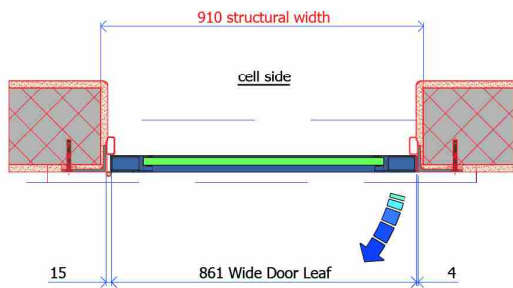

Sectional Plan

CLCS Range Cell doors

9D004

Police Holding Room Door

Application:

A Chubb Locks Custodial Services Ltd Home Office specification door for police holding rooms incorporating a 150mm square laminated glass vision panel with privacy cover, recessed pull handle and Type 2 Chubb 3G112 heavy duty mortice deadlock. Conforms to the Police Buildings Custody Design Guide and National Police Estates Group Best Practice Document.

Specification:

Specifications, Performance Data & Tolerances

- Conforms to the Police Buildings Custody Design Guide
- Conforms to the National Police Estates Group Best Practice Document
- Gap between Door Leaf and Rebate Maximum 2mm Complies with Home Office Static Load Test
- Continuous Hinge Cyclic Tested to a Minimum 1,000,000 cycles min and to BS EN 1935 Grade 14 160kg
- Home Office Approved Glass Home Type 1 specification Laminated Toughened Glass/Polycarbonate



Door Frame

- 125x75x8mm Rolled Steel Angle Frame to BS EN 10025:2004
- 25x25x3mm Rolled Hollow Section Steel Rebates to BS EN 10025:2004
- All Steelwork Shot Blasted to BS EN ISO 11124-4:1997
- 75x10mm Flat Steel Threshold Section to BS EN 10025:2004 Cast into Floor
- Steel Fabrication to BS EN ISO 9001: 2000
- Welding to BS EN 1011-2: 2001
- Frame Fixings Hilti HSL-TZ M8/20 CSK Sleeve Anchors 10no. minimum per frame

Door Leaf

- 1.6mm thick Cold Rolled Steel Door Skins Both Sides & All Edges Hot Dip Zinc Coated to BS EN 10346:2009
- 44mm thick Solid Timber Door Core Mixed Tropical 3 Layer Lamels Hardwood Rails & Stiles
- Door Core Density 460 – 500kg/m³
- Heat Pressure Bonded 80C @ 500lbs/in² for 7mins
- Adhesive Apollo A9267 PU
- Ligature Resisting Continuous Hinge either Barrel or Gear Type Capable of Supporting Weight of Door Leaf
- 150mm Square Laminated Glass & Polycarbonate Vision Panel with Hinged Steel Privacy Cover
- Type 2 Chubb 3G112 Heavy Duty Mortice Lock Operable Corridor Side Only
- Recessed Pull Handle Corridor Side Cast Stainless Steel Grade 304

Standard Dimensions

- Structural Opening 910mm Wide x 2100mm High
- Overall Door Frame 1130mm Wide x 2210mm High (Height From Finished Floor Level as Threshold Cast into Floor)
- Door Leaf 861mm Wide x 2072mm High Excluding Hinge(s) x 46mm Thick
- Frame Clearance 7mm Jamb, 7mm Head
- Door Leaf Clearance 4mm Leading Edge, 15mm hinge, 3mm head, 10mm undercut

Finish:

- Powder Coat Epoxy Primer to BS EN 12206-1:2004

CLCS Range

Cell doors

9D004

Police Holding Room Door

Options:

- Alternative Sizes Available
- Right Hand Open-Out or Left Hand Open-Out (Open-In Not Permitted)
- Polyester Powder Coat Matt 30% Gloss to Any Standard RAL No. to BS EN 12206-1:2004
- Adjustable Rebates 25x25mm Solid Stainless Steel Grade 304 to BS EN 10088
- 50x25x2mm Rolled Hollow Section Rebates Stainless Steel Grade 304 to BS EN 10088
- 1.6mm thick Polished Stainless Steel Cell Side Door Skin Grade 304 to BS EN 10088
- Door Position Contact Switch
- Home Office Approved Hit & Miss Viewer
- Ligature Resisting Gasket Free Circular Viewer with Swivel Cover
- Alternative Chemical Resin Frame Fixings
- Heavy Duty Wall Mounted Door Stop
- Type 2 Chubb 3G112 Monitored Lock with Wired Hinge

Warranties:

- Defects 12 Months Product Subject to Correct Maintenance and Installation if Applicable Excluding Wilful Damage Caused by Operator or Detainee and Any Paint Decoration & Hardware Supplied by Others if Applicable
- Start Date From Practical Completion on New Build Projects or Installation on Refurbishment/Upgrade Projects
- Extended Warranties Available

CLCS Range

Cell doors

9D004

Police Holding Room Door

Technical Design:

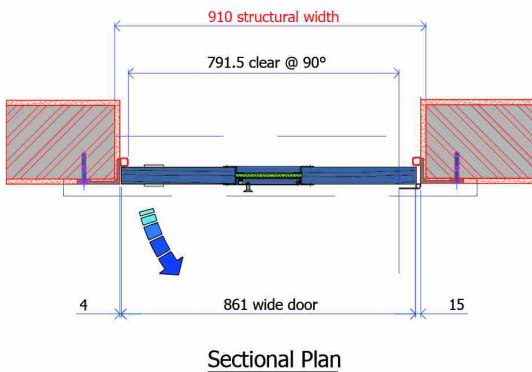
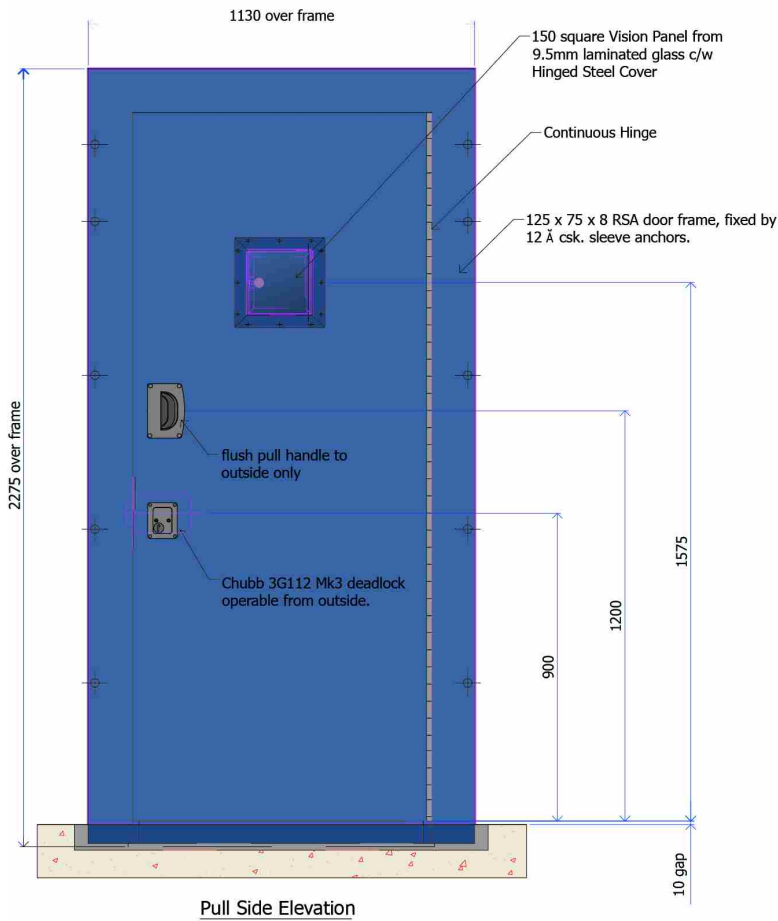

CLCS Range

Cell doors

9D005

Holding Room Screen

Application:

A Chubb Locks Custodial Services Ltd holding room screen based on typical Home Office specifications for secure doors & glazing for holding areas within police station charge areas. Incorporating large areas of Home Office Type 1 specification Laminated Toughened Glass/Polycarbonate, recessed pull handle and Type 2 Chubb 3G112 heavy duty mortice deadlock. Any size/configuration of panels can be provided.



Specification:

Specifications, Performance Data & Tolerances

- Glazing Gasket Holding Room Side 1.5mm Maximum and Double Sided Adhesive to Prevent Pick
- Continuous Hinge Cyclic Tested to a Minimum 1,000,000 cycles min and to BS EN 1935 Grade 14 160kg
- Home Office Approved Glazing Type 1 specification Laminated Toughened Glass/Polycarbonate

Door Frame

- 100x60x4mm Hot Formed Rolled Hollow Section Steel Frame to BS EN 10025:2004
- 40x20mm Solid Section Steel Rebates to BS EN 10025:2004
- 75x10mm Flat Steel Threshold Section to BS EN 10025:2004 Cast into Floor
- All Steelwork Shot Blasted to BS EN ISO 11124-4:1997
- Steel Fabrication to BS EN ISO 9001: 2000
- Welding to BS EN 1011-2: 2001
- Frame Fixings Hilti HSL-TZ M8/20 Sleeve Anchors 12no. minimum per frame

Door Leaf/Side Panels

- 3mm thick Cold Rolled Steel Door Skins Both Sides Electro-Zinc Coated to BS EN 10152:2009
- 40x40x3mm & 60x40x3mm Internal Rolled Hollow Section Skeleton Framework to BS EN 10025:2004
- Internal Skeleton Framework Shot Blast to BS EN ISO 11124-4:1997
- Steel Fabrication to BS EN ISO 9001: 2000
- Welding to BS EN 1011-2: 2001
- Mineral Wool Insulation RWA45 to all Internal Voids to BS EN 13162:2001
- Ligature Resisting Continuous Hinge either Barrel or Gear Type Capable of Supporting Weight of Door Leaf
- Home Office Approved Glazing Type 1 specification Laminated Toughened Glass/Polycarbonate
- Glazing Frames External fixed with CSK Torx/Hex Resist Screws Stainless Steel Grade A2
- Type 2 Chubb 3G112 Heavy Duty Mortice Deadlock Operable Corridor Side only
- Recessed Pull Handle Corridor Side Stainless Steel Grade 304

Standard Dimensions

- Structural Opening 2500mm Wide x 2100mm High
- Overall Door Frame 2486mm Wide x 2093mm High (Height From Finished Floor Level as Threshold Cast into Floor)
- Door Leaf 771mm Wide x 2020mm High Excluding Hinge(s) x 46mm Thick
- Door Leaf Frame 910mm Wide x 2486mm High Overall from FFL
- Side Panels 788mm Wide x 2093mm High x 46mm Thick Including Frame
- Frame Clearance 7mm Jamb, 7mm Head
- Door Leaf Clearance 4mm Leading Edge, 15mm hinge, 3mm head, 10mm undercut

Finish:

- Powder Coat Epoxy Primer to BS EN 12206-1:2004

CLCS Range

Cell doors

9D005

Holding Room Screen

Options:

- Alternative Sizes Available
- Right Hand Open-Out or Left Hand Open-Out (Open-In Not Permitted)
- Polyester Powder Coat Matt 30% Gloss to Any Standard RAL No. to BS EN 12206-1:2004
- Polished Stainless Steel Internal Door/Side panel Skins Grade 304 to BS EN 10088
- Adjustable Rebates 25x25mm Solid Stainless Steel Grade 304 to BS EN 10088
- 40x20mm Solid Rebates Stainless Steel Grade 304 to BS EN 10088 Satin Polished
- Intelligent Electronic Privacy Glass Glazing in conjunction with Home Office Type 1 specification Laminated Toughened Glass/Polycarbonate
- Door Position Contact Switch
- Alternative Chemical Resin Frame Fixings
- Heavy Duty Wall/Floor Mounted Door Stop
- Electric Strike for Access Control used with the Chubb 3G112 Lock
- Type 2 Chubb 3G112 Monitored Lock with Wired Hinge
- Type 1 Chubb 4L55 Flush Mounted Mechanical Slam Action Cell Lock & Flush Mounted Adjustable Strike Plate
- Type 1 Chubb 4L79 Flush Mounted Electro-Mechanical Slam Action Cell Lock with Wired Hinge
- Type 1 Chubb 4A79 ATLAS Flush Mounted Intelligent Electro-Mechanical Slam Action Cell Lock with Wired Hinge

Warranties:

- Defects 12 Months Product Subject to Correct Maintenance and Installation if Applicable Excluding Wilful Damage Caused by Operator or Detainee and Any Paint Decoration & Hardware Supplied by Others if Applicable
- Start Date From Practical Completion on New Build Projects or Installation on Refurbishment/Upgrade Projects
- Extended Warranties Available

CLCS Range Cell doors 9D005 Holding Room Screen

Technical Design:

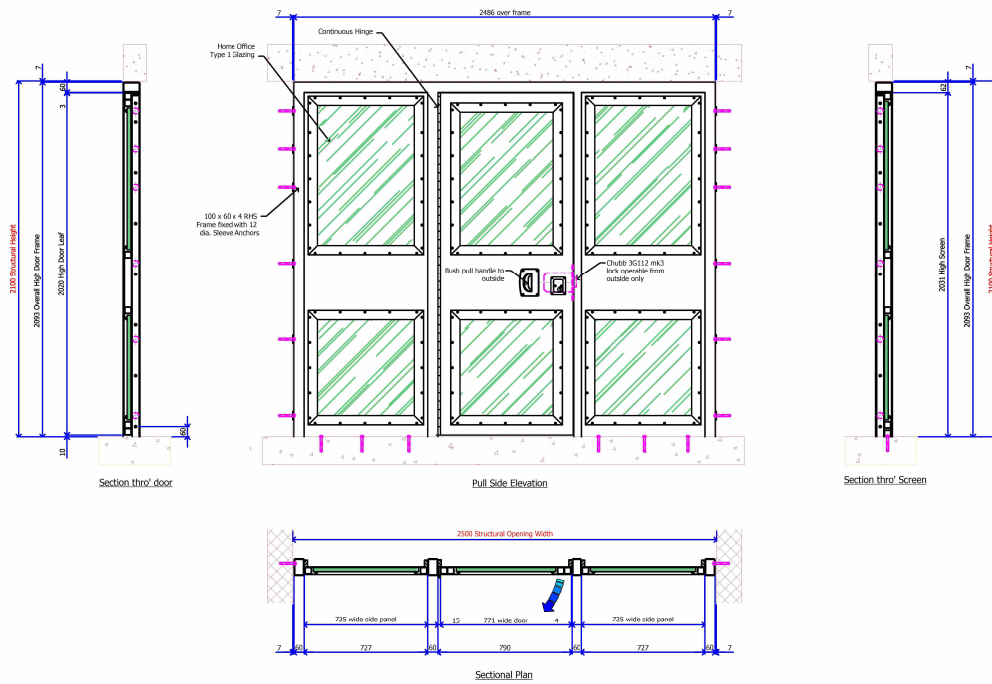

Application:

A Chubb Locks Custodial Services Ltd HMPS specification cell door for court cells incorporating a vision panel with privacy cover and preparation for a Type 3 Chubb 3R47 mortice locking latch. Conforms to the Court Standards & Design Guide and standards & specifications required by the Prison Service.

Specification:

Specifications, Performance Data & Tolerances

- Conforms to the Court Standards & Design Guide
- Conforms to the standards & specifications required by the Prison Service

Door Frame

- 100x100x4mm Hot Rolled Hollow Section Steel Frame to BS EN 10025:2004
- 12x12 Solid Steel Section Rebates BS EN 10025:2004
- All Steelwork Shot Blasted to BS EN ISO 11124-4:1997
- 4mm Pressed Steel Threshold Section Electro-Zinc Coated to BS EN 10152:2009 Cast into Floor
- Frame Fixing Cleats 100x65x8mm Rolled Steel Angle to BS EN 10025:2004 6no.minimum per frame
- Steel Fabrication to BS EN ISO 9001: 2000
- Welding to BS EN 1011-2: 2001
- Frame Fixings M12 x 250 Chemical Resin Stud Anchors 12no.minimum per frame

Door Leaf

- 1.6mm thick Cold Rolled Steel Door Skins Both Sides Hot Dip Zinc Coated to BS EN 10346:2009
- 4mm thick Cold Rolled Steel Internal Kick Plates to Electro-Zinc Coated to BS EN 10152:2009
- 38x19x2mm Internal ERW Rectangular Steel Tube Skeleton Framework to BS EN 10305-3/5 Grade E220
- Internal Skeleton Framework Shot Blast to BS EN ISO 11124-4:1997
- Steel Fabrication to BS EN ISO 9001: 2000
- Welding to BS EN 1011-2: 2001
- Mineral Wool Insulation RWA40 to all Internal Voids to BS EN 13162:2001
- Tubular Pivot Hinge Full Length of Door Leaf as HMPS Specification
- Laminated Glass Vision Panel with Hinged Privacy Cover as HMPS Specification
- Preparation for Type 3 Chubb 3R47 Mortice Locking Latch
- Outer Steel Lock Box Enclosure Included as Part of Internal framework Skeleton

Standard Dimensions

- Structural Opening 870mm Wide x 2062mm High
- Overall Door Frame 845mm Wide x 2049.5mm High (Height From Finished Floor Level as Threshold Cast into Floor)
- Door Leaf 618mm Wide CL Hinge Tube x 1936.5mm High x 42mm Thick
- Frame Clearance 12.5mm Jambs, 12.5mm Head
- Door Leaf Clearance 3mm Leading Edge, 3mm head, 10mm undercut

Finish:

- Powder Coat Epoxy Primer to BS EN 12206-1:2004

CLCS Range

Cell doors

9D006

Court Cell Door

Options:

- 1125mm Structural Opening Width for Disabled Cells
- Alternative Sizes Available
- Right Hand Open-In or Left Hand Open-In (Open-Out Not Standard Specification)
- Polyester Powder Coat Matt 30% Gloss to Any Standard RAL No. to BS EN 12206-1:2004
- Door Leaf to Open Out Into the Corridor Instead of Into The Cell
- Heavy Duty Wall Mounted Door Stop
- Supply & Install Type 3 Chubb 3R47 Mortice Locking Latch

Warranties:

- Defects 12 Months Product Subject to Correct Maintenance and Installation if Applicable Excluding Wilful Damage Caused by Operator or Detainee and Any Paint Decoration & Hardware Supplied by Others if Applicable
- Start Date From Practical Completion on New Build Projects or Installation on Refurbishment/Upgrade Projects
- Extended Warranties Available

CLCS Range Cell doors 9D006 Court Cell Door

Technical Design:

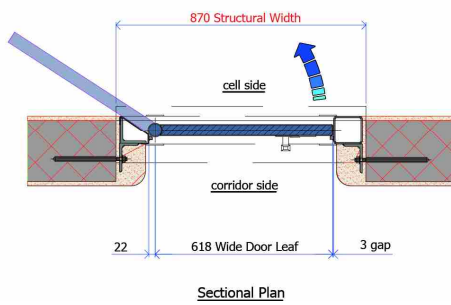
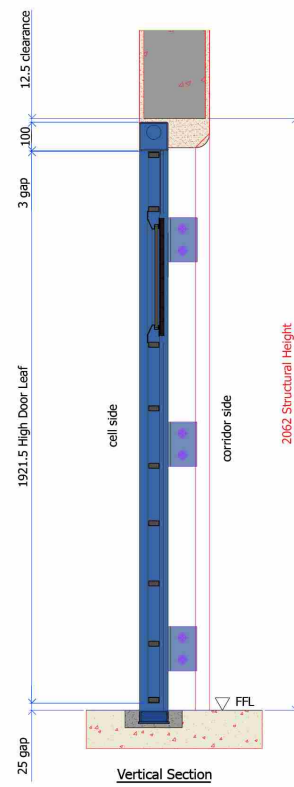
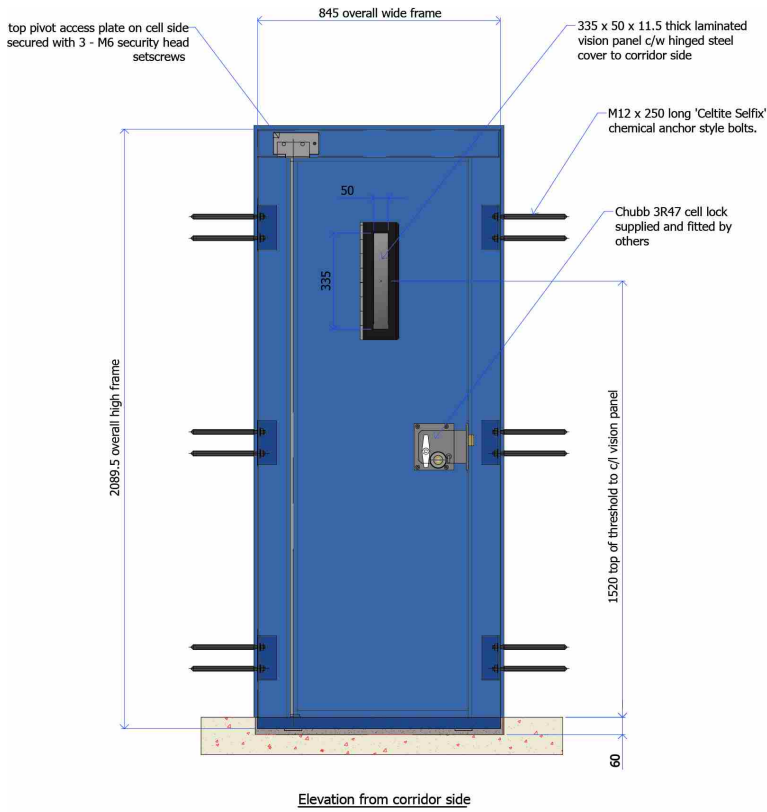

Application:

A Chubb Locks Custodial Services Ltd HMPS specification cell door for prison cells incorporating an anti-barricade device, anti-ligature strips, vision panel with privacy cover, inundation unit and preparation for a Class 1 Chubb cell lock. Conforms to the standards & specifications required by the Prison Service & Ministry of Justice.

Specification:

Specifications, Performance Data & Tolerances

- Conforms to the standards & specifications required by the Prison Service & Ministry of Justice

Door Frame

- 100x60x4mm & 100x100x4mm Hot Rolled Hollow Section Steel Frame to BS EN 10025:2004
- Anti-Barricade Device Machined & Fabricated From Solid Steel Section as HMPS Specification
- All Steelwork Shot Blasted to BS EN ISO 11124-4:1997
- 4mm Pressed Steel Threshold Section Electro-Zinc Coated to BS EN 10152:2009 Cast into Floor
- Steel Fabrication to BS EN ISO 9001: 2000
- Welding to BS EN 1011-2: 2001
- Frame Fixings Fully Site Welded Head Chemical Resin Anchors 8no.minimum per frame

Door Leaf

- 1.6mm thick Cold Rolled Steel Door Skins Both Sides Hot Dip Zinc Coated to BS EN 10346:2009
- 38x19x2mm Internal ERW Rectangular Steel Tube Skeleton Framework to BS EN 10305-3/5 Grade E220
- Internal Skeleton Framework Shot Blast to BS EN ISO 11124-4:1997
- Steel Fabrication to BS EN ISO 9001: 2000
- Welding to BS EN 1011-2: 2001
- Mineral Wool Insulation RWA40 to all Internal Voids to BS EN 13162:2001
- Tubular Pivot Hinge Full Length of Door Leaf as HMPS Specification
- Laminated Glass Vision Panel with Hinged Privacy Cover as HMPS Specification
- Preparation for Class 1 Chubb 4L65P Mechanical Cell Lock With Privacy Facility
- Direct Mounting Lock Plate Included as Part of Internal framework Skeleton
- Lockable Inundation Unit as HMPS Specification
- Anti-Ligature Strips Face Fixed at Head & Leading Edge Over Lock as HMPS Specification

Standard Dimensions

- Structural Opening 790mm Wide x 2070mm High
- Overall Door Frame 770mm Wide x 2060mm High (Height From Finished Floor Level as Threshold Cast into Floor)
- Door Leaf 618.5mm Wide CL Hinge Tube x 1937mm High x 42mm Thick
- Frame Clearance 10mm Jambs, 10mm Head
- Door Leaf Clearance 3mm Leading Edge, 3mm hinge, 3mm head, 10mm undercut

Finish:

- Powder Coat Epoxy Primer to BS EN 12206-1:2004

CLCS Range

Cell doors

9D008

Prison Cell Door

Options:

- Structural Opening Width 1040mm for Disabled Cells
- Alternative Sizes Available
- Right Hand Open-In or Left Hand Open-In (Open-Out Not Standard Specification)
- Polyester Powder Coat Matt 30% Gloss to Any Standard RAL No. to BS EN 12206-1:2004
- Single or Double Frame Arrangements
- Cast-In in Lieu of Bolt-Fix Frame Arrangements
- Preparation for Class 1 Chubb 4L56 Mechanical Slam Action Cell Lock in Lieu of 4L65P
- Preparation for Class 1 Chubb 4A78 ATLAS Intelligent Electro-Mechanical Privacy Facility Cell Lock in Lieu of 4L65P
- Preparation for Class 1 Chubb 4A79 ATLAS Intelligent Electro-Mechanical Slam Action Cell Lock in Lieu of 4L65P
- Heavy Duty Surface Fixed External Barrel Bolt
- Heavy Duty Wall Mounted Door Stop
- Integrated Drugs Treatment System (IDTS) Hatch
- Dirty Protest Foodhatch
- Dirty Protest Vision Panel
- Scottish Prison Service Design Vision Panel Cover
- Scottish Prison Service Design Inundation Unit
- Timber Veneered Door Leaf One or Both Sides

Warranties:

- Defects 12 Months Product Subject to Correct Maintenance and Installation if Applicable Excluding Wilful Damage Caused by Operator or Detainee and Any Paint Decoration & Hardware Supplied by Others if Applicable
- Start Date From Practical Completion on New Build Projects or Installation on Refurbishment/Upgrade Projects
- Extended Warranties Available

CLCS Range Cell doors 9D008 Prison Cell Door

Technical Design:

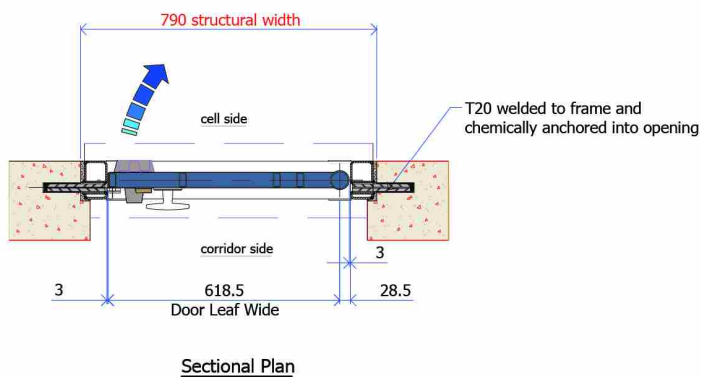
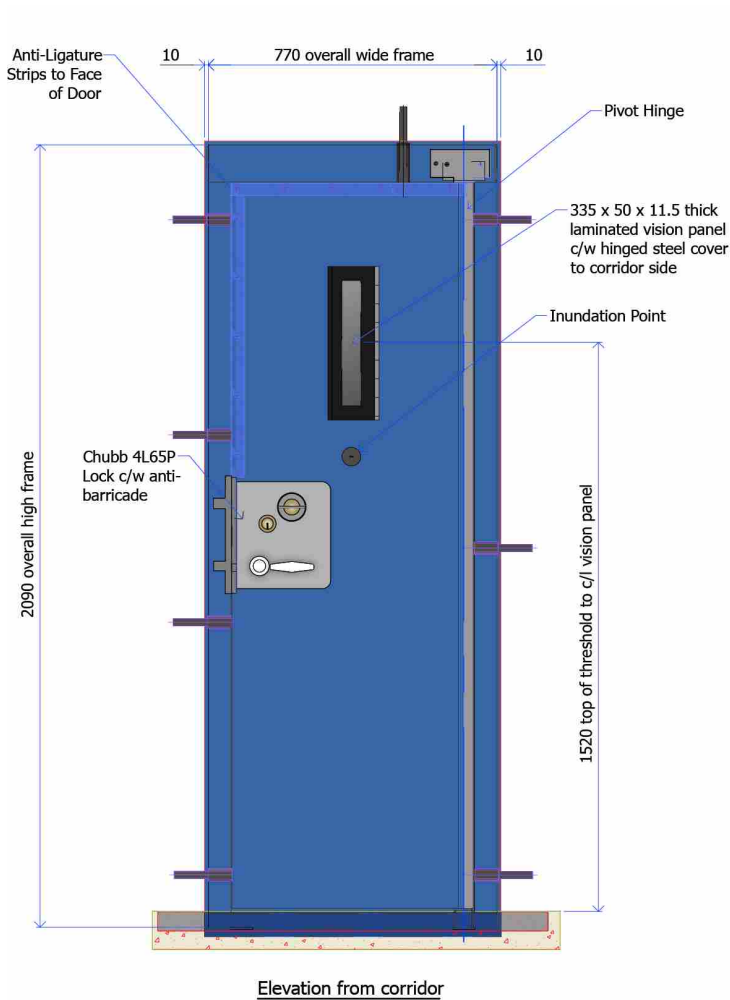

Application:

A Chubb Locks Custodial Services Ltd IPS specification cell door for prison cells incorporating removable rebates, horizontal vision panel with privacy cover, inundation unit and preparation for a Class 1 Chubb cell lock. Conforms to the standards & specifications required by the Irish Prison Service.

Specification:

Specifications, Performance Data & Tolerances

- Conforms to the standards & specifications required by the Irish Prison Service

Door Frame

- 120x60x5mm Jamb & 160x120x5mm Header Hot Rolled Hollow Section Steel Frame to BS EN 10025:2004
- Removable 20x20x3mm Pressed Steel Angle Rebate Strips Fixed With M6 CSK Security Screws
- Removable Solid Steel Lock Bolt Strike Plate Welded to Rebate Strips
- All Steelwork Shot Blasted to BS EN ISO 11124-4:1997
- 120x15mm Flat Steel Threshold Section To BS EN 10025:2004 Cast into Floor
- Steel Fabrication to BS EN ISO 9001: 2000
- Welding to BS EN 1011-2: 2001
- 4mm Thick Removable Access Plate In Header With Preparation For Tamper Microswitch
- Frame Fixings Fully Site Welded Head T16 Rebar Chemical Resin Anchors 7no.minimum per frame

Door Leaf

- 3mm thick Cold Rolled Steel Door Skins Both Sides Electro-Zinc Coated to BS EN 10152:2009
- 50x25x1.5mm Internal ERW Rectangular Steel Tube Skeleton Framework to BS EN 10305-3/5 Grade E220
- Internal Skeleton Framework Shot Blast to BS EN ISO 11124-4:1997
- Steel Fabrication to BS EN ISO 9001: 2000
- Welding to BS EN 1011-2: 2001
- Mineral Wool Insulation RWA50 to all Internal Voids to BS EN 13162:2001
- Tubular Pivot Hinge Full Length of Door Leaf as IPS Specification
- Horizontal Laminated Glass Vision Panel with Hinged Privacy Cover as IPS Specification
- Preparation for Surface Mounted Class 1 Chubb 4L56 Mechanical Slam Action Cell Lock
- Direct Mounting Lock Plate Welded To Corridor Side Face Of Door
- 20mm Dia Internal Conduit With Smooth Bushed Joints For Future Electric Locking
- Inundation Unit as IPS Specification
- Stainless Steel Grade 304 Card Holder Riveted To Corridor Side Face
- Preparation For Door Position Contact

Standard Dimensions

- Structural Opening 1010mm Wide x 2260mm High
- Overall Door Frame 990mm Wide x 2250mm High (Height From Finished Floor Level as Threshold Cast into Floor)
- Door Leaf 834.6mm Wide CL Hinge Tube x 2077mm High x 56mm Thick
- Frame Clearance 10mm Jamb, 10mm Head
- Door Leaf Clearance 3mm Leading Edge, 3mm hinge, 3mm head, 10mm undercut

Finish:

- Powder Coat Epoxy Primer to BS EN 12206-1:2004

Options:

- Alternative Sizes Available
- Right Hand Open-In or Left Hand Open-In (Open-Out Not Standard Specification)
- Polyester Powder Coat Matt 30% Gloss to Any Standard RAL No. to BS EN 12206-1:2004
- Cast-In in Lieu of Bolt-Fix Frame Arrangements
- Preparation for Class 1 Chubb 4L65P Mechanical Cell Lock With Privacy Facility
- Preparation for Class 1 Chubb 4A78 ATLAS Intelligent Electro-Mechanical Privacy Facility Cell Lock in Lieu of 4L65P
- Preparation for Class 1 Chubb 4A79 ATLAS Intelligent Electro-Mechanical Slam Action Cell Lock in Lieu of 4L65P
- Heavy Duty Wall Mounted Door Stop

Warranties:

- Defects 12 Months Product Subject to Correct Maintenance and Installation if Applicable Excluding Wilful Damage Caused by Operator or Detainee and Any Paint Decoration & Hardware Supplied by Others if Applicable
- Start Date From Practical Completion on New Build Projects or Installation on Refurbishment/Upgrade Projects
- Extended Warranties Available

CLCS Range Cell doors

9D009

Irish Prison Cell Door

Technical Design:

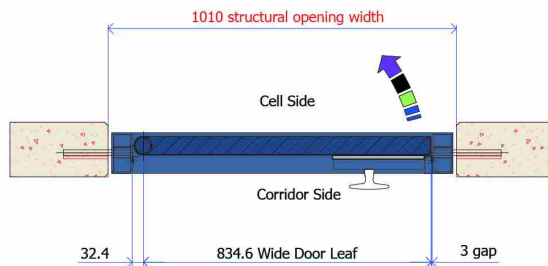
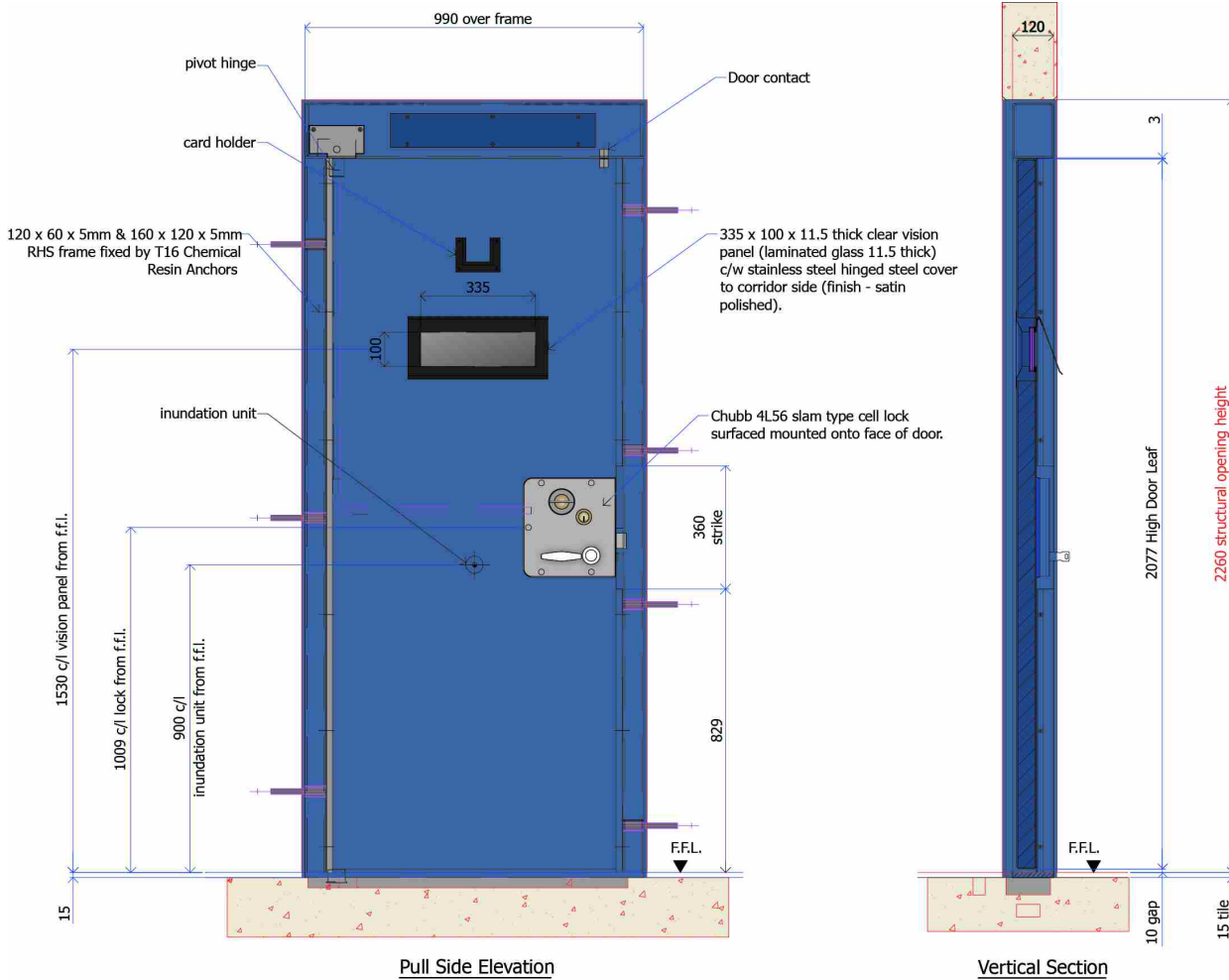

CLCS Range Circulation & perimeter doors

9D014A

Police Prisoners Entrance Door

Application:

A Chubb Locks Custodial Services Ltd prisoner entrance door for entering custody in police stations. Incorporating a 150mm square laminated glass vision panel with privacy cover, recessed pull handle and Type 2 Chubb 3G112 heavy duty mortice deadlock working in conjunction with an electric strike for keyless access control. Generally conforms to the Police Buildings Custody Design Guide and National Police Estates Group Best Practice Document.

Specification:

Specifications, Performance Data & Tolerances

- Generally Conforms to the Police Buildings Custody Design Guide
- Generally Conforms to the National Police Estates Group Best Practice Document
- Continuous Hinge Cyclic Tested to a Minimum 1,000,000 cycles min and to BS EN 1935 Grade 14 160kg

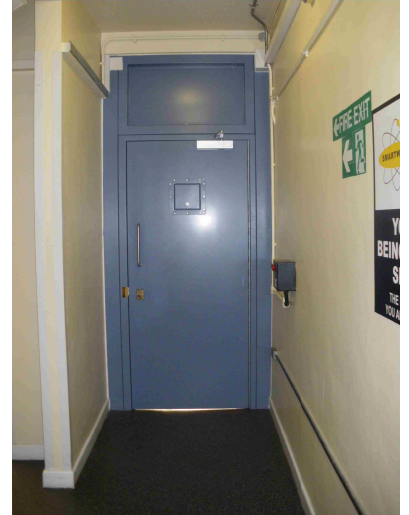

Door Frame

- 3mm thick Pressed Steel Profile Frame 125x69x50mm 19mm Rebate Electro-Zinc Coated to BS EN 10152:2009
- 75x10mm Flat Steel Threshold Section to BS EN 10025:2004 Cast into Floor
- Steel Fabrication to BS EN ISO 9001: 2000
- Welding to BS EN 1011-2: 2001
- Heavy Duty Fail-Secure Electric Strike 12v DC Monitored
- Frame Fixings Hilti HSL-TZ M8/20 Sleeve Anchors 10no. minimum per frame
- Security Type Frame Grommets to Conceal Fixings

Door Leaf

- 1.6mm thick Cold Rolled Steel Door Skins Both Sides & All Edges Hot Dip Zinc Coated to BS EN 10346:2009
- 44mm thick Solid Timber Door Core Mixed Tropical 3 Layer Lamels Hardwood Rails & Stiles
- Door Core Density 460 – 500kg/m³
- Heat Pressure Bonded 80C @ 500lbs/in² for 7mins
- Adhesive Apollo A9267 PU
- Ligature Resisting Continuous Hinge either Barrel or Gear Type Capable of Supporting Weight of Door Leaf
- 150mm Square Laminated Glass Vision Panel with Hinged Steel Privacy Cover
- Type 2 Chubb 3G112 Heavy Duty Mortice Lock Operable Both Sides
- Recessed Pull Handle Both Sides Cast Stainless Steel Grade 304
- Overhead Hydraulic Door Closer with Adjustable Closing Force EN 3-6 and Back Check

Standard Dimensions

- Structural Opening 910mm Wide x 2100mm High
- Overall Door Frame 900mm Wide x 2093mm High (Height From Finished Floor Level as Threshold Cast into Floor)
- Door Leaf 782mm Wide x 2030mm High Excluding Hinge(s) x 48mm Thick
- Frame Clearance 5mm Jamb, 7mm Head
- Door Leaf Clearance 3mm Leading Edge, 15mm hinge, 3mm head, 10mm undercut

Finish:

- Powder Coat Epoxy Primer to BS EN 12206-1:2004

CLCS Range

Circulation & perimeter doors

9D014A

Police Prisoners Entrance Door

Options:

- Structural Opening Width 1125mm for Disabled Access
- Alternative Sizes Available
- Right Hand Open-In/Out or Left Hand Open-In/Out
- Polyester Powder Coat Matt 30% Gloss to Any Standard RAL No. to BS EN 12206-1:2004
- Weather Seals Around Frame Rebate
- Drip Strip & Upstand Weather Bar for Exposed External Applications
- Door Position Contact Switch
- Home Office Approved Hit & Miss Viewer
- Ligature Resisting Gasket Free Circular Viewer with Swivel Cover
- Alternative Chemical Resin Frame Fixings
- Heavy Duty Wall Mounted Door Stop
- Type 2 Chubb 3G112 Monitored Lock with Wired Hinge

Warranties:

- Defects 12 Months Product Subject to Correct Maintenance and Installation if Applicable Excluding Wilful Damage Caused by Operator or Detainee and Any Paint Decoration & Hardware Supplied by Others if Applicable
- Start Date From Practical Completion on New Build Projects or Installation on Refurbishment/Upgrade Projects
- Extended Warranties Available

CLCS Range

Circulation & perimeter doors

9D014A

Police Prisoners Entrance Door

Technical Design:

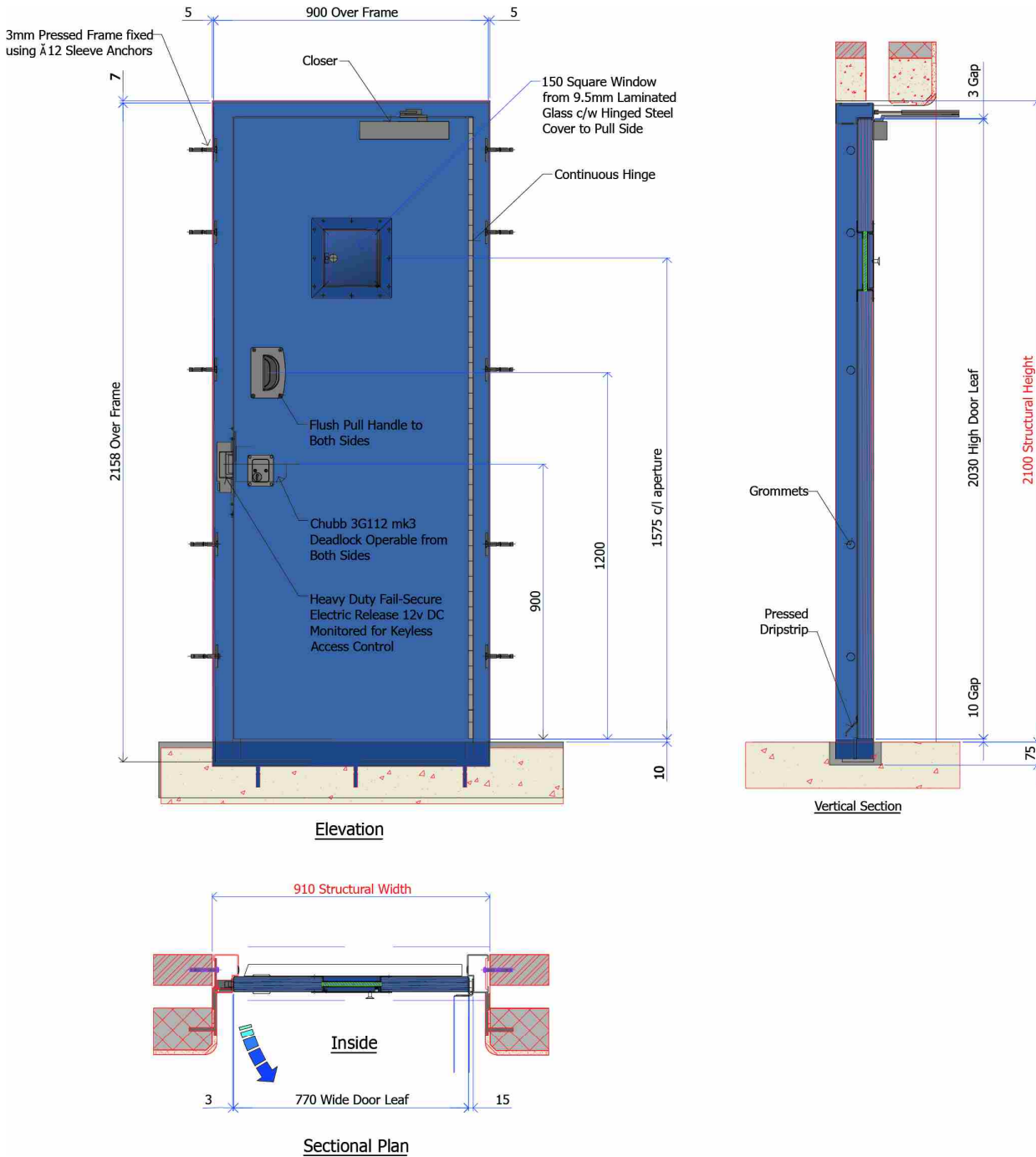

CLCS Range Circulation & perimeter doors

9D014B

Police Custody Fire Escape Door

Application:

A Chubb Locks Custodial Services Ltd fire escape door for police station custody secure areas incorporating recessed pull handles and Type 2 Chubb 3G112 heavy duty mortice deadlock. Generally conforms to the Police Buildings Custody Design Guide and National Police Estates Group Best Practice Document.

Specification:

Specifications, Performance Data & Tolerances

- Generally Conforms to the Police Buildings Custody Design Guide
- Generally Conforms to the National Police Estates Group Best Practice Document
- Continuous Hinge Cyclic Tested to a Minimum 1,000,000 cycles min and to BS EN 1935 Grade 14 160kg

Door Frame

- 3mm thick Pressed Steel Profile Frame 125x69x50mm 19mm Rebate Electro-Zinc Coated to BS EN 10152:2009
- 75x10mm Flat Steel Threshold Section to BS EN 10025:2004 Cast into Floor
- Steel Fabrication to BS EN ISO 9001: 2000
- Welding to BS EN 1011-2: 2001
- Frame Fixings Hilti HSL-TZ M8/20 Sleeve Anchors 10no. minimum per frame
- Security Type Frame Grommets to Conceal Fixings

Door Leaf

- 1.6mm thick Cold Rolled Steel Door Skins Both Sides & All Edges Hot Dip Zinc Coated to BS EN 10346:2009
- 44mm thick Solid Timber Door Core Mixed Tropical 3 Layer Lamels Hardwood Rails & Stiles
- Door Core Density 460 – 500kg/m³
- Heat Pressure Bonded 80C @ 500lbs/in² for 7mins
- Adhesive Apollo A9267 PU
- Ligature Resisting Continuous Hinge either Barrel or Gear Type Capable of Supporting Weight of Door Leaf
- Type 2 Chubb 3G112 Heavy Duty Mortice Lock Operable Both Sides
- Recessed Pull Handle Both Sides Cast Stainless Steel Grade 304

Standard Dimensions

- Structural Opening 910mm Wide x 2100mm High
- Overall Door Frame 900mm Wide x 2093mm High (Height From Finished Floor Level as Threshold Cast into Floor)
- Door Leaf 782mm Wide x 2030mm High Excluding Hinge(s) x 48mm Thick
- Frame Clearance 5mm Jamb, 7mm Head
- Door Leaf Clearance 3mm Leading Edge, 15mm hinge, 3mm head, 10mm undercut

Finish:

- Powder Coat Epoxy Primer to BS EN 12206-1:2004

CLCS Range

Circulation & perimeter doors

9D014B

Police Custody Fire Escape Door

Options:

- Structural Opening Width 1125mm for Disabled Access
- Alternative Sizes Available
- Right Hand Open-In/Out or Left Hand Open-In/Out
- Polyester Powder Coat Matt 30% Gloss to Any Standard RAL No. to BS EN 12206-1:2004
- 150mm Square Laminated Glass Vision Panel with Hinged Steel Privacy Cover
- Overhead Hydraulic Door Closer with Adjustable Closing Force EN 3-6 and Back Check
- Heavy Duty Fail-Secure Electric Strike 12v DC Monitored for Keyless Access Control
- Weather Seals Around Frame Rebate
- Drip Strip & Upstand Weather Bar for Exposed External Applications
- Door Position Contact Switch
- Home Office Approved Hit & Miss Viewer
- Ligature Resisting Gasket Free Circular Viewer with Swivel Cover
- Alternative Chemical Resin Frame Fixings
- Heavy Duty Wall Mounted Door Stop
- Type 2 Chubb 3G112 Monitored Lock with Wired Hinge

Warranties:

- Defects 12 Months Product Subject to Correct Maintenance and Installation if Applicable Excluding Wilful Damage Caused by Operator or Detainee and Any Paint Decoration & Hardware Supplied by Others if Applicable
- Start Date From Practical Completion on New Build Projects or Installation on Refurbishment/Upgrade Projects
- Extended Warranties Available

CLCS Range

Circulation & perimeter doors

9D014B

Police Custody Fire Escape Door

Technical Design:

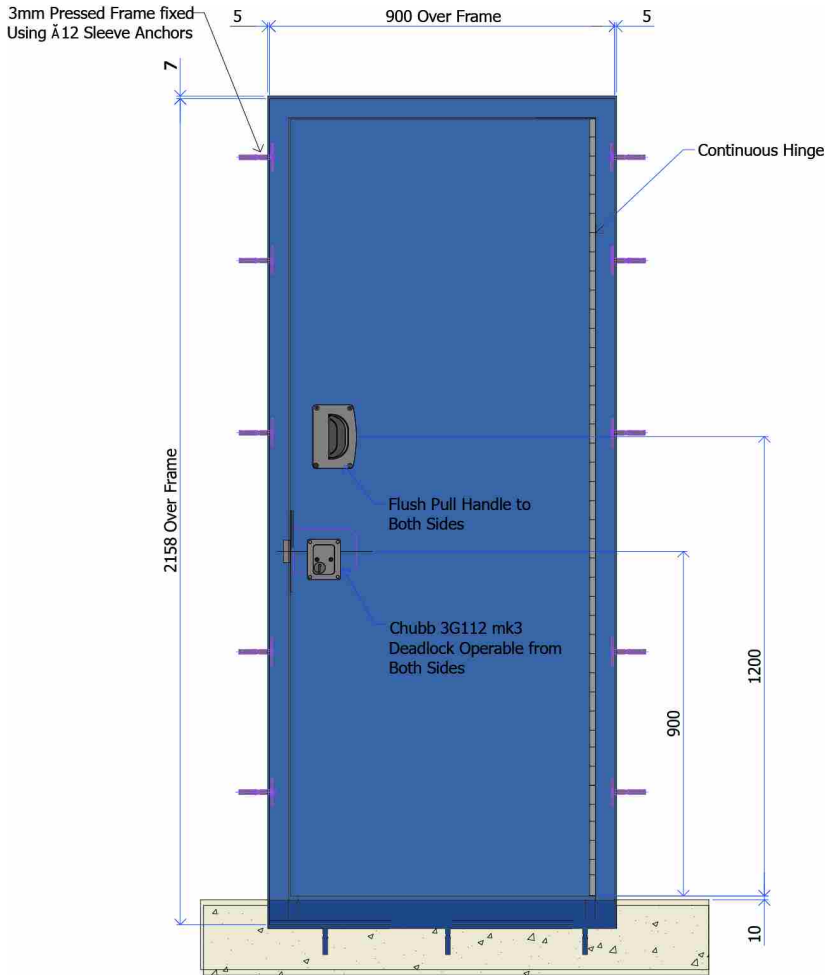

Elevation

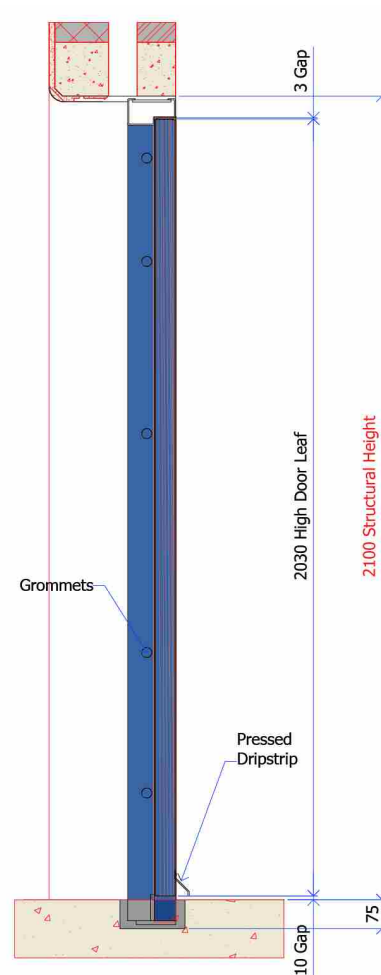

Vertical Section

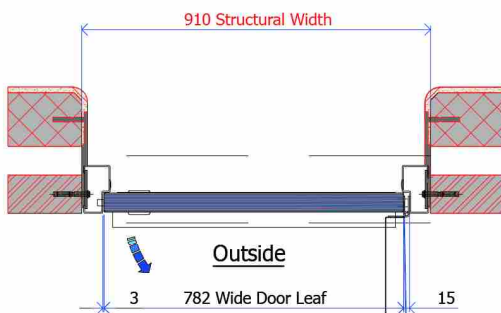

Sectional Plan

CLCS Range

Circulation & perimeter doors

9D015A

Police Pass/Exercise Yard Door

Application:

A Chubb Locks Custodial Services Ltd door typically used for police station pass or exercise yard doors within custody. Incorporating a 150mm square laminated glass vision panel, recessed pull handle and Type 2 Chubb 3G112 heavy duty mortice deadlock. Generally conforms to the Police Buildings Custody Design Guide and National Police Estates Group Best Practice Document.

Specification:

Specifications, Performance Data & Tolerances

- Generally Conforms to the Police Buildings Custody Design Guide
- Conforms to the National Police Estates Group Best Practice Document
- Continuous Hinge Cyclic Tested to a Minimum 1,000,000 cycles min and to BS EN 1935 Grade 14 160kg

Door Frame

- 3mm thick Pressed Steel Profile Frame 125x69x50mm 19mm Rebate Electro-Zinc Coated to BS EN 10152:2009
- 75x10mm Flat Steel Threshold Section to BS EN 10025:2004 Cast into Floor
- Steel Fabrication to BS EN ISO 9001: 2000
- Welding to BS EN 1011-2: 2001
- Frame Fixings Hilti HSL-TZ M8/20 Sleeve Anchors 10no. minimum per frame
- Security Type Frame Grommets to Conceal Fixings

Door Leaf

- 1.6mm thick Cold Rolled Steel Door Skins Both Sides & All Edges Hot Dip Zinc Coated to BS EN 10346:2009
- 44mm thick Solid Timber Door Core Mixed Tropical 3 Layer Lamels Hardwood Rails & Stiles
- Door Core Density 460 – 500kg/m³
- Heat Pressure Bonded 80C @ 500lbs/in² for 7mins
- Adhesive Apollo A9267 PU
- Ligature Resisting Continuous Hinge either Barrel or Gear Type Capable of Supporting Weight of Door Leaf
- 150mm Square Laminated Glass Vision Panel
- Type 2 Chubb 3G112 Heavy Duty Mortice Lock Operable One or Both Sides
- Recessed Pull Handle Both Sides Cast Stainless Steel Grade 304

Standard Dimensions

- Structural Opening 910mm Wide x 2100mm High
- Overall Door Frame 900mm Wide x 2093mm High (Height From Finished Floor Level as Threshold Cast into Floor)
- Door Leaf 782mm Wide x 2030mm High Excluding Hinge(s) x 48mm Thick
- Frame Clearance 5mm Jamb, 7mm Head
- Door Leaf Clearance 3mm Leading Edge, 15mm hinge, 3mm head, 10mm undercut

Finish:

- Powder Coat Epoxy Primer to BS EN 12206-1:2004

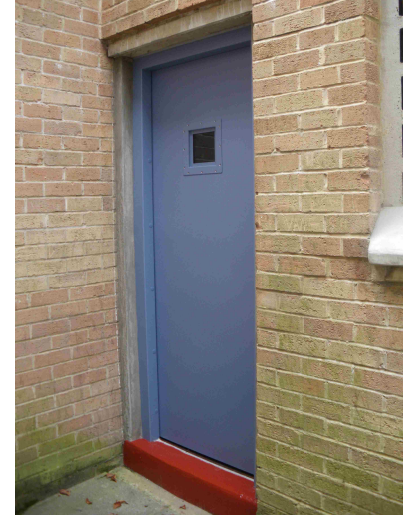

CLCS Range

Circulation & perimeter doors

9D015A

Police Pass/Exercise Yard Door

Options:

- Structural Opening Width 1125mm for Disabled Access
- Alternative Sizes Available
- Right Hand Open-In/Out or Left Hand Open-In/Out
- Polyester Powder Coat Matt 30% Gloss to Any Standard RAL No. to BS EN 12206-1:2004
- Overhead Hydraulic Door Closer with Adjustable Closing Force EN 3-6 and Back Check
- Heavy Duty Fail-Secure Electric Strike 12v DC Monitored for Keyless Access Control
- Weather Seals Around Frame Rebate
- Drip Strip & Upstand Weather Bar for Exposed External Applications
- Hinged Steel Privacy Cover on Vision Panel
- Door Position Contact Switch
- Home Office Approved Hit & Miss Viewer
- Ligature Resisting Gasket Free Circular Viewer with Swivel Cover
- Alternative Chemical Resin Frame Fixings
- Heavy Duty Wall Mounted Door Stop
- Type 2 Chubb 3G112 Monitored Lock with Wired Hinge

Warranties:

- Defects 12 Months Product Subject to Correct Maintenance and Installation if Applicable Excluding Wilful Damage Caused by Operator or Detainee and Any Paint Decoration & Hardware Supplied by Others if Applicable
- Start Date From Practical Completion on New Build Projects or Installation on Refurbishment/Upgrade Projects
- Extended Warranties Available

CLCS Range

Circulation & perimeter doors

9D015A

Police Pass/Exercise Yard Door

Technical Design:

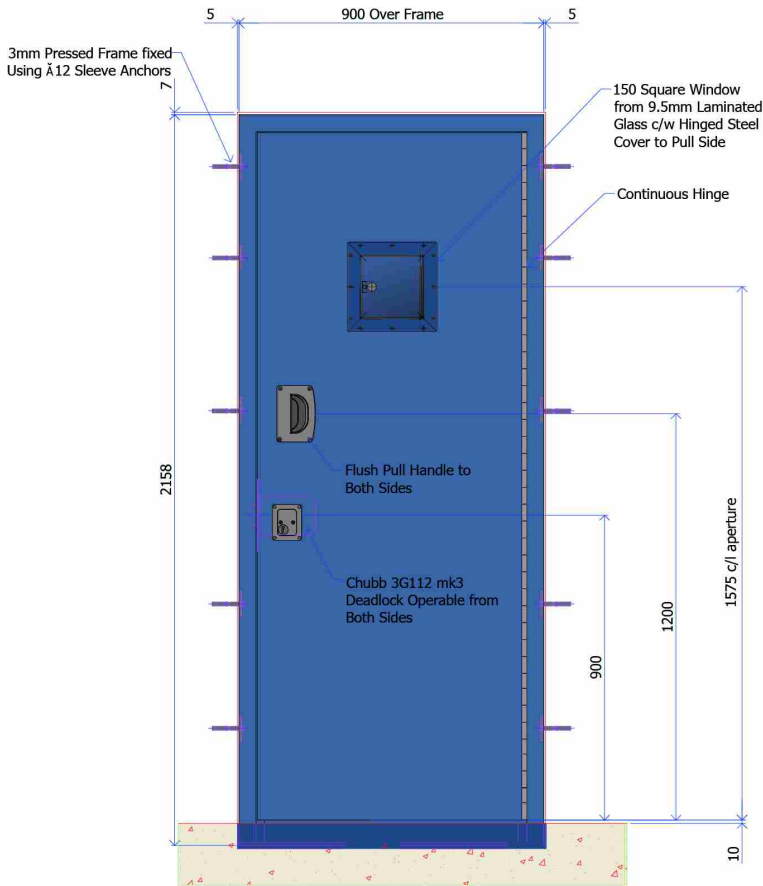

Elevation

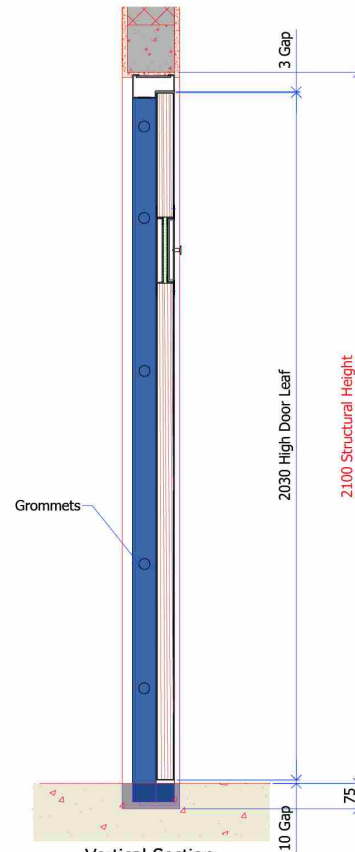

Vertical Section

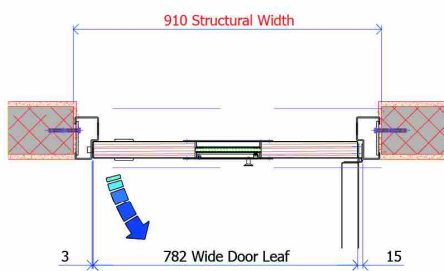

Sectional Plan

CLCS Range

Circulation & perimeter doors

9D015B

Police Surgeon/Medical Room Door

Application:

A Chubb Locks Custodial Services Ltd secure door for police station surgeon/medical rooms in custody incorporating a 150mm square laminated glass vision panel with privacy cover, recessed pull handle and Type 2 Chubb 3G112 heavy duty mortice deadlock. Generally conforms to the Police Buildings Custody Design Guide and National Police Estates Group Best Practice Document.

Specification:

Specifications, Performance Data & Tolerances

- Generally Conforms to the Police Buildings Custody Design Guide
- Conforms to the National Police Estates Group Best Practice Document
- Continuous Hinge Cyclic Tested to a Minimum 1,000,000 cycles min and to BS EN 1935 Grade 14 160kg

Door Frame

- 3mm thick Pressed Steel Profile Frame 125x69x50mm 19mm Rebate Electro-Zinc Coated to BS EN 10152:2009
- 75x10mm Flat Steel Threshold Section to BS EN 10025:2004 Cast into Floor
- Steel Fabrication to BS EN ISO 9001: 2000
- Welding to BS EN 1011-2: 2001
- Frame Fixings Hilti HSL-TZ M8/20 Sleeve Anchors 10no. minimum per frame
- Security Type Frame Grommets to Conceal Fixings

Door Leaf

- 1.6mm thick Cold Rolled Steel Door Skins Both Sides & All Edges Hot Dip Zinc Coated to BS EN 10346:2009
- 44mm thick Solid Timber Door Core Mixed Tropical 3 Layer Lamels Hardwood Rails & Stiles
- Door Core Density 460 – 500kg/m³
- Heat Pressure Bonded 80C @ 500lbs/in² for 7mins
- Adhesive Apollo A9267 PU
- Ligature Resisting Continuous Hinge either Barrel or Gear Type Capable of Supporting Weight of Door Leaf
- 150mm Square Laminated Glass Vision Panel with Hinged Steel Privacy Cover
- Type 2 Chubb 3G112 Heavy Duty Mortice Lock Operable Both Sides
- Recessed Pull Handle Both Sides Cast Stainless Steel Grade 304

Standard Dimensions

- Structural Opening 910mm Wide x 2100mm High
- Overall Door Frame 900mm Wide x 2093mm High (Height From Finished Floor Level as Threshold Cast into Floor)
- Door Leaf 782mm Wide x 2030mm High Excluding Hinge(s) x 48mm Thick
- Frame Clearance 5mm Jamb, 7mm Head
- Door Leaf Clearance 3mm Leading Edge, 15mm hinge, 3mm head, 10mm undercut

Finish:

- Powder Coat Epoxy Primer to BS EN 12206-1:2004

CLCS Range

Circulation & perimeter doors

9D015B

Police Surgeon/Medical Room Door

Options:

- Structural Opening Width 1125mm for Disabled Access
- Alternative Sizes Available
- Right Hand Open-In/Out or Left Hand Open-In/Out
- Polyester Powder Coat Matt 30% Gloss to Any Standard RAL No. to BS EN 12206-1:2004
- Overhead Hydraulic Door Closer with Adjustable Closing Force EN 3-6 and Back Check
- Heavy Duty Fail-Secure Electric Strike 12v DC Monitored
- Door Position Contact Switch
- Alternative Chemical Resin Frame Fixings
- Heavy Duty Wall Mounted Door Stop
- Type 2 Chubb 3G112 Monitored Lock with Wired Hinge

Warranties:

- Defects 12 Months Product Subject to Correct Maintenance and Installation if Applicable Excluding Wilful Damage Caused by Operator or Detainee and Any Paint Decoration & Hardware Supplied by Others if Applicable
- Start Date From Practical Completion on New Build Projects or Installation on Refurbishment/Upgrade Projects
- Extended Warranties Available

CLCS Range

Circulation & perimeter doors

9D015B

Police Surgeon/Medical Room Door

Technical Design:

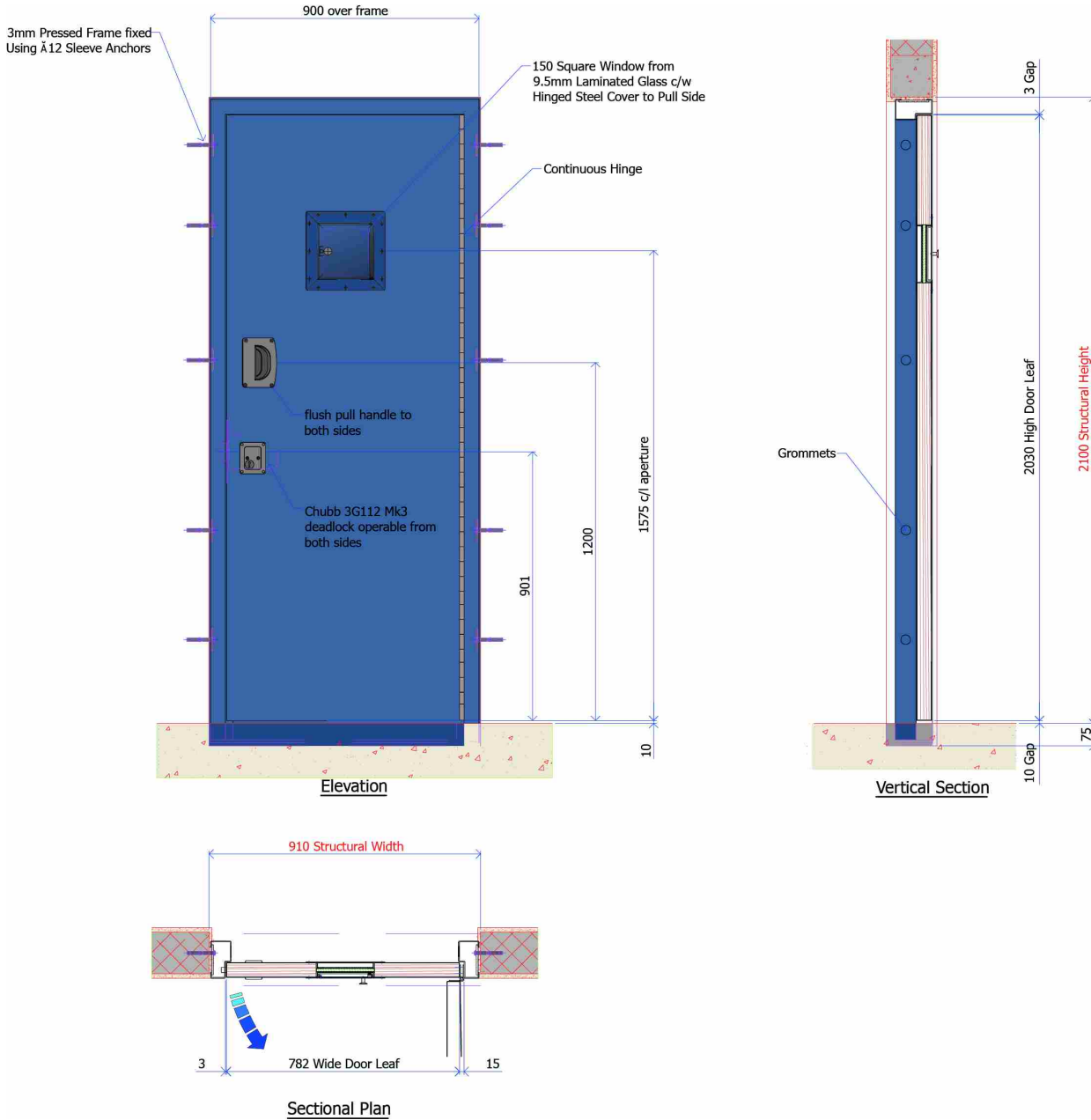

CLCS Range

Circulation & perimeter doors

9D017B

Steel Fire Door 60 min Integrity

Application:

A Chubb Locks Custodial Services Ltd steel fire door with 60 mins fire resistance integrity for use in police custody. The door incorporates a laminated glass vision panel, a Type 2 Chubb 3G112 heavy duty mortice deadlock & continuous hinge.

Specification:

Specifications, Performance Data & Tolerances

- Fire Resistance 60 mins Integrity to BS EN 1634-1:2000
- Continuous Hinge Cyclic Tested to a Minimum 1,000,000 cycles min and to BS EN 1935 Grade 14 160kg

Door Frame

- 125x75x8mm Rolled Steel Angle Frame to BS EN 10025:2004
- 25x25x3mm Rolled Hollow Section Steel Rebates to BS EN 10025:2004
- 75x10mm Flat Steel Threshold Section to BS EN 10025:2004 Cast into Floor
- All Steelwork Shot Blasted to BS EN ISO 11124-4:1997
- Steel Fabrication to BS EN ISO 9001: 2000
- Welding to BS EN 1011-2: 2001
- Frame Fixings Hilti HSL-TZ M8/20 Sleeve Anchors 10no. minimum per frame

Door Leaf

- 3mm thick Cold Rolled Steel Door Skins Both Sides Electro-Zinc Coated to BS EN 10152:2009
- 40x40x3mm Internal Rolled Hollow Section Skeleton Framework to BS EN 10025:2004
- Internal Skeleton Framework Shot Blast to BS EN ISO 11124-4:1997
- Steel Fabrication to BS EN ISO 9001: 2000
- Welding to BS EN 1011-2: 2001
- Mineral Wool Insulation RWA45 to all Internal Voids to BS EN 13162:2001
- Ligature Resisting Continuous Hinge Capable of Supporting Weight of Door Leaf
- Fire Rated Security Laminated Glazing
- Intumescent Glazing Gasket
- Glazing Frame Fixed with CSK Torx/Hex Resist Screws Stainless Steel Grade A2
- Type 2 Chubb 3G112 Heavy Duty Mortice Deadlock Operable Both Sides
- Recessed Pull Handle Both Sides Stainless Steel Grade 304

Standard Dimensions

- Structural Opening 910mm Wide x 2100mm High
- Overall Door Frame 1130mm Wide x 2210mm High (Height From Finished Floor Level as Threshold Cast into Floor)
- Door Leaf 861mm Wide x 2072mm High Excluding Hinge(s) x 46mm Thick
- Frame Clearance 7mm Jambs, 7mm Head
- Door Leaf Clearance 4mm Leading Edge, 15mm hinge, 3mm head, 10mm undercut

Finish:

- Powder Coat Epoxy Primer to BS EN 12206-1:2004

CLCS Range

Circulation & perimeter doors

9D017B

Steel Fire Door 60 min Integrity

Options:

- Alternative Steel Frame Sections Available
- Alternative Sizes Available
- Right Hand or Left Hand
- Polyester Powder Coat Matt 30% Gloss to Any Standard RAL No. to BS EN 12206-1:2004
- Door Position Contact Switch
- Heavy Duty Fail-Secure Electric Strike 12v DC Monitored for Keyless Access Control
- Hinged Privacy Cover On Vision Panel
- Overhead Hydraulic Door Closer with Adjustable Closing Force EN 3-6 and Back Check
- Smoke Seals
- Heavy Duty Wall/Floor Door Stop

Warranties:

- Defects 12 Months Product Subject to Correct Maintenance and Installation if Applicable Excluding Wilful Damage Caused by Operator or Detainee and Any Paint Decoration & Hardware Supplied by Others if Applicable
- Start Date From Practical Completion on New Build Projects or Installation on Refurbishment/Upgrade Projects
- Extended Warranties Available

CLCS Range

Circulation & perimeter doors

9D017B

Steel Fire Door 60 min Integrity

Technical Design:

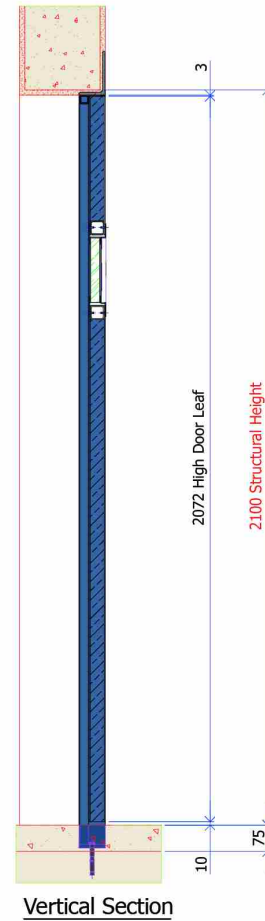
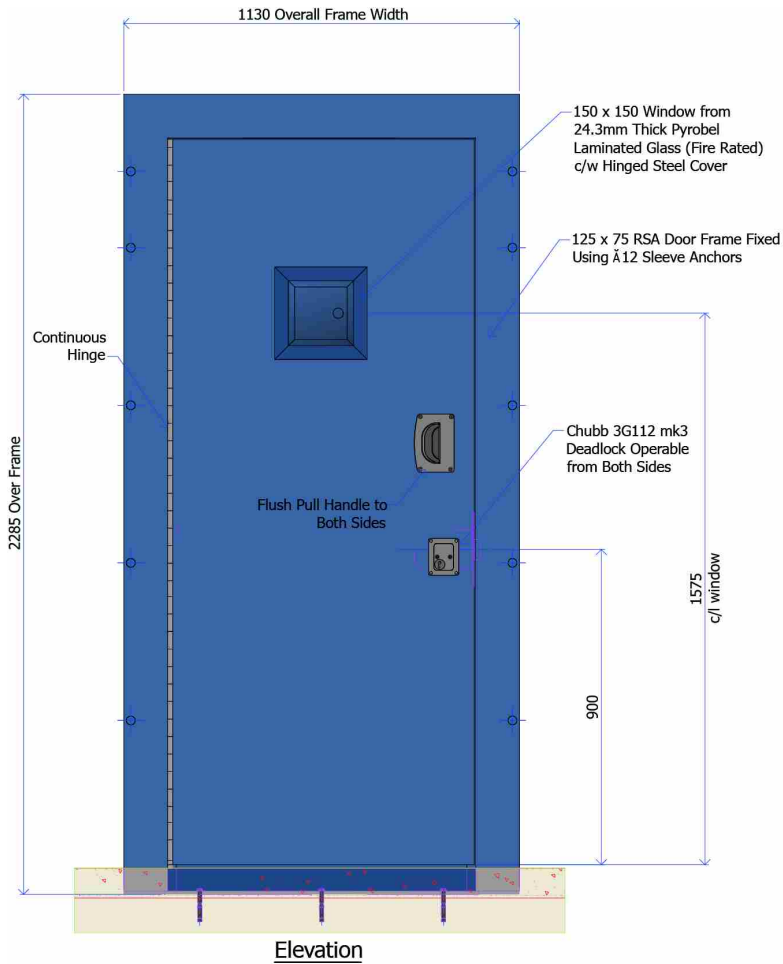

CLCS Range

Circulation & perimeter doors

9D017C

Fully Glazed Corridor Fire Door 60 min Integrity

Application:

A Chubb Locks Custodial Services Ltd steel fully glazed corridor fire door & glazed side panel with 60 mins fire resistance integrity for use in police custody in place of traditional barred grilles. The door incorporates large toughened laminated glass vision panels and a Type 2 Chubb 3G112 heavy duty mortice deadlock.

Specification:

Specifications, Performance Data & Tolerances

- Fire Resistance 60 mins Integrity to BS EN 1634-1:2000
- Continuous Hinge Cyclic Tested to a Minimum 1,000,000 cycles min and to BS EN 1935 Grade 14 160kg

Door Frame

- 100x60x4mm Hot Formed Rolled Hollow Section Steel Frame to BS EN 10025:2004
- 40x20mm Solid Section Steel Rebates to BS EN 10025:2004
- 75x10mm Flat Steel Threshold Section to BS EN 10025:2004 Cast into Floor
- All Steelwork Shot Blasted to BS EN ISO 11124-4:1997
- Steel Fabrication to BS EN ISO 9001: 2000
- Welding to BS EN 1011-2: 2001
- Frame Fixings Hilti HSL-TZ M8/20 Sleeve Anchors 12no. minimum per frame

Door Leaf

- 3mm thick Cold Rolled Steel Door Skins Both Sides Electro-Zinc Coated to BS EN 10152:2009
- 40x40x3mm & 60x40x3mm Internal Rolled Hollow Section Skeleton Framework to BS EN 10025:2004
- Internal Skeleton Framework Shot Blast to BS EN ISO 11124-4:1997
- Steel Fabrication to BS EN ISO 9001: 2000
- Welding to BS EN 1011-2: 2001
- Mineral Wool Insulation RWA45 to all Internal Voids to BS EN 13162:2001
- Ligature Resisting Continuous Hinge either Barrel or Gear Type Capable of Supporting Weight of Door Leaf
- 'CERTIFIRE' Approved Security Laminated Toughened Glazing
- Intumescent Glazing Gasket
- Glazing Frames Fixed with CSK Torx/Hex Resist Screws Stainless Steel Grade A2
- Type 2 Chubb 3G112 Heavy Duty Mortice Deadlock Operable Both Sides
- Recessed Pull Handle Both Sides Stainless Steel Grade 304

Fixed Side Panel

- 3mm thick Cold Rolled Steel Door Skins Both Sides Electro-Zinc Coated to BS EN 10152:2009
- 40x40x3mm & 60x40x3mm Internal Rolled Hollow Section Skeleton Framework to BS EN 10025:2004
- Internal Skeleton Framework Shot Blast to BS EN ISO 11124-4:1997
- Steel Fabrication to BS EN ISO 9001: 2000
- Welding to BS EN 1011-2: 2001
- Mineral Wool Insulation RWA45 to all Internal Voids to BS EN 13162:2001
- 'CERTIFIRE' Approved Security Laminated Toughened Glazing
- Intumescent Glazing Gasket
- Glazing Frames Fixed with CSK Torx/Hex Resist Screws Stainless Steel Grade A2

Standard Dimensions

- Structural Opening 1800mm Wide x 2100mm High
- Overall Door Frame 1786mm Wide x 2093mm High (Height From Finished Floor Level as Threshold Cast into Floor)
- Door Leaf 771mm Wide x 2020mm High Excluding Hinge(s) x 46mm Thick
- Door Leaf Frame 910mm Wide x 2486mm High Overall from FFL
- Side Panel 876mm Wide x 2093mm High x 46mm Thick Including Frame
- Frame Clearance 7mm Jambs, 7mm Head
- Door Leaf Clearance 4mm Leading Edge, 15mm hinge, 3mm head, 10mm undercut

CLCS Range Circulation & perimeter doors

9D017C

Fully Glazed Corridor Fire Door 60 min Integrity

Finish:

- Powder Coat Epoxy Primer to BS EN 12206-1:2004

Options:

- Alternative Sizes Available
- Right Hand or Left Hand
- Polyester Powder Coat Matt 30% Gloss to Any Standard RAL No. to BS EN 12206-1:2004
- Door Position Contact Switch
- Heavy Duty Fail-Secure Electric Strike 12v DC Monitored for Keyless Access Control
- Type 2 Chubb 3G112 Monitored Lock with Wired Hinge
- Glazed Fixed Side Panel Hinge or Slam Side of Door
- Overhead Hydraulic Door Closer with Adjustable Closing Force EN 3-6 and Back Check
- Smoke Seals
- Heavy Duty Wall/Floor Door Stop

Warranties:

- Defects 12 Months Product Subject to Correct Maintenance and Installation if Applicable Excluding Wilful Damage Caused by Operator or Detainee and Any Paint Decoration & Hardware Supplied by Others if Applicable
- Start Date From Practical Completion on New Build Projects or Installation on Refurbishment/Upgrade Projects
- Extended Warranties Available

CLCS Range Circulation & perimeter doors

9D017C

Fully Glazed Corridor Fire Door 60 min Integrity

Technical Design:

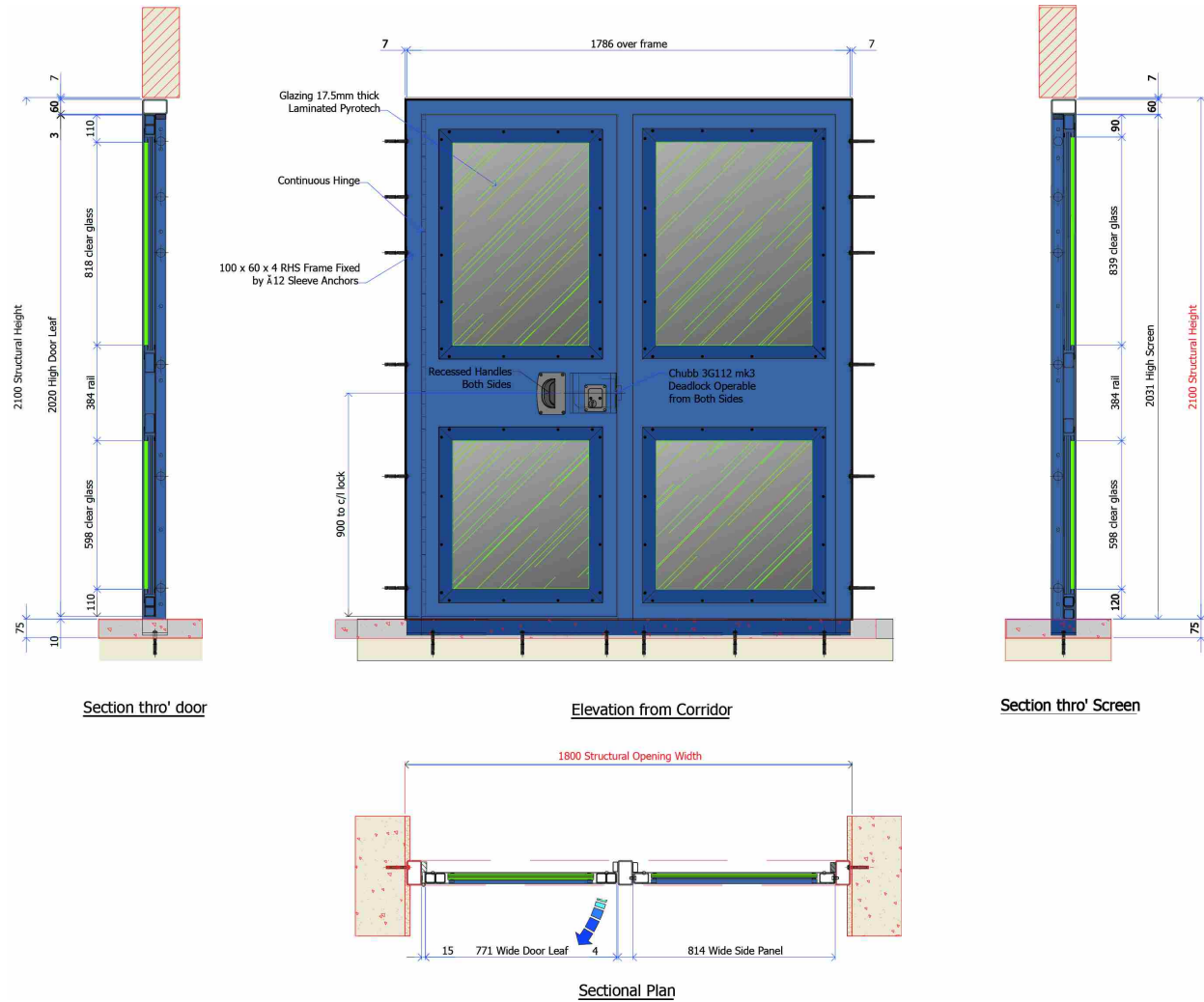

CLCS Range

Circulation & perimeter doors

9D019

Armaglaze Single Action Door

Application:

A Chubb Locks Custodial Services Ltd solid timber single action door & frame faced both sides in coloured textured Armaglaze typically used in corridor locations within Metropolitan Police custody. The door incorporates a Type 2 Chubb 3G112 lock, heavy duty roller catch, polycarbonate vision panel and self-closing floor spring. Conforms to the Metropolitan Police standard specifications.

Specification:

Specifications, Performance Data & Tolerances

- Conforms to The Metropolitan Police Standard Specification

Door Frame

- Monolithic Ash Hardwood Frame 3 Sides 150x70x50mm 20mm Rebate
- European Ash Hardwood Kiln Dried Moisture Content 10 -14% Density 710kg/m³
- Mortice & Tenon Joints
- Hardwood Finish Sanded 240 Grit
- Steel Threshold Plate
- Counterbored & Pelleted Frame Fixings
- Frame Fixings 12mm dia x 100mm Sleeve Anchors 8no. minimum per frame
- Single Action Floor Spring

Door Leaf

- 49/50mm thick Solid Timber Core Malaysian Hardwood Lamels 20-30mm x 200mm finger Jointed Average Density 750kg/m³
- 5mm thick Coloured Armaglaze Textured Facing Heat Pressure Bonded to Both Sides 45C @2500lbs/in² for 6mins
- 25mm Hardwood Ash Lipping Bonded & Screwed All 4 Edges Minimum Density 710kg/m³ 10 -14%MC
- Hardwood Finish Sanded 240 Grit
- Type 2 Chubb 3G112 Heavy Duty Mortice Lock Operable Both Sides
- Heavy Duty Roller Catch
- Stainless Steel Pull Handle & Push Plate
- 6mm thick Polycarbonate Vision Panel 215mm x 250mm
- Single Action Floor Spring Pivots

Standard Dimensions

- Structural Opening 1200mm Wide x 2110mm High
- Overall Door Frame 1190mm Wide x 2104mm High (Height From Finished Floor Level as Threshold Cast into Floor)
- Door Leaf 1082mm Wide x 2030mm High Excluding Hinge(s) x 60mm Thick
- Frame Clearance 5mm Jambs, 6mm Head
- Door Leaf Clearance 4mm Leading Edge, 4mm hinge, 4mm head, 10mm undercut

Finish:

- Colour Impregnated Armaglaze Textured Facings
- Hardwood Lacquer Two Pack Semi-Matt 20% Sheen

CLCS Range

Circulation & perimeter doors

9D019

Armaglaze Single Action Door

Options:

- Alternative Sizes Available
- Right Hand or Left Hand
- Choice of Alternative Hardwood Frame and Lipping Species
- Choice of Alternative Colour Armaglaze Textured Facings to BS 4800 Range
- CERTIFIRE Approved Laminated Fire resistant Glass
- Smoke/Intumescent Seals

Warranties:

- Defects 12 Months Product Subject to Correct Maintenance and Installation if Applicable Excluding Wilful Damage Caused by Operator or Detainee and Any Paint Decoration & Hardware Supplied by Others if Applicable
- Start Date From Practical Completion on New Build Projects or Installation on Refurbishment/Upgrade Projects
- Extended Warranties Available

CLCS Range Circulation & perimeter doors 9D019 Armaglaze Single Action Door

Technical Design:

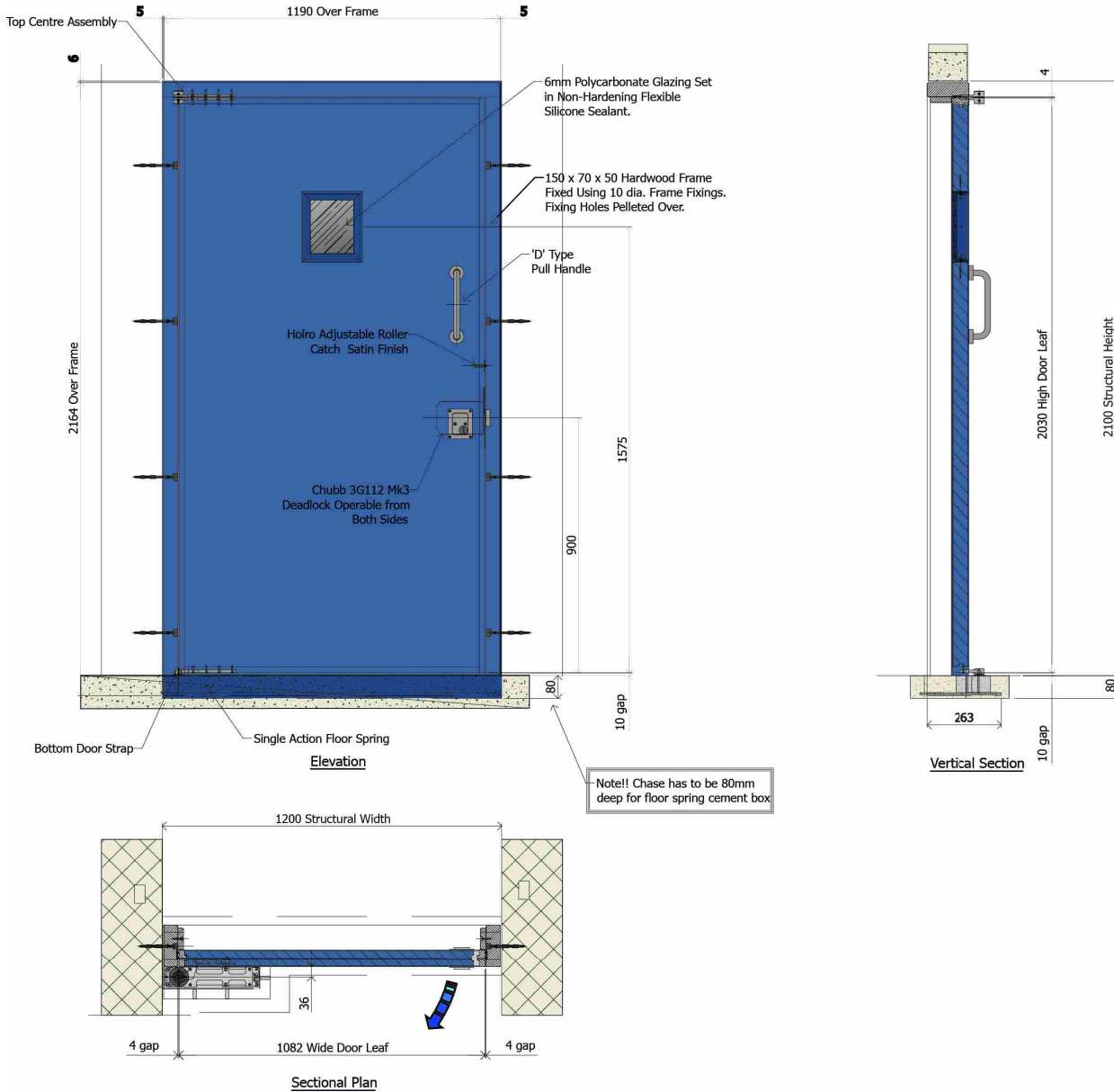

CLCS Range

Circulation & perimeter doors

9D020

Armaglaze Double Action Door

Application:

A Chubb Locks Custodial Services Ltd solid timber double action door & frame faced both sides in coloured textured Armaglaze typically used in corridor locations within Metropolitan Police custody. The door incorporates a Type 2 Chubb 3G112 lock, heavy duty roller catch, polycarbonate vision panel and self-closing floor spring. Conforms to the Metropolitan Police standard specifications.

Specification:

Specifications, Performance Data & Tolerances

- Conforms to The Metropolitan Police Standard Specification
- Door Not Handed

Door Frame

- Monolithic Ash Hardwood Frame 3 Sides 140x50mm
- European Ash Hardwood Kiln Dried Moisture Content 10 -14% Density 710kg/m³
- Mortice & Tenon Joints
- Hardwood Finish Sanded 240 Grit
- Steel Threshold Plate
- Counterbored & Pelleted Frame Fixings
- Frame Fixings 12mm dia x 100mm Sleeve Anchors 8no. minimum per frame
- Double Action Floor Spring

Door Leaf

- 49/50mm thick Solid Timber Core Malaysian Hardwood Lamels 20-30mm x 200mm finger Jointed Average Density 750kg/m³
- 5mm thick Coloured Armaglaze Textured Facing Heat Pressure Bonded to Both Sides 45C @2500lbs/in² for 6mins
- 25mm Hardwood Ash Lipping Bonded & Screwed All 4 Edges Minimum Density 710kg/m³ 10 -14%MC
- Hardwood Finish Sanded 240 Grit
- Type 2 Chubb 3G112 Heavy Duty Mortice Lock Operable Both Sides
- Heavy Duty Roller Catch
- Stainless Steel Push Plates Both Sides
- 6mm thick Polycarbonate Vision Panel 215mm x 250mm
- Double Action Floor Spring Pivots

Standard Dimensions

- Structural Opening 1200mm Wide x 2110mm High
- Overall Door Frame 1190mm Wide x 2104mm High (Height From Finished Floor Level as Threshold Cast into Floor)
- Door Leaf 1092mm Wide x 2040mm High Excluding Hinge(s) x 60mm Thick
- Frame Clearance 5mm Jamb, 6mm Head
- Door Leaf Clearance 4mm Leading Edge, +6mm hinge, 4mm head, 10mm undercut

Finish:

- Colour Impregnated Armaglaze Textured Facings
- Hardwood Lacquer Two Pack Semi-Matt 20% Sheen

CLCS Range

Circulation & perimeter doors

9D020

Armaglaze Double Action Door

Options:

- Alternative Sizes Available
- Choice of Alternative Hardwood Frame and Lipping Species
- Choice of Alternative Colour Armaglaze Textured Facings to BS 4800 Range
- CERTIFIRE Approved Laminated Fire resistant Glass
- Smoke/Intumescent Seals

Warranties:

- Defects 12 Months Product Subject to Correct Maintenance and Installation if Applicable Excluding Wilful Damage Caused by Operator or Detainee and Any Paint Decoration & Hardware Supplied by Others if Applicable
- Start Date From Practical Completion on New Build Projects or Installation on Refurbishment/Upgrade Projects
- Extended Warranties Available

CLCS Range

Circulation & perimeter doors

9D020

Armaglaze Double Action Door

Technical Design:

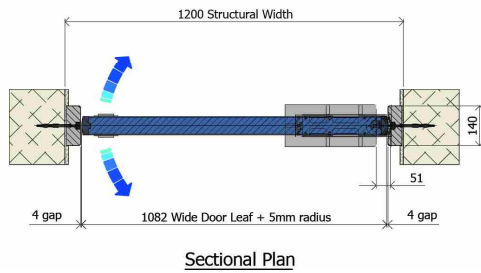
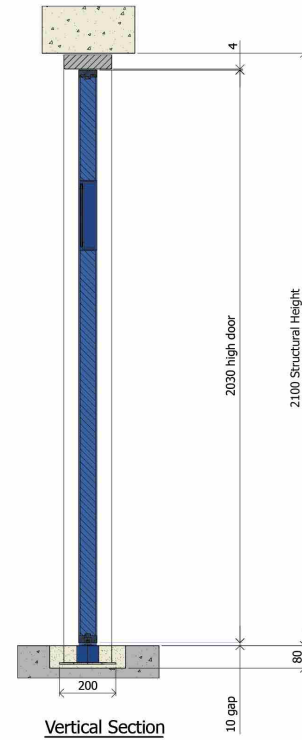
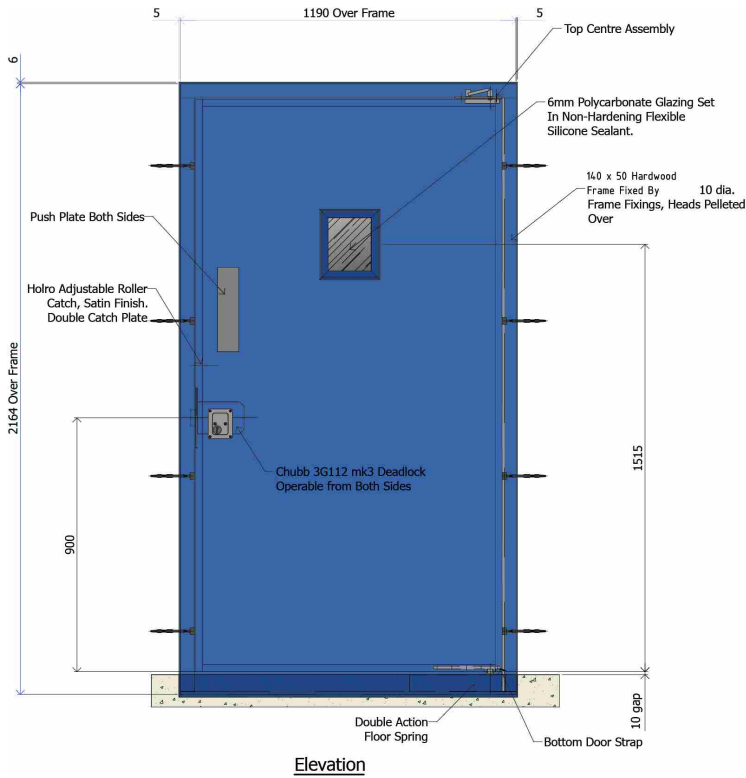

CLCS Range

Circulation & perimeter doors

9D023

Prison Control & Restraint (C&R) Door

Application:

A Chubb Locks Custodial Services Ltd HMPS specification control & Restraint (C&R) door for prison wings incorporating two shoot bolts, vision panel with privacy cover, pull handle and preparation for a Class 2 Chubb 3G112 heavy duty mortice deadlock. Conforms to the standards & specifications required by the Prison Service & Ministry of Justice.

Specification:

Specifications, Performance Data & Tolerances

- Conforms to the standards & specifications required by the Prison Service & Ministry of Justice

Door Frame

- 100x60x4mm & 100x100x4mm Hot Rolled Hollow Section Steel Frame to BS EN 10025:2004
- 12x12mm Solid Steel Rebates To BS EN 10025:2004 Stitch Welded All Round
- All Steelwork Shot Blasted to BS EN ISO 11124-4:1997
- 4mm Pressed Steel Threshold Section Electro-Zinc Coated to BS EN 10152:2009 Cast into Floor
- Steel Fabrication to BS EN ISO 9001: 2000
- Welding to BS EN 1011-2: 2001
- Frame Fixings Fully Site Welded Head Chemical Resin Anchors 8no.minimum per frame

Door Leaf

- 1.6mm thick Cold Rolled Steel Door Skins Both Sides Hot Dip Zinc Coated to BS EN 10346:2009
- 38x19x2mm Internal ERW Rectangular Steel Tube Skeleton Framework to BS EN 10305-3/5 Grade E220
- Internal Skeleton Framework Shot Blast to BS EN ISO 11124-4:1997
- Steel Fabrication to BS EN ISO 9001: 2000
- Welding to BS EN 1011-2: 2001
- Mineral Wool Insulation RWA40 to all Internal Voids to BS EN 13162:2001
- Tubular Pivot Hinge Full Length of Door Leaf as HMPS Specification
- Laminated Glass Vision Panel with Hinged Privacy Cover as HMPS Specification
- Preparation for Class 2 Chubb 3G112 Heavy Duty Mortice Deadlock Operable Both Sides
- Outer Steel Lock Box Welded Into Door Construction
- Two Heavy Duty Shoot Bolts Fitted To Secure Stairs Side
- Welded Steel Pull Handle Fitted To Secure Stairs Side

Standard Dimensions

- Structural Opening 1040mm Wide x 2060mm High
- Overall Door Frame 1020mm Wide x 2050mm High (Height From Finished Floor Level as Threshold Cast into Floor)
- Door Leaf 868.5mm Wide CL Hinge Tube x 1927mm High x 42mm Thick
- Frame Clearance 10mm Jambs, 10mm Head
- Door Leaf Clearance 3mm Leading Edge, 3mm hinge, 3mm head, 10mm undercut

Finish:

- Powder Coat Epoxy Primer to BS EN 12206-1:2004

CLCS Range

Circulation & perimeter doors

9D023

Prison Control & Restraint (C&R) Door

Options:

- Alternative Sizes Available
- Right Hand Open-In or Left Hand Open-Into Stairs Side (Open-Out Not Standard Specification)
- Polyester Powder Coat Matt 30% Gloss to Any Standard RAL No. to BS EN 12206-1:2004
- Cast-In in Lieu of Bolt-Fix Frame Arrangements
- Heavy Duty Wall Mounted Door Stop

Warranties:

- Defects 12 Months Product Subject to Correct Maintenance and Installation if Applicable Excluding Wilful Damage Caused by Operator or Detainee and Any Paint Decoration & Hardware Supplied by Others if Applicable
- Start Date From Practical Completion on New Build Projects or Installation on Refurbishment/Upgrade Projects
- Extended Warranties Available

CLCS Range Circulation & perimeter doors

9D023

Prison Control & Restraint (C&R) Door

Technical Design:

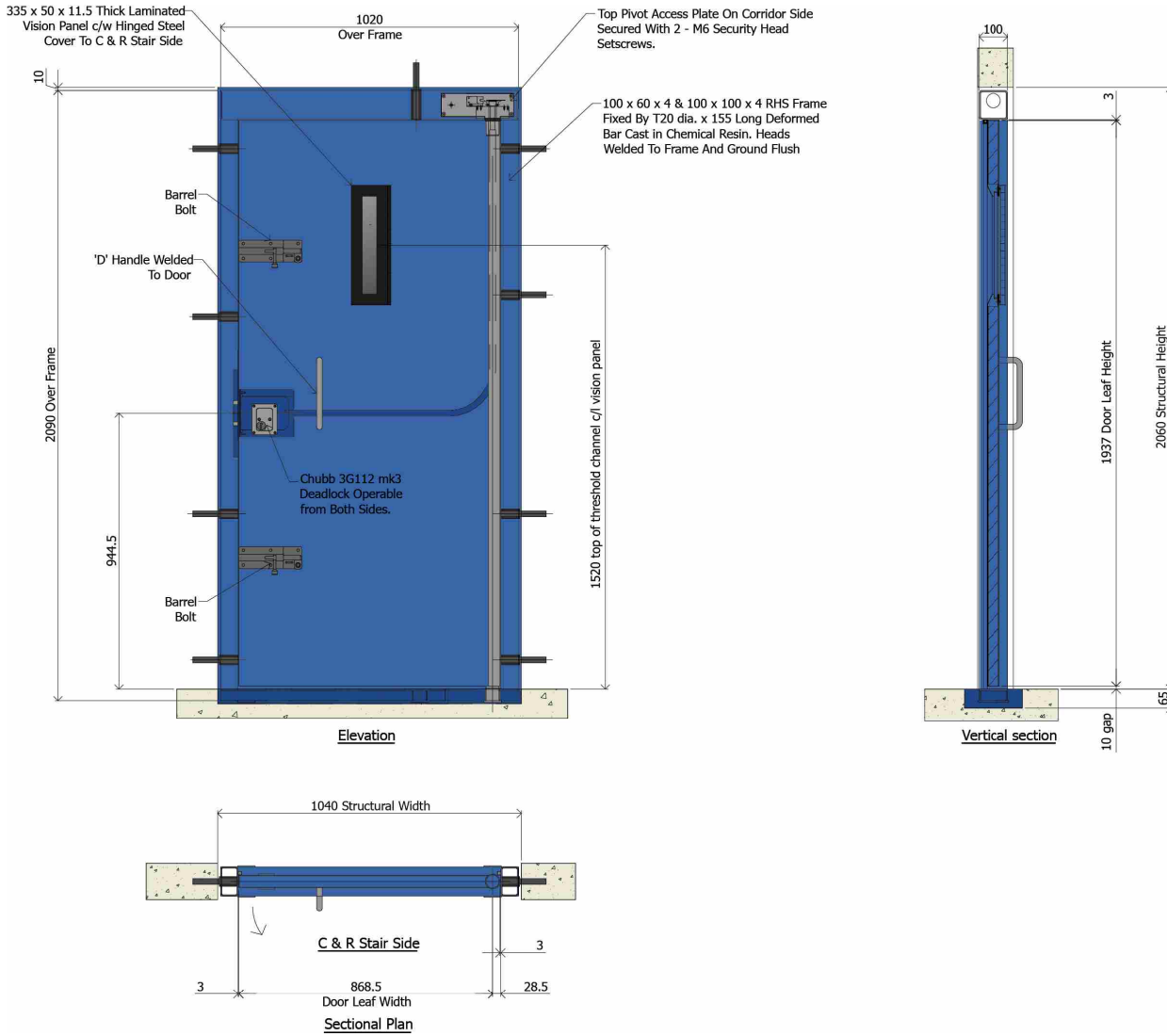

CLCS Range Personnel doors

9D026B

Steel Service Duct Door

Application:

A Chubb Locks Custodial Services Ltd steel CERTIFIRE approved door & frame service duct door with 60 mins fire resistance integrity typically located in-between cells. The door incorporates a Chubb 3G114 5 lever mortice deadlock, 3no. butt hinges and recessed pull handle outside. Conforms to the Police Buildings Custody Design Guide and National Police Estates Group Best Practice Document.

Specification:

Specifications, Performance Data & Tolerances

- Conforms to the Police Buildings Custody Design Guide
- Conforms to the National Police Estates Group Best Practice Document
- CERTIFIRE Approved Fire Resistance 60 mins Integrity to BS EN 1634-1:2000 and BS 476 part 22
- Typical Insulation Value 3.2W/m²k
- Hinges Tested to BS EN 1935: 2002 Grade 13 200,000 Cycles 120kg Door Leaf

Door Frame

- 1.5mm thick Pressed Steel Profile Frame 100x65x50mm 15mm Rebate Hot Dip Zinc Coated to BS EN 10346:2009
- 3 or 4 Sided Frame
- Knock-Down or Fully Welded Frame Joints
- Steel Fabrication to BS EN ISO 9001: 2000
- Welding to BS EN 1011-2: 2001
- Frame Fixings 7.5mm dia x 72mm CSK T30 Concrete Screws 8no. minimum per frame

Door Leaf

- 1.2mm thick Cold Rolled Steel Door Skins Both Sides & All Edges Hot Dip Zinc Coated to BS EN 10346:2009
- Pre-Expanded Small Cell Honeycomb Core
- Heat Pressure Bonded 80C @ 500lbs/in² for 7mins
- Adhesive Apollo A9267 PU
- 102mm x 76mm Stainless Steel Grade 304 High Performance Ball Bearing Butt Hinges 3no. per Leaf
- Chubb 3G114 5 Lever Mortice Lock Operable Outside Only

Standard Dimensions

- Structural Opening 600mm Wide x 1800mm High
- Overall Door Frame 590mm Wide x 1790mm High (4 Sided Frame) 1793mm (3 Sided Frame)
- Door Leaf 484mm Wide x 1684mm High 4 Sided Frame, 1730mm 3 Sided Frame x 44mm Thick
- Frame Clearance 5mm Jamb, 5mm Head & Bottom 4 Sided Frame, 7mm 3 Sided Frame
- Door Leaf Clearance 3mm Leading Edge, 3mm hinge, 3mm head & Bottom 4 Sided Frame, 10mm undercut 3 Sided Frame

Finish:

- Powder Coat Epoxy Primer to BS EN 12206-1:2004

CLCS Range Personnel doors

9D026B

Steel Service Duct Door

Options:

- Alternative Sizes Available
- Right Hand or Left Hand
- Polyester Powder Coat Matt 30% Gloss to Any Standard RAL No. to BS EN 12206-1:2004
- Smoke Seals
- Double Leaf arrangement
- Door Position Contact Switch
- Butt Hinges Incorporating Dog Bolts

Warranties:

- Defects 12 Months Product Subject to Correct Maintenance and Installation if Applicable Excluding Wilful Damage Caused by Operator or Detainee and Any Paint Decoration & Hardware Supplied by Others if Applicable
- Start Date From Practical Completion on New Build Projects or Installation on Refurbishment/Upgrade Projects
- Extended Warranties Available

CLCS Range Personnel doors 9D026B Steel Service Duct Door

Technical Design:

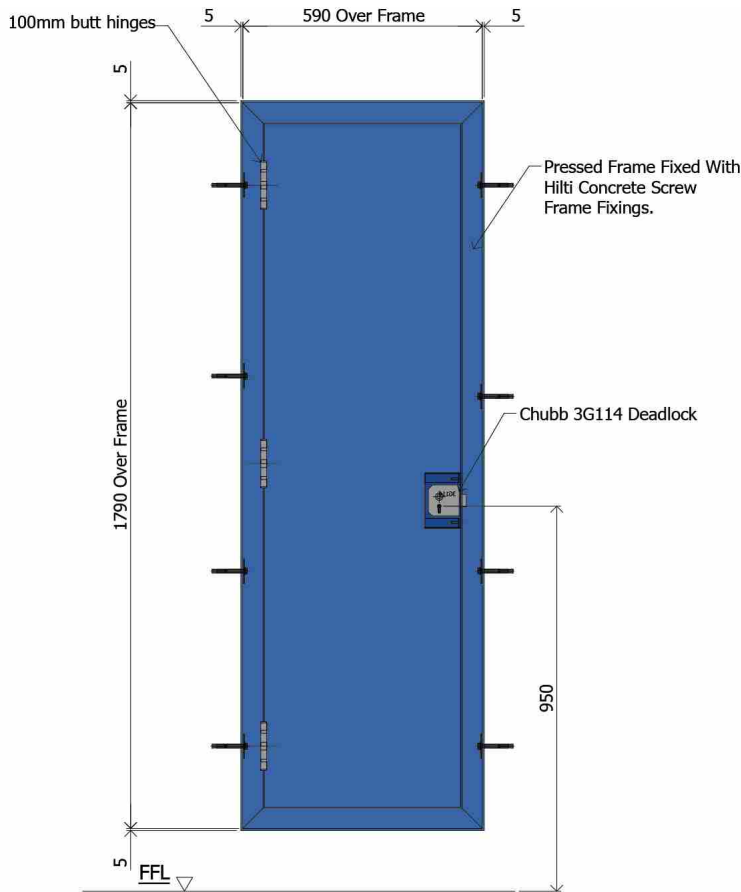

Elevation

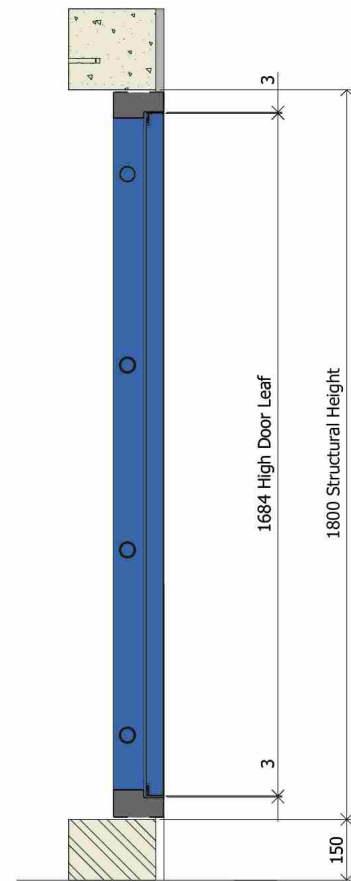

Vertical Section

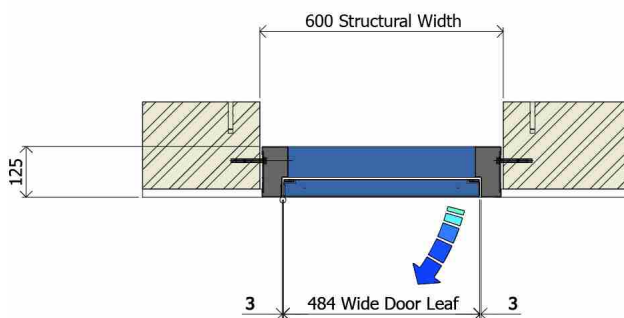

Sectional Plan

CLCS Range Personnel doors

9D026C

Steel Service Duct Door with Integral Shoe Locker

Application:

A Chubb Locks Custodial Services Ltd steel door & frame service duct door with integral shoe locker typically located in-between cells. The door incorporates a Chubb 3G114 5 lever mortice deadlock, 3no. butt hinges and recessed pull handle outside. Conforms to the Police Buildings Custody Design Guide and National Police Estates Group Best Practice Document.

Specification:

Specifications, Performance Data & Tolerances

- Conforms to the Police Buildings Custody Design Guide
- Conforms to the National Police Estates Group Best Practice Document
- Typical Insulation Value 3.2W/m²k
- Hinges Tested to BS EN 1935: 2002 Grade 13 200,000 Cycles 120kg Door Leaf

Door Frame

- 1.5mm thick Pressed Steel Profile Frame 100x65x50mm 15mm Rebate Hot Dip Zinc Coated to BS EN 10346:2009
- 3 or 4 Sided Frame
- Knock-Down or Fully Welded Frame Joints
- Steel Fabrication to BS EN ISO 9001: 2000
- Welding to BS EN 1011-2: 2001
- Frame Fixings 7.5mm dia x 72mm CSK T30 Concrete Screws 8no. minimum per frame

Door Leaf

- 1.2mm thick Cold Rolled Steel Door Skins Both Sides & All Hot Dip Zinc Coated to BS EN 10346:2009
- Pre-Expanded Small Cell Honeycomb Core
- Heat Pressure Bonded 80C @ 500lbs/in² for 7mins
- Adhesive Apollo A9267 PU
- 1.5mm thick Pressed Steel Integral Shoe Locker with Simple Cam Lock
- 102mm x 76mm Stainless Steel Grade 304 High Performance Ball Bearing Butt Hinges 3no. per Leaf
- Chubb 3G114 5 Lever Mortice Lock Operable Outside Only
- Recessed Pull Handle Outside Cast Stainless Steel Grade 304

Standard Dimensions

- Structural Opening 600mm Wide x 1800mm High
- Overall Door Frame 590mm Wide x 1790mm High (4 Sided Frame) 1793mm (3 Sided Frame)
- Door Leaf 484mm Wide x 1684mm High 4 Sided Frame, 1730mm 3 Sided Frame x 44mm Thick
- Frame Clearance 5mm Jamb, 5mm Head & Bottom 4 Sided Frame, 7mm 3 Sided Frame
- Door Leaf Clearance 3mm Leading Edge, 3mm hinge, 3mm head & Bottom 4 Sided Frame, 10mm undercut 3 Sided Frame

Finish:

- Powder Coat Epoxy Primer to BS EN 12206-1:2004

CLCS Range Personnel doors

9D026C

Steel Service Duct Door with Integral Shoe Locker

Options:

- Alternative Sizes Available
- Right Hand or Left Hand
- Polyester Powder Coat Matt 30% Gloss to Any Standard RAL No. to BS EN 12206-1:2004
- Smoke Seals
- Double Leaf arrangement
- Door Position Contact Switch
- Butt Hinges Incorporating Dog Bolts

Warranties:

- Defects 12 Months Product Subject to Correct Maintenance and Installation if Applicable Excluding Wilful Damage Caused by Operator or Detainee and Any Paint Decoration & Hardware Supplied by Others if Applicable
- Start Date From Practical Completion on New Build Projects or Installation on Refurbishment/Upgrade Projects
- Extended Warranties Available

CLCS Range Personnel doors

9D026C

Steel Service Duct Door with Integral Shoe Locker

Technical Design:

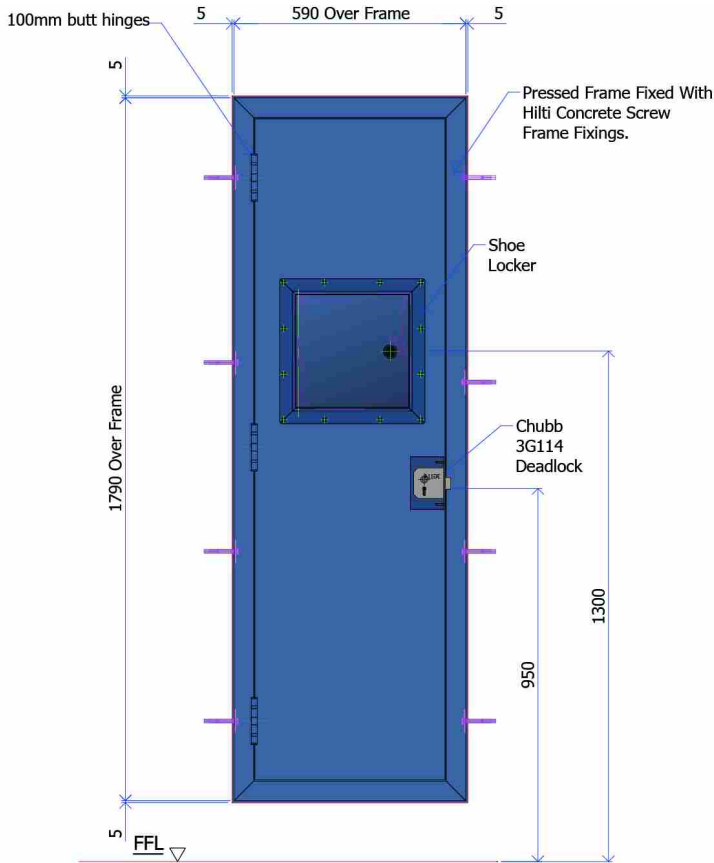

Elevation

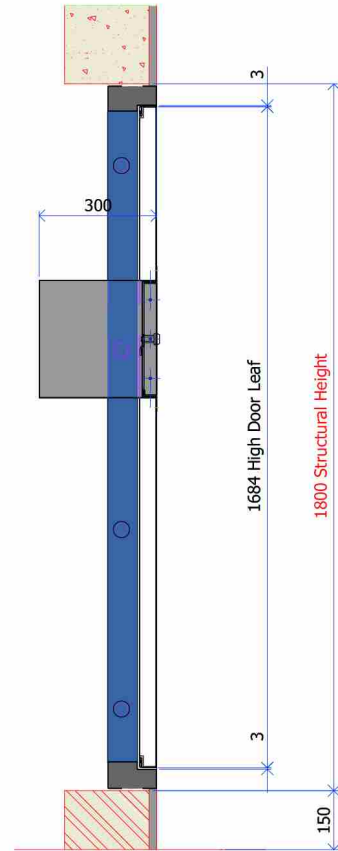

Vertical Section

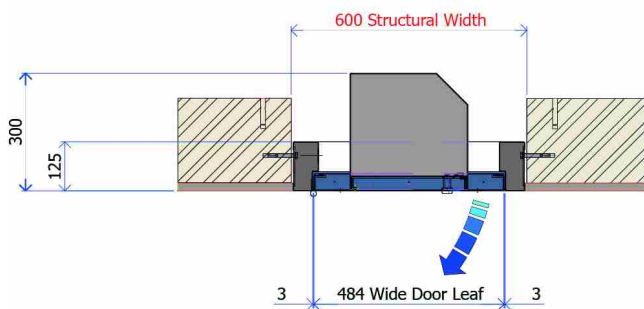

Sectional Plan

CLCS Range Personnel doors

9D026D

Steel Service Duct Door Pair FD60

Application:

A Chubb Locks Custodial Services steel CERTIFIRE approved fire door & frame with 60 mins fire resistance integrity for use in prison wings. The door incorporates preparation for a NOMS approved deadlock, flush bolts & 3no. butt hinges per leaf.



Specification:

Specifications, Performance Data & Tolerances

- CERTIFIRE Approved Fire Resistance 60 mins Integrity to BS EN 1634-1:2000 and BS 476 part 22
- Typical Insulation Value 3.2W/m²k
- Hinges Tested to BS EN 1935:2002 Grade 13 200,000 Cycles 120kg Door Leaf

Door Frame

- 1.5mm thick Pressed Steel Profile Frame 100x65x50mm 15mm Rebate Hot Dip Zinc Coated to BS EN 10346:2009
- 3 Sided Frame with Low Profile Aluminium Threshold Plate
- Knock-Down Frame Joints
- Self-Adhesive Neoprene Smoke Seals
- Steel Fabrication to BS EN ISO 9001: 2000
- Welding to BS EN 1011-2: 2001
- Frame Fixings 7.5mm dia x 72mm CSK T30 Concrete Screws 10no. minimum per frame

Door Leafs

- 1.5mm thick Cold Rolled Steel Door Skins Both Sides & All Edges Hot Dip Zinc Coated to BS EN 10346:2009
- Reinforced Door Construction
- Pre-Expanded Small Cell Honeycomb Core
- Heat Pressure Bonded 80C @ 500lbs/in² for 7mins
- Adhesive Apollo A9267 PU
- 102mm x 76mm Stainless Steel Grade 304 High Performance Ball Bearing Butt Hinges 3no. per Leaf
- Outer Steel Lock Box Welded Into Internal Door Construction
- Active Door leaf Prepared for NOMS Approved Deadlock Supplied & Fitted By Others
- Inactive Leaf Fitted with Two Fire Rated Steel Flush Bolts

Standard Dimensions

- Structural Opening 2186mm Wide x 2070mm High
- Overall Door Frame 2176mm Wide x 2063mm High
- Door Leaf 1033mm Wide x 2003mm High x 44mm Thick
- Frame Clearance 5mm Jamb, 7mm Head
- Door Leaf Clearance 4mm Leading Edge, 3mm hinge, 3mm head, 7mm undercut

Finish:

- Powder Coat Epoxy Primer to BS EN 12206-1:2004

CLCS Range Personnel doors

9D026D

Steel Service Duct Door Pair FD60

Options:

- Alternative Sizes Available
- Polyester Powder Coat Matt 30% Gloss to Any Standard RAL No. to BS EN 12206-1:2004
- 4 Sided Frame
- Overhead Transom Panel
- Half Wrap Around Frame Detail
- Automatic Bottom Drop Seal
- Welded Frame in Lieu of Knock-Down
- Door Position Contact Switch One or Both Leafs
- Hinges Incorporating Dog Bolts
- Kick Plates
- Intumescent Mastic Around Frame

Warranties:

- Defects 12 Months Product Subject to Correct Maintenance and Installation if Applicable Excluding Wilful Damage Caused by Operator or Detainee and Any Paint Decoration & Hardware Supplied by Others if Applicable
- Start Date From Practical Completion on New Build Projects or Installation on Refurbishment/Upgrade Projects
- Extended Warranties Available

CLCS Range Personnel doors

9D026D

Steel Service Duct Door Pair FD60

Technical Design:

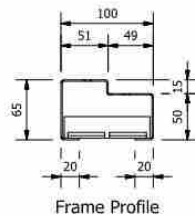
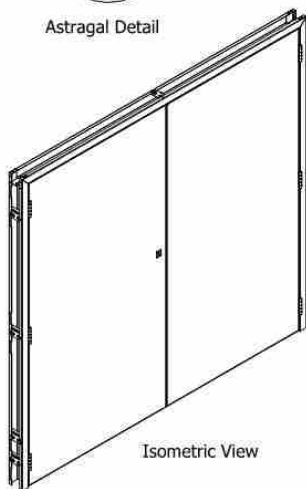
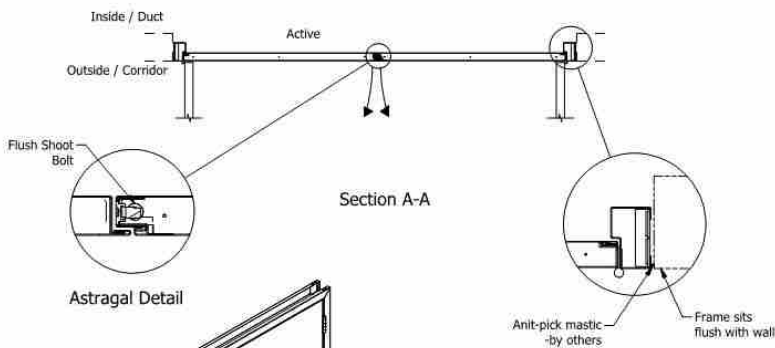
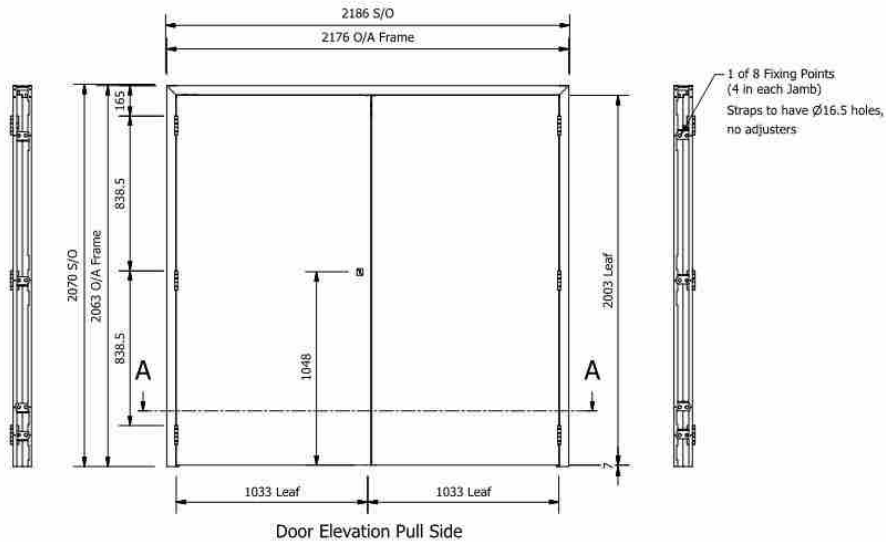

CLCS Range Personnel doors

9D027A

Timber Personnel Door

Application:

A Chubb Locks Custodial Services Ltd solid timber door & frame personnel door with optional 60 mins fire resistance integrity typically used for staff offices, toilets etc. within custody. The door incorporates a Chubb 3J60 5 lever mortice deadlocking latch & knob furniture both sides and 4no. butt hinges. Conforms to the Police Buildings Custody Design Guide and National Police Estates Group Best Practice Document.

Specification:

Specifications, Performance Data & Tolerances

- Conforms to the Police Buildings Custody Design Guide
- Conforms to the National Police Estates Group Best Practice Document
- Hinges Tested to BS EN 1935: 2002 Grade 13 200,000 Cycles 120kg Door Leaf

Door Frame

- Monolithic Hardwood Frame Section 3 Sides 125x75x50mm 25mm Rebate
- Sapele Hardwood Kiln Dried Moisture Content 10 -14% Density 640kg/m³
- Mortice & Tenon Joints
- Counterbored & Pelleted Fixings
- Frame Fixings 12mm dia x 100mm Sleeve Anchors 8no. minimum per frame

Door Leaf

- FD60 Certified 54mm thick Solid Timber Core Mixed Tropical 3 Layer Lamels Hardwood Rails & Stiles Average Density 460 - 500kg/m³
- Typically 9mm – 12mm Hardwood Lipping Bonded All 4 Edges Minimum Density 640kg/m³ 15% MC
- Chubb 3J60 5 Lever Mortice Deadlocking latch with knob furniture both sides
- 102mm x 76mm Stainless Steel Grade 304 High Performance Ball Bearing Butt Hinges 4no. per Leaf

Standard Dimensions

- Structural Opening 910mm Wide x 2100mm High
- Overall Door Frame 900mm Wide x 2093mm High
- Door Leaf 794mm Wide x 2030mm High Excluding Hinge(s) x 54mm Thick
- Frame Clearance 5mm Jambs, 7mm Head
- Door Leaf Clearance 3mm Leading Edge, 3mm hinge, 3mm head, 10mm undercut

Finish:

- Water Based Two Coat Prime Paint

CLCS Range Personnel doors

9D027A

Timber Personnel Door

Options:

- Alternative Sizes Available
- Right Hand Open-In/Out or Left Hand Open-In/Out
- Certified Fire Resistance 60 mins Integrity to BS EN 1634-1:2000 or BS 476 part 22
- Choice of Alternative Hardwood Frame and Lipping Species
- Choice of Veneer Finishes to Door Leaf with Matching or Complimentary Harwood Door Frames
- Lacquer Finish if Veneered Two Pack Semi-Matt 20% Sheen
- Ligature Resisting Hardware
- Smoke Seals
- Laminated Glass vision Panel
- Home Office Approved Hit & Miss Viewer
- Chubb WS9 Wide Angle Magnification Viewer
- Type 2 Chubb 3G112 Heavy Duty Mortice Lock Operable Both Sides
- Intumescent Seals
- Double Leaf Arrangement with Rebated Leading Edge Lipping
- Overhead Hydraulic Door Closer with Adjustable Closing Force EN 3-6 and Back Check
- Electro-Magnetic Hold Open Door Closer
- Door Position Contact Switch
- Continuous Hinge in Lieu of Butt Hinges
- Alternative Chemical Resin Frame fixings
- Heavy Duty Wall Mounted Door Stop
- Butt Hinges Incorporating Dog Bolts

Warranties:

- Defects 12 Months Product Subject to Correct Maintenance and Installation if Applicable Excluding Wilful Damage Caused by Operator or Detainee and Any Paint Decoration & Hardware Supplied by Others if Applicable
- Start Date From Practical Completion on New Build Projects or Installation on Refurbishment/Upgrade Projects
- Extended Warranties Available

CLCS Range Personnel doors

9D027A

Timber Personnel Door

Technical Design:

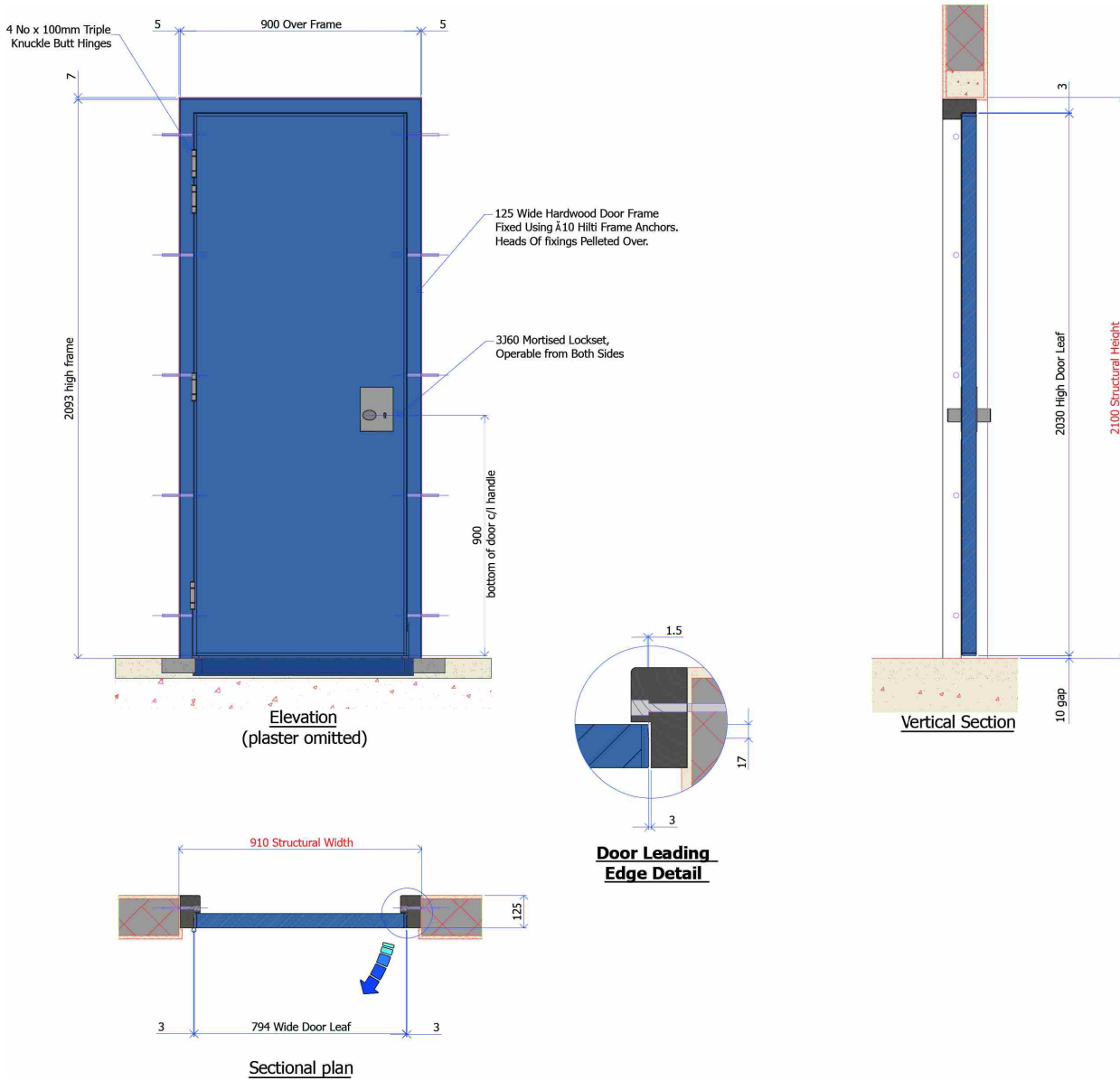

CLCS Range Personnel doors

9D027B

Half Glazed Timber Personnel Door

Application:

A Chubb Locks Custodial Services Ltd solid timber door & frame personnel door with optional 60 mins fire resistance integrity typically used for staff offices, toilets etc. within custody. The door incorporates a laminated glass vision panel, Chubb 3J60 5 lever mortice deadlocking latch & knob furniture both sides and 4no. butt hinges. Conforms to the Police Buildings Custody Design Guide and National Police Estates Group Best Practice Document.

Specification:

Specifications, Performance Data & Tolerances

- Conforms to the Police Buildings Custody Design Guide
- Conforms to the National Police Estates Group Best Practice Document
- Hinges Tested to BS EN 1935: 2002 Grade 13 200,000 Cycles 120kg Door Leaf

Door Frame

- Monolithic Hardwood Frame Section 3 Sides 125x75x50mm 25mm Rebate
- Sapele Hardwood Kiln Dried Moisture Content 10 -14% Density 640kg/m³
- Mortice & Tenon Joints
- Counterbored & Pelleted Fixings
- Frame Fixings 12mm dia x 100mm Sleeve Anchors 8no. minimum per frame

Door Leaf

- FD60 Certified 54mm thick Solid Timber Core Mixed Tropical 3 Layer Lamels Hardwood Rails & Stiles Average Density 460 - 500kg/m³
- Typically 9mm – 12mm Hardwood Lipping Bonded All 4 Edges Minimum Density 640kg/m³ 15% MC
- Chubb 3J60 5 Lever Mortice Deadlocking latch with knob furniture both sides
- 102mm x 76mm Stainless Steel Grade 304 High Performance Ball Bearing Butt Hinges 4no. per Leaf
- Laminated Glass vision Panel with Hardwood Beading

Standard Dimensions

- Structural Opening 910mm Wide x 2100mm High
- Overall Door Frame 900mm Wide x 2093mm High
- Door Leaf 794mm Wide x 2030mm High Excluding Hinge(s) x 54mm Thick
- Frame Clearance 5mm Jamb, 7mm Head
- Door Leaf Clearance 3mm Leading Edge, 3mm hinge, 3mm head, 10mm undercut

Finish:

- Water Based Two Coat Prime Paint

CLCS Range Personnel doors

9D027B

Half Glazed Timber Personnel Door

Options:

- Alternative Sizes Available
- Right Hand Open-In/Out or Left Hand Open-In/Out
- Certified Fire Resistance 60 mins Integrity to BS EN 1634-1:2000 or BS 476 part 22
- Choice of Alternative Hardwood Frame and Lipping Species
- Choice of Veneer Finishes to Door Leaf with Matching or Complimentary Harwood Door Frames
- Lacquer Finish if Veneered Two Pack Semi-Matt 20% Sheen
- Ligature Resisting Hardware
- Smoke Seals
- Home Office Approved Hit & Miss Viewer
- Chubb WS9 Wide Angle Magnification Viewer
- Type 2 Chubb 3G112 Heavy Duty Mortice Lock Operable Both Sides
- Intumescent Seals
- Double Leaf Arrangement with Rebated Leading Edge Lipping
- Overhead Hydraulic Door Closer with Adjustable Closing Force EN 3-6 and Back Check
- Electro-Magnetic Hold Open Door Closer
- Door Position Contact Switch
- Continuous Hinge in Lieu of Butt Hinges
- Alternative Chemical Resin Frame fixings
- Heavy Duty Wall Mounted Door Stop
- Butt Hinges Incorporating Dog Bolts

Warranties:

- Defects 12 Months Product Subject to Correct Maintenance and Installation if Applicable Excluding Wilful Damage Caused by Operator or Detainee and Any Paint Decoration & Hardware Supplied by Others if Applicable
- Start Date From Practical Completion on New Build Projects or Installation on Refurbishment/Upgrade Projects
- Extended Warranties Available

CLCS Range Personnel doors

9D027B

Half Glazed Timber Personnel Door

Technical Design:

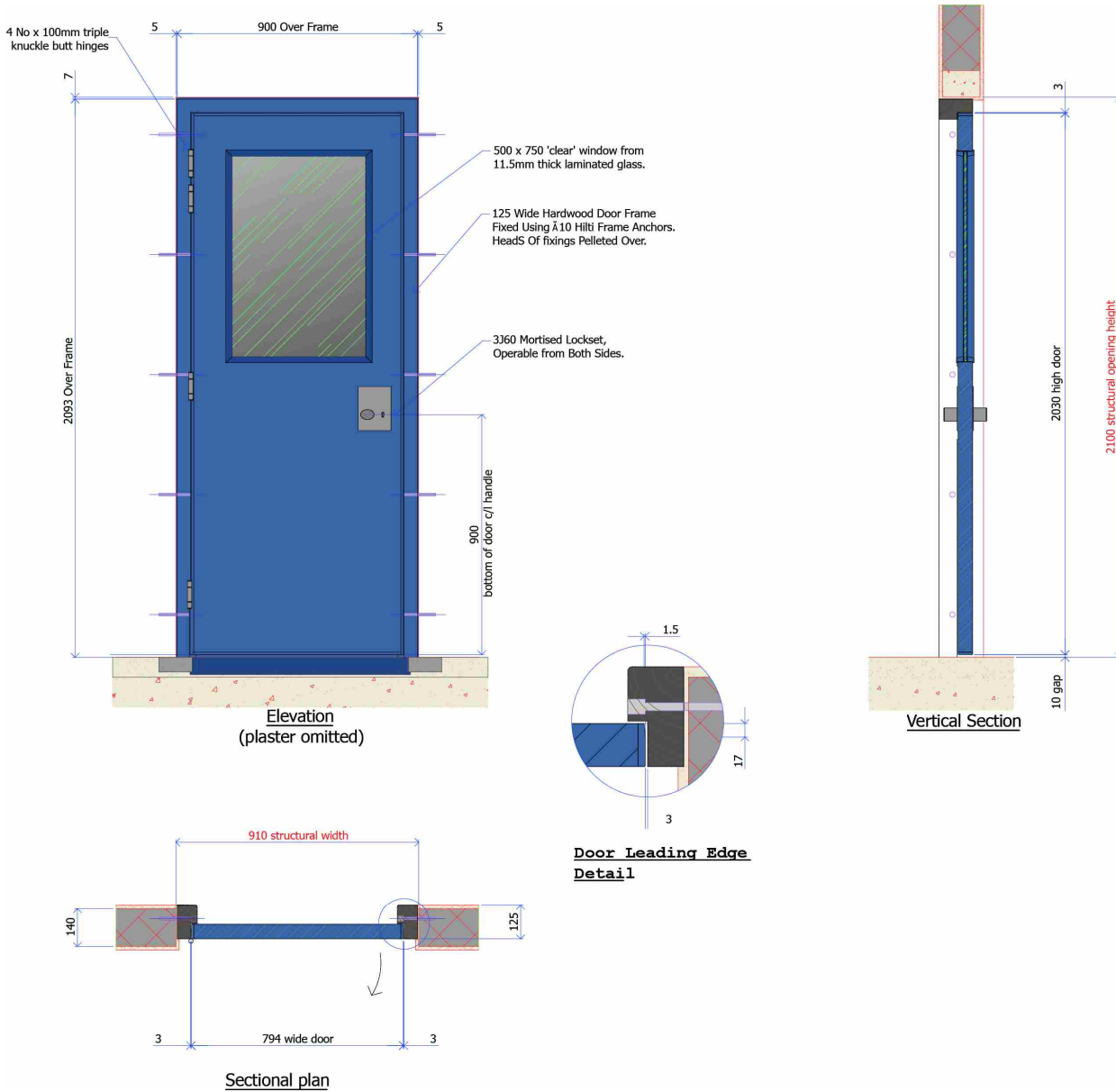

CLCS Range Personnel doors

9D028

Firearms Security Door

Application:

A Chubb Locks Custodial Services Ltd heavy duty secure steel door constructed in accordance with The Home Office Firearms Security Handbook 2005 and The Health & Safety Executive Circular to Chief Officers of Police Mo.1 2005 for the safe storage of firearms.

Specification:

Specifications, Performance Data & Tolerances

- Conforms to the Health & Safety Executive Circular to Chief Officers of Police No.1 2005 for the Security of Licenced & Registered Explosives Stores & Registered Premises
- Conforms to the Firearms Security Handbook 2005 Produced By The Home Office, The Associations of Chief Police Officers and The British Sports Council

Door Frame

- 100x75x10mm Rolled Steel Angle 3 Sided Frame to BS EN 10025:2004
- 100x10mm Flat Section Continuous Fixing Plates 3 Sides to BS EN 10025:2004
- 100x10mm Steel Threshold Plate
- All Steelwork Shot Blasted to BS EN ISO 11124-4:1997
- Steel Fabrication to BS EN ISO 9001: 2000
- Welding to BS EN 1011-2: 2001
- Wall Fixings Hilti HSL-TZ M8/20 Sleeve Anchors 24no. min

Door Leaf

- 10mm thick One Piece Cold Rolled Steel Electro-Zinc Coated to BS EN 10152:2009
- All Edges De-burred & Ground Smooth
- 8mm Dia x 150mm Welded Steel Pull Handle Outside Deliberately Weak So Cannot Be Used to Attack The Door
- Steel Fabrication to BS EN ISO 9001: 2000
- Welding to BS EN 1011-2: 2001
- 2no. Chubb 3G317 Heavy Duty Mortice Deadlocks Keyed to Differ
- Locks Mounted into Reinforced Outer Steel Boxes Continuously Welded to Door Leaf
- Anti-Drill Lock Plates Welded To Outside Of Door Leaf
- 3no. Heavy Duty Anti-Lift Strap Hinges Continuously Welded to Door Leaf & Frame
- 4no. Heavy Duty Steel Hinge Bolts Continuously Welded to Door Leaf

Standard Dimensions

- Structural Opening 910mm Wide x 2100mm High
- Overall Door Frame 896mm Wide x 2092mm High (Height From Finished Floor Level as Threshold Cast into Floor)
- Door Leaf 836mm Wide x 2053mm High Excluding Hinge(s) x 10mm Thick
- Frame Clearance 7mm Jambs, 8mm Head
- Door Leaf Clearance 20mm Leading Edge, 20mm hinge, 20mm head, 10mm undercut

Finish:

- Powder Coat Epoxy Primer to BS EN 12206-1:2004

CLCS Range Personnel doors

9D028

Firearms Security Door

Options:

- Alternative Sizes Available
- Right Hand Open Out or Left Hand Open-Out (Open In Not Permitted)
- Polyester Powder Coat Matt 30% Gloss to Any Standard RAL No. to BS EN 12206-1:2004
- Heavy Duty Wall Mounted Door Stop

Warranties:

- Defects 12 Months Product Subject to Correct Maintenance and Installation if Applicable Excluding Wilful Damage Caused by Operator or Detainee and Any Paint Decoration & Hardware Supplied by Others if Applicable
- Start Date From Practical Completion on New Build Projects or Installation on Refurbishment/Upgrade Projects
- Extended Warranties Available

CLCS Range Personnel doors 9D028 Firearms Security Door

Technical Design:

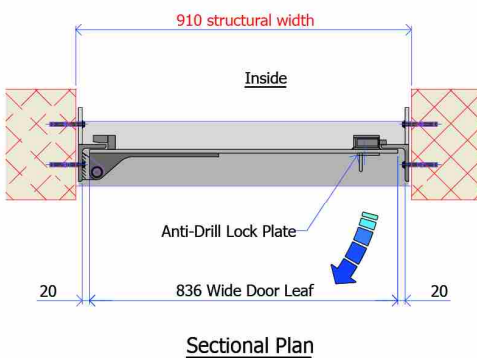
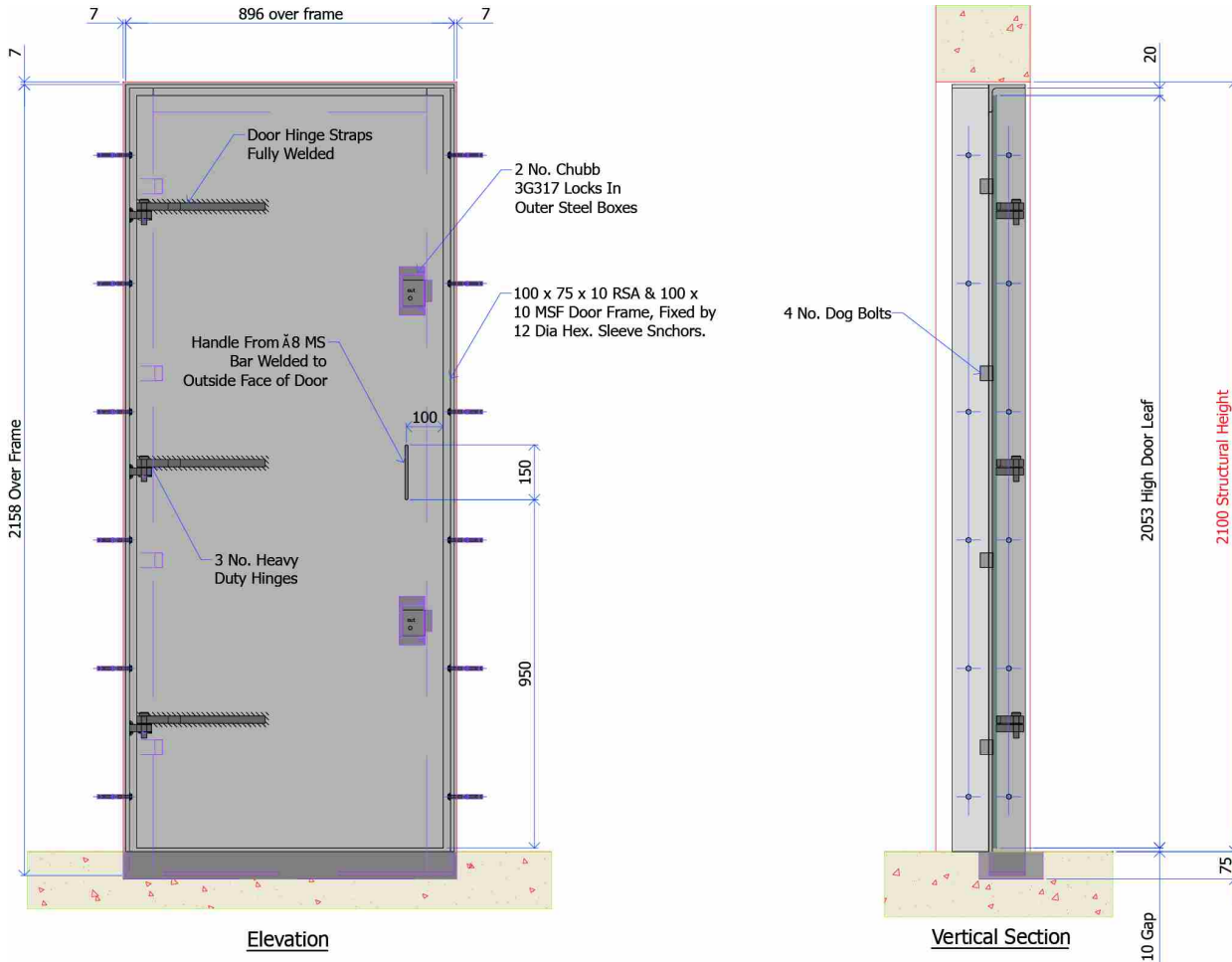

CLCS Range Personnel doors

9D030

Decency Door

Application:

A Chubb Locks Custodial Services Ltd solid timber decency door & frame typically used in shower facilities located within custody. The door incorporates a heavy duty roller catch and 3no. butt hinges. Conforms to the Police Buildings Custody Design Guide and National Police Estates Group Best Practice Document.

Specification:

Specifications, Performance Data & Tolerances

- Conforms to the Police Buildings Custody Design Guide
- Conforms to the National Police Estates Group Best Practice Document
- Hinges Tested to BS EN 1935: 2002 Grade 13 200,000 Cycles 120kg Door Leaf

Door Frame

- Two Part Ash Hardwood Frame Posts 2 Sides 125x45mm Plus 40x20mm Planted Rebates
- Loose Ash Rebate Stops Secured by CSK Security Head Screws
- European Ash Hardwood Kiln Dried Moisture Content 10 -14% Density 710kg/m³
- Concealed Frame Fixings Beneath Rebate Stops
- Frame Fixings Hilti HRD-CR 10x140mm Anchors 6no. minimum per door

Door Leaf

- 44mm thick Solid Timber Core Mixed Tropical 3 Layer Lamels Hardwood Rails & Stiles Average Density 460 - 500kg/m³
- White Matt Formica Facing Heat Pressure Bonded to Both Sides 45C @2500lbs/in² for 6 mins
- Typically 9mm – 12mm Hardwood Ash Lipping Bonded All 4 Edges Minimum Density 710kg/m³ 10 -14% MC
- Heavy Duty Roller Catch
- 102mm x 76mm Stainless Steel Grade 304 High Performance Ball Bearing Butt Hinges 3no. per Leaf

Standard Dimensions

- Structural Opening 1000mm Wide
- Overall Door Frame Posts 990mm Wide x 1515mm High 400mm From FFL
- Door Leaf 894mm Wide x 1515mm High Excluding Hinge(s) x 46mm Thick
- Frame Clearance 5mm Jambs
- Door Leaf Clearance 3mm Leading Edge, 3mm hinge, 400mm from FFL

Finish:

- Lacquer Two Pack Semi-Matt 20% Sheen

Options:

- Alternative Sizes Available
- Right Hand Open-Out or Left Hand Open-Out
- Choice of Alternative Hardwood Frame and Lipping Species
- Choice of Alternative Colour Formica Facings
- Recessed Pull Handle Outside Only Stainless Steel Grade 304
- Stainless Steel Push Plate Inside Only Grade 304

CLCS Range Personnel doors

9D030

Decency Door

Warranties:

- Defects 12 Months Product Subject to Correct Maintenance and Installation if Applicable Excluding Wilful Damage Caused by Operator or Detainee and Any Paint Decoration & Hardware Supplied by Others if Applicable
- Start Date From Practical Completion on New Build Projects or Installation on Refurbishment/Upgrade Projects
- Extended Warranties Available

CLCS Range Personnel doors 9D030 Decency Door

Technical Design:

