

4

ATTACHING THE MOUNTING PLATE

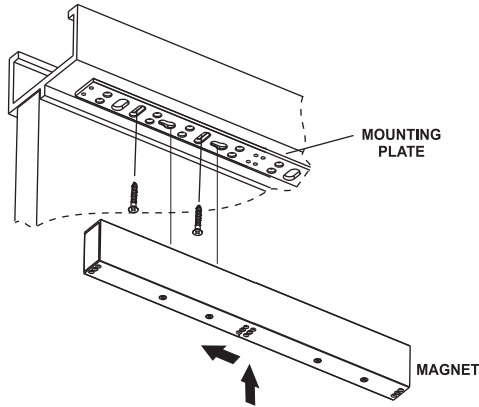

- Use the supplied template to determine the correct location and size of mounting holes for both the door and frame header. Ensure that the door opens away from the EML. In the case of a single door, the EML is positioned as close as possible to the vertical section of the door jamb.
- Loosely install the mounting plate using two of the supplied philips head mounting screws in the elongated slots. Attach the EML to the mounting plate.

5

MOUNTING OF THE ARMATURE

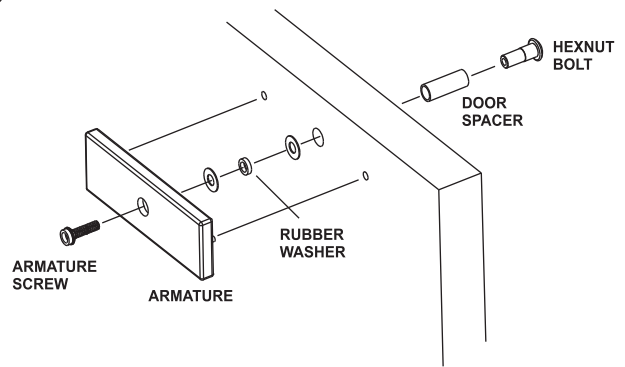

- Align the armature plate on the door using sight or the template supplied.
- Mark and drill holes then mount the armature to the door. Make sure that the armature plate is not over tightened and that it is installed as shown in the following diagram. The armature plate must be free to self align with the door.

6

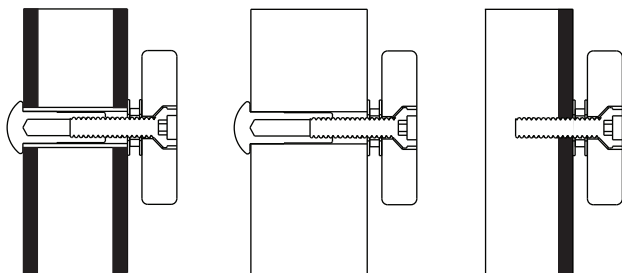

HOLLOW CORE DOOR ENLARGE HOLE TO Ø16mm
SOLID CORE DOOR ENLARGE HOLE TO Ø12mm
REINFORCED DOOR TAP M6X1.0 for Z4 TAP M8X1.25 for Z8

MOUNTING ARMATURE ON DIFFERENT DOOR TYPES

7

MOUNTING OF THE MAGNET

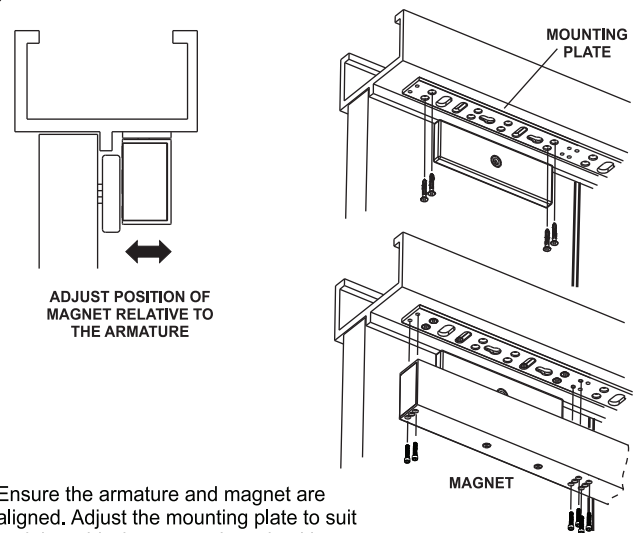

- Ensure the armature and magnet are aligned. Adjust the mounting plate to suit and then drill the appropriate sized holes in the door header for the remaining attachment screws.

MOUNTING ON GLASS DOORS

Assemble Glass Door brackets as shown.

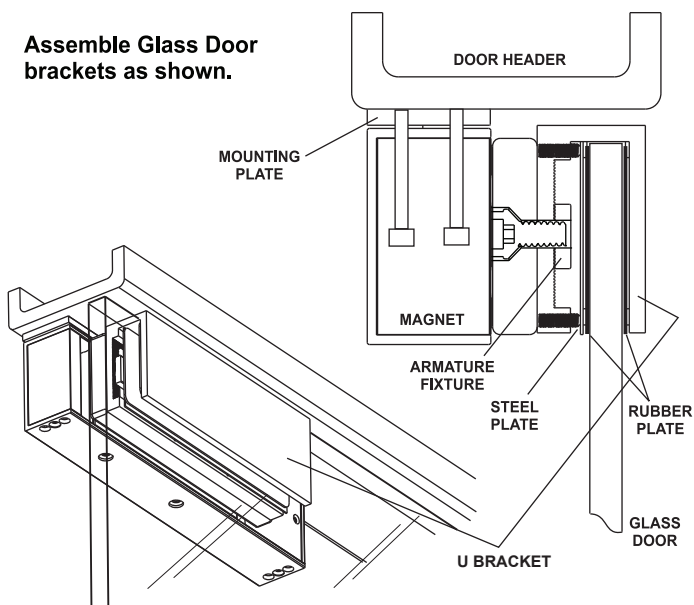

ELECTRICAL CONNECTION

- Connect electrical wiring according to the local appropriate wiring rules. Make sure the correct voltage on the PCB has been selected prior to turning on the power. Failure to do this could damage the unit. Factory default voltage is set to 12volts DC.
- **Note: If a door closer has been fitted then adjust it so that the armature closes lightly against the magnet. This will avoid damage to the magnet and will also make the door operation quieter.**

MAINTENANCE

- The electro magnetic lock does not require much ongoing maintenance. The customer should be advised to keep the mating faces of the armature and magnet clean, making sure that no abrasive materials are used to clean the faces.
- **Do not spray the magnet or armature with any chemicals such as lacquer as the release of the electro magnet may be compromised.**