



ASSA ABLOY Triton² Patented Master Key System

Unrivalled security and master keying capability
giving you superior key control

ASSA ABLOY
Opening Solutions

Experience a safer
and more open world

ASSA ABLOY high security cylinder systems

The first choice for high quality, patent protected cylinder systems

Unrivalled heritage and quality

Since manufacturing our first cylinder in 1939, we've built-up an unrivalled reputation for high quality, patented cylinder platforms, designed for the toughest and most demanding environments in the commercial sector.

With a heritage of quality and understanding the importance of high security, combined with forward thinking innovation, we are the market leaders in commercial patented cylinder systems.

Expertly designed and tested with precision engineering, our cylinders are designed to last, so you can be confident you have a durable and reliable system that will last for decades to come.



Master keying excellence

Our market leading master keying expertise is second to none.

Our specialist in-house master keying department will ensure your system is properly planned to accommodate all future expansion, therefore avoiding potentially costly long-term problems possible with an 'off the shelf' system.

Once your system has been designed the cylinders can be assembled and supplied by a local ASSA ABLOY Partner, specially trained to provide advice and ongoing support, with all elements of your master key system.

Expert service and support

In addition to expert service from the ASSA ABLOY Partners, our team of Sector Specialists are available to support. They have a wealth of experience, within a range of environments in the commercial sector.

Our Sector Specialists offer a full site survey audit and will provide advice and recommendations on your suite. They will then work together with your chosen ASSA ABLOY Partner to meet your requirements.

For a bespoke and optimised master key specification, consult with your ASSA ABLOY Sector Specialist and ASSA ABLOY Partner at the earliest stage of your project.



Patent protection and key control

For your security and peace of mind

Key protection

Key protection defends against the more insidious threat of intruders, using unauthorised copies of keys to gain access.

For ASSA ABLOY the protection and safeguarding of the end user is essential. Our concept of key control is unique and is part of our commitment to our customers and protection of their assets, buildings and staff.

Effective security requires effective control and management of keys. This is true both for a single lock on a door and a large and complex master key system. If it is possible for anybody to obtain a key, the premises become vulnerable to unauthorised or criminal intruders.

No patent, no protection

All registered key systems from ASSA ABLOY are protected by new international patents. We are committed to vigorously defending our patents whenever necessary to ensure the continued security of your premises.

ASSA ABLOY Triton² is patented until 2036 for your peace of mind.



Introducing ASSA ABLOY Triton²

The next generation of ASSA ABLOY master key cylinder systems



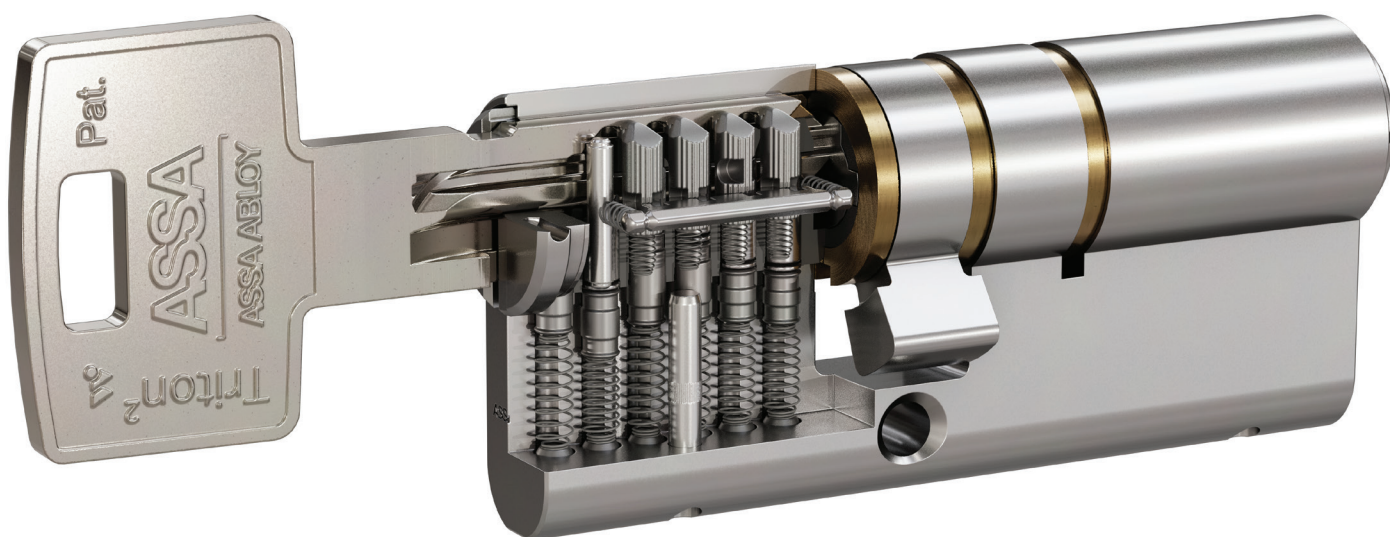

ASSA ABLOY Triton² is our next generation of high security, patented, master key cylinders for the commercial sector.

Using innovative technology, ASSA ABLOY Triton² is purposely designed to provide the highest levels of security, to keep your premises totally secure.

ASSA ABLOY Triton² cylinders and keys are built to last and will provide many years of reliable use. They offer the same high quality and excellent durability you come to expect from an ASSA ABLOY cylinder.



Why choose ASSA ABLOY Triton² for your new suite:

-  The highest security - Long life patent protection until 2036 giving you peace of mind over your key control. Cylinders exceed the requirements of EN1303:2015 Grade 6/D for your assurance of physical security.
-  Quality and durability unmatched - Cylinders and keys are precision engineered and rigorously tested, to ensure the highest levels of quality and durability.
-  Unrivalled master keying capability - A system with a massive amount of combinations guarantees unique systems for the 9900 range. This allows the requirements of the largest and most complex suites to be met.
-  One solution for all - A complete range of cylinders and padlocks to suit your requirements. The 9900 range also integrates with ASSA ABLOY CLIQ[®] Remote for maximum security and flexibility.
-  Total service and support - Both our exclusive ASSA ABLOY Partner network and our experienced Sector Specialists, are here to guide your purchase and aftersales service, for complete support

The system is suitable for large and complex suites in healthcare, education, commercial sectors, public buildings and any areas requiring a highly secure and durable cylinder platform.

Healthcare



Education



Commercial



Public Buildings



The key to high security

Security and control starts with the key

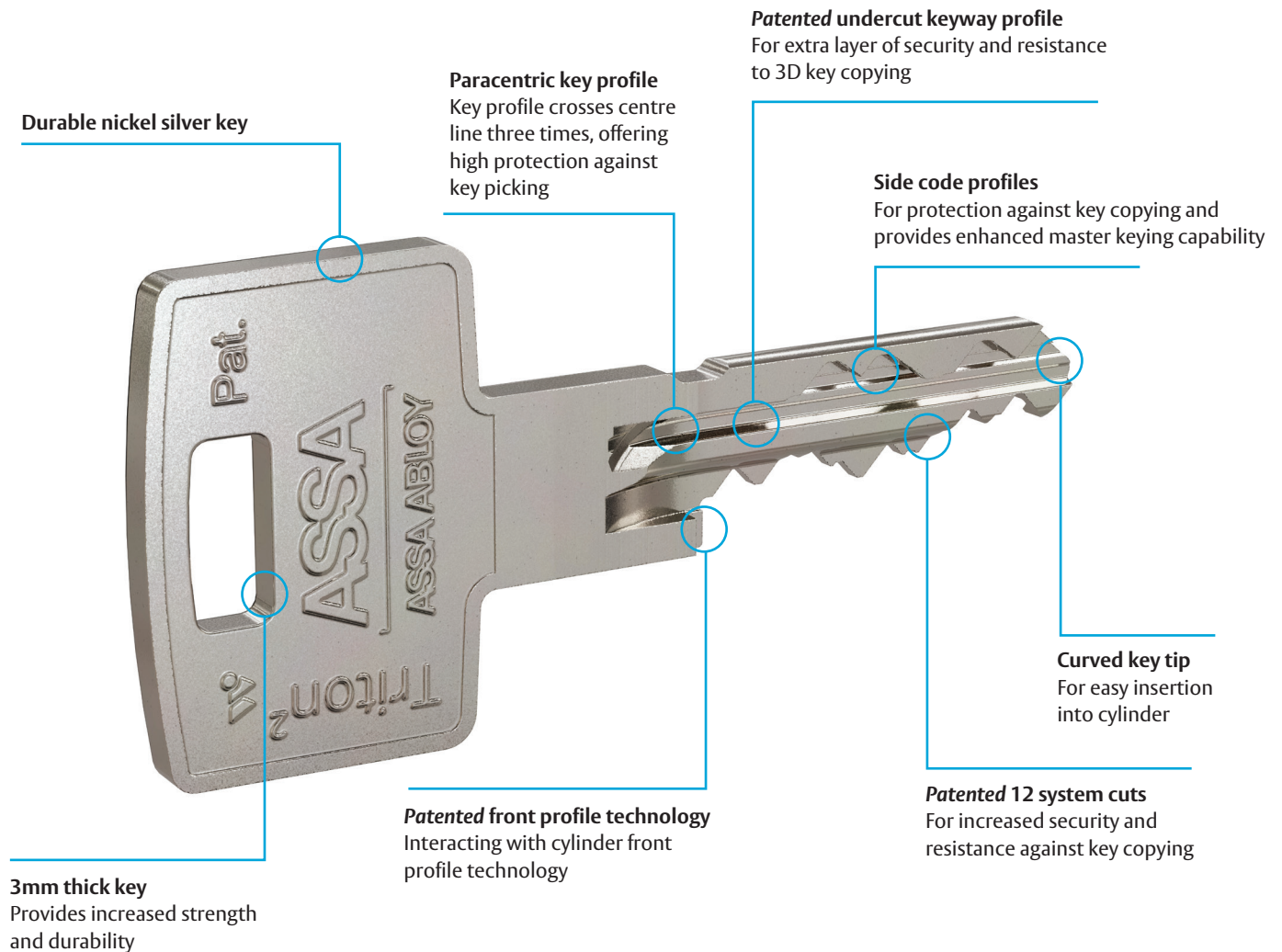

Patented key control for your security

ASSA ABLOY Triton² has four overlapping key patents, to ensure long life patent protection until 2036. These multiple key patents provide secure key control and reassurance that your keys can't be copied.

Authorised key cutting only

Our protected key cutting programme requires ASSA ABLOY to provide the ASSA ABLOY Partner network, authorisation for key cutting programmes to be released.

What's more, the additional profiling process for the 9900 range, requires ASSA ABLOY to authorise and send encrypted key cutting files to the ASSA ABLOY Partners. This ensures the highest level of key cutting security.

Patently secure cylinders

High quality, high security cylinders built to last

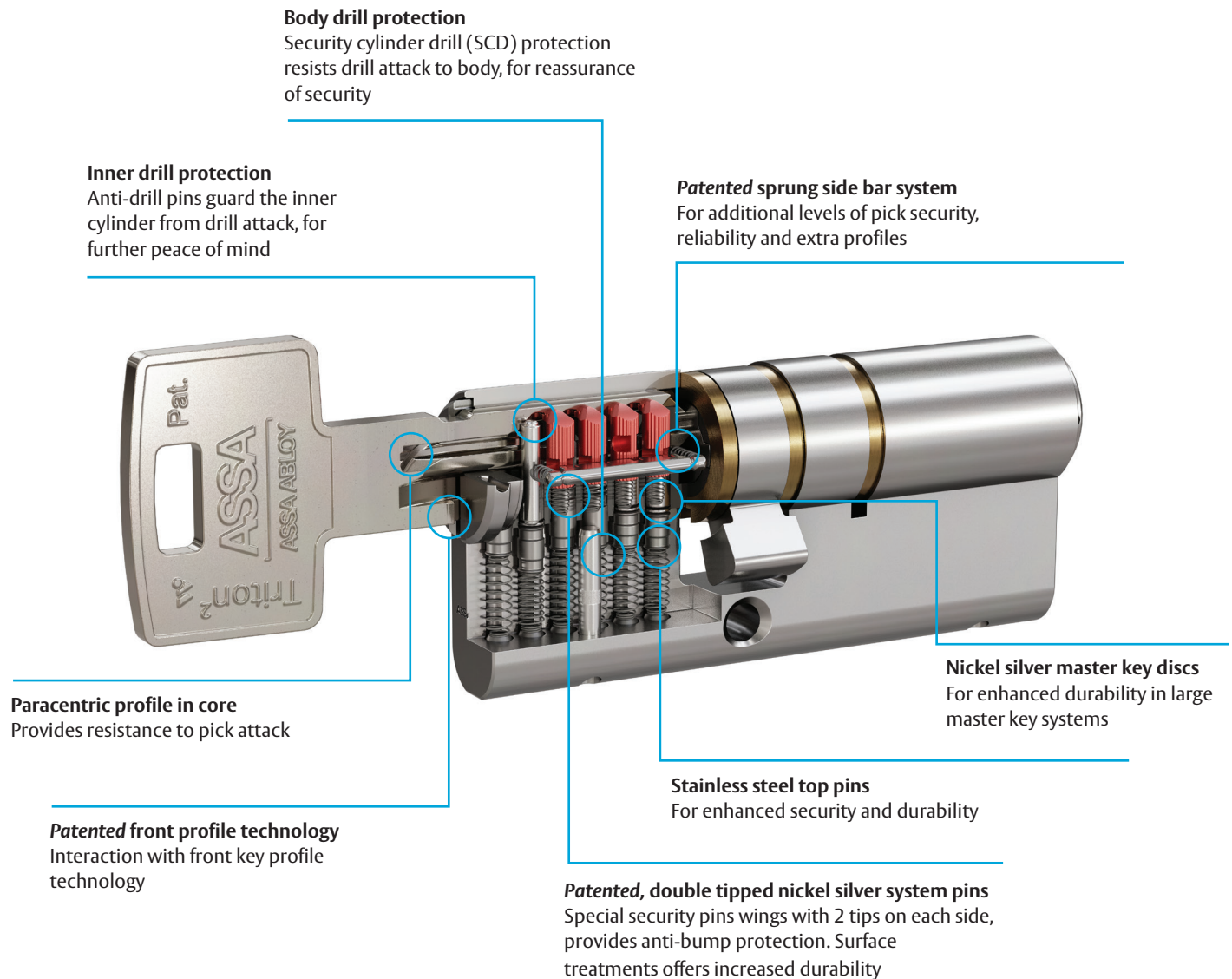

Long life patented cylinder protection

ASSA ABLOY Triton² cylinders include patent protection and when combined with the key patents, provides long life patent protection until 2036.

Unrivalled master keying capability

The 6 pin configuration combined with profiling on the side bar (9900 range) offers unrivalled master keying capabilities, and code uniqueness. This allows the requirements of largest and most complex suites to be satisfied.

Designed to be highly secure

ASSA ABLOY Triton² cylinders are highly secure, with anti-pick, anti-pull, anti-drill and anti-bump protection built in. They exceed the latest EN1303:2015 Grade 6/D certification, so you can be sure ASSA ABLOY Triton² will resist known attack methods and your premises remains secured.

The ASSA ABLOY Triton² cylinder range

Patented, high security range for all your requirements

The ASSA ABLOY high security range of patented cylinders consists of three ranges to suit your requirements.

Absolute Security



An electro-mechanical solution that provides absolute security and flexible control of access rights.

- 6 pin electro-mechanical cylinder system
- Integrates with ASSA ABLOY Triton (9900 range only)

High Security

Triton²

The ultimate in mechanical master keying for buildings with high security and complex master key requirements across multiple sites.

The ASSA ABLOY Triton ranges consists of two levels, with differing functionality to meet your requirements.

ASSA ABLOY Triton 9900 range:

- 6 pin mechanical cylinder system with 4 pin side bar.
- Code unique world wide
- Paracentric key profile
- Long patent life until 2036
- Upgradable and compatible with ASSA ABLOY CLIQ[®] Remote
- Supplied as master keyed only
- Combined with 6900 series

Medium Security

Triton²

ASSA ABLOY Triton 6900 range:

- 6 pin mechanical system with 2 pin side bar
- Paracentric key profile
- Long patent life until 2036
- Not possible to upgrade or integrate 9900 cylinder in the same masterkey

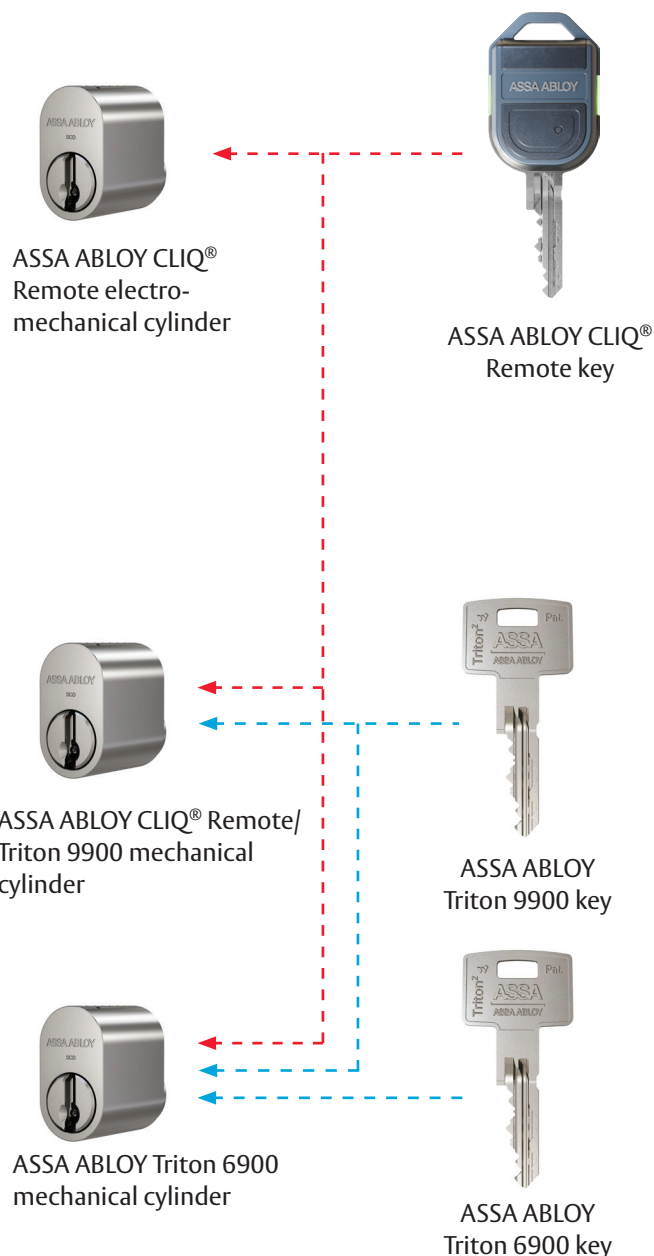

Integration with ASSA ABLOY CLIQ® Remote

For maximum security and maximum flexibility



ASSA ABLOY CLIQ® Remote is our electro-mechanical cylinder system that offers the maximum level of security and user flexibility.

The system uses micro-electronics and programmable keys to offer administrators flexible control over access rights e.g. a key can be programmed to provide access to a room at an allotted time.

ASSA ABLOY CLIQ® Remotes audit trail functionality allows you to have visibility of who is in your building, providing re-assurance from a security, and health and safety perspective.

This gives you the ultimate flexibility when designing and specifying your suite. ASSA ABLOY CLIQ® Remote can be added to areas of buildings where maximum security is required, to provide an additional electronic layer of security.

The ASSA ABLOY Triton® 9900 range is fully compatible and can be integrated into a master key system with ASSA ABLOY CLIQ® Remote. This gives you the opportunity to include ASSA ABLOY CLIQ® Remote when the system is designed, or it can be upgraded at a later date.

Hierarchy of system integration

ASSA ABLOY Triton's mechanical system provides the basic foundation, which is made up of different security levels or zones. Mechanical cylinders can be incorporated into the master key suite, for those doors not requiring maximum security or access control.

ASSA ABLOY CLIQ® Remote can then be used on the perimeter, high security doors, and sensitive areas. CLIQ® padlocks can also be incorporated into the system and used to secure outbuildings and gates.

The hierarchy below explains how the two systems combine in a typical master key system, to provide the benefits of a high-security mechanical system and access control.

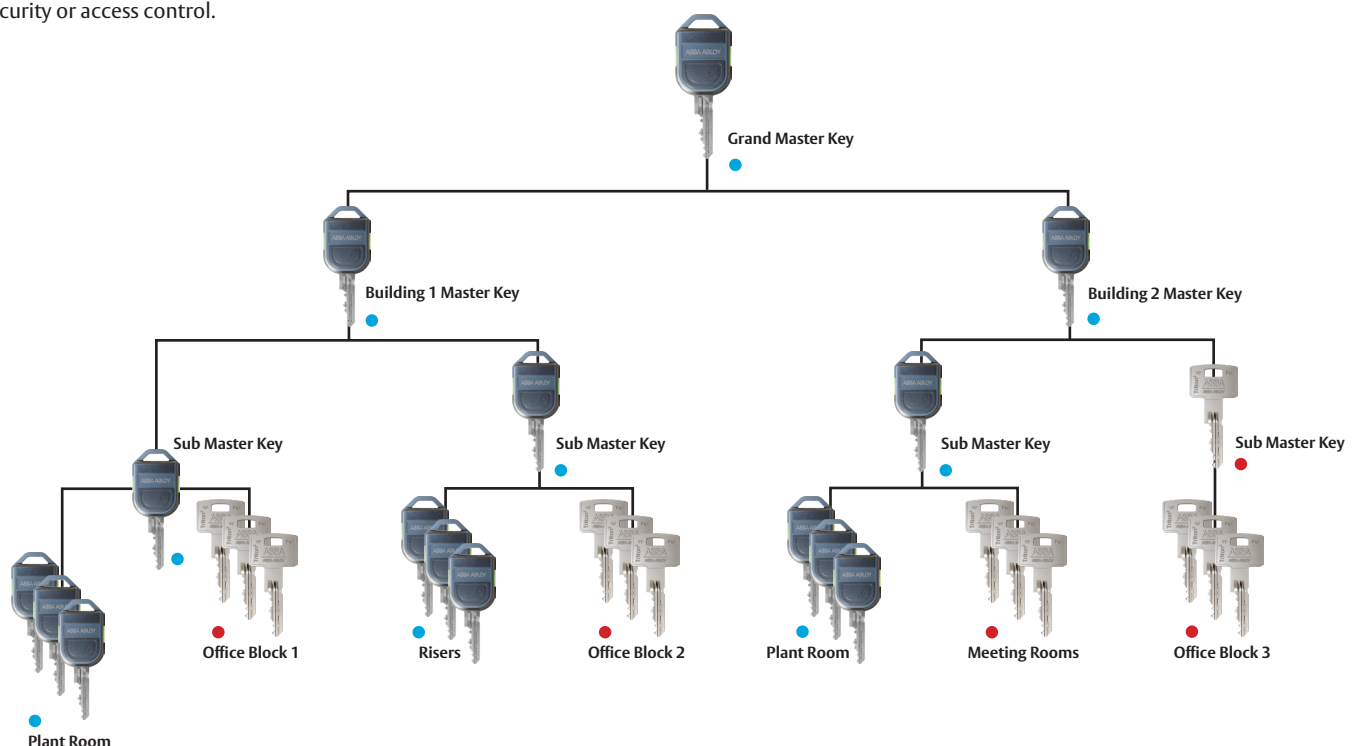





One solution for all

A full range of cylinders to suit all your requirements

ASSA ABLOY Triton is available in a full range of cylinder shapes, allowing the system to be used with all common types of lock cases. A full range of padlocks is also available to suit your required level of security.

The complete range allows the installation of one system that covers all applications, from external and internal doors, to cabinets and padlocks.

Scandinavian Oval

For use with ASSA ABLOY Modular, Connect and Narrow Profile lock cases. The cylinder is fixed to the lockcase with two hardened steel screws, supplied with the accessory set. ASSA accessories (see page 13) must be used.

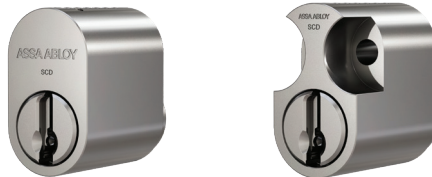

6901/9901
Single cylinder (outside)

6903/9903
Single cylinder (inside)

6902
Double cylinder

For use with ASSA ABLOY rim and Connect narrow profile lock cases. The cylinder is fixed to the lock case with two brass screws which can be cut to length. Supplied with rim cylinder sleeve.



6907/9907
Single rim cylinder (outside)

6909/9909
Single rim cylinder (inside)

6908
Double rim cylinder

Scandinavian Round

For use with ASSA ABLOY Modular and Connect lock cases. The cylinder is fixed with four high security hardened steel screws, supplied with the accessory set.



6911/9911
Single cylinder (outside)

6913/9913
Single rim cylinder (outside)

6912
Double rim cylinder

Mortise cylinders

For use with locking devices accepting screw-in cylinders. State lock type when ordering to ensure that correct cam is supplied.

For use with rim locks and other locking devices accepting rim cylinders.



6951/9951
Single mortise cylinder

6952/9952
Double mortise cylinder

6957/9957
Rim cylinder

Euro profile

For use with locks accepting Euro profile cylinders.

Optional functions

- Classroom, clockwise
- Classroom, anticlockwise
- Clutch
- Dual action
- Cog wheel
- Clutch release

The M20 high security Euro cylinder range is also available offering high resistance.



6922/9922
Double cylinder

6923/9923
Single cylinder



6927/9927
Single cylinder with
oval turn



6924/9924
Single cylinder with
small turn

6921/9921
Single cylinder with
large turn

British oval

For use with locks accepting Oval profile cylinders. Cylinders are supplied with fixing screw.



6932/9932
Double cylinder

6933/9933
Single cylinder



6937/9937
Single cylinder with
oval turn



3934/5934
Single cylinder with
small turn

3921/5921
Single cylinder with
large turn

One solution for all

A full range of padlocks to suit all your requirements

ASSA ABLOY Triton² is available in a full range of padlocks to suit your required level of security.

Class 2

- Padlock body manufactured from extruded brass and surface black chrome plated
- Shackle of rustproofed hardened steel, 8mm or 10mm diameter
- Drainage holes in the padlock body prevent freezing. No external screws or rivets
- Green stripes indicate Security Grade 3 to EN 12320
- 52mm clearance on extended shackle



69240/99240
Key locking



69241/99241
Snap



69243/99243
Key locking
extended
shackle



69346/99346
Key locking
10mm diameter
shackle



69249/99249
Key locking
closed shackle

Class 3

- Padlock body manufactured from hardened steel and surface black chrome plated
- Shackle of rustproofed hardened steel, 10mm diameter
- Drainage holes in the padlock body prevent freezing. No external screws or rivets
- Blue stripes indicate Security Grade 4 to EN 12320



69341/99341
Key locking



69349/99349
Key locking
closed shackle

Class 4 / Class 5

- Padlock body manufactured from hardened steel and surface black chrome plated
- Shackle of rustproofed hardened steel, 13mm diameter
- Drainage holes in the padlock body prevent freezing. No external screws or rivets
- Red stripes indicate Security Grade 5 (open shackle) or Grade 6 (closed shackle) to EN 12320



69441/99441
Key locking



69549/99549
Key locking
closed shackle

Weather resistant

- Padlock body manufactured from hardened steel
- Shackle manufactured from boron steel
- IP68 rated
- Fulfills the requirements of EN 12320 grade 3
- Available in alternative shackle heights
- Operating temperatures: -40° F to +130° F
-40° C to +80° C



69250/99225
Grade 3 weatherproof
25mm shackle



Experience a safer
and more open world

ASSA ABLOY

ASSA ABLOY Opening Solutions Sweden
P.O. Box 371
SE-631 05 Eskilstuna
Sweden
Phone +46 (0)16 17 70 00
Customer support:
Phone intl. +46 16 17 71 00
Phone nat. 0771 640 640
helpdesk.se.openingsolutions@assaabloy.com
assaabloy.com