

SLIPPER

For sliding cupboard doors. Max 9kg.

APPLICATION

- For fitted bathroom and kitchen furniture of all kinds, such as serving hatches, cupboards and other items made from lightweight wood or chipboard
- For timber, timber framed or composite doors
- Silent – nylon slides on attractive aluminium track
- Easily top fixed
- Simple to remove doors for cleaning and decorating

DOOR SPECIFICATION

Track System	Slipper
For Individual Doors:	
Max Door Weight	9kg
Max Door Width	900mm
Door Thickness	16-30mm
Max Door Height	1800mm

STANDARD SETS AND PACK

Sets comprise of 2 top aluminium section tracks, 4 nylon sliders, 3 guides, safety stop, 2 flushpulls, all screws and fitting instructions.

Set No.	Opening width	Track length	Hardware for
HSS4	1200mm	1200mm	2 doors
HSS5	1500mm	1500mm	2 doors
HSS6	1800mm	1800mm	2 doors
Pack No.	Application		
HSS1	Single door fittings pack		

HARDWARE SPECIFICATION

Track	H130	Aluminium (900, 1200, 1500, 1800, 2400 & 3600mm lengths)
Slider	H131	White nylon <i>Sliders are molded with radiused sides for ease of installation and for a smooth sliding action.</i>
Door Stop	H28P	Rubber-buffered stop
Guides	H132	White nylon saw cut guide <i>Guides can be positioned on both sides of the door or slide in a sawcut in the centre line of the door.</i>
Accessories		
Flush Pull	H26P	

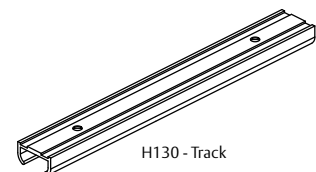

H130 - Track

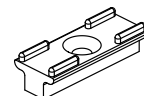

H131 - Hanger

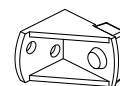

H28P - Door Stop

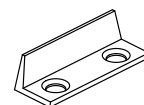

H132 - Guide



H26P - Flush Pull

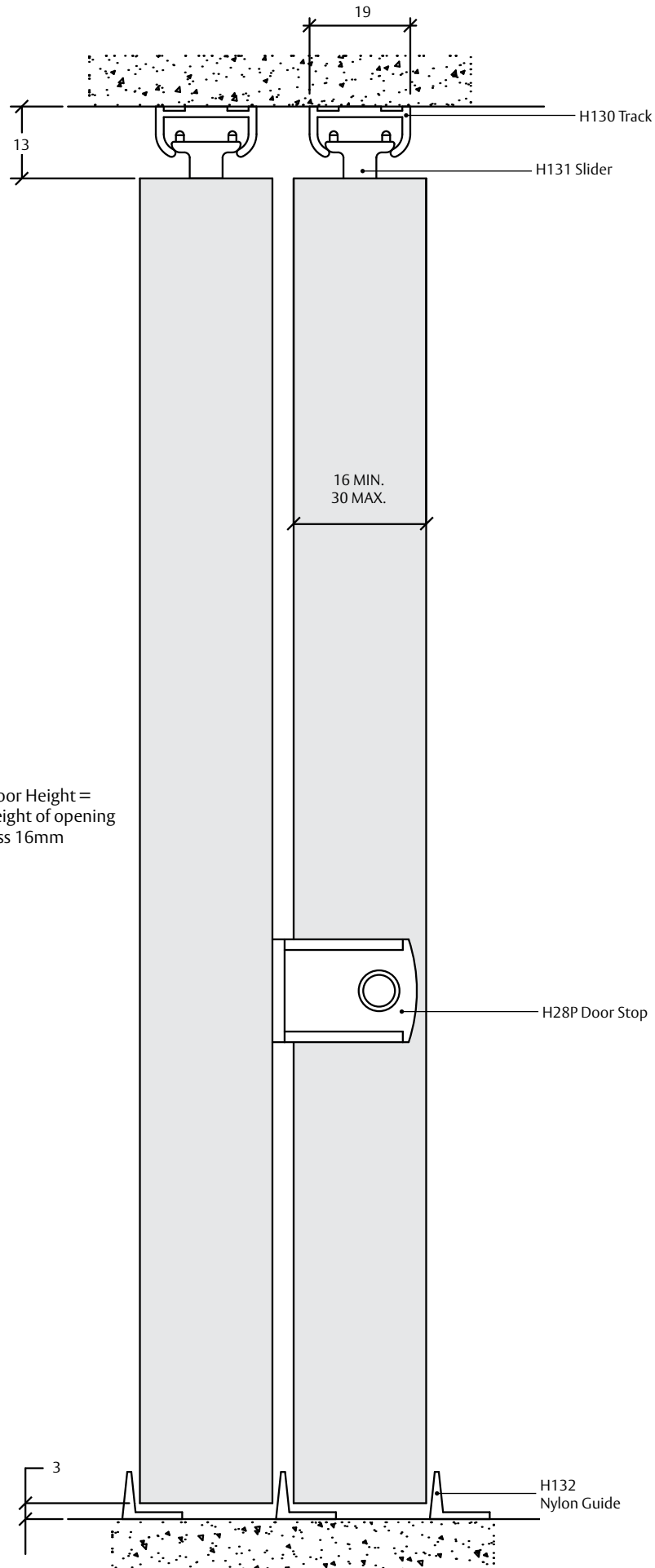

NOT TO SCALE

Door Height =
height of opening
less 16mm

H28P Door Stop

H132
Nylon Guide

H130 Track

H131 Slider

16 MIN.
30 MAX.

19

13

3