

Heavy Duty Floor Mount Door Holder

Model: EMH50-FMHD



ASSA ABLOY



ASSA ABLOY, the global leader
in door opening solutions.

Installation Instructions

Features

- Dual Voltage Selectable (12VDC or 24 VDC)
- Emergency Release/Test button
- Floor Mount with heavy duty design
- Low Current Consumption
- Reliable Fail-Safe Mechanism
- Durable and Silent Operation
- Designed to AS4178 Standard

Specifications

- Dimensions: 110L x 80W x 93H (mm)
- Voltage: 12/24VDC+10% (Selectable)
- Current Draw: 12V/140mA 24V/70mA
- Operating Temp: -10~+55°C
- Suitable Humidity: 0~95% (Relative humidity)
- Holding Force: 23kg
- Suitable for: Single and Double Fire Doors

Dimensions

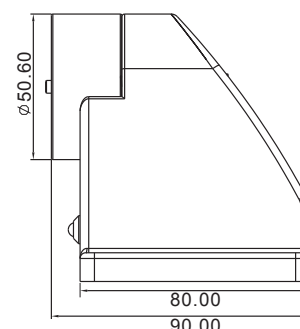
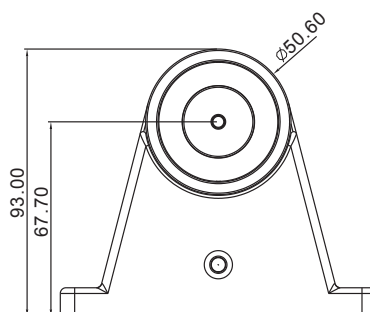
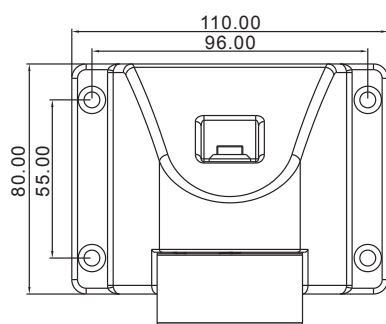

Installation

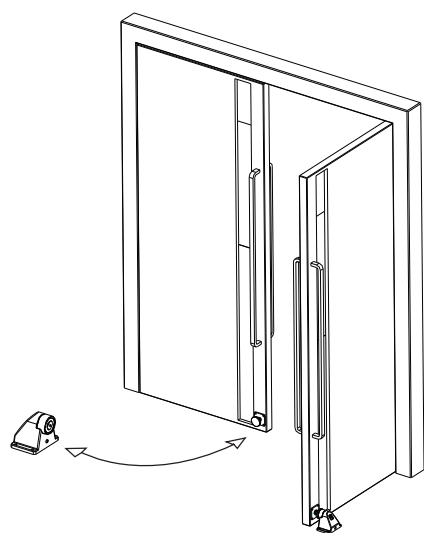

Installation

12/24V Adjustable

Notes

- The default setting is 24VDC
- To select 12 VDC see image below

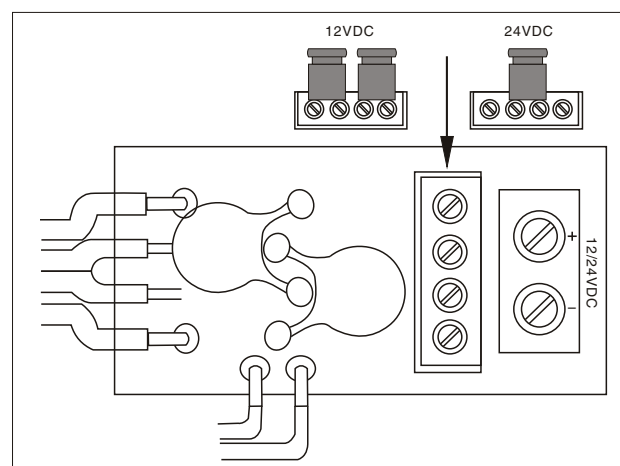

Wiring Diagram

