

Door Opening Solutions

ASSA ABLOY

Experience a safer
and more open world



Door Closers



Handles



Hinges



Door Stops

The ASSA ABLOY Group

World leaders in door opening solutions

ASSA ABLOY

ASSA ABLOY is the global leader in door opening solutions, dedicated to satisfying end-user needs for security, safety and convenience

As the world's leading door opening solutions provider we are dedicated to satisfying end-user needs for security, safety and convenience.

With over 150 companies operating in more than 70 countries, the Group is the strongest global player in the industry with around 47,000 employees and more than \$8 billion sales worldwide.

Today ASSA ABLOY is the leading global supplier of intelligent lock and security solutions. Its products account for more than one in ten of all lock installations worldwide.

ASSA ABLOY Group is represented in all major regions, on both mature and emerging markets, with leading positions in much of Europe, North America and in Australia.

In the rapidly growing electro-mechanical security sector, the Group has a leading position in fields such as access control, identification technology, automatic doors and hotel security.

ASSA ABLOY's vision is to be the most innovative supplier of total door opening solutions in order to deliver safe and convenient security solutions that provide real added value to customers.

Using the latest technologies and tried-and-tested techniques we are constantly developing innovative solutions that improve our customers' lives through greater security, safety and convenience.

ASSA ABLOY has been producing an annual sustainability report based on GRI (Global Reporting Initiative) guidelines since 2005. We are leading the way, with more than 250 environmental product declarations across the Group since 2008.

Sustainability is integrated in all Group processes: innovation, product development, manufacturing, logistics and sales.



Specification Service

Total door opening solutions

ASSA ABLOY

ASSA ABLOY Security Solutions is totally committed towards easing the specification burden by providing full support to architects through our GAI and BREEAM qualified specification team who can produce highly professional specs in CSI or an NBS format.

As a trusted auxiliary member of your design team our specialists will ensure that the solutions identified will accord with your clients exacting design, legislative, fiscal and operational requirements.

As a global manufacturer, ASSA ABLOY offers the reassurance of local onsite technical support and long term warranties, bringing true peace of mind to the developer, architect, contractor, client and building operator alike.

In order to promote our offering of total door opening solutions we have launched sector-based specification brochures.



Our Services

- Consultation for complete door opening solutions
- Project specification writing
- Technical support
- Project co-ordination
- After sales service





About UNION

The distinguished UNION brand provides an extensive range of architectural products for commercial and contract applications and is widely recognized in over 80 countries.

The company takes pride in its heritage and experience, and is committed to innovative design principles and

continual product development, an ethos that directly benefits end users, specifiers and installers to achieve the levels of security and aesthetics they require.

UNION products are designed in the UK by highly skilled and experienced project teams and are at the forefront in quality and performance.

Lever Locks



2 Lever Mortice



2 Lever Bathroom



2 Lever Rebated



3 Lever Deadlock



3 Lever Sliding



3 Lever Mortice



5 Lever Mortice



5 Lever Deadlock

2 Lever Locksets



Z049-97-95



100-05-95



100-11-95



50285-95



680-06-95

Bathroom Locksets



Z049-97-WC



100-55-94



100-11-94



50285-94



680-66-94



Lever Lock Handles



428-57 AS 51567-06 AS 680-06 AS 100-05 SN 100-05 PB 100-05 BLK 100-11 PB 100-11 SN



50285 PB 50285 SN 50285 AC Z033-420 AB Z033-420 BLK 35141 AC Z049 AB Z049 SN

Bathroom Handles



680-66 AS 51567-66 AS 100-11 PB 100-55 PB 50285 PB Z033-420 AB Z033-420 SN Z049-97 AB

4 Lever Steel Door Lock



4L-22931/34

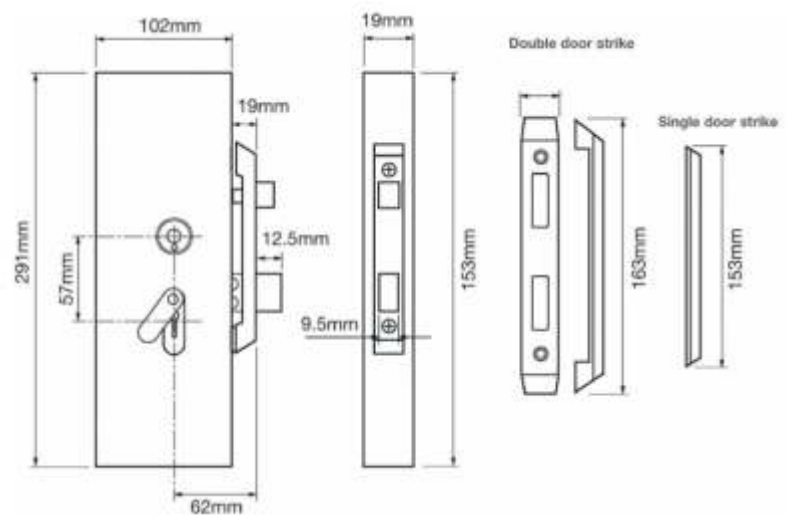



2 Lever Economy Range



2L-L234-95-AB



2L-L234-95-SB



2L-L234-95-MBK



2L-L236-95-AB



2L-L236-95-SB



2L-L236-95-MBK

Bathroom Locks



2L-L236-94-AB



2L-L236-94-SB



2L-L236-94-MBK



2L-L234-94-AB



2L-L234-94



2L-L234-94-MBK



Cylinder Lock cases



2B21
Mortise Sashlock



2B22
Mortise Deadlock



2B23
Mortise Latch



2B27
Mortise Bathroom Lock



CL-X972-45
Mortise Sashlock



CL-X972-60
Mortise Sashlock



CL-X972D-60
Mortise Deadlock



CL-X972
Mortise Latch lock



CL-X985-45
Mortise Lock



CL-X985-60
Mortise Lock



CL-X925-
Narrow Stile Lock



CL-XR925-
Narrow Stile Roller Lock



NS-2240-SSS
Narrow Stile Hook Lock



QE-50
Hook Lock



QE-30
Hook Lock



CL-2404
Mortise Lock



CL-2404
Mortise Deadlock



58mm Cylinder Locksets



LS-F707-L802-RG



LS-F707-L802-SN



LS-F707-L802-AB



LS-F714-LK3-RG



LS-F714-LK3-SN



LS-F714-LK3-AB



LS-F707-L802-RG



LS-F719-L753-SN



LS-F719-L7539-AB



LS-F7141-L328-RG



LS-F7141-L328-SN



LS-F7141-L328-AB



F136-324-AB



F136-324-SN



LS-50221-AB



LS-35041-SN



LS-35041-SN



LS-50-428-AS



LS-Z033



LS-Z033-AB



LS-50285-PB



LS-50285-SN



LS-515-AS



LS-680-06-AS



Cylinder Locksets



LS-306-85-AB



LS-Z306-85-PB



LS-201-85-SN



LS-201-AB



LS-201-85-PB



LS-712-85-AB



LS-50222-85 AB



LS-35062-85 SN



LS-50242-85-1B



LS-140-86-AB



LS-Z904-85-SN



LS-Z904-85-AB

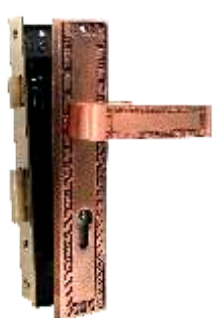

LS-35088-AC



LS-350096-AB



LS-9504-85-SN



LS-9504-85-AB



LS-700-86-AB



LS-700-86-SN



LS-1555-72-AB



LS-1555-72-PB



LS-1560-72-SN



LS-1560-72-AB



LS-Z413-72-PB



LS-Z413-72-SN



Rose Lever Handles

Solid handles



LS-AAL-123

LS-RR-167

LS-RR-147

LS-RR-179

LS-RR-146

LS-RR-HC089



AAL118-SS



AAL206-SS



AAL212



AAL213



AAL219

Zinc Alloy Handles



RR-201



RR-306



RR-207



RR-313

Decorative Handles



RR-WB40



RR-WB41



RR-100-MBK



RR-100-RG



RR-100-MBK

Tubular Handles



001-SS



002-SS



005-SS



007-SS



009

Square Handles



6274-66-BLK



T038-BLK



T038 SS



T042 SS



S098 SS



UNION

ASSA ABLOY

High Security Multibolt Locks

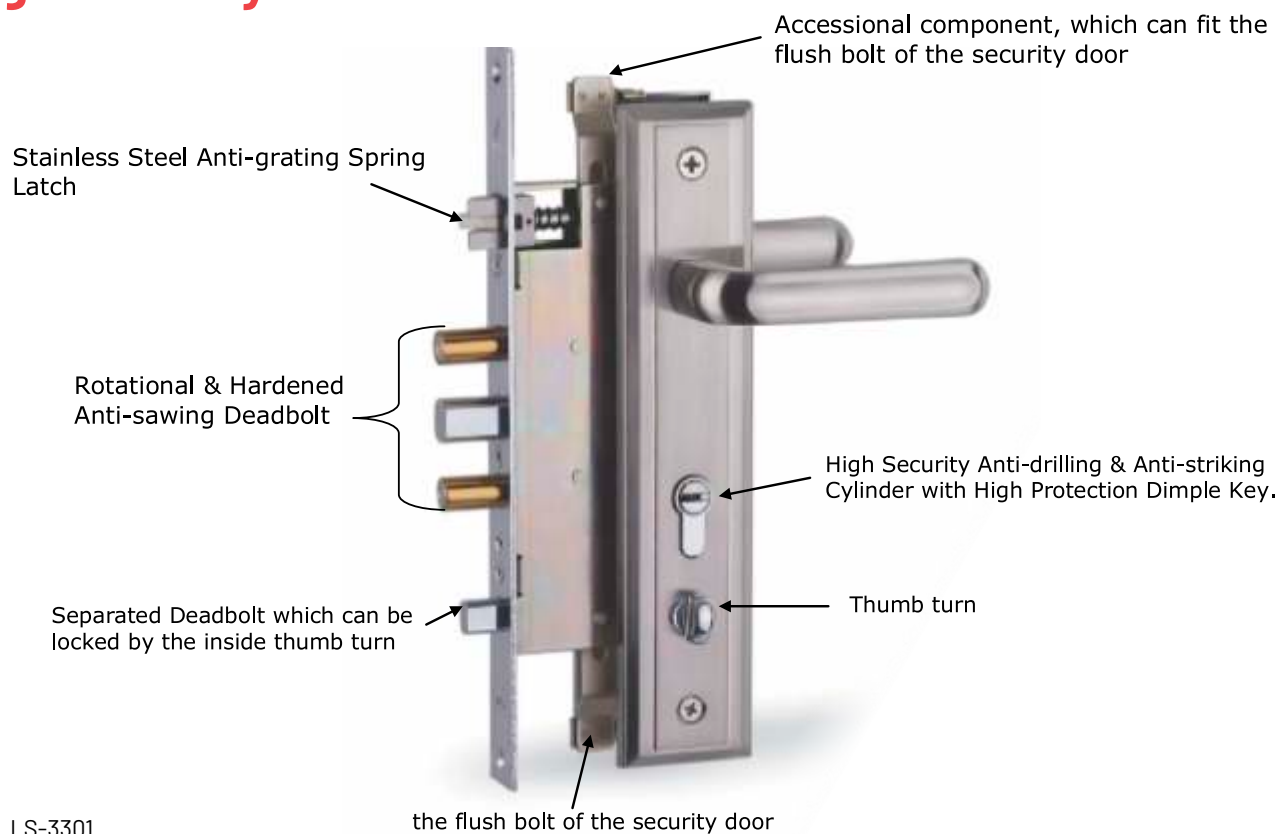

LS-3301



LS-3303

Available in:

PB - Polished Brass

SN- Satin Nickel

AB - Antique Brass



LS-8545-Z904

Available in

AB- Antique Brass

SN- Satin Nickel

BLK- Black

High Security Multipoint locks

MPL415G Lock Set Double Locking Multipoint Lock

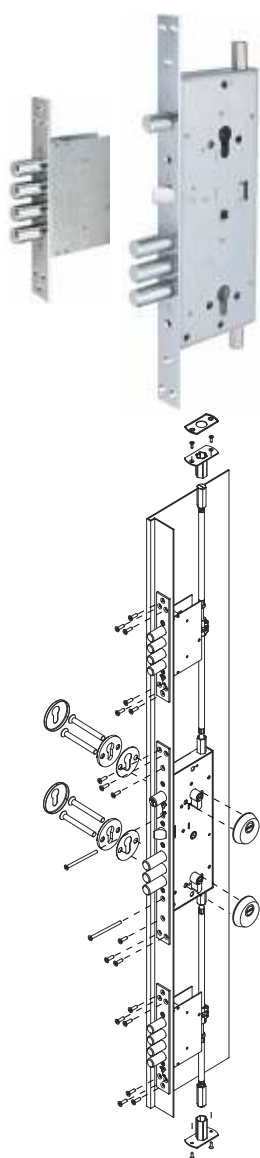

Features

- 4 smart key-turns
- 41.5 mm bolt throw
- 15 locking bolts
- Geometrical locking
- Double cylinder locking
- Cogwheel central locking mechanism
- Dead-bolt latch when locked
- Operated by Euro profile cam cylinders
- Right- or Left-Hand installation

Specifications

- Handle operation
- Latch Ø20 mm
- Backseat: 65 mm
- Bolt throw: 41.5 mm
- Minimum door height - 1950 mm
- Maximum door height - 2120 mm

Finishes

Bright brass, nickel satin, nickel chrome

Multipoint security

TESA



CL-R200B5
Mortice Lock



CL-R201B5
DEADLOCK



TLB5

- » Operated by high security Euro profile cylinder
- » Available in 3point and 5 Point

Finishes

Forend	Strike	Escutcheon	Cylinder
AE	AE	LM	LT
AC	AE	CM	LN
HN	HN	LN	LN
AI	AI (long and short)	AI	LN

AE: Gold enamelled; AC: Chrome enamelled; LM: Satin brass; LT: Brass; HN:Nickel steel ; LN: Nickel brass; AI:Stainless steel.



Gear lock



Black Range



Double Cylinder
CY-SP-EP-KK-35-35-BLK

Thumbturn Cylinder

Single Cylinder



HN-2BB-403030-BLK

Pull Handles

Bolt Through

L	H	D
150	56	19
225	56	19
300	56	25



PHD-BT-225-22-SSS

Concealed Fix

	L	H	D
	150	56	19
	225	56	19
	300	56	19



PHD-CF-225-56-SSS

Back to Back

L	H	D
300	80	32



PHC-BB-300-80-SSS

Back to Back

L	H	D
300	86	32



PHT-BB-300-32-BLK

Back to Back

L	H	D
150	56	19
225	56	19
300	56	25



PHD-BB-225-56-SSS

Back to Back

L	H	D
400	80	32
600	80	32
1000	80	32



PHT-BB-400-80-SSS

Pull Handle on Plate

L	H	D
300	225	19
400	225	19



PHP-300-100-SS

Back to Back

L	H	D
300	225	19
400	225	19

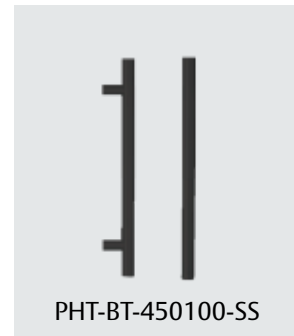

PHT-BT-450100-SS

Other finishes Available
Finishes:

Polished Brass
Aluminium
Polishes Stainless Steel
Black Matte

Code guide

PH = Pull Handle

PHD - D Shape
PHT - T Shape
PHC - C Shape
PHS - S Shape
PHCR - Cranked

Fixing

BT - Bolt through
BB - Back to back
CF - Concealed fix

eg 225-56 =
225mm x 56mm



ASSA ABLOY

<u>CODE - VE</u>	<u>CODE - AAK</u>	<u>PRODUCT</u>	<u>METAL</u>	<u>WIDTH</u>	<u>SIZE</u>	<u>APPROX WT (KGS)</u>	<u>FINISH</u>	<u>PICTURE</u>
33156	PH-33156-SS-800	PULL HANDLE - SS PIPE (25 x 25)	SS 202	25 x 25 MM	800 MM	1.000	SS	
33156	PH-33156-AB-800	PULL HANDLE - SS PIPE (25 x 25)	SS 202	25 x 25 MM	800 MM	1.000	AB	
33156	PH-33156-MBK-800	PULL HANDLE - SS PIPE (25 x 25)	SS 202	25 x 25 MM	800 MM	1.000	BLK	
33156	PH-33156-SS-1000	PULL HANDLE - SS PIPE (25 x 25)	SS 202	25 x 25 MM	1000 MM	1.250	SS	
33156	PH-33156-AB-1000	PULL HANDLE - SS PIPE (25 x 25)	SS 202	25 x 25 MM	1000 MM	1.250	AB	
33156	PH-33156-MBK-1000	PULL HANDLE - SS PIPE (25 x 25)	SS 202	25 x 25 MM	1000 MM	1.250	BLK	
33156	PH-33156-SS-1200	PULL HANDLE - SS PIPE (25 x 25)	SS 203	26 x 25 MM	1200 MM	1.500	SS	
33156	PH-33156-AB-1200	PULL HANDLE - SS PIPE (25 x 25)	SS 203	26 x 25 MM	1200 MM	1.500	AB	
33156	PH-33156-MBK-1200	PULL HANDLE - SS PIPE (25 x 25)	SS 204	27 x 25 MM	1200 MM	1.500	BLK	
33159	PH-33159-SS-800	PULL HANDLE - SS PIPE (30 x 30)	SS 202	30 x 30 MM	800 MM	1.000	SS	
33159	PH-33159-AB-800	PULL HANDLE - SS PIPE (30 x 30)	SS 202	30 x 30 MM	800 MM	1.000	AB	
33159	PH-33159-MBK-800	PULL HANDLE - SS PIPE (30 x 30)	SS 202	30 x 30 MM	800 MM	1.000	BLK	
33159	PH-33159-SS-1000	PULL HANDLE - SS PIPE (30 x 30)	SS 202	30 x 30 MM	1000 MM	1.200	SS	
33159	PH-33159-AB-1000	PULL HANDLE - SS PIPE (30 x 30)	SS 202	30 x 30 MM	1000 MM	1.200	AB	
33159	PH-33159-MBK-1000	PULL HANDLE - SS PIPE (30 x 30)	SS 202	30 x 30 MM	1000 MM	1.200	BLK	
33159	PH-33159-SS-1200	PULL HANDLE - SS PIPE (30 x 30)	SS 202	30 x 30 MM	1200MM	1.450	SS	
33159	PH-33159-AB-1200	PULL HANDLE - SS PIPE (30 x 30)	SS 202	30 x 30 MM	1200MM	1.450	AB	
33159	PH-33159-MBK-1200	PULL HANDLE - SS PIPE (30 x 30)	SS 202	30 x 30 MM	1200MM	1.450	BLK	
33171	PH-33171-AB-1000	PULL HANDLE - KNURLING SOLID	ALUM		1000 MM	1.800	AB	



Hinges

Accessories



Plates and Signages



Door Closers



DC-7772-SIL
EN size 2-4



DC-7836-SIL
EN size 3-6

EN 1154 door closer power sizes

Door closer power size	Recommended door leaf width mm max.	Closing torque between 0° and 4°	
		Nm min.	Nm max.
1	750	9	13
2	850	13	18
3	950	18	26
4	1,100	26	37
5	1,250	37	54
6	1,400	54	87
7	1,600	87	140





Specialty Doors

Fire Rated Doors



Characteristics

- Full range of sizes
- Single or double-leaf version
- Glazing or fully louvered
- The adaptability of the material shown to standard steel doors and frames
- Easy to maintain and highly durable



Material

The doors are made of galvanized steel sheets or stainless steel sheets grade 304 (also available SS grade 316 on structural honeycomb or mineral wool with vertical stiffener of high density depending on the type of the door.



Finishing Options

- Pre-coated steel sheets RAL 7035, 5010, 9002, 9006, 9007, 9010, 9016
- Customized powder-coated to any RAL colour from standard RAL colour chart
- Stainless steel finish (mirror or brush finish)
- Epoxy powder primed finish
- Wet paint (spray paint)

Bullet Resistant Doors



Characteristics

- Full range of sizes
- Single or double-leaf version
- Flush or vision panel
- Door frames are made of steel



Material

The doors are made of steel sheets. Door leaves are filled with ballistic fiber glass armour panels with vertical stiffener of high density depending on the type of the door.



Classification

Bullet Protection Ratings

- Level 1 - 9mm (3 shots),
- Level 2 .357 Magnum (3 shots)
- Level 3 .44 Magnum (3 shots)
- Level 4 .30 Caliber Rifle (1 shot)
- Level 5 - 7.62mm Rifle (1 shot)
- Level 6 - 9mm (5 shots)
- Level 7 - 5.56mm Rifle (5 shots)
- Level 8 - 7.62mm Rifle (5 shots)



Finishing Options

- Standard finish
- Factory applied primer as standard finish
- Pre-coated steel sheets RAL 7035, 5010, 9002, 9006, 9007, 9010, 9016
- Stainless steel finish (cladding)
- Wet paint (spray paint)

Water Resistant, Air Tight & Acoustic Doors



Characteristics

- Full range of sizes
- Single or double-leaf version
- Glazing or fully louvered
- The adaptability of the material shown to standard steel doors and frames
- Easy to maintain and highly durable



Material

The doors are made of galvanized steel sheets or stainless steel sheets grade 304 (also available SS grade 316 on structural honeycomb or mineral wool with vertical stiffener of high density depending on the type of the door.



Classification

- Fire Rated 30/60/90/120 minutes (BS and UL)
- Noise insulation properties Rw up to 50 dB



Finishing Options

- Pre-coated steel sheets RAL 7035, 5010, 9002, 9006, 9007, 9010, 9016
- Powder-coated to any RAL colour from standard RAL colour chart
- Wet paint (spray paint) Flush, with vision panel or louver
- Easy to maintain and highly durable
- Stainless steel finish (mirror or brush finish)
- Epoxy powder primed finish

ProHealth (Lead Line & Hermatic Doors)



Characteristics

- Full range of sizes, Lead line frame
- Single or double-leaf version
- Noise insulation properties Rw up to 50 dB
- Door frames are made of wood or steel
- Anti-bacterial finish
- Lead sheets, available in 0.8 mm upto 6 mm thickness, integrated into door and frame
- Vertically steel stiffened doors for added strength and durability
- Standard 1.5mm steel; 1.2mm upto 2mm available



Classification

- Radiation proof (Hermatic Door)



Finishing Options

- Pre-coated steel sheets RAL 7035, 5010, 9002, 9006, 9007, 9010, 9016
- Powder-coated to any RAL colour from standard RAL colour chart
- Stainless steel finish (mirror or brush finish)
- Epoxy powder primed finish
- Decoral painting system (wooden finish)
- Wet paint (spray paint)

Other Types of Specialty Doors

Security Doors
Blast Resistant Doors

Detention Doors
Louvre Doors

Patient Room Doors
Cold Room Doors



Entrance Automation

- Sliding Doors - framed and frameless glass doors
- Telescopic Sliding Doors
- Swing door operators
**can be intergrated into access control for security and safety*

- Revolving Doors
- Hematic Doors

Application

- Pedestrian Doors
- Industrial Doors
- Garage Doors
- Gates



Sliding & Folding Door Gear

- Flexirol Multi Directional (90 degree or 135 degree movement)
- Flexirol Center fold sliding folding, max 125 kg per leaf
- Securefold sliding folding, max 100 kg per leaf
- Soltaire straight Sliding heavy duty, ideal for high corrosion areas
- Husky single top and double top, for light doors and wardrobes
- Husky 50 kg and 100 kg for room deviders, max 50kg and 100 kgs respectively
- Husky Folding for light and medium residential partitions, max 4 leaves

HENDERSON



Access Control Platforms



Impro offers everything you need for your access control solution, no matter the size of your business. Our API offers a choice of integrations, being either a protocol based API or tight integrations, or a database integration via staging tables.

CLIQ® is a security locking system with high-end microelectronics, programmable keys and cylinders. It gives you control of the security of on-site and off-site entrances from a central location. It's as simple as replacing the existing cylinders!

SMARTair wireless access control system, you can forget about keys and manage access to your building from a single control point. Multiple credential types are supported, including cards, tags, bracelets and stickers. This allows your building users to carry credentials in the most convenient format for them.





Electro Mechanical Solutions



T5pro Biometric & Card Reader



Maglock
EML-ML-C-600



Maglock
AC-ML-560



Pin and Card Reader
HRW900



Brackets
EML-BK-ML-GL

Code guide :

EML - Electro Mechanical

ML- Mag Lock
ML-D Double
ML-S Single
ML-C Concealed

ES- Electric strike

BK - Bracket

FB - Fire Break Glass

EX- Exit switch

Mag lock range
600 lbs
800 lbs
1200 lbs

Electric Strike
compatible with most
72mm and 85mm locks



Electric Stricke
EML-ES-760-SS



Electro Magnetic Lock
EL-560 (Solenoid lock)

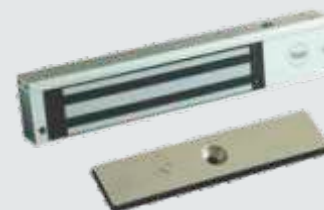

Maglock
EM-Y-560



RL-EL-674 (Transformer required)



No Touch Exit Button
EDS-K1-1



Emergency break glass
EML-FB



Exit Button
AC-803



Override Key Switch
AC-DRK-01-SS



Access Control Solutions

Automatic Gate Controllers



Centurion D5 / D10 Specifications

- D5 - 12v batteries, steel rack
Weight Capacity - 500kg
- D10 - 24v batteries, steel rack
Weight Capacity - 1000kg
- 2 X 4 button remotes

Application:
Domestic or light industrial application

Vantage 500 swing gate Features:

- Faster operation and a Push force of upto 250kg
- Supports inward- and outward-opening
- Battery backup

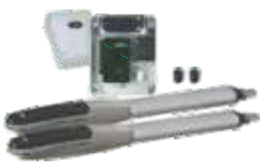

Access Control Solution (Office)



Components

- Electro magnetic lock or electric Strike
- Power supply and battery
- Pin/card/Biometric Reader
- Ext Button
- Mechanical override
- Door closer

Aperio

Aperio wireless devices are the easiest way to extend the reach of your access control system, or to replace your mechanical locks with intelligent access control. Because they operate wire-free, battery-powered Aperio devices are fast and cost-effective to install and save you money in operating and maintenance costs.



Features

- Highly effective burglary protection:** Reader: IP54 outside part, IP44 inside part
Lock case: CE, EN179, EN1125, EN14846 in progress
- No manipulation:** Main electronics inside, reader element outside Including emergency battery connector and LED indicators
- Temperature range:** Reader (outside) -40°C to +65°C, Lock case (inside) -10°C to +65 °C
- Monitoring:** Integrated sensors for door (open/closed); bolt position (locked/unlocked) and mechanical override detection
- Escape function:** Exterior handle controlled by electronics, interior handle always engaged (request to exist sensor included)

Hotel Solutions

Tesa Hotel Lock

Robust, innovative and elegant: the new electronic lock is a completely updated and upgraded access control device. With a more sophisticated design, multiple finishes and an extra-resistant locking mechanism, i-max is perfect for environments where intelligence, design and functionality must stand out.

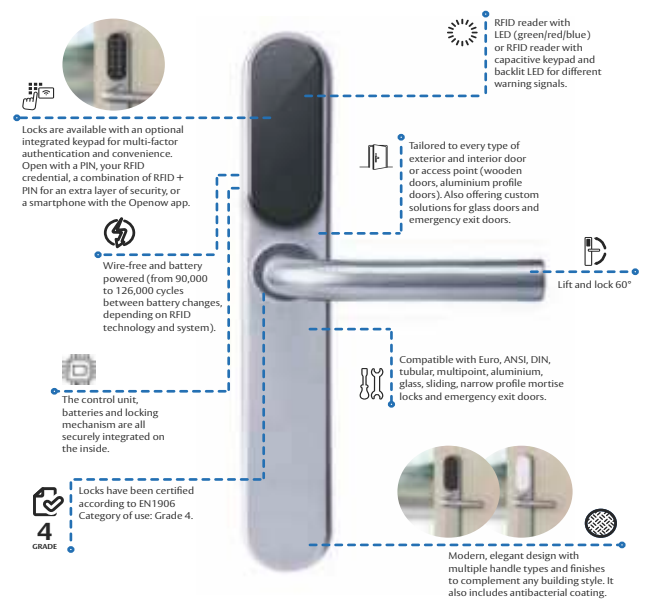

Wireless Access Control Lockset



Access Control



Features and Flexibility

ASSA ABLOY Wireless Access Control Light Commercial locking solution provides you with all the features you will need to manage your security requirements and provide peace of mind to all users.

Common access points, and emergency exits



RFID Technology



Our locking solutions provide total flexibility, adapting our solutions to your specific needs.

User friendly Software



Elanza Hospitality Lockset

Yale

Elanza is wireless access lockset for new construction or renovation to fulfill the desire for design continuity in corridors & guestrooms.



Features and Specifications

- Update-on-card electronic lock with MIFARE RFID technology
- 304 Grade Stainless Steel handle and escutcheon
- 3-point latch with antifriction mechanism
- 20 mm throw high-strength deadbolt (Privacy Function)
- Emergency egress by simply pressing down inside handle
- IP 54 Rated (with rubber gasket)
- 414 Audit trail
- Mechanical Override Cylinder with option of keyed alike





System Components



Yale Lock System Software



Energy Saver Switch



Card Encoder



Hand-Held Unit

Technical Data

- Power: 4x1.5V AA Alkaline batteries
- Material: Stainless Steel
- Emergency: Mechanical Override keys
- Door Thickness: 35~80mm
- Temperature -25°C~70°C
- Certifications - EN 14846 : 2008
- UL Listed

RFID Specifications

- 13.56MHz Mifare Classic Technology
- MF1S70 card (Time, Authorizing, Query, Terminating)
- MF1S50 card (System ID, Staff, Lock, Lock Setting Guest, Emergency)
- Eleven free sectors for All-in-one card application use

4109A Smart Door Lock

Yale

Combining high security with cutting edge technology, the Yale 4109A Digital Door Lock is a high quality security solution for the contemporary home.

Never carry keys again with the Yale Fingerprint Digital Door Lock - an intelligent biometric lock with advanced one-touch fingerprint verification technology.

The Lock can be opened with PIN code, fingerprint verification or traditional key. And now with enhanced electronics and updated firmware - you have the convenience of Yale Access app connectivity and capability.

Enjoy peace of mind, protected by a Yale Lock with 180 years of security expertise built in.



*Ideal for Airbnb
and Apartments*



Specifications:

4109A Digital Door Lock

Mortice Lock

Professional or Advanced DIY installation

Timber, Fibreglass, Aluminium
40-95mm door thickness

60mm backset

95mm deep mortice required

100mm stile

Strike kit required for aluminium framed doors (SYDMSK01)

Rebate kit required for rebated doors (SYDMRK01)

Part number

Important: This product is suitable for residential applications on entry doors. It is not suitable for entry points where the escutcheon is exposed to outdoor elements.

Connects with:

Add the Yale Access Kit and easily monitor and control your lock from your smartphone.



Yale Access Kit (YDM-ACCESSKIT)

How it works:

Download our free Yale Access app on iOS and Android.



Yale Access APP



Digital Lock - YDME 100 NxT



YDME 100 NxT

With Yale YDME 100 NxT, you can choose from different types of door access control for your home, from fingerprint scan to personalised PIN code, RFID key tag or a back up manual key. Yale redefines peace of mind with the technology that addresses peace of mind concerns while you enjoy a convenient and secure entrance solution for you and your family. Yale YDME100 NxT Smart Lock is a smart and extremely convenient solution for your home.

Product Key Features



YDME 100 NxT

Biometric	Available
PIN code	Available
RFID keytag	Available
Mechanical key override	2 pcs available
Color	● Brown ● Black
Front body	80(W) x 375(H) x 30(D) mm
Back body	80(W) x 375(H) x 30(D) mm
Backset	60mm
Door thickness	35 - 65mm
Emergency power supply	Available
Universal handle	Available

Digital Lock - YDME 50



RF CARD ACCESS



TOUCH KEY PAD



MANUAL KEY OVERRIDE

YDME50 is the basic digital latch lock. It replaces the existing ball lock and lever handle if you want to enhance the security of your room for luxury goods & confidential documents.



2 Lever Locksets



DY687 AL



DY677 GL



DY697 CP



DY697 AB



DY2294-A1 AL



DY2294-A1 GL



DY2294-Z3 CP



DY2294-Z3 AB



DY687-BLK



2294-A1 BLK



2 Lever Locksets Economy Range



ALH09-AB



ALH09-SB



ALH09-MBK



ALH09-BK-AB



ALH09-BK-SB



ALH09-BK-MBK

Knobsets



Knobset PB



Knobset SS



Knobset AB



Storeroom Knobset



Cylinder Locksets (50 & 58mm)



LS-Y-L193-A83-SN



LS-Y-L193-A83-RG



LS-Y-L193-A83-MBK



LS-BY-L172-AB



LS-Y-L309-A69--61-SN



LS-Y-L309-A69--61-RG



LS-Y-L309-A69--61-BLK



LS-BY-L72-NB



LS-Y-L351-A82-RG



LS-Y-L351-A82-RG



LS-Y-L351-A82-MBK



LS-BY-L140-AB

Cylinder Locksets (Handle on Rose)



LS-Y-ADS-L339-MBK



LS-Y-ADS-L756-MBK



LS-Y-L339-MBK



LS-Y-L756-MBK



Cylinder Locksets



LS-Y-Z201-SN
(Apollo)



LS-Y-201-AB
(Apollo)



LS-Y-201-PB
(Apollo)



B18583-L85-AB



LS-B-22-A3-AB
(Ali)



LS-B-22-A3-PB
(Ali)



LS-B-22-A3-SN
(Ali)



185124-L03B-SN



LS-18580B-L154-AB



LS-Y-LHS-L339-SN



Y-LHS-Z201-SN



LS-Y-LHS-L756-AB



T038 SN



S098 SN



35-ZR-A002 BLK



35-ZR-A003 BLK



Rim Locks / Night Latches

Front door and indoor solutions.



DY564 GL



DY564 AB



DY564 BLK



RL-61000601
GATE RIMLOCK



V198 AB



V198 1/4 AB



RL-EL-684
(Transformer required)
ELECTRIC RIMLOCK



RL-61000502
GATE RIMLOCK
"Must specify Right or Left"



P77 AB



P77 SN



P89 CH



P89 BLK

High Security Deadlock

Specifications

- Multibolt Security deadbolts
- Stainless steel lock case
- 70mm dimple key cylinder
- Round escutcheons
- Ideal for both steel and wooden doors



Model: CL-Y-201D-SS



High Security lock

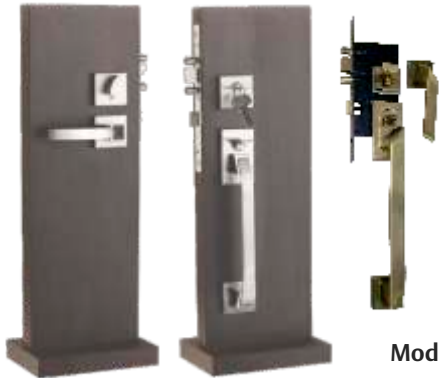

Model: V-126MDSL

Features

- Sleek and stylish satin nickel finish
- High security lock case with multibolt locks
- Crafted from robust Zinc Alloy
- Smooth and reliable locking mechanism
- Comes with all necessary mounting hardware
- Easy to follow instructions for stress-free installation
- Available in AB & SN finishes

Architectural Fittings



2022V Door Closer



MP522 Door Closer



Hinges

Cylinders

A range of cylinders adapted to equip all type of doors.



Essential Cylinder



High Security Dimple Cylinder



Privacy Cylinder





Padlocks

Iron Padlock



Model No	Brass Body Width(mm)	c	Standard Shackle	
			A	B
Y112/40	40	7	25	20
Y112/50	50	9	29	25
Y112/60	60	11	32	30
Y112/70	70	13	37	35
Y113/90	90	36MMX 19MM		



Essential Brass Padlock



Model No	Brass Body Width(mm)	c	Standard Shackle	
			A	B
YE1/30	30	5	16	15
YE1/40	40	6	22	21
YE1/50	50	8	26	26
YE1/60	60	10	32	31

Hammer Series



Model No	Brass Body Width (mm)	c	Standard Shackle	
			A	B
Y2/50	50	8	24	40
Y2/60	60	10	30	30
Y2/70	70	12	32	36
Y2/80	80	14	38	38

Y120 Series (High Security)



Model No	Model No
Y120/40/1	Y120D/50/1
Y120/50/1	Y120D/50/2
Y120/50/2	Y120D/60/1
Y120/60/1	Y120D/60/2
Y120/60/2	
Y120/70/1	



Model No	Model No
Y120B/40/1	Y120DB/50/1
Y120B/50/1	Y120DB/50/2
Y120B/50/2	Y120DB/60/1
Y120B/60/1	Y120DB/60/2
Y120B/60/2	
Y120B/70/1	

C - Shackle Diameter (mm)

A - Clearance Height (mm)

B - Clearance Width (mm)



Yale

Safes

With an easy to use digital keypad, attractive modern design and exceptional level of quality, the Yale safe range is the ideal choice for the protection of your valuables.

Part of **ASSA ABLOY**

Digital Safes

Small Digital Safe

Door Thickness:	6 mm
Exterior Dimensions:	200 x 310 x 200 mm
Interior Dimensions:	190x300 x 340 x 150 mm
Net Weight:	7kg
Part Number:	SFT/20ET



Features

- Easy to operate 3-8 code programmable keypad
- Manual over-ride function
- Supplied with 2 manual override keys
- LCD display
- Pre-drilled holes and fixing bolts allow permanent mounting
- Steel construction with carpeted floor to protect against scratches and damage
- It comes with two anti-saw locking bolts (16 mm) and steel body for protection against all attacks

Medium Digital Safe

Door Thickness:	6 mm
Exterior Dimensions:	250 x 350 x 300 mm
Interior Dimensions:	240x 340 x 200 mm
Net Weight:	10kg
Part Number:	SFT/25ET



Features

- Designed to fit a standard size laptop
- Easy to operate 3-8 code programmable keypad
- Manual over-ride function Supplied with 2 manual override keys
- LCD display
- Pre-drilled holes and fixing bolts allow permanent mounting.

Laptop Digital Safe

Door Thickness:	6 mm
Exterior Dimensions:	200 x 430 x 350 mm
Interior Dimensions:	190 x 240 x 300 mm
Net Weight:	13kg
Part Number:	SFT/35EDL



Biometric Safes

Biometric Safe

Door Thickness:	6 mm
Exterior Dimensions:	200 x 480 x 350 mm
Interior Dimensions:	192 x 475 x 295 mm
Net Weight:	13.7kg
Part Number:	YLFB/200/EB1



Features

- Fingerprint access, can store upto 100 fingerprints
- Laser-cut door for protection against attacks
- Lock down for 1 minute after 3 incorrect attempts
- Locking mechanism with 2 anti-saw locking bolts
- Comes with an override key and fixing bolts
- PIN code access
- Automatic door opening mechanism

Certified Safes

Certified Professional Digital Safe

Door Thickness:	6 mm
Exterior Dimensions:	520 x 350 x 360 mm
Interior Dimensions:	510 x 337 x 290 mm
Net Weight:	29 kg
Part Number:	SF/YSM/520/EG1



This certified Boxes have been designed to tackle burglary & fit any home. Comes with an extra thick body and door using heavy-duty steel.

Features

- Digital Security Safe Series are user-friendly with resettable codes on the lock panel and an override key
- Electronic Lock with digital keypad
- Blue backlight display
- Laser cut steel door, with auto-opening function (when Correct code is entered)
- Reinforced steel hinge
- Brushed aluminum face plate
- Concealed fixing points and mounting bolts included
- Interior finish with full felt lining
- Internal light source
- Armored steel plates protecting locking mechanism

Professional Drop Safe

Professional Drop Safe

Door Thickness:	6 mm
Exterior Dimensions:	514 x 355 x 355 mm
Interior Dimensions:	255 x 349 x 279 mm
Net Weight:	32 kg
Part Number:	SF/YSM/514/EG1/D



Features

- Deposit Slot
- Lock protected with hardened steel plate
- Spring loaded door for easy opening
- Internal LED light & Blue backlight LCD display
- Lock out alarm on 4 incorrect code entries a
- Opens with combination of 3 to 8 digit code
- Low battery warning
- Display code on/off function

Fire Safes

Fire Safe - Medium

Exterior Dimensions: 352 x 412 x 363 mm

Interior Dimensions: 260 x 320 x 234 mm

Net Weight: 31kg

Part Number: SF/YFM/352/FG2/B

Certified by KS (Korea Standard)



All Yale Fire Safes are equipped with a unique digital security keypad unlike any other on the market today.

Features

State-of-the-art digital touchpad

- Unique touchpad technology
- 1 million+ digital user code
- Code scramble input function for privacy
- One time access codes
- Silent input option
- 1-48 hours total lockdown mode
- Time lock when wrong code is entered
- Comes with a pack of fixing bolts

Easy to operate

- Re-settable 4-12 digit user code
- Low battery alarm signal
- Emergency battery capability

Protection

- Tested to withstand up to one hour of intense fire
- 16mm steel locking bolts
- Hinges protected with 18mm steel dog-bolts
- 1 hour fire protection for documents. The internal temperature will not exceed 150°C in 927°C

Fire Safe - Large

Exterior Dimensions: 420 x 352 x 433 mm

Interior Dimensions: 320 x 260 x 304 mm

Net Weight: 36kg

Part Number: SF/YFM/420/FG2/B

Certified by SP (Swedish National Testing & Research Institute) and KS (Korea Standard)



Fire Safe - Extra Large

Exterior Dimensions: 522 x 404 x 440 mm

Interior Dimensions: 410 x 300 x 300 mm

Net Weight: 53kg

Part Number: SF/YFM/520/FG2/B

Certified by SP (Swedish National Testing & Research Institute) and KS (Korea Standard)



Fire Safe - Extra Large

Exterior Dimensions: 700x 500 x 480mm

Interior Dimensions: 563 x 363 x 300mm

Net Weight: 100kg

Part Number: SF/YFH/695/FG2/B

Yale Fire Security Safe is certified by SP (Swedish National Testing and Research Institute)



YEC520

Electronic File Cabinet

Exterior Dimensions: 520x350x360mm

Interior Dimensions: 510x340x330mm

Part Number: YEC/520/ET1



Features

- 3 - digit user code
- Single, removable dividing shelf
- High security override key
- Home and office use - Fits lever arch files
- Pre-drilled holes for wall or floor mounting

Key Access

Ordering Information

Description	Part Number
• Key Access - Key Safe	Y500/187/1



Yale Key Access provides protection for keys in a tough wall mounted design.

Features

- Strong Die-Cast body
- Tough impact resistant plastic body shroud
- Weather resistant construction
- Large internal storage area
- Accepts Multiple keys
- Resettable 4 digit combination lock

Value Safe

Value Mini Safe

Exterior Dimensions: H170 x W230 x D170mm

Interior Dimensions: H160 x W220 x D 110mm

Net Weight: 2.3 Kg

Volume: 3.8 Litres



Features

- Resettable Each safe is accessed via an easy to set 3 to 8 digit PIN.
- 2 override keys are also supplied
- It features 16mm locking bolts that are retracted by the handle once the correct code has been entered.
- After three incorrect PIN entries, the keypad will be locked down for 20 seconds
- The safes feature 2 indicator lights for easy status reading: green for open, red for error or low battery

Cash Boxes

Cash box Small	
Dimensions:	150 x 120 x 80 mm
Part Number:	SF/CB/001
Cash box Medium	
Dimensions:	200 x 160 x 85 mm
Part Number:	SF/YCB/090/BB2
Cash box Large	
Dimensions:	300 X 240 X 90 mm
Part Number:	CB/004



At Yale, we pride ourselves in protecting the things that matter the most to you.

Features

- This cash box secures and organizes cash, change, or savings at home, in the office, or for your business.
- A coin tray that comes with 6 spaces
- Durable powder-coated surface
- Compact with handy carry handle
- Available in different sizes

Motorised Safes

Maximum Security Safe Small Size	
Door Thickness:	6 mm
Exterior Dimensions:	200 x 350 x 200 mm
Interior Dimensions:	192x 345 x 145 mm
Net Weight:	8.5kg
Part Number:	YSEB/200/EB1
Maximum Security Safe Home Size	
Door Thickness:	6 mm
Exterior Dimensions:	250 x 350 x 300 mm
Interior Dimensions:	242 x 345 x 245 mm
Net Weight:	12.1kg
Part Number:	YSEB/250/EB1
Maximum Security Safe Office Size	
Door Thickness:	6 mm
Exterior Dimensions:	400 x 350 x 340 mm
Interior Dimensions:	392 x 345 x 285 mm
Net Weight:	17kg
Part Number:	YSEB/400/EB1



Features

- Anti-drill plate and laser cut door for maximum security against attacks
- Maximum security mechanical over-ride that includes 1 double bitting key
- Motorised locking mechanism with two anti-saw locking bolts (20mm)
- PIN code access
- Lock down for one minute after three incorrect attempts
- Must be securely mounted with fixings provided to a wall or floor
- Protect documents, jewellery, keys or any other valuable items
- Automatic door opening mechanism
- Clear LCD keypad display
- Internal light for contents to be easily seen
- Internal hooks for hanging keys or small items

Electronic Key Safes

Electronic Key Safe -48 Keys	
Door Thickness:	3 mm
Exterior Dimensions:	365 x 300 x 100 mm
Interior Dimensions:	355 x 290 x 50mm
Net Weight:	8kg
Part Number:	SF/YKB/365/DB1
Electronic Key Safe -100 Keys	
Door Thickness:	3 mm
Exterior Dimensions:	550 x 350 x 130 mm
Interior Dimensions:	540 x 350 x 130 mm
Net Weight:	13 kg
Part Number:	SF/YKB/550/DB1



Medium and large electronic key safe for secure storage and organisation of up to 100 keys, ideal for home and business applications

Features

- 3 Solid steel powder-coated construction in black
- Time lock after 3 erroneous opening attempts
- Tamper-proof
- Reset button in the battery compartment
- Over 100,000 possible PIN combinations
- Open with a digital code or key (two keys included)
- Hinges: internal
- Adjustable key holders /for almost any key size
- Openings for wall or floor installation



Africa's leading manufacturer and distributor of electronic security products.



BEST IN CLASS SECURITY SOLUTIONS

- hyyp Smart phone app control
- Onyx wireless alarm system
- Expandable hybrid systems
- OPTEX wired/wireless solutions
- Video verification when using Dahua p2p CCTV
- App automation control
- 2 Year exchange warranty

806 XSERIES  Onyx  hyyp  IN PARTNERSHIP WITH OPTEX 

www.idsprotect.co.za | info@idsprotect.co.za | webshop.idsprotect.com

Part of 

ASSA ABLOY is the global leader
in door opening solutions,
dedicated to satisfying end user
needs for security, safety and
convenience.

ASSA ABLOY

ASSA ABLOY (E.A.) LTD.

Headquarters Showroom

Dunga Close, Off Dunga Road, Industrial area
Telephone: +254 20 6531 569, +254 729 365 575
Whatsapp: +254 702 794 198

Kijabe Street Showroom

Mobile: +254 112 192 719

Westlands Showroom

Mobile: +254 708 958 944

Mombasa Showroom

Mobile: +254 115 325 014

Eldoret Showroom

Mobile: +254 727 472 157

info.kenya@assaabloy.com
www.assaabloy.com/ke