



# CYS10

## Sawn Key Cylinders

**ASSA ABLOY**  
Opening Solutions

Security and reliability at a competitive price

*Cylinder system with 6-pin technology Made in EU, ensuring high performance at an affordable price. The key, featuring a patented vertical design and durable structure, provides an excellent experience, with enhanced security from the double patent.*



### **Certified security**

EN 1303:2015 Euro cylinders tested to 1 6 – B – C 6 D at ASSA ABLOY labs. Security technology patent protected until 2037.



### **Attack resistance**

Secure anti-pick design and tested bump resistance for additional security.



### **Reliable construction**

Durable design with 96-hour corrosion resistance and tested for 300,000 lock/unlock cycles.

Experience a safer  
and more open world

# CYS10

## Key



For all CYS10  
locking points



With its trusted sawn key design and large keybow, the CYS10 key is convenient to use. Its long key neck allows the operation with thicker door escutcheons.

Two separate key copy protection patents provide an extra layer of security.



Patent protection  
makes unauthorized  
key copying illegal

Technical data and features	
Security	Patent-protected until 2037 Ownership card included
Keying	Sawn key design Keyed to differ (KD) Keyed alike (KA) Master key system (MKS)
Number of keys	KD: 3 MKS and KA: according to order
Max. number of effective key differs	144,729
Exclusive profiles	Customer specific profiles available
Profile shape	Paracentric
Raw material	Nickel Silver
Finish	Nickel Silver
Customizations	Key medal marking with customer logo, laser-engraved Ownership card with customer information in B/N
Key thickness	2.5 mm
Key neck length	17.2 mm
Weight	20.3 g

Dimensions in mm

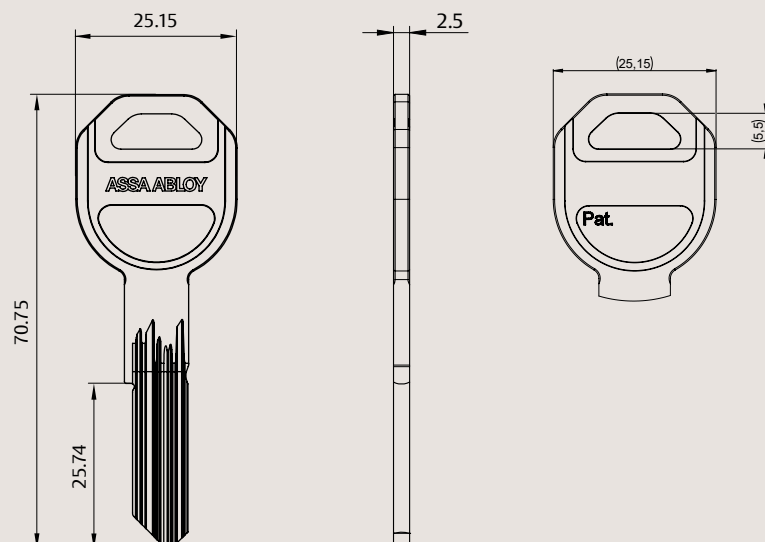

# CYS10

## Double Euro Cylinder



For internal  
and external doors



Durable and secure, the CYS10 Double Euro Cylinder provides the protection you need to lock your building's doors – inside or out. Various optional features, such as free wheeling cam and gear wheel cam, make it ideal for a wide range of applications.



Certified security



Protection against  
cylinder attack

### Technical data and features

<b>Security</b>	EN 1303:2015 tested, 1 6 – B – C 6 0 Cam DIN 18252 compliant
<b>Attack resistance</b>	Anti-pick Anti-bump (for MKS consult your master key specialist)
<b>Keying</b>	Sawn key design Keyed to differ (KD) Keyed alike (KA) Master key system (MKS)
<b>Number of keys</b>	KD: 3 MKS and KA: according to order
<b>Max. number of effective key differs</b>	144,729
<b>Number of pins</b>	6
<b>Raw material</b>	Brass
<b>Finish</b>	Satin Nickel Polished brass (on request)
<b>Cylinder length</b>	Minimum: 27 27 mm Maximum: 80 80 mm Increments: 5 mm (starting from 30 30 mm)
<b>Weight</b>	234 g (length 30 30 mm)
<b>Optional functionality</b>	Construction keying

Dimensions in mm

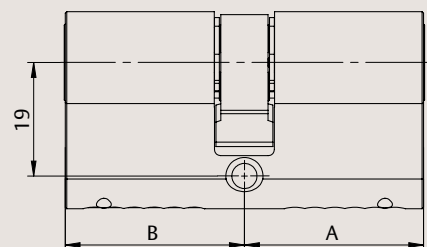
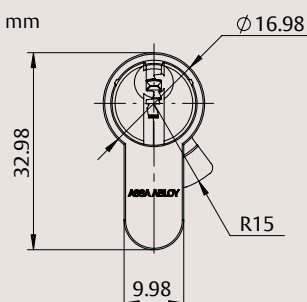

# CYS10

## Single Euro Cylinder



For internal doors



Highly durable cylinder with the performance to secure your building. Keep interior spaces secure with the CYS10 Single Euro Cylinder. The optional multi-position cam allows the cam to turn into the application's required position.



Certified security



Protection against cylinder attack

### Technical data and features

<b>Security</b>	EN 1303:2015 tested, 1 6 – B – C 6 0 Cam DIN 18252 compliant
<b>Attack resistance</b>	Anti-pick Anti-bump (for MKS consult your master key specialist)
<b>Keying</b>	Sawn key design Keyed to differ (KD) Keyed alike (KA) Master key system (MKS)
<b>Number of keys</b>	KD: 3 MKS and KA: according to order
<b>Max. number of effective key differs</b>	144,729
<b>Number of pins</b>	6
<b>Raw material</b>	Brass
<b>Finish</b>	Satin Nickel
<b>Cylinder length</b>	Minimum: 27 10 mm Maximum: 80 10 mm Increments: 5 mm (starting from 30 10 mm)
<b>Weight</b>	161 g (length 30 10 mm)
<b>Optional functionality</b>	Construction keying

Dimensions in mm

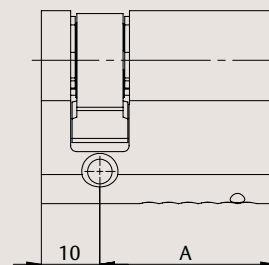
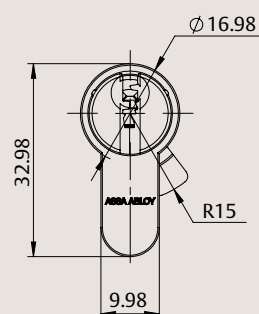

# CYS10

## Axis Cylinder



For internal  
and external doors

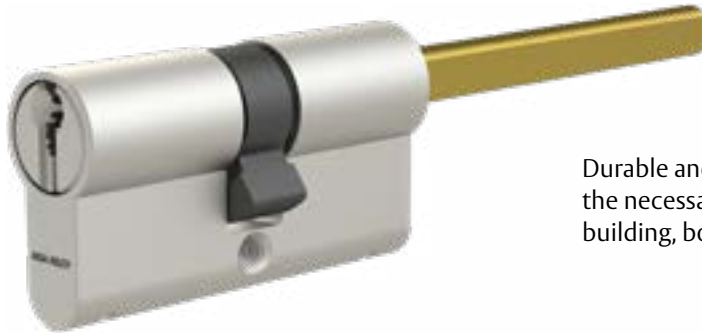

Durable and secure, the CYS10 axis cylinder provides the necessary protection to secure the doors of your building, both inside and out.



Certified security



Protection against  
cylinder attack

Technical data and features	
<b>Security</b>	EN 1303:2015 tested, 1 6 – B – C 6 0 Cam DIN 18252 compliant
<b>Attack resistance</b>	Anti-pick Anti-bump (also for KA)
<b>Keying</b>	Sawn key design Keyed to differ (KD) Keyed alike (KA) Master key system (MKS)
<b>Number of keys</b>	KD: 3 MKS and KA: according to order
<b>Max. number of effective key differs</b>	144,729
<b>Number of pins</b>	6
<b>Raw material</b>	Brass
<b>Finish</b>	Satin Nickel
<b>Cylinder length</b>	Minimum: 30 30 mm Maximum: 80 30 mm Increments: 5 mm (starting from 30 30 mm)
<b>Lunghezza del codolo</b>	70 mm
<b>Weight</b>	234 g (length 30 30 mm)
<b>Optional functionality</b>	Construction keying

Dimensions in mm

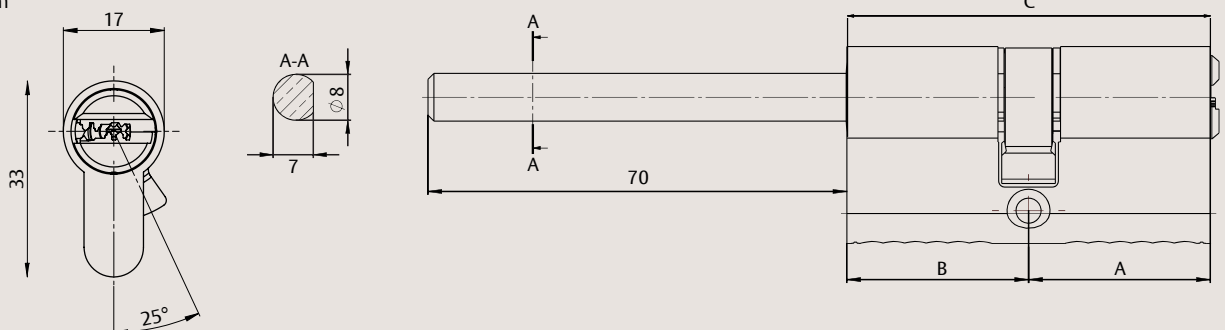

# CYS10

## Thumbturn Double Euro Cylinder



For internal and  
external doors



A reliable solution when privacy is required: CYS10 Thumbturn Cylinders securely lock doors and can quickly unlock to provide a faster exit. Various optional features, such as clutch release and classroom function, make it ideal for a wide range of applications.



Certified security

### Technical data and features

<b>Security</b>	EN 1303:2015 tested, 1 6 – B – C 6 0 Cam DIN 18252 compliant
<b>Attack resistance</b>	Anti-pick Anti-bump (for MKS consult your master key specialist)
<b>Keying</b>	Sawn key design Keyed to differ (KD) Keyed alike (KA) Master key system (MKS)
<b>Number of keys</b>	KD: 3 MKS and KA: according to order
<b>Max. number of effective key differs</b>	144,729
<b>Number of pins</b>	6
<b>Raw material</b>	Brass
<b>Finish</b>	Satin Nickel
<b>Cylinder length</b>	Minimum: 30 30 mm Maximum: 80 80 mm Increments: 5 mm (starting from 30 30 mm)
<b>Thumbturn dimensions</b>	18 x 35 x 31.7 mm (W x H x D)
<b>Weight</b>	300 g (length 30 30 mm)
<b>Optional functionality</b>	Construction keying

Dimensions in mm

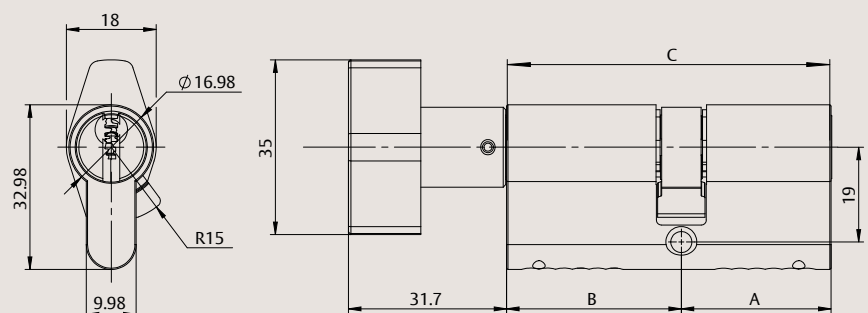

# CYS10

## Rim Cylinder



Additional security  
for external doors



Secure entrances while at the same time, enabling anyone inside to make an easy exit. The CYS10 Rim Cylinder can be used with night latches or other locking devices which are operated from a tailbar.



Certified security



Protezione contro le  
manipolazioni del cilindro

### Technical data and features

<b>Security</b>	EN 1303:2015 tested, 1 6 – B – C 6 0 Cam DIN 18252 compliant
<b>Attack resistance</b>	Anti-pick Anti-bump (also for KA)
<b>Keying</b>	Sawn key design Keyed to differ (KD) Keyed alike (KA) Master key system (MKS)
<b>Number of keys</b>	KD: 3 MKS and KA: according to order
<b>Max. number of effective key differs</b>	144,729
<b>Number of pins</b>	6
<b>Raw material</b>	Brass
<b>Finish</b>	Satin Nickel
<b>Tailbar length</b>	54 mm
<b>Face diameter</b>	32 mm
<b>Body diameter</b>	29.5 mm
<b>Weight</b>	210 g

Dimensions in mm

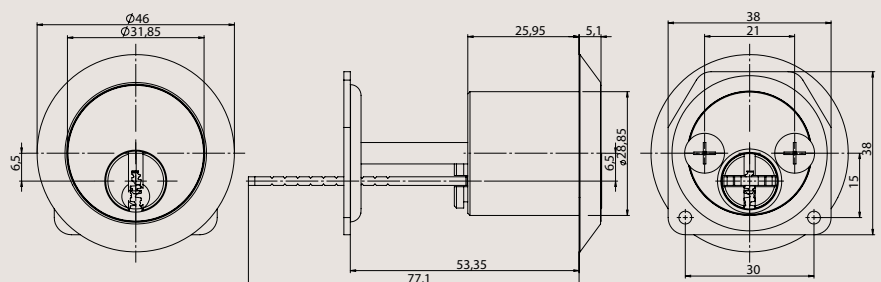

# CYS10

## Cam Lock



For indoor and outdoor locking points



Keep sensitive documents and possessions safe. Secure and unlock your letterbox, cabinets and drawers with one single key. When in the unlocked position, the CYS10 Cam Lock retains the key to prevent your possessions being left at risk.



Certified security



Protezione contro le manipolazioni del cilindro

### Technical data and features

<b>Security</b>	EN 1303:2015 tested, 1 6 – B – C 6 0 Cam DIN 18252 compliant
<b>Attack resistance</b>	Anti-pick Anti-bump (also for KA)
<b>Keying</b>	Sawn key design Keyed to differ (KD) Keyed alike (KA) Master key system (MKS)
<b>Number of keys</b>	KD: 3 MKS and KA: according to order
<b>Max. number of effective key differs</b>	144,729
<b>Number of pins</b>	6
<b>Raw material</b>	Brass
<b>Finish</b>	Satin Nickel
<b>Body diameter</b>	27 mm
<b>Body diameter</b>	34.6 mm
<b>Weight</b>	210 g

Dimensions in mm

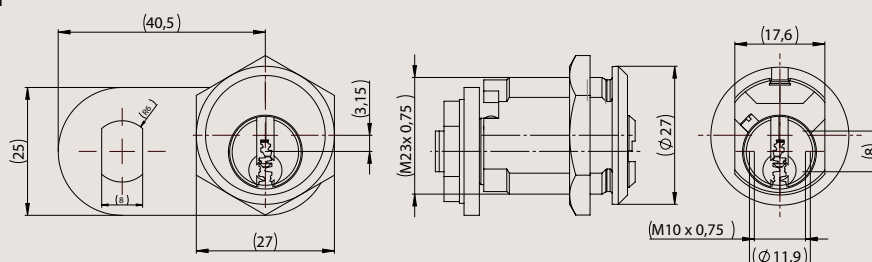



# CYS10 Padlock



For indoor and outdoor  
locking points



Optional: Dust cover

A trusted, robust padlock for multiple applications, inside or outdoors. Suitable for sheds, gates, fences, lockers, storage boxes, bike chains, and more.

When in the unlocked position, the CYS10 Padlock retains the key to prevent your possessions being left at risk.

The optional dust cover increases corrosion resistance to 240 hours.



Certified security



Protezione contro le  
manipolazioni del cilindro

## Technical data and features

<b>Security</b>	EN 12320:2012 tested – grade 3 IP67 (with dust cover)
<b>Attack resistance</b>	Anti-pick Anti-bump (also for KA)
<b>Keying</b>	Sawn key design Keyed to differ (KD) Keyed alike (KA) Master key system (MKS)
<b>Number of keys</b>	KD: 3 MKS and KA: according to order
<b>Max. number of effective key differs</b>	144,729
<b>Number of pins</b>	6
<b>Raw material</b>	Body: Brass Shackle: Hardened Boron Steel
<b>Finish</b>	Satin Nickel
<b>Body dimensions</b>	Width: 48 mm Length: 56 mm Thickness: 20 mm
<b>Shackle diameter</b>	8 mm
<b>Shackle clearance</b>	25 mm   50 mm   75 mm
<b>Weight</b>	450 g (25 mm shackle clearance)
<b>Optional functionality</b>	Dust cover (240 hours salt spray test conformance) Non-key retaining

Dimensions in mm

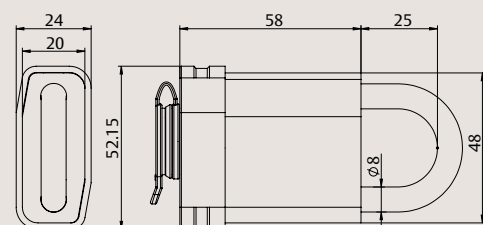
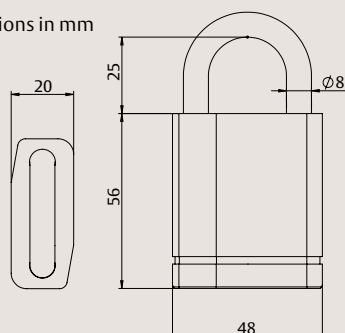

Optional: With dust cover

# Glossary of optional CYS10 functionality



An aid to better understanding



## **Construction keying**

One temporary key gives contractors access to several homes during building phase. Homeowner keys are protected from duplication when they move in. When inserted and turned, their key changes the cylinder's internal mechanism, permanently invalidating the construction key.

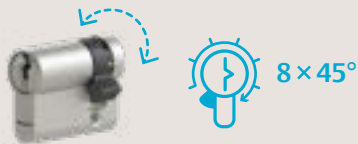

## **Multi-position cam**

The cam can be adjusted to eight different positions within a 45-degree angle by pressing the cam's locking pin and turning the cam into the application's required position. For use with key switches.

The ASSA ABLOY Group is the global leader in access solutions. Everyday we help billions of people experience a more open world.

**ASSA ABLOY**  
Opening Solutions

ASSA ABLOY Opening Solutions leads the development within door openings and products for access solutions in homes, businesses and institutions. Our offering includes doors, door and window hardware, locks, access control and service.

ASSA ABLOY Italia S.p.A.  
Via Bovaresa 13 - 40017  
San Giovanni in Persiceto (BO)  
Italia  
[assaabloy.it](http://assaabloy.it)