

Hinges



ASSA ABLOY

Experience a safer
and more open world



The ASSA ABLOY Group

The global leader in access solutions

ASSA ABLOY Group is the global leader in access solutions. Every day, we help billions of people experience a safer and more open world. ASSA ABLOY Opening Solutions leads the development within door openings and products for access solutions in homes, businesses and institutions. Our offering includes doors, door and window hardware, mechanical and smart locks, electromechanical locks, access control solutions and service.

With over 150 companies operating in more than 70 countries, the Group is the strongest global player in the industry with over 61,000 employees and more than SEK 141 billion sales worldwide.

Today, ASSA ABLOY is the leading global supplier of intelligent lock and security solutions. Its products account for more than one in ten of all lock installations worldwide.

ASSA ABLOY Group is represented in all major regions, on both mature and emerging markets, with leading positions in many markets all over the world.

In the rapidly growing electromechanical security sector, the Group has a leading position in fields such as access control, identification technology, automatic doors and hotel security.

ASSA ABLOY's vision is to be the most innovative supplier of total door opening solutions in order to deliver safe and convenient security solutions that provide real added value to customers.

Using the latest 'technologies together with tried and tested' techniques, we are constantly developing innovative solutions that improve our customers' lives through greater security, safety and convenience.

ASSA ABLOY has been producing an annual sustainability report based on GRI (Global Reporting Initiative) guidelines since 2005. We are leading the way, with more than 250 environmental product declarations across the Group since 2008.

Sustainability is integrated in all Group processes: innovation, product development, manufacturing, logistics and sales.



Hinges

A hinge serves as the pivotal connection between the door and its frame, allowing for smooth opening and closing motion. Hinges consist of two plates joined by a pin or rod, with one plate attached to the door and the other to the door frame. This design enables the door to swing freely while providing stability and support. Door hinges come in various types, including butt hinges, continuous/piano hinges, and concealed hinges, each offering distinct benefits and suitable for different door applications.

Door Hinges

Door Hinges Feature & Benefits

Key features:

- Standard template hole pattern
- Available grade SS 304
- Fire rated
- 200,000 cycles tested
- Compliant to BS EN 1935

Key features:

- Suitable for interior and exterior door (Wooden & Metal)
- High corrosion resistance
- Suitable for fire rated doors
- High durability
- Friction resistance

Key features:

- Manufactured from high grade stainless steel
- Easily seated pin that will not rise during normal use
- Available hinges
 1. Ball bearing hinges
 2. Lift off hinge
 3. Concealed hinge
- ASSA ABLOY hinges are suitable for high traffic doors and commercial applications
- Suitable for door weight up to 120 kg

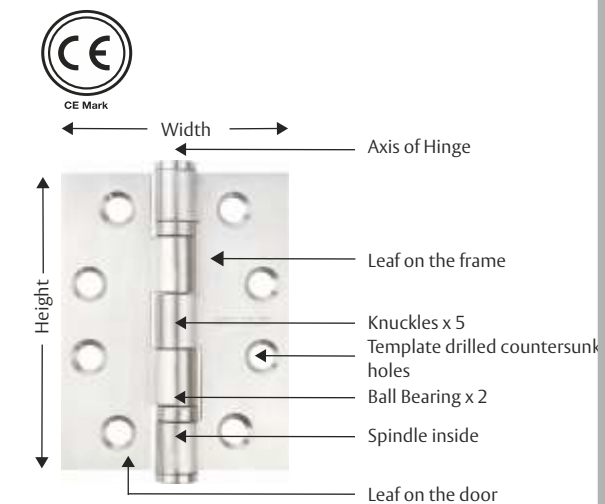

* Note: Some of the abovementioned features may not be applicable for all model of hinges
CE Marking and fire Rating is applicable for only Stainless Steel SS 304 Grade Ball Bearing hinges.



Door Hinges

Ball Bearing Hinges
Specifications

Key features:

There are a few variables which must be considered and guidelines to be observed, in order to determine hinge selection for individual doors. It is recommended that the guidelines contained dimensions, the first figure always indicates the height and the second indicates the width and the third indicates the thickness.
e.g. 102mm x 76mm x 3mm

Hinge height

The appropriate hinge height for any job is dependent upon the door width, thickness and weight. The height of the hinge is the length of the flap, not including the tips of the pin, as shown in the below diagram.

Euro Profile Cylinder
Double cylinder

Number of hinges per door:

The following quantity of hinges are recommended for the given door heights

- Two hinges - Up to 1514mm
- Three hinges - 1514mm - 2286mm
- Four hinges - 2286mm - 3048mm

Note:

- For each additional 762mm (30”) add one hinge.

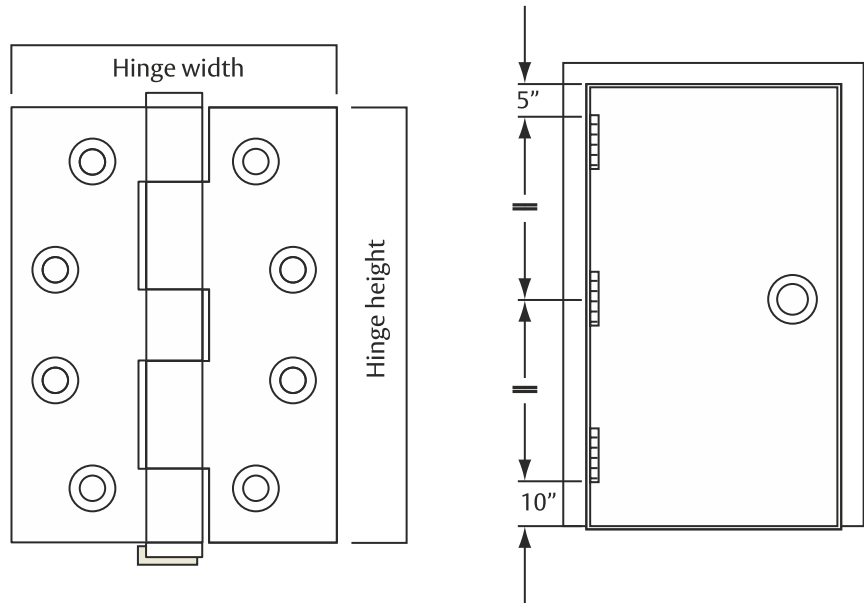

Fixing screws:

Each butt hinge is supplied with the appropriate sized wood screws. Metal door screws are optional

- 8 Gauge screw for 76mm width hinges
- 10 Gauge screw for 102mm and greater with hinges

Hinge width:

The door thickness and door jamb width (also trim size if applicable) determine the width of the hinge required. The width is measured across the leaves when the hinge is fully opened as shown in the below diagram.

Finishes:

Satin Stainless Steel - SSS

Door Hinges

Door
Hinges

Model no.: AH2BB-01, AH2BB-02, AH2BB-02-MS
AH2BB-03 AH2BB-04, AH2BB-05

Description:

AH2BB-01 (102 x 76 x 2.5) - 2 Ball Bearing Button Tipped SS 304
AH2BB-02 (102 x 76 x 3.0) - 2 Ball Bearing Button Tipped SS 304
AH2BB-02-MS (4.0 x 3.0 x 3.0) - 2 Ball Bearing

Button Tipped SS 304, (METAL SCREW)
AH2BB-03 (127 x 76 x 3.0) - 2 Ball Bearing Button Tipped SS 304
AH2BB-04 (127 x 89 x 3.0) - 2 Ball Bearing Button Tipped SS 304
AH2BB-05 (127 x 102 x 3.0) - 2 Ball Bearing Button Tipped SS 304

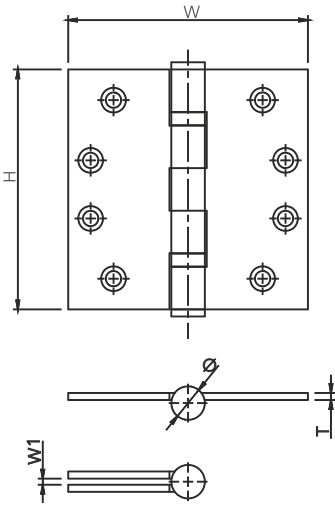

Ball Bearing Hinges

Hinge Size (mm):

Height	Width	Thickness	Grade
102	76	2.5	SS304
102	76	3.0	SS304
127	76	3.0	SS304
127	89	3.0	SS304
127	102	3.0	SS304
102	102	3.0	SS304

Door Hinges

Door Hinges

Model no.:AAH203, AAH204, AAH205, AAH206
AAH207, AAH210, AAH217, AAH218
AAH219, AAH220

Description:

- 2 Ball Bearing 5 knuckle hinges
- Square corners
- 304 stainless steel provides improved corrosion resistance
- Also available in SS316 Grade upon request
- Available with timber (W) or metal (M) door fixing :
Please specify requirement on order
- Also available with Security Stud Feature (DOG BOLT) upon request
- Weight up to 120 kg
- Investigated to ANSI/BHMA A156.1
- Also evaluated in accordance with standard UL 10C.

Description:

- Satin Stainless Steel - US32D
- Matt Bck
- SS ● Matt Black

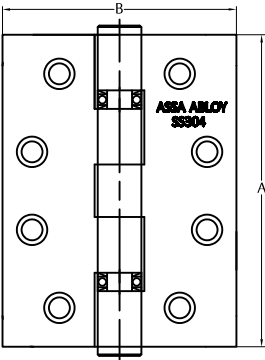

Product Information

Hinge Size (mm):

Model No.	Height	Width	Thickness
AAH203	102	76	3.0
AAH204	102	102	3.0
AAH205	102	89	3.0
AAH206	127	76	3.0
AAH207	114	102	3.4
AAH210	114	114	3.4
AAH217	114	102	3.0
AAH218	114	114	3.0
AAH219	127	89	3.0
AAH220	127	102	3.0

Note: The hinge must be bedded onto a 2mm thick intumescent behind both blades when fixed to a timber door

Available Finishes

- SSS :- Satin Stainless Steel

Door Hinges

Door Hinges

Model no.:AAH303, AAH304, AAH305, AAH306
AAH307, AAH310, AAH314D,
AAH315D, AAH316D

Description:

- Ball bearing race ideal for improved quality
- Square corners
- 304 stainless steel provides improved corrosion resistance
- Also available in Grade SS316 upon request
- Available with template or congruent (zigzag) fixing pattern: please specify requirement on order
- Available with timber (W) or metal (M) door
- Dog bolt hinges for additional security (D)
- 2ball beading hinges

Description:

- EN 1935:2002 performance-tested to 200,000 cycles on 120kg door mass
- Grade 13



Classification to EN1935						
4	7	6	1	1	4	0 13

Classification to En1935 with Dogbolt						
4	7	6	1	1	4	1 13

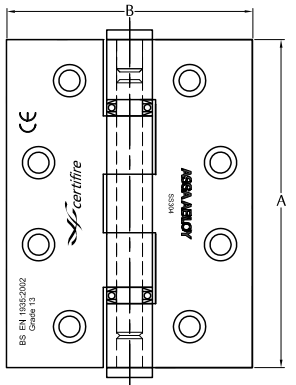

Product Information

Hinge Size (mm):

Model No.	Height	Width	Thickness
AAH303	102	76	3.0
AAH304	102	102	3.0
AAH305	102	89	3.0
AAH306	127	76	3.0
AAH307	114	102	3.4
AAH310	114	114	3.4
AAH314D	102	76	3.0
AAH315D	102	89	3.0
AAH316D	102	102	3.0

* are not approved for timber doors

Note: The hinge must be bedded onto a 2mm thick intumescent behind both blades when fixed to a timber door

Available Finishes

- SSS :- Satin Stainless Steel

Door Hinges

Flush Hinge

Description:Stainless Steel Flush hinge

Model No.	L	W	T	Door Mass
AA-FH-01	100	70	2	40 kg
AA-FH-02	127	76	3	80 kg

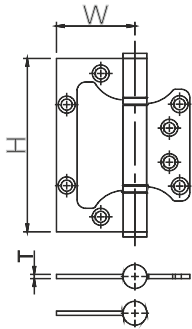

ASSA ABLOY Group is the global leader in access solutions. Every day, we help billions of people experience a more open world.

ASSA ABLOY

ASSA ABLOY Opening Solutions leads the development within door openings and products for access solutions in homes, business and institutions. Our offering includes doors, door and window hardware, locks, access control and service.

assaabloy.com

MUMBAI

EcoStar, 11th Floor, 1101 / 1105,
Off Aarey Road, Vishweshwar Nagar
Goregoan (East),
Mumbai - 400063,

PUNE

Sr. No.36, Hissa No.1, Plot No.11,
Village Pisoli Haveli Kondhwa,
Pune - 411 028,
Maharashtra

GURUGRAM

1&2, ENCO Co-working Space,
6th Floor, Enkay Tower,
Udyog Vihar, Phase – 5,
Gurugram -122016, Haryana

BENGALURU

#36/2, Fourth Floor,
JRR Towers, Near South-end Circle,
Basavanagudi,
Bengaluru-560 004, Karnataka

HYDERABAD

2nd Floor, Alcazar Mall,
Plot No. 497/498,
Road No. 36, Jubilee Hills,
Hyderabad-500 033, Telangana

CHENNAI

23-2, Old No 39-2, Cenotaph Road,
1st Lane, Near to Crown Plaza Hotel,
Opp Canara Bank, Teynampet,
Chennai-600 018