



# DC477

## Technical Datasheet

**ASSA ABLOY**  
Opening Solutions

Floor spring with Cam-Motion® technology for comfortable opening of heavy double action doors

Experience a safer  
and more open world

## DC477

### Floor spring with Cam-Motion® technology for single and double action doors, size 2-4



DC477 with Italian spindle, satin stainless steel

**Cam-Motion® technology** creates rapidly decreasing opening force without losing fire or smoke protection compliance

The DC477 with adjustable closing force is suitable for heavy doors. Balancing building design and accessibility, ASSA ABLOY floor springs are minimal on the outside and powerful on the inside – ideal for double action doors made of any material, even glass. The rapidly decreasing opening force of Cam-Motion technology ensures doors open with less effort.

- Certified in compliance with EN 1154, size 2-4
- Suitable for fire and smoke protection doors (not for hold-open variants)
- For single and double action doors up to 1100 mm width and 170 kg weight
- Barrier-free according to CEN/TR 15894

#### Cover plate finishes

- Polished stainless steel
- Satin stainless steel
- Polished brass

#### Features

- Premium construction provides double the industry standard for durability (over 1.000.000 test cycles)
- Hydraulic control from 170° in both door swing directions allows for smooth and controlled door operation
- Closing and latch speeds can be raised and lowered independently via top-facing valves
- Overpressure relief valve protects the floor spring from misuse
- Zinc plated cement box allows for large adjustment range to fix any alignment problems without taking down the door
- Detachable spindle in different lengths (0-30 mm) and variants allows flexible installation
- Consistent performance in a wide range of temperatures

#### Product variants

- Hold-open at 105° (cannot be used on fire doors)
- Hold-open at 90° (cannot be used on fire doors)
- Without hold-open

#### Accessories

- **AC115** reversible bottom arm, Italian spindle
- **AC393** reversible bottom arm, German spindle
- **AC8** double action top pivot
- **AC118** double action top pivot, adjustable pivot point
- **AC375** double action top pivot, full steel, self-lubricating bushing
- **AC583** right and left bottom arm, socket for Italian square spindle
- **AC392** right and left bottom arm, socket for German rectangular spindle
- **AC384** top pivot for left- or right-handed doors
- **AC612** sealing compound for floor springs
- **CP534** cover plate

#### Versatile applications

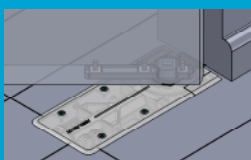

Double action doors

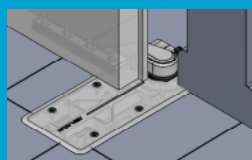

Left-handed doors



Right-handed doors

# DC477

## Technical attributes and certification

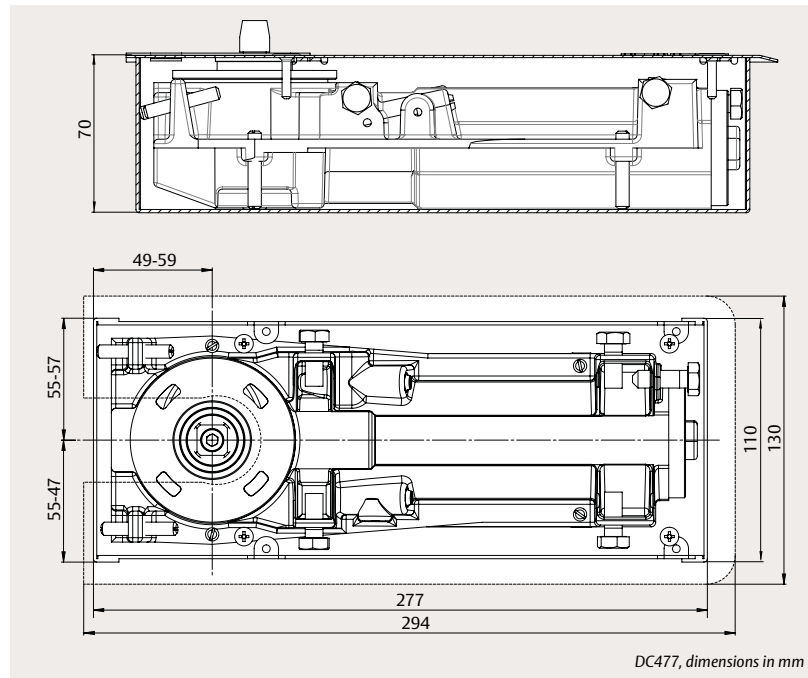

### Technical attributes

Closing force	EN size 2-4
Maximum leaf width	1100 mm
Maximum door weight	170 kg
Closing speed (C)	Variable between 170° and 15°
Latch speed (L)	Variable between 15° and 0°
Overpressure relief valve	Yes
Hold-open mode	105° / 90° / without hold-open
Maximum opening angle	~170°
Handing	Left- / right-handed or double action
Force adjustment	Yes
Body adjustment within cement box	9 mm vertical 4 mm side 10 mm front 4° angle
Hinge distance	55 – 57 mm
Corrosion resistance	Grade 4 (240 hours)
Dimensions (H x D x L)	70 x 110 x 277 mm



Visit [assaabloy.com](https://assaabloy.com) to download all relevant product literature



### Certification and testing

Certified in compliance with	EN 1154
CE classification	3   8   2-4   1   1   4
CE / UKCA mark	Yes
Suitable for fire and smoke protection doors	Yes
Barrier-free according to	CEN/TR 15894
Third-party verified EPD	ISO 14025, EN 15804



# DC477

## Mounting dimensions and accessories

### Mounting on double action doors

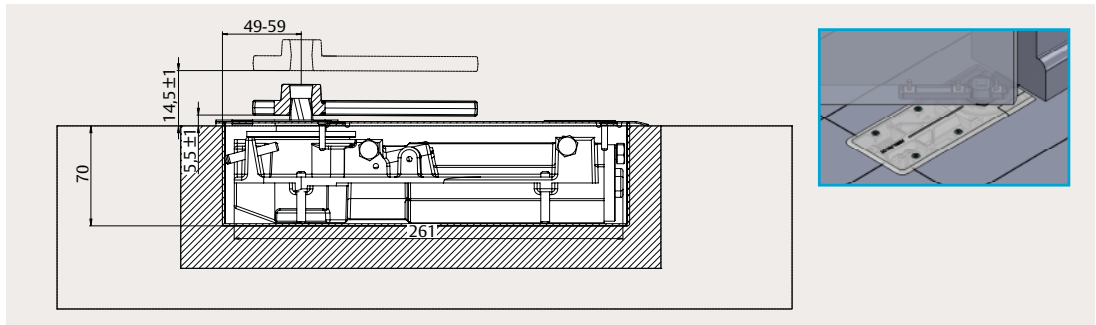

### Mounting on left- / right-handed doors with patch fitting V500 bottom hinge for centre-hung doors

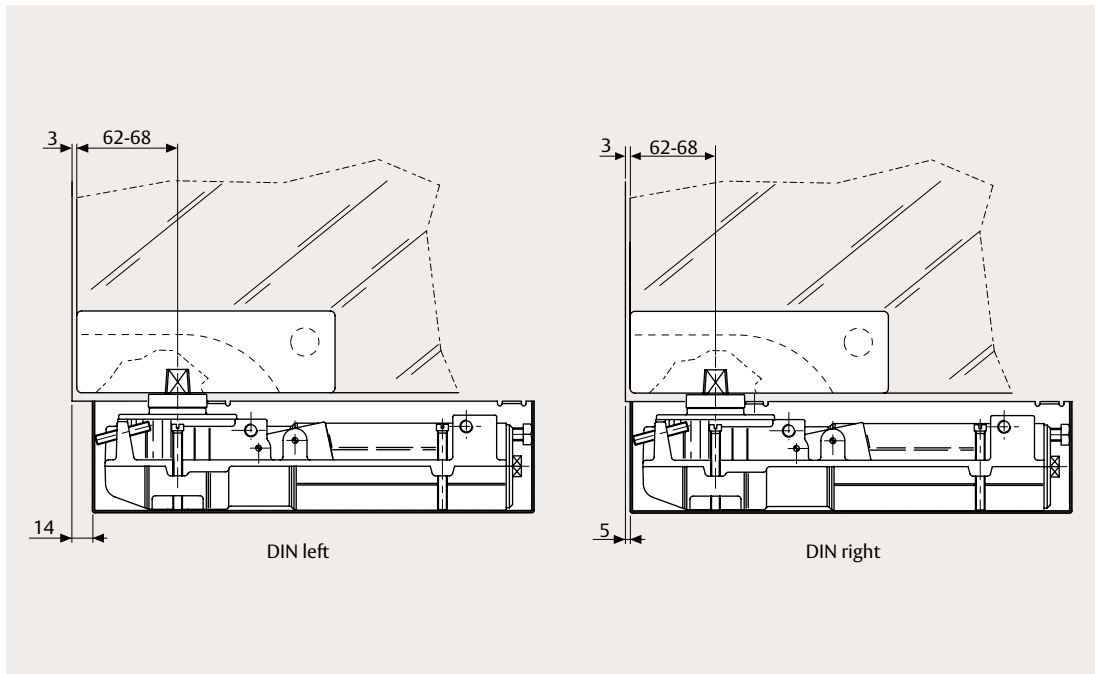

### CP534 cover plate for DC477

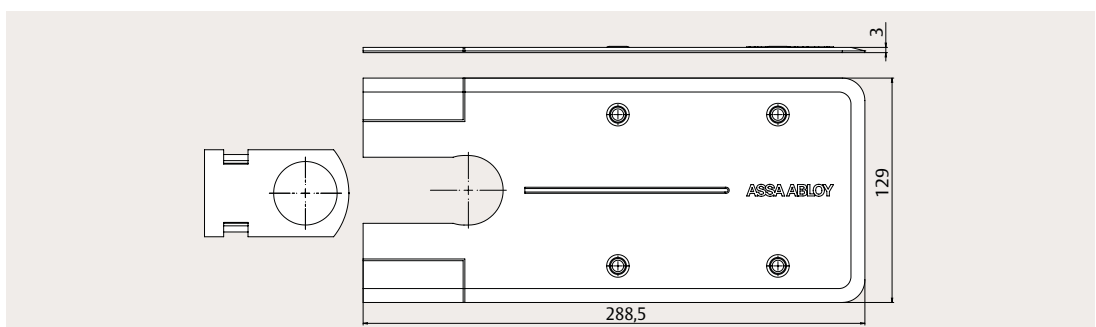

# DC477

## Accessories

### AC115 reversible bottom arm

for double action doors;  
socket for Italian squared  
spindle

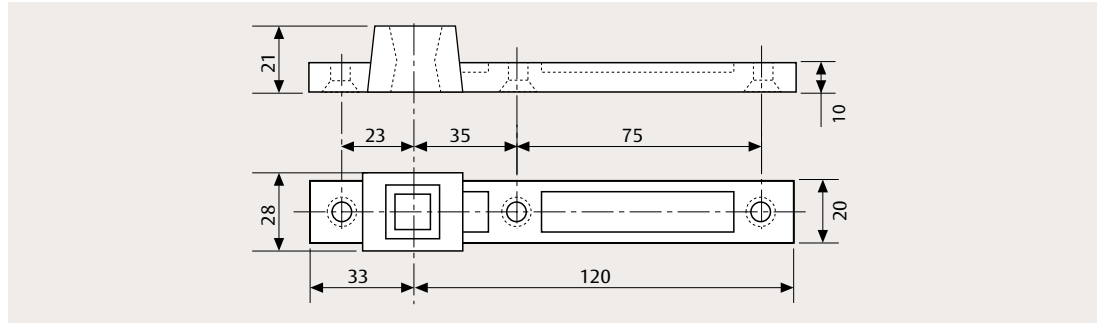

### AC393 reversible bottom arm

for double action doors;  
socket for German  
rectangular spindle

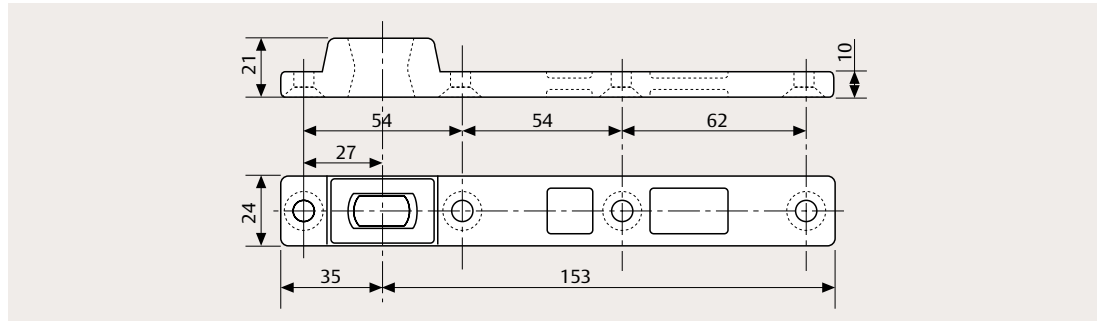

### AC8 top pivot

for double action doors

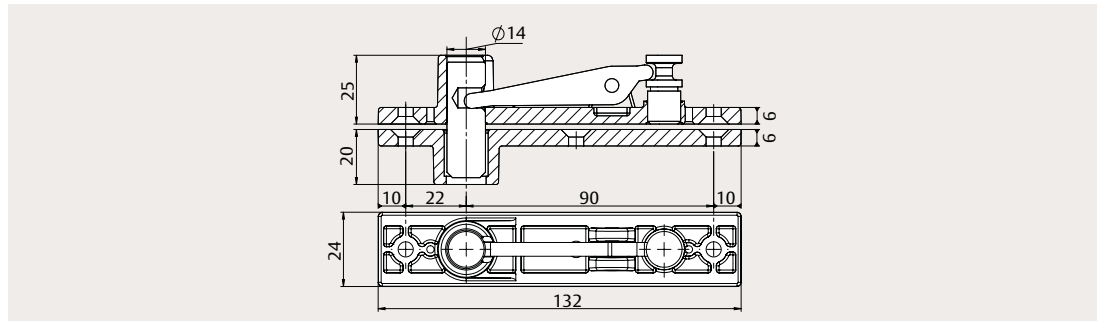

### AC118 top pivot

for double action doors;  
adjustable pivot point

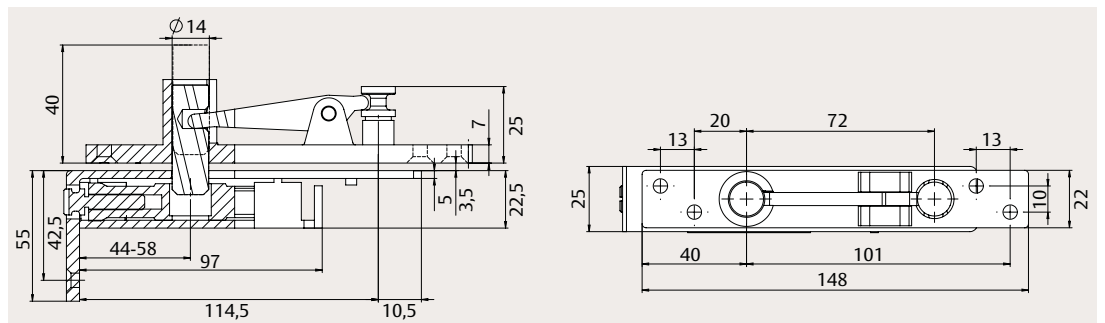

### A375 top pivot

for double action doors;  
self-lubricating bushing

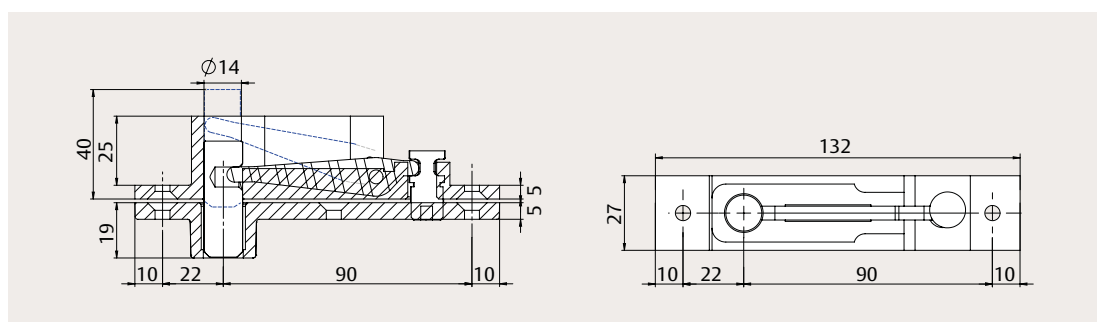

# DC477

## Accessories

### AC583 right and left bottom arm

for single action doors,  
36 mm offset; socket for  
Italian square spindle

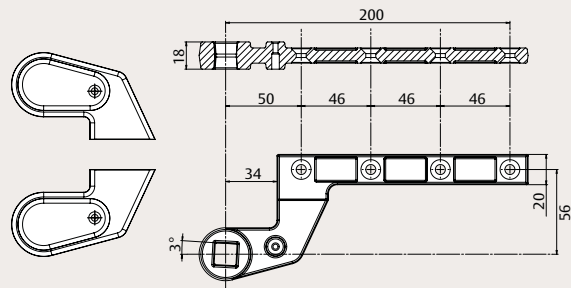

### AC392 right and left bottom arm

for single action doors,  
36 mm offset; socket  
for German rectangular  
spindle

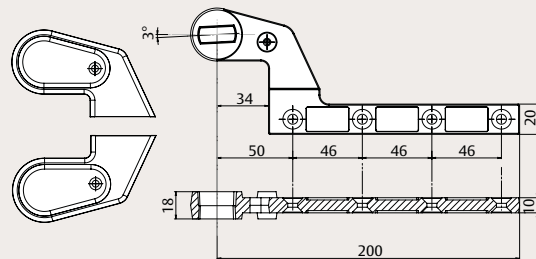

### AC384 right and left top arm

for single action doors,  
36 mm offset

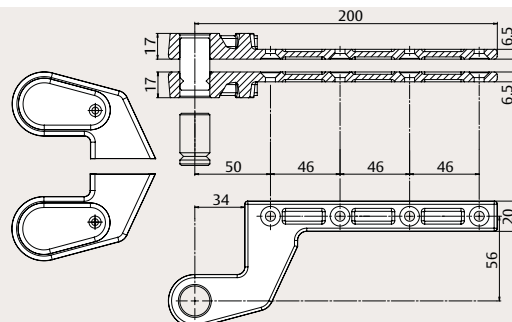

### AC612 sealing compound

for floor springs

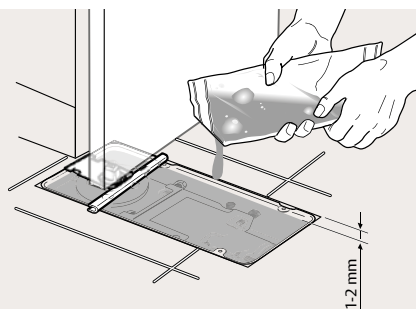

### Detachable spindles

Italian spindle with  
square shape

German spindle with  
flat-conical shape

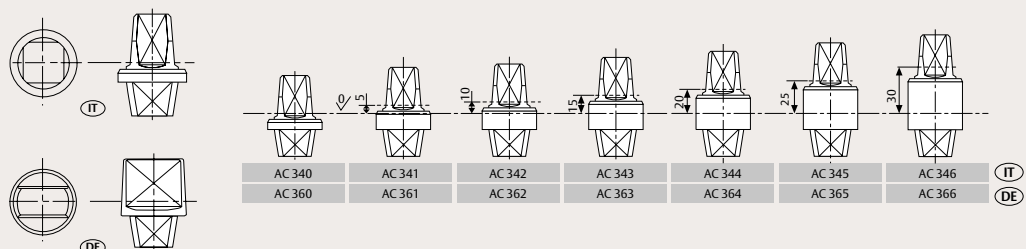

# DC477

## Order information



### Floor springs

DC477, EN size 2-4, with hold-open at 105°	DC477-----105
DC477, EN size 2-4, with hold-open at 90°	DC477-----90
DC477, EN size 2-4, without hold-open	DC477-----NHO

### Cover plates

CP534 cover plate for DC477, polished stainless steel	DCCP534----DPSS
CP534 cover plate for DC477, satin stainless steel	DCCP534----DSSS
CP534 cover plate for DC477, polished brass	DCCP534----DPBR

### Spindles

AC340 detachable Italian spindle, 0 mm, zinc plated	MA0340S0
AC341 detachable Italian spindle, 5 mm, zinc plated	MA0341S0
AC342 detachable Italian spindle, 10 mm, zinc plated	MA0342S0
AC343 detachable Italian spindle, 15 mm, zinc plated	MA0343S0
AC344 detachable Italian spindle, 20 mm, zinc plated	MA0344S0
AC345 detachable Italian spindle, 25 mm, zinc plated	MA0345S0
AC346 detachable Italian spindle, 30 mm, zinc plated	MA0346S0
AC360 detachable German spindle, 0 mm, zinc plated	MA0360S0
AC361 detachable German spindle, 5 mm, zinc plated	MA0361S0
AC362 detachable German spindle, 10 mm, zinc plated	MA0362S0
AC363 detachable German spindle, 15 mm, zinc plated	MA0363S0
AC364 detachable German spindle, 20 mm, zinc plated	MA0364S0
AC365 detachable German spindle, 25 mm, zinc plated	MA0365S0
AC366 detachable German spindle, 30 mm, zinc plated	MA0366S0

### Other accessories

AC115 reversible bottom arm, steel, socket for Italian spindle	MA0115S0
AC393 reversible bottom arm, steel, socket for German spindle	MA0393S0
AC8 double action top pivot	MA0008S0
AC375 double action top pivot, full steel, with self-lubricating bushing	MA0375S0
AC118 double action top pivot, with adjustable pivot point	MA0118S0
AC583 right and left bottom arm, steel, 36 mm offset, socket for Italian spindle, ABS cover silver	DCAC583---DEV1-
AC583 right and left bottom arm, steel, 36 mm offset, socket for Italian spindle, ABS cover black	DCAC583---D9004
AC392 right and left bottom arm, steel, 36 mm offset, socket for German spindle, ABS cover silver	DCAC392---DEV1-
AC392 right and left bottom arm, steel, 36 mm offset, socket for German spindle, ABS cover black	DCAC392---D9004
AC384 right and left top arm, full steel, 36 mm offset, ABS cover silver	DCAC384---DEV1-
AC384 right and left top arm, full steel, 36 mm offset, ABS cover black	DCAC384---9004
AC612 sealing compound for floor springs	MA0612S0

DC477



CP534, polished steel



CP534, satin steel



CP534, polished brass



AC340



AC360



AC115



AC393



AC375



AC118



AC583, silver



AC583, black



AC392, silver



AC392, black



The ASSA ABLOY Group is the global leader in access solutions. Every day, we help billions of people experience a more open world.

ASSA ABLOY Opening Solutions leads the development within door openings and products for access solutions in homes, businesses and institutions. Our offering includes doors, door and window hardware, locks, access control and service.

**ASSA ABLOY**  
Opening Solutions

ASSA ABLOY Opening Solutions EMEA  
Dukes Court  
Dukes Street  
Woking  
GU21 5BH  
United Kingdom  
[assaabloy.com](https://assaabloy.com)