



DC450EA

Technical Datasheet

ASSA ABLOY
Opening Solutions

Floor spring with Cam-Motion® technology
for comfortable opening of double action doors

Experience a safer
and more open world

DC450EA

Floor spring with Cam-Motion® technology for single and double action doors, size 2/3/4



DC450EA with Italian spindle, satin stainless steel

Cam-Motion® technology creates rapidly decreasing opening force without losing fire or smoke protection compliance

The DC450EA with fixed closing force is suitable for shallow applications. Balancing building design and accessibility, ASSA ABLOY floor springs are minimal on the outside and powerful on the inside – ideal for double action doors made of any material, even glass. The rapidly decreasing opening force of Cam-Motion technology ensures doors open with less effort.

- Certified in compliance with EN 1154, size 2, 3 or 4
- Suitable for fire and smoke protection doors (not for hold-open variants)
- For single and double action doors up to 1100 mm width and 120 kg weight
- Barrier-free according to CEN/TR 15894

Cover plate finishes

- Polished stainless steel
- Satin stainless steel

Features

- Premium construction provides double the industry standard for durability (over 1.000.000 test cycles)
- Hydraulic control from 170° in both door swing directions allows for smooth and controlled door operation
- Closing and latch speeds can be raised and lowered independently via top-facing valves
- Zinc plated cement box (only 40 mm high) allows for large adjustment range to fix any alignment problems without taking down the door
- Detachable spindle in different lengths (0-30 mm) and variants allows flexible installation
- Same dimensions for EN2, EN3 and EN4 products simplifies replacement
- Consistent performance in a wide range of temperatures

Product variants

- Hold-open at 105° (cannot be used on fire doors)
- Hold-open at 90° (cannot be used on fire doors)
- Without hold-open

Accessories

- **AC115** reversible bottom arm, Italian spindle
- **AC393** reversible bottom arm, German spindle
- **AC8** double action top pivot
- **AC118** double action top pivot, adjustable pivot point
- **AC375** double action top pivot, full steel, self-lubricating bushing
- **AC583** right and left bottom arm, socket for Italian square spindle
- **AC392** right and left bottom arm, socket for German rectangular spindle
- **AC384** top pivot for left- or right-handed doors
- **AC612** sealing compound for floor springs
- **CP308** cover plate retrofit kit for DC460
- **CP619** cover plate

Versatile applications

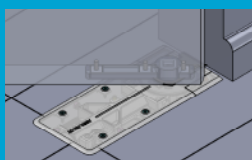

Double action doors



Left-handed doors



Right-handed doors

DC450EA

Technical attributes and certification

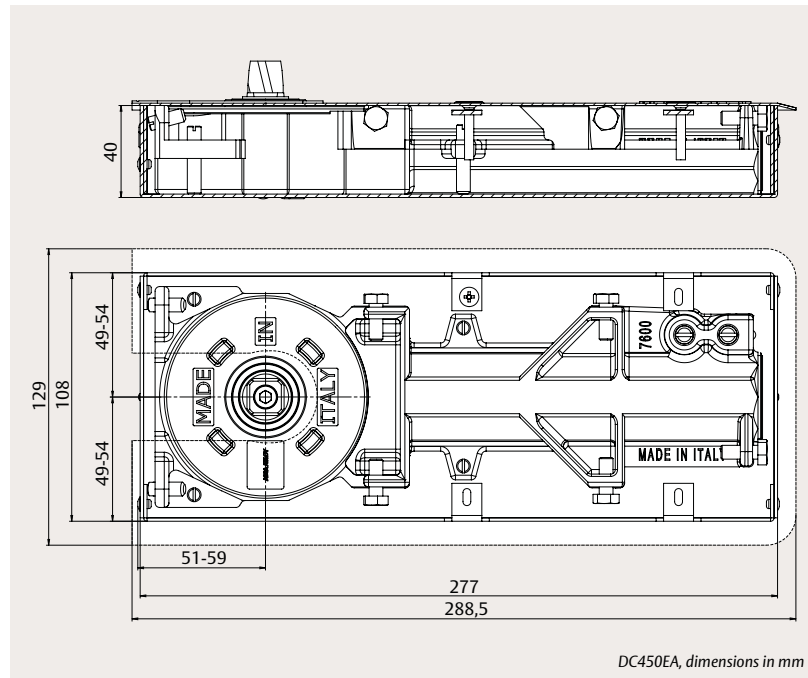

DC450EA, dimensions in mm



Technical attributes

Closing force	EN size 2/3/4
Maximum leaf width	850 mm / 950 mm / 1100 mm
Maximum door weight	120 kg
Closing speed (C)	Variable between 170° and 15°
Latch speed (L)	Variable between 15° and 0°
Hold-open mode	105° / 90° / without hold-open
Maximum opening angle	~170°
Handing	Left- / right-handed or double action
Force adjustment	No
Body adjustment within cement box	2 mm vertical 6 mm side 7 mm front 4° angle
Hinge distance	49 – 54 mm
Corrosion resistance	Grade 4 (240 hours)
Dimensions (H x D x L)	40 x 108 x 277 mm



Visit assaabloy.com to download all relevant product literature



Certification and testing

Certified in compliance with	EN 1154
CE classification	3 8 2/3/4 1 1 4
CE / UKCA mark	Yes
Suitable for fire and smoke protection doors	Yes (≥EN3)
Barrier-free according to	CEN/TR 15894
Third-party verified EPD	ISO 14025, EN 15804



DC450EA

Mounting dimensions and accessories

Mounting on double action doors

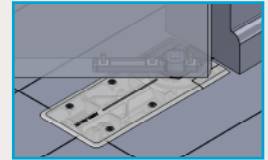
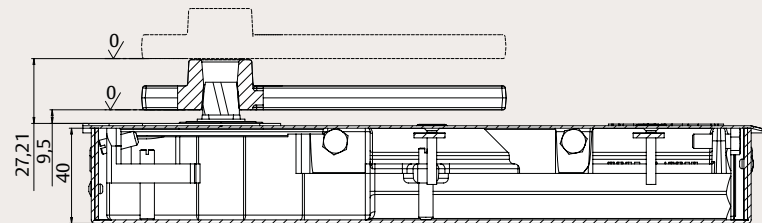

Mounting on left- / right-handed doors

The drawing shows mounting on a left-handed door. For right-handed doors it is the reverse.

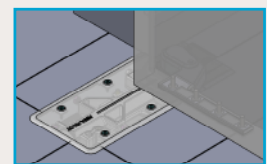
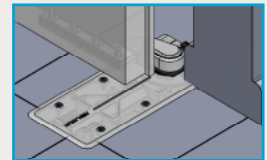
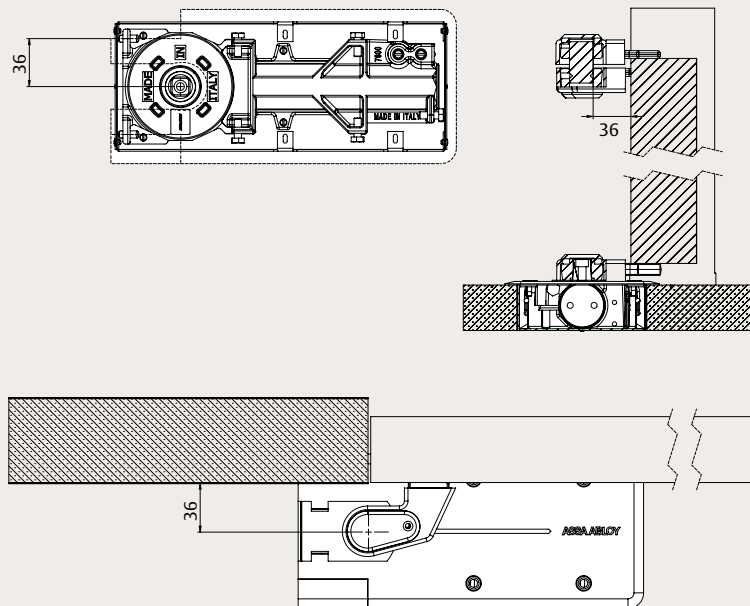

CP619 cover plate for DC450

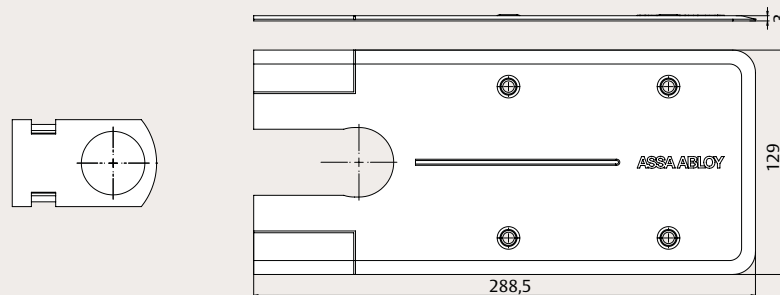

CP308 cover plate for DC460 retrofit

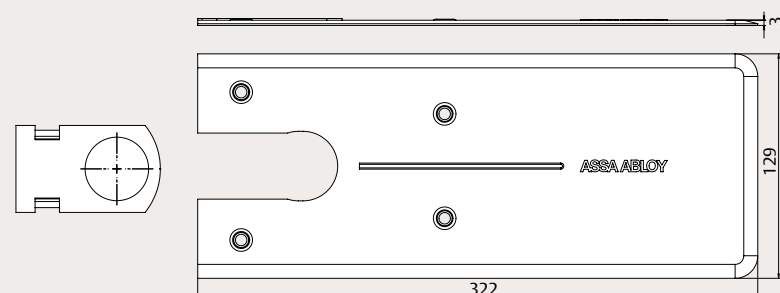

DC450EA

Accessories

AC115 reversible bottom arm

for double action doors;
socket for Italian squared
spindle

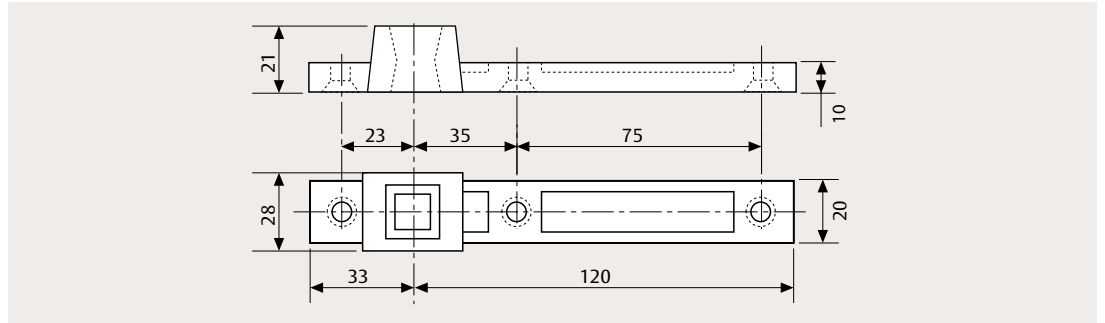

AC393 reversible bottom arm

for double action doors;
socket for German
rectangular spindle

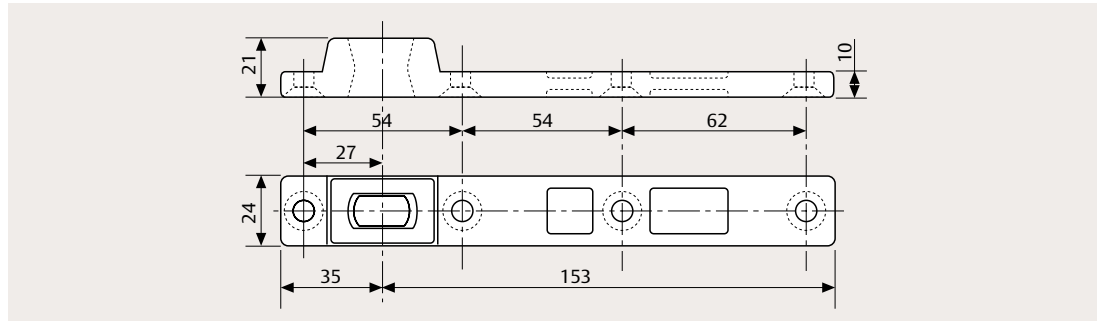

AC8 top pivot

for double action doors

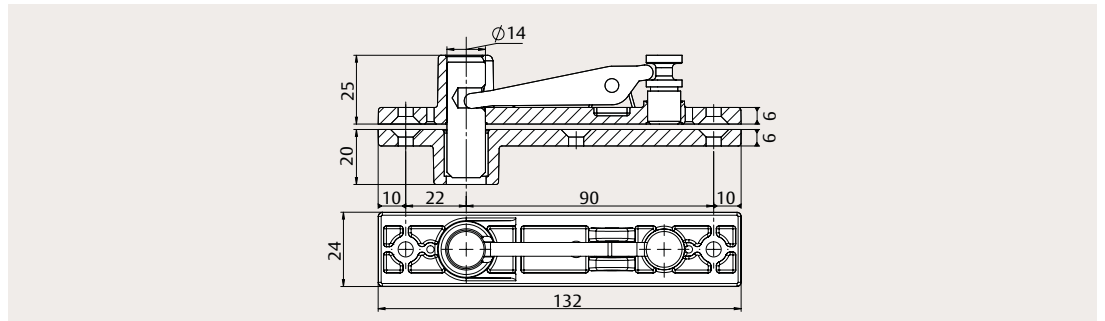

AC118 top pivot

for double action doors;
adjustable pivot point

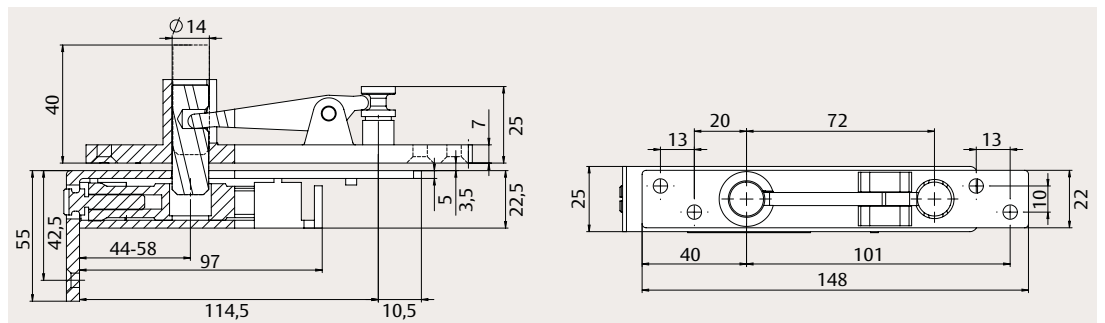

A375 top pivot

for double action doors;
self-lubricating bushing

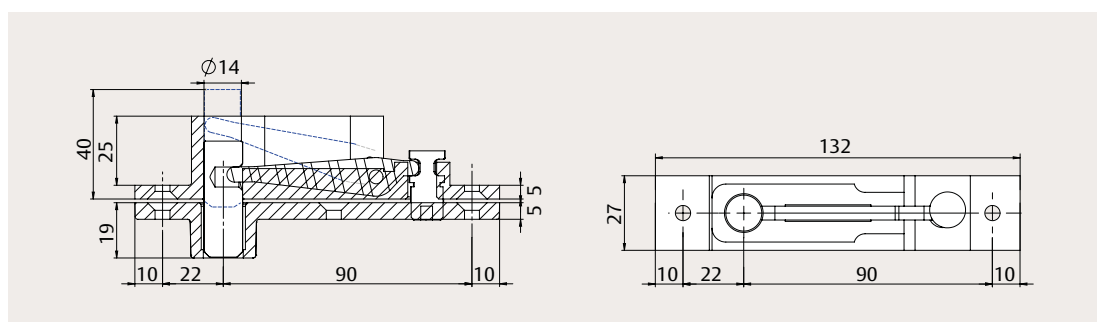

DC450EA

Accessories

AC583 right and left bottom arm

for single action doors,
36 mm offset; socket for
Italian square spindle

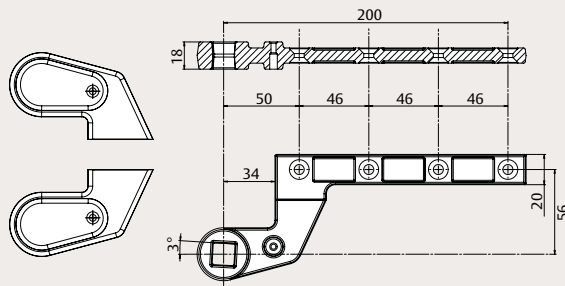

AC392 right and left bottom arm

for single action doors,
36 mm offset; socket
for German rectangular
spindle

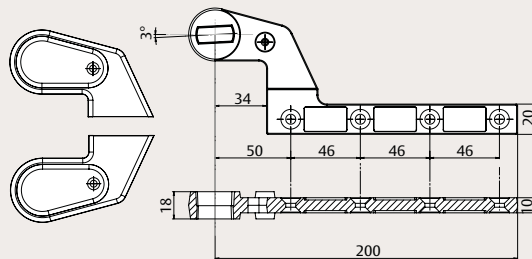

AC384 right and left top arm

for single action doors,
36 mm offset

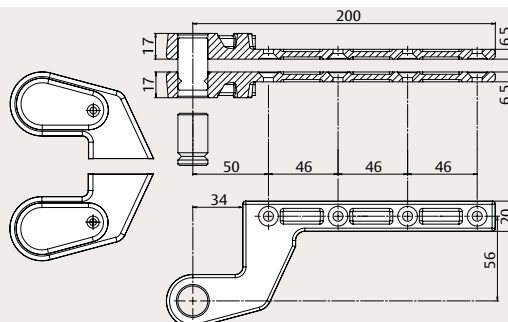

AC612 sealing compound

for floor springs

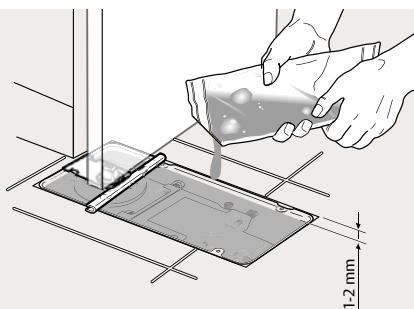

Detachable spindles

Italian spindle with
square shape

German spindle with
flat-conical shape

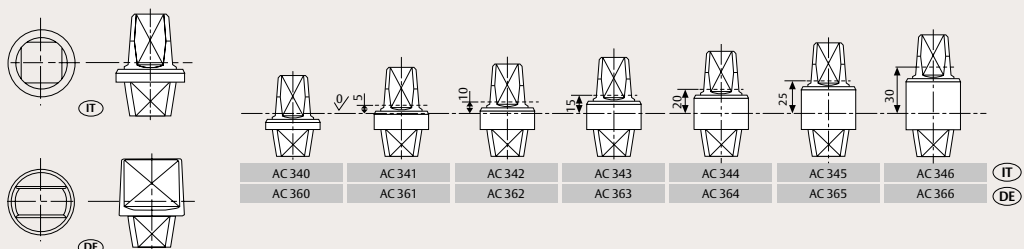

DC450EA

Order information



Floor springs

DC450EA, EN size 2, with hold-open at 105°	DC450EA---2-105
DC450EA, EN size 2, with hold-open at 90°	DC450EA---2--90
DC450EA, EN size 2, without hold-open	DC450EA---2-NHO
DC450EA, EN size 3, with hold-open at 105°	DC450EA---3-105
DC450EA, EN size 3, with hold-open at 90°	DC450EA---3--90
DC450EA, EN size 3, without hold-open	DC450EA---3-NHO
DC450EA, EN size 4, with hold-open at 105°	DC450EA---4-105
DC450EA, EN size 4, with hold-open at 90°	DC450EA---4--90
DC450EA, EN size 4, without hold-open	DC450EA---4-NHO

Cover plates

CP619 cover plate for DC450EA, polished stainless steel	DCCP619-----PSS
CP619 cover plate for DC450EA, satin stainless steel	DCCP619-----SSS
CP308 cover plate retrofit kit for DC460, satin stainless steel	DCCP308-----DSSS
CP308 cover plate retrofit kit for DC460, polished stainless steel	DCCP308-----DPSS

Spindles

AC340 detachable Italian spindle, 0 mm, zinc plated	MA0340S0
AC341 detachable Italian spindle, 5 mm, zinc plated	MA0341S0
AC342 detachable Italian spindle, 10 mm, zinc plated	MA0342S0
AC343 detachable Italian spindle, 15 mm, zinc plated	MA0343S0
AC344 detachable Italian spindle, 20 mm, zinc plated	MA0344S0
AC345 detachable Italian spindle, 25 mm, zinc plated	MA0345S0
AC346 detachable Italian spindle, 30 mm, zinc plated	MA0346S0
AC360 detachable German spindle, 0 mm, zinc plated	MA0360S0
AC361 detachable German spindle, 5 mm, zinc plated	MA0361S0
AC362 detachable German spindle, 10 mm, zinc plated	MA0362S0
AC363 detachable German spindle, 15 mm, zinc plated	MA0363S0
AC364 detachable German spindle, 20 mm, zinc plated	MA0364S0
AC365 detachable German spindle, 25 mm, zinc plated	MA0365S0
AC366 detachable German spindle, 30 mm, zinc plated	MA0366S0

Other accessories

AC115 reversible bottom arm, steel, socket for Italian spindle	MA0115S0
AC393 reversible bottom arm, steel, socket for German spindle	MA0393S0
AC8 double action top pivot	MA0008S0
AC375 double action top pivot, full steel, with self-lubricating bushing	MA0375S0
AC118 double action top pivot, with adjustable pivot point	MA0118S0
AC583 right and left bottom arm, steel, 36 mm offset, socket for Italian spindle, ABS cover silver	DCAC583---DEV1-
AC583 right and left bottom arm, steel, 36 mm offset, socket for Italian spindle, ABS cover black	DCAC583---D9004
AC392 right and left bottom arm, steel, 36 mm offset, socket for German spindle, ABS cover silver	DCAC392---DEV1-
AC392 right and left bottom arm, steel, 36 mm offset, socket for German spindle, ABS cover black	DCAC392---D9004
AC384 right and left top arm, full steel, 36 mm offset, ABS cover silver	DCAC384---DEV1-
AC384 right and left top arm, full steel, 36 mm offset, ABS cover black	DCAC384---9004
AC612 sealing compound for floor springs	MA0612S0

DC450EA



CP619, polished



CP619, satin



CP308, polished



CP308, satin



AC340



AC360



AC115



AC393



AC375



AC118



AC583, silver



AC583, black



AC392, silver



AC392, black



The ASSA ABLOY Group is the global leader in access solutions. Every day, we help billions of people experience a more open world.

ASSA ABLOY Opening Solutions leads the development within door openings and products for access solutions in homes, businesses and institutions. Our offering includes doors, door and window hardware, locks, access control and service.

ASSA ABLOY
Opening Solutions

ASSA ABLOY Opening Solutions EMEA
Dukes Court
Dukes Street
Woking
GU21 5BH
United Kingdom
assaabloy.com