



ASSA ABLOY

ASSA ABLOY Aperio®

Technical Catalogue

Experience a safer
and more open world



Table Of Contents

4 Introducing Aperio Wireless Locking Technology

Expand your new or existing access control system without wiring doors	4
Aperio product overview	5
Aperio is ready for both offline and online integration	8
Extend your favourite access control features to more doors	10
Everybody benefits from Aperio Wireless Access Control	12

13 Aperio AU100 Wireless Lock

Aperio AU100 Wireless Lock Technical Information	14
Aperio AU100 Wireless Lock Ordering Information	17

18 Aperio E100 Wireless Escutcheon

Aperio E100 Wireless Escutcheon Technical Information	19
Aperio E100 Wireless Escutcheon Ordering Information	21

22 Aperio H100 Wireless Handle

Aperio H100 Wireless Handle Technical Information	23
Aperio H100 Wireless Handle Ordering Information	25

26 Aperio C100 Wireless Cylinder

Aperio C100 Wireless Cylinder Technical Information	27
Aperio C100 Wireless Cylinder Ordering Information	29

30 Aperio ES100 Wireless Reader & Integrated Strike

Aperio ES100 Series Wireless Electric Strikes Technical Information	31
Aperio ES100 Series Wireless Electric Strikes Ordering Information	32

34 Aperio DR100 Wireless Reader with Relay

Aperio DR100 Wireless Wall Reader with Relays Technical Information	35
Aperio DR100 Wireless Wall Reader Ordering Information	37

38 Aperio KL100 Wireless Locker/Cabinet Lock

Aperio KL100 Wireless Locker/Cabinet Lock Technical Information	39
Aperio KL100 Wireless Locker/Cabinet Lock Ordering Information	41

42 Aperio P100 Wireless Padlock

Aperio P100 Wireless Padlock Technical Information	43
Aperio P100 Wireless Padlock Ordering Information	45

46 Aperio Communication Hub

Aperio Communication Hub Technical Information	47
Aperio Communication Hub Ordering Information	49

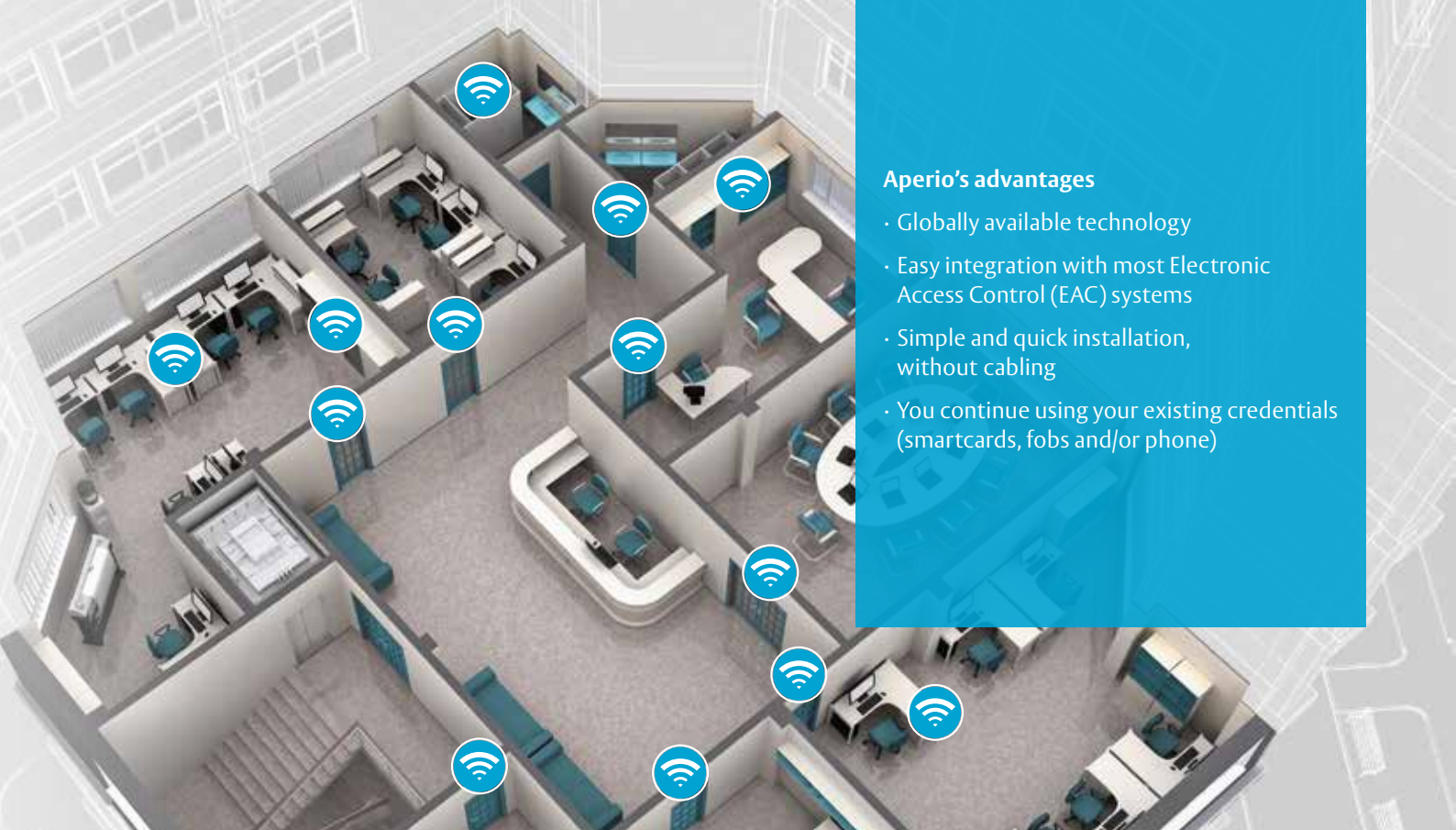

Aperio's advantages

- Globally available technology
- Easy integration with most Electronic Access Control (EAC) systems
- Simple and quick installation, without cabling
- You continue using your existing credentials (smartcards, fobs and/or phone)

Expand Your New Or Existing Access Control System Without Wiring Doors

Integrate more doors into your existing access control system by adding Aperio battery-powered locks

Installing traditional access control doors is costly due to extensive wiring requirements, limiting security coverage to high-priority doors. Other doors retain mechanical locks, lacking monitoring and management capabilities. A lost master key poses a significant security risk. Aperio technology offers a solution: wirelessly equipping doors with integrated RFID and mobile readers, seamlessly integrating them into your access control system. This enhances control, adapts to organizational changes, and streamlines security management.

Users carry a single credential (RFID, mobile, wearable) for all access needs, simplifying the process.

Communication hub

Control up to 64 doors* with the Aperio communication hub for indoor use. Easy and cost-effective to install, the hub is the nexus between the Aperio devices and the EAC system.

Communication happens in real time.

For more information, please refer to page 46



* Access control panel dependant.

Aperio Product Overview

	High Security* Door	Medium Security Door	Standard to Medium Security Door
	AU100	E100	H100
Device	Wireless lock with RFID reader, keypad, and Seos mobile credential support.	Wireless escutcheon with RFID and Bluetooth reader, compatible with Seos mobile credentials.	Wireless handle with RFID and NFC/Bluetooth reader.
Usage	Suitable for internal and semi-protected outdoor doors, e.g., high-traffic areas like office entrances or restricted zones.	Ideal for internal and medium to high-traffic doors, such as commercial buildings, offices, or schools. It integrates seamlessly with access control systems.	Ideal for interior doors in offices, meeting rooms, archives, and other spaces requiring secure access control.
Ease of installation	Retrofits existing mechanical Lockwood mortice locks (compatible with 3772 and 5782 series) without modifying the mortice.	mechanical 3772 series mortice locks, without requiring additional door modifications.	No additional drilling or cabling is required; retrofits easily onto existing mechanical lock cases (8mm spindles, such as the Lockwood mortice locks).
Power	Battery powered (4 x AA), supporting up to 40,000 operations, with a battery life of approximately two years. Battery low warnings are sent to the access control system.	Battery powered with a lifetime of up to 40,000 operations (using a lithium CR123A battery). Battery low warnings are sent to the access control system.	Battery: 30 openings per day for 50 months
Multi-authentication	Yes: Supports RFID credentials, Seos mobile access, and PIN via a capacitive keypad.	Supports RFID credentials and Seos mobile access, with the ability to integrate Bluetooth for mobile credentials.	credentials, including MIFARE Classic, iCLASS, and Seos, as well as mobile credentials via NFC/Bluetooth.
Credentials	Supports multiple high-frequency RFID technologies such as Mifare Classic/Plus, iCLASS, DESFire, Seos and LEGIC and mobile technologies (NFC and BLE).	Supports multiple high-frequency RFID technologies such as Mifare Classic/Plus, iCLASS, DESFire, Seos and LEGIC and mobile technologies (NFC and BLE).	Supports multiple high-frequency RFID technologies such as Mifare Classic/Plus, iCLASS, DESFire, Seos and LEGIC and mobile technologies (NFC and BLE).
Status information	<ul style="list-style-type: none"> • Door position (open/closed) • Bolt position (secured/unsecured) • Key override support • Handle position (Rex monitoring for egress) 	<ul style="list-style-type: none"> - Wireless communication with 5-10 seconds heartbeat. - Local storage of up to 200 events for audit trails. - Door position and lock status monitoring. 	<ul style="list-style-type: none"> - LED indicators for operation feedback (red/green/orange). - Wireless communication with the access control system. - Offline/online operation modes, including the Aperio Standard OSS Offline mode.
Accessories	Keypads, wireless hubs, and spindles are part of the solution.	Includes USB interface for electronic configuration.	U-handle option available along with various other mechanical hardware choices.
Certification	Fire rated (Australian Standard AS1905.1 for fire doors), compliant with Australian Lock Standards for security and durability, as well as European electrical compliance standards.	Compliant with Australian standards for security, fire safety, and durability (AS4145.2:1993 and AS1905.1:2005).	Certified according to Australian standards (CE, UKCA, and EN1634 for fire safety).
Feedback	LED indicator and audible buzzer for user feedback.	Provides visual and audible feedback via LED and buzzer.	LED provides visual feedback for authentication and operation status. This wireless handle provides a cost-effective and seamless solution for upgrading to access control without extensive installation requirements
Smart Credential Cache	Up to 1000 users can be granted access even if the EAC is temporarily down.		
Operation	All products can run in online and offline* (OSS included) mode.		

Aperio Product Overview

	Standard to Medium Security Door	Medium security, high traffic doors	Medium security, high traffic doors	Medium Security Cabinet Door	Standard to Medium Security Opening
	C100	DR100	ES100	KL100	P100
Device	Cylinder with RFID and NFC/Bluetooth reader.	Wall-mounted reader with secure relays, RFID and NFC/BLE-enabled for high-traffic doors.	Wireless Wall mounted reader with Battery powered strike RFID and NFC/ BLE-enabled for high-traffic doors.	Cabinet lock with RFID and NFC/ BLE reader.	Wireless padlock with RFID and NFC/Bluetooth reader.
Usage	Ideal for internal doors like offices, meeting rooms, and server cabinets, with no drilling or cabling required.	Designed for high-traffic doors such as entrance doors, turnstiles, overhead doors, loading bays, and roof access points.	The Aperio ES100 is a wireless integrated electric strike designed to retrofit doors with real-time online access control, making it a versatile and cost-effective solution for upgrading security systems without extensive wiring.	Suitable for lockers, drawers, cupboards, and other interior cabinet applications in environments such as hospitals, offices, retail, and staff lockers.	Designed for securing non-standard openings such as toolboxes, storage cages, and containers. Suitable for outdoor and rugged environments thanks to its IP66 rating, ensuring weather and dust resistance.
Ease of installation	- No additional drilling or cabling required, designed to retrofit existing mechanical doors. - Compatible with standard Lockwood Australian oval 570 series cylinders, making installation straightforward.	Minimal drilling, i- Minimal drilling required. - Interconnecting cables are used for simple integration. - Powered by a 12-24 VDC power supply, suitable for quick retrofitting into existing systems.	The Aperio ES100 is widely recognized for its ease of installation, making it a popular choice for retrofitting doors with wireless access control	- No additional drilling or cabling required. - Can be installed on metal or wooden doors with standard cutouts (18/22 or 16/19 mm). - Supports both left and right-handed cabinet openings and can be installed vertically to secure drawers.	- No drilling or cabling required. - Can be easily swapped with mechanical padlocks, providing a quick upgrade to digital access control.
Power	Powered by a lithium CR2 battery, offering up to 30,000 operations (approximately two years of use).	Requires a 12-24 VDC power source for operation.	The Aperio ES100 is powered by two AA lithium batteries, delivering up to 45,000 access cycles per set, it includes a microUSB port for emergency power, making it a highly efficient and easy-to-install solution for retrofitting doors with real-time access control.	Powered by a single CR123A lithium battery, which supports up to 40,000 operations or several years of usage.	Powered by a single CR2 lithium battery, supporting up to 30,000 operations or approximately 2 years of usage under normal conditions.
Multi-authentication	Yes: Supports RFID and mobile credentials (NFC/Bluetooth).	Supports RFID and mobile credentials (NFC/Bluetooth) for secure access control.	Supports RFID and mobile credentials (NFC/Bluetooth) for secure access control.	Supports a variety of credentials, including RFID cards, NFC-enabled smartphones, Bluetooth, and other mobile credentials.	- Provides real-time status feedback through LED indicators (red/green/orange) showing access granted/denied, tamper detection, and battery status.
Credentials	RFID Credentials: ** - MIFARE Classic® - MIFARE Ultralight® - MIFARE® DESFire® - MIFARE Plus® - iCLASS SE® - iCLASS Seos® - iCLASS Seos Elite® - **Mobile Credentials: ** - NFC-enabled mobile credentials. - Bluetooth for mobile access via smartphones.	RFID Credentials: - MIFARE Classic®, - MIFARE DESFire®, - iCLASS SE®, - iCLASS Seos® - HID Mobile Access (BLE and NFC). - Mobile Credentials: - NFC and Bluetooth-enabled mobile credentials for access using smartphones and compatible devices.	RFID Credentials: - MIFARE Classic®, - MIFARE DESFire®, - iCLASS SE®, - iCLASS Seos® - HID Mobile Access (BLE and NFC). - Mobile Credentials: - NFC and Bluetooth-enabled mobile credentials for access using smartphones and compatible devices.	- RFID Credentials: - MIFARE Classic® - MIFARE DESFire® - iCLASS SE® - iCLASS Seos® - Mobile Credentials: - NFC-enabled mobile credentials. - Bluetooth for mobile access via smartphones.	- RFID Credentials: - MIFARE Classic® - MIFARE Ultralight® - MIFARE® DESFire® - MIFARE Plus® - iCLASS SE® - iCLASS Seos® - iCLASS Seos Elite® - Mobile Credentials: - NFC and Bluetooth-enabled credentials via smartphones.
Status information	LED indicators (red/green/orange) provide feedback on lock status and battery life. Battery low warnings are communicated to the access control system. Tracks events and credential, with data stored locally for audit purposes.	- Provides status feedback such as: - Door position (open/closed) - Tamper detection - Request to exit (REX) input.	- The Aperio ES100 features a bi-color LED indicator that provides visual feedback on lock status and system activity using red, amber, and green lights. It also supports real-time monitoring of door position, lock state, tamper events, battery health, and request-to-exit signals.	- Provides real-time feedback through built-in LED indicators (red/green/yellow) for access granted or denied, tamper detection, and battery status monitoring.	- Provides real-time status feedback through LED indicators (red/green/orange) showing access granted/denied, tamper detection, and battery status.
Accessories	Rubber cover sleeve for added protection.	No additional accessories required, though optional features like additional power supplies or connectors may be added for specific environments.	- Accessories include interchangeable faceplates and adjustable shims for compatibility with different door types, monitored kits like the MH Security Kit for latch and door position monitoring, and request-to-exit capabilities, and offers tamper-resistant strike bodies in multiple depths.	- Different cam options are available depending on specific application needs (e.g., straight cam or long throat for timber doors).	- Aperio Hubs (AH30 and AH20). - Battery change tool: tool for replacing CR2 lithium battery. - Optional Override Credentials: Up to 10 override credentials can be set up for emergency access in case of communication failure.
Certification	CE, UKCA, EN 15684:2012 Compliant with CE, UKCA, EN 15684:2012 (1680AF30), and fire-rated according to EN 1634 for doors up to 90 minutes.	Compliant with CE and UKCA standards, providing reliable and certified performance in security environments.	Compliant with CE, UKCA, RCM, R-NZ.	Certified under CE and UKCA standards, ensuring its compliance with security and operational requirements.	Certified with CE, UKCA, and RCM standards, ensuring its compliance with security and performance requirements.
Feedback	LED indicators provide visual feedback (red/green/orange) for lock status.	Includes LED status feedback to visually indicate the lock's state.	Includes LED status feedback to visually indicate the lock's state	LED Indicators and Battery Feedback	- LED indicators provide visual feedback on the lock's status, battery life, and access attempts, making it easy for users and administrators to monitor its functionality.
Smart Credential Cache	Up to 1000 users can be granted access even if the EAC is temporarily down.				
Operation	All products can run in online and offline (OSS included) mode.				



Aperio is Ready for Both Offline and Online Integration

Aperio Online Integration: Door Monitoring in Real Time

Aperio Online integrations offer real-time lock-to-system, instant audit trails and remote locking/unlocking function. Online integration puts you in total control of access and equips you to react quickly to any emergency. When integrated online, Aperio locks connect with your system via a range of different Communication Hubs to control up to 64* doors within a range of 25 metres.

Online Aperio locks are compatible with all standard RFID technologies. Online integration provides the option to cache 1,000 valid credentials.

Aperio Offline Integration: Access Rights On Card via Updater

Aperio Offline locks are installed wire-free and integrate seamlessly with a new or existing access control system*. Individual lock and user permissions updates may be completed remotely or locally, via the update readers. For maximum compatibility with new and existing systems, Aperio Offline locks accept most RFID technologies, incorporating audit trail support. With Aperio, you can also combine Offline and Online doors within the same installation.

Aperio Offline locks support both ASSA ABLOY Offline and OSS Standard Offline protocols, guaranteeing interoperability with a broad range of access systems.

Aperio Wireless Access Control Technology Adapts To Your Security Needs

All
integrations
Online and/or
Offline

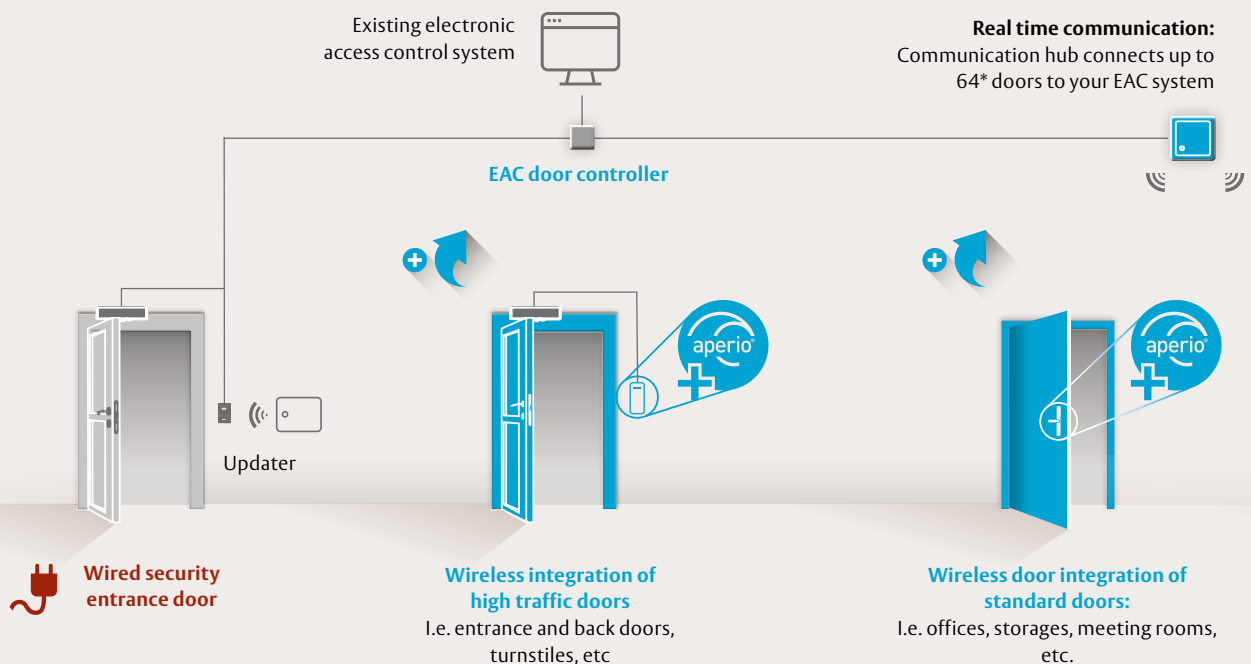

* Panel dependant.

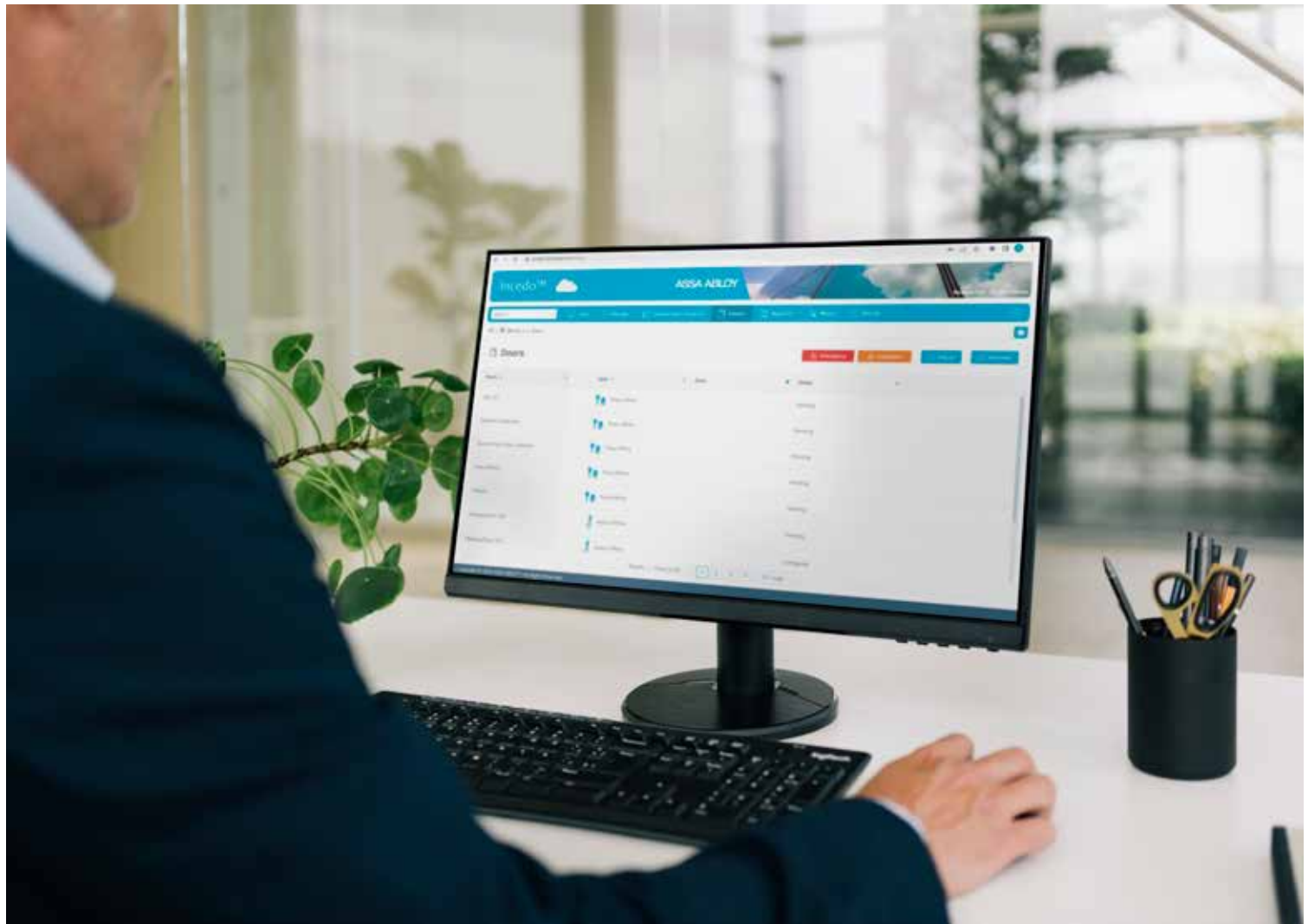

Make Non-Standard Openings Part of Your EAC System

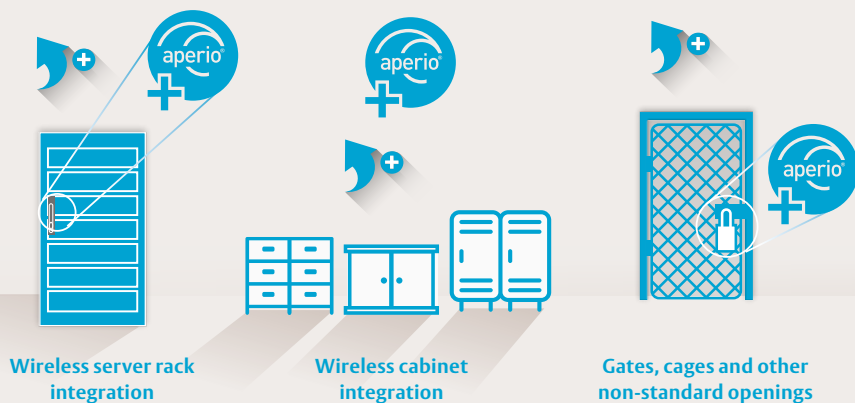

Continue Using Your Credentials



For comprehensive details
on credential technologies,
consult the product
datasheet pages



**Upgrade to mobile credentials
whenever you are ready:**
Aperio works with RFID and
mobile technologies simultaneously

Extend Your Favourite Access Control Features To More Doors

Aperio has integration in its DNA, making it easy to extend the reach and capacity of your access control without wiring. Doors previously secured with mechanical locking can now be integrated into an access control system and unlocked with the same credentials.

Aperio-equipped access points are managed from the existing system software interface. Over 130 access control manufacturers globally have already integrated battery-powered Aperio locks to work seamlessly with their system, ensuring you benefit from all supported EAC features.



Multi-RFID Technology

The ability to use different RFID card technologies within the same system.

Aperio devices supporting this feature

The entire Aperio product family

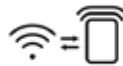

Online/Offline Transition*

Seamless transition between the two modes without the need to replace or modify locks.

Aperio devices supporting this feature

The entire Aperio product family



Unlimited Users

There is no limit to the number of users who can open a door. This number is set by the access control system.

Aperio devices supporting this feature

The entire Aperio product family

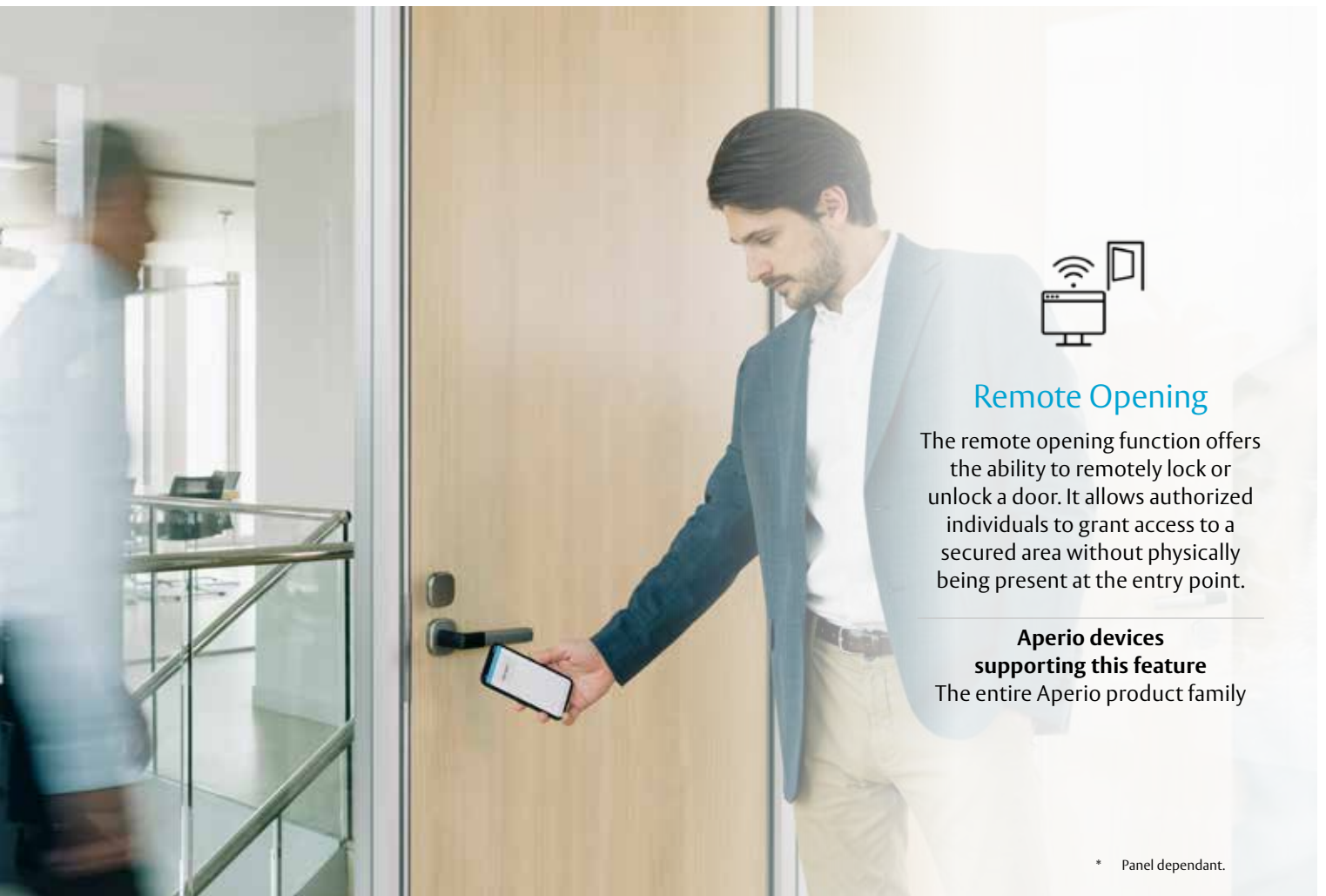

Remote Opening

The remote opening function offers the ability to remotely lock or unlock a door. It allows authorized individuals to grant access to a secured area without physically being present at the entry point.

Aperio devices supporting this feature

The entire Aperio product family

* Panel dependant.



Emergency Code

Emergency (or Duress) code is a security feature designed to protect individuals in potentially dangerous situations.

With Emergency Code enabled, a silent hold-up alarm triggers in the security centre if, in a threatening situation, a credential-holder uses their access card along with an attack code instead of her/his own PIN.

Aperio devices supporting this feature

Aperio PINpad devices:
E100 wireless escutcheon and
AU100 wireless lock.

Use Cases

Emergency situations



Operation During Access Control Panel Breakdown

Aperio offers several smart credential handling options to enable access in case of a communications failure with the access control system.

Up to 1000 users can be granted access even if the Access Control Panel is temporarily down.

Aperio devices supporting this feature

The entire Aperio product family

Use Cases

Retail stores or warehouses,
medication storage rooms or
laboratories, server rooms or
equipment racks



Four Eyes Rule

The 'four eyes rule' is a practice that requires the presence of at least two authorized users with two different credentials each to unlock a door. It can be a combination of a card/phone + PIN or two cards/phones. The number of users and number/combination of credentials is configured by the EAC system.

Aperio devices supporting this feature

The entire Aperio product family

Use Cases

Sensitive or high-security environments
When access to critical areas, systems, or data must be reviewed and approved by a second authorized person.



Escape and Return

This feature allows a user to temporarily leave a secure area or room and then return without having to repeat the full authentication process. This feature is often implemented to provide convenience to authorized individuals who need to briefly exit and re-enter a restricted area without compromising security.

Aperio devices supporting this feature

E100 wireless escutcheon

Use Cases

Emergency situations,
short breaks



Electronic Privacy

Also known as 'Do Not Disturb', this feature restricts access to an area. When the electronic privacy button is pressed or enabled, it allows the user to restrict access into the area. When engaged, the EAC may still grant access to specific users.

Aperio devices supporting this feature

E100 wireless escutcheon
AU100 Series Escutcheon

Use Cases

Meeting rooms,
clothes changing rooms,
dorm rooms, accommodation
rooms

Everybody benefits from Aperio Wireless Access Control

Building access control impacts multiple stages and stakeholders

Business owners, security staff, and facility managers

have an extensive portfolio from which to select the optimal digital access solution that meets individual requirements, ensuring low energy consumption and minimal maintenance, plus optional services when needed.



OEMs, system integrators, and installers gain from our top-tier technologies for new installations or digital access upgrades, unparalleled standards expertise, and the broadest selection of wireless access hardware.



Users benefit from the convenience and safety provided by our digital access solutions every day, enhancing their experience in the building from installation through to daily use.



For architects and specifiers, integrating modern design aesthetics and green building practices is a key concern from the design phase. Aperio devices can help them achieve their goals.





Aperio AU100 Wireless Lock

Aperio AU100 Wireless Lock

Technical information

The cost-effective solution for doors with demanding access control requirements

The ASSA ABLOY Aperio AU100 is the most complete electronic wireless security lock on the market. It works with almost any system, via Online, Offline or OSS-standard offline integration.

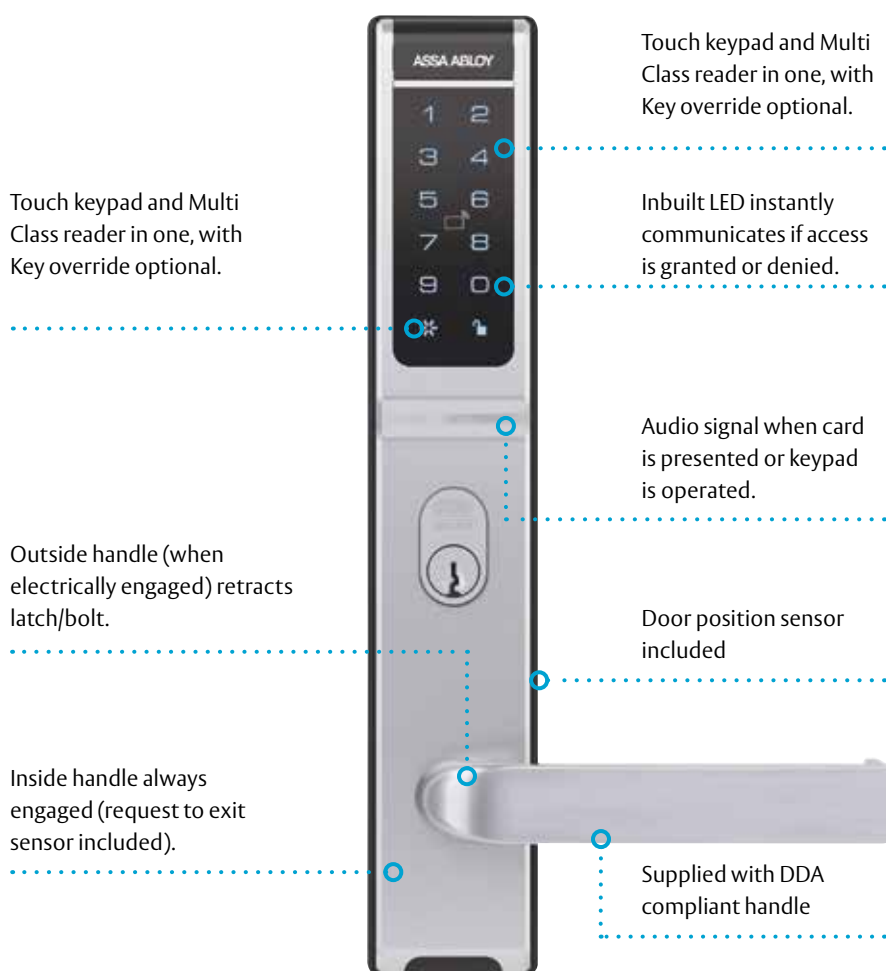

Versions:



AU100-530



AU100-3772



AU100-5782



Easy integration

Aperio AU100 works seamlessly with access control systems integrated with Aperio via the AADP protocol or Wiegand hub. No database integration required.



Highly effective safety and security protection

Rated IP55, D8, S8.



Multi-authentication

AU100 adds an extra layer of security to your opening with keypad functionality (only supported by Aperio Online)



Monitoring

Integrated sensors for door (open/closed); Handle status detection (request to exit).



Convenience

Aperio AU100 reads industry-leading RFID credentials, as well as mobile (NFC).

Aperio AU100 Wireless Lock

Technical information



Electronic Technical Information

Battery Type	4 x AA Alkaline
Battery Lifetime	>40,000 cycles
Radio Standard	IEEE802.15.4 (2.5GHz)
Encryption	AES128Bit
Wireless Range	5-25m depending on location of Hub & Environment
RFID Technologies (Based on reader type)	High Frequency Multiclass : iCLASS®/ISO 14443B; iCLASS® Seos; MIFARE™ Classic; MIFARE™ Plus; MIFARE™ DESFire™ EV1
RFID Reading	UID/sector/block
Card Range	>2cm
Operating Temperature	-20°C - 60°C
Humidity	<85% non condensing
Approvals	RCM CE
Finish	Brushed Satin Chrome Matt Black
Door Thickness	35-50mm
Mobile Access	BLE & NFC

Product Details

	AU100-530	AU100-3772	AU100-5782
Finish	SC	SC	SC
Backset	60mm	60mm	30mm
Lever	77A	77A	778A
Door Thickness	35-50mm	35-50mm	35-50mm
Body Material	Zinc Alloy	Zinc Alloy	Zinc Alloy
Override Cylinder	No	Yes	Yes
Lock Type	Tubular Latch 530	Suited for 3570 and 3770	Suited for 5580 and 5780
Door Application	Retrofit Latch	Timer door 60mm Backset	Metal or Aluminium narrow Style doors 30mm Backset

Standards and Compliance

	Successfully tested up to 2 hours on fire door assemblies in accordance with Australian Standard AS1905.1 2005 - Part 1: Fire Resistant Doorsets
SL8	(Security) Australian Lock Standard (AS4145.2:1993)
DL8	(Durability) Australian Lock Standard (AS4145.2:1993)
	Australian Electrical Regulatory Compliance
CE	European Electric Compliance

Aperio AU100 Wireless Lock

Technical information

The AU100 is available in a range of form factors including: the popular 530 latch option (non key override) and 60mm and 30mm backset variants.

You may also use the 530 version on a Mortice lockset and not use the override cylinder feature.



AU100-530

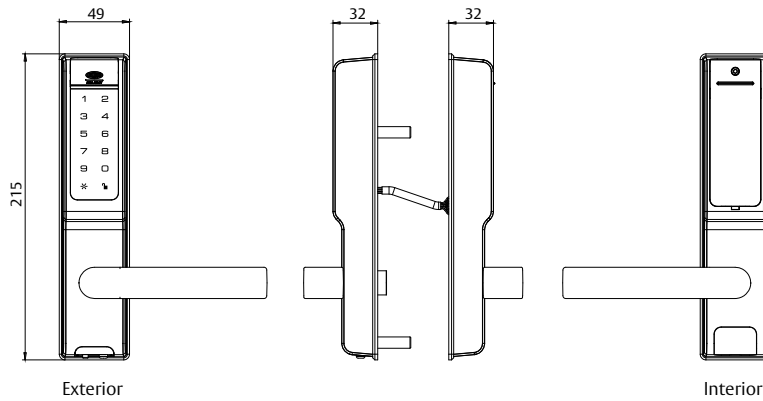

AU100-3772

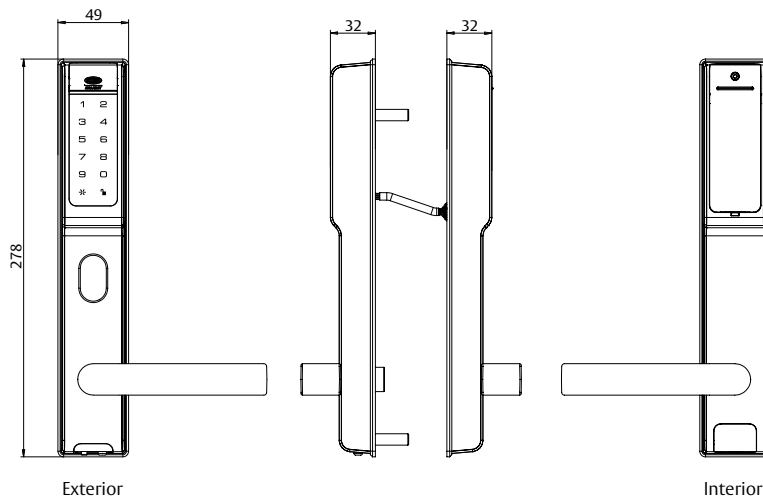

AU100-5782

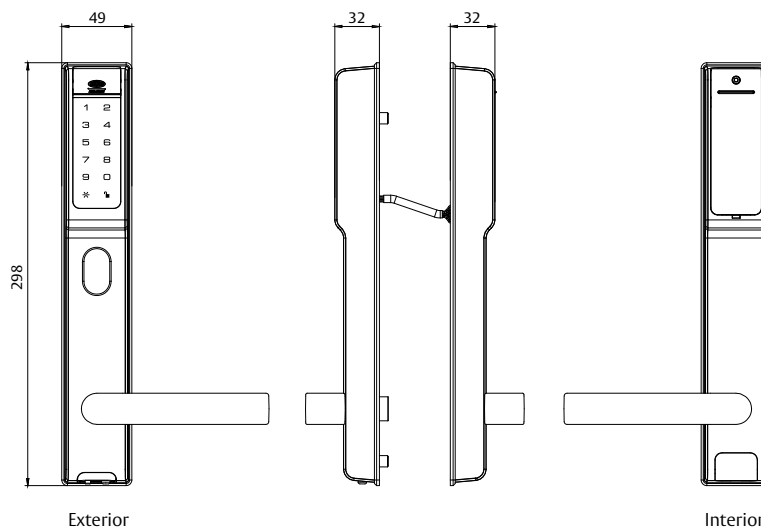

Aperio AU100 Wireless Lock

Ordering information

AU100 Escutcheons Only

Product Description	Part Number
Aperio AU100 V3 Keypad & Reader, Mobile Access, 530 Ver, 35-50mm Door, with 530 Latch, Satin Chrome	AU103BMU2SC1/1
Aperio AU100 V3 Keypad & Reader, Mobile Access, 530 Ver, 35-50mm Door, with 530 Latch, Matt Black	AU103BMU2MBK1/1
Aperio AU100 V3 Keypad & Reader, Mobile Access, 3772 Ver, 35-50mm Door, No Lock, Satin Chrome	AU103BMU2SC1/2
Aperio AU100 V3 Keypad & Reader, Mobile Access, 3772 Ver, 35-50mm Door, No Lock, Matt Black	AU103BMU2MBK1/2
Aperio AU100 V3 Keypad & Reader, Mobile Access, 3772 Ver, 35-50mm Door, with 3772 Mortice, Satin Chrome	AU103BMU2SC1/2/B
Aperio AU100 V3 Keypad & Reader, Mobile Access, 3772 Ver, 35-50mm Door, with 3772 Mortice, Matt Black	AU103BMU2MBK1/2/B
Aperio AU100 V3 Keypad & Reader, Mobile Access, 5782 Ver, 35-50mm Door, No Lock, Satin Chrome	AU103BMU2SC1/3
Aperio AU100 V3 Keypad & Reader, Mobile Access, 5782 Ver, 35-50mm Door, No Lock, Matt Black	AU103BMU2MBK1/3
Aperio AU100 V3 Keypad & Reader, Mobile Access, 5782 Ver, 35-50mm Door, with 5782 Mortice, Satin Chrome	AU103BMU2SC1/3/B
Aperio AU100 V3 Keypad & Reader, Mobile Access, 5782 Ver, 35-50mm Door, with 5782 Mortice, Matt Black	AU103BMU2MBK1/3/B

Accessories

Product Description	Part Number
Aperio Gen 5 Wireless Communications Hub 1:16 RS485	AH30-3-0
Aperio Gen 5 Wireless Communications Hub 1:64 TCP/IP	AH40-4-0
Aperio Hub Antenna Extension Cable – 152mm	500ZB-EXTANT-00



Aperio E100 Wireless Escutcheon

Aperio E100 Wireless Escutcheon

Technical information

Robust access control with customizable features

The ASSA ABLOY Aperio E100 is the most convenient way to upgrade access control: It is fitted without wiring at the door and works with almost any system, via Online, Offline* or OSS-standard offline integration.



Open with a smart card or mobile phone. The Keypad option offers multi-authentication for an extra layer of security*.

*Only supported by Aperio online

Main electronics (RFID + radio + BLE) outside, security electronics inside.

Audio signal when card is presented or keypad is operated.

Different handle models: U- and L- shapes.

Inbuilt LED instantly communicates if access is granted or denied.

Optional electronic privacy button.

Inside handle always engaged.

Internal handle use detection (request to exit).



Easy integration

Aperio E100 works seamlessly with access control systems integrated with Aperio via the AADP protocol or Wiegand hub. No database integration required.



Quick installation

No or minimal drilling. Interconnecting cable.



Flexibility

Can be used with Australian mortice locks – in wooden, steel and tubular-frame doors (and glass doors).



Convenience

Aperio E100 reads industry-leading RFID credentials, as well as mobile (NFC and BLE).



Privacy function (optional)

Electronic privacy button when pressed/enabled allows the user to restrict access into the area. When engaged, the EAC may still grant access to specific users.

Versions:



Standard

Keypad

Cutouts:



Cylinder

Blind

*Panel dependant

Aperio E100 Wireless Escutcheon

Technical information

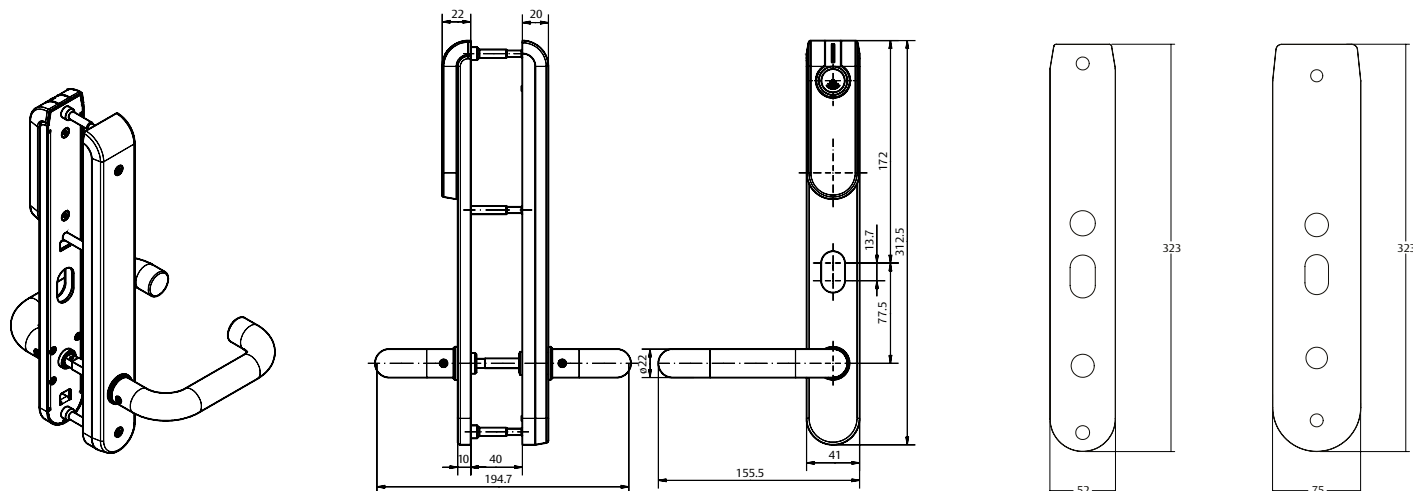

E100 cover plate

E100 Technical Information

Battery Type	1 x Lithium CR123A
Battery Life Time	>40,000 cycles
Radio Standard	IEEE 802.15.4 (2.4GHz)
Encryption	AES128 Bit
Wireless Range	5-25m depending on location of hub & environment
RFID Technology**	High Frequency Multiclass : iCLASS®/ ISO 14443B; iCLASS® Seos; MIFARE™ Classic; MIFARE™ Plus; MIFARE™ DESFire™ EV1
RFID Reading	UID / sector / block
Card Read Range	< 4cm
Operating Temperature	0°C – 60°C
Humidity	< 85% non condensating
IP-Degree	IP 52*
Approvals	CE and RCM
Colour	Brushed stainless steel
Override Cylinder	Lockwood Australian oval 570 series
Door Thickness	35mm to 85mm requires spindle to suit
Spindles	7.6mm
Backset	60mm
Mobile Access	BLE & NFC

Aperio E100 Wireless Escutcheon

Ordering information

Ordering Information

Product Description	Part Number
Aperio E100 V3 Escutcheon 35-45mm Door, MultiClass, Mobile Access	E103MUB1SS1
Aperio E100 V3 Escutcheon 35-45mm Door, MultiClass, Mobile Access + 3772 Mortice Lock	E103MUB1SS1/3772
Aperio E100 V3 Escutcheon 46-55mm Door, MultiClass, Mobile Access	E103MUB1SS2
Aperio E100 V3 Escutcheon 46-55mm Door, MultiClass, Mobile Access + 3772 Mortice Lock	E103MUB1SS2/3772
Aperio E100 V3 Escutcheon 56-65mm Door, MultiClass, Mobile Access	E103MUB1SS3
Aperio E100 V3 Escutcheon 56-65mm Door, MultiClass, Mobile Access + 3772 Mortice Lock	E103MUB1SS3/3772

Accessories

Product Description	Part Number
Aperio E100 Face Plate, No Key Override	E103NOKO
Aperio E100 Cover Plate, One Pair (each plate is 1.2mm thick, allow in the Spindle Length)	E100-PL2SSS
Aperio Gen 5 Wireless Communications Hub, 1:16, RS485	AH30-3-0
Spindle change tool	500ZB-S-TOOL
Aperio Gen 5 Wireless Communications Hub, 1:64, TCP/IP	AH40-4-0

Spare Parts

Product Description	Part Number
Aperio Spindle Kit 35-45mm	E-SP35/45
Aperio Spindle Kit 45-55mm	E-SP45/55

Notes:

- E100 cover plate is used only if required when retro fitting existing door furniture.
- Each cover plate is 1.2mm thick. A total of 2.4mm should be added to door thickness if using these plates
- To change the spindle; special tools may be required



Aperio H100 Wireless Handle

Aperio H100 Wireless Handle

Technical information

Powerful access control inside an award-winning slimline door handle

The ASSA ABLOY Aperio H100 is the easy, aesthetically pleasing way to upgrade access control: It is fitted without wiring or drilling at the door and works with almost any system, via Online, Offline* or OSS-standard offline integration.

Inbuilt LED instantly communicates if access is granted or denied.

Discreet handle with minimal footprint and contemporary design.



U-handle adapter available as an accessory.



Inside handle always engaged.

All electronics and functionality are inside the outer part of the handle.



Finishes:

Satin Pearl or Matt Black



*Panel dependant



Easy integration

Aperio H100 works seamlessly with access control systems integrated with Aperio via the AADP protocol or Wiegand hub. No database integration required.



Quick installation

It takes a few minutes to swap a mechanical handle for an Aperio H100.



Flexibility

Can be used with the most common Scandinavian and Finnish mortise locks – in wooden, steel, and tubular frame doors (and glass doors with standard lock cases).



Convenience

Aperio H100 reads industry-leading RFID credentials, as well as mobile (NFC and BLE).

Aperio H100 Wireless Escutcheon

Technical information

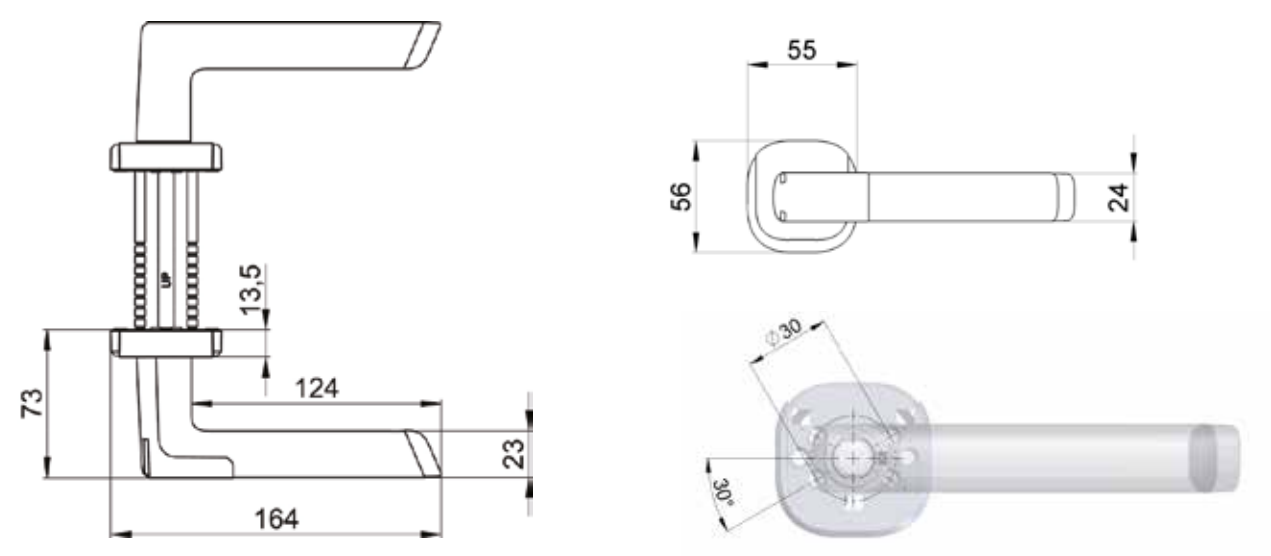

H100 Technical Information

Battery type	1 x Lithium CR123A
Battery lifetime	>40,000 cycles High Frequency Multiclass: 30 openings per day for 50 months
Radio standard	IEEE 802.15.4 (2.4 GHz)
Encryption (radio communication)	AES 128 bits
Distance between the RFID Reader and hub	Up to 25m depending on the building environment
RFID technologies (Based on reader type)	High Frequency Multiclass : iCLASS®/ ISO 14443B; iCLASS® Seos; MIFARE™ Classic; MIFARE™ Plus; MIFARE™ DESFire™ EV1
RFID reading	UID / Sector / Block / Application / File
RFID reading range	< 4cm
Class of protection	IP42
Operating temperature	0°C to 55°C
Relative humidity	< 85% (condensation-free)
IP-degree	IP 65
Authentication	One level of authentication - CARD only
Status	LED (red/green/orange)
Communication interfaces	Communication via radio (USB dongle) or USB type B adapter (accessory)
Offline and Online operation modes	Aperio® Online; Aperio® Offline; Aperio® Standard OSS Offline
Approvals	CE, EN1906: 26-B010B RCM
Mobile Access	BLE & NFC

Aperio H100 Wireless Escutcheon

Ordering information

Ordering Information

Product Description	Part Number
Aperio H100 Handle, Right, 8mm Spindle, Satin Pearl, Mobile Access	H100B8R-SC-AU
Aperio H100 Handle, Right, 8mm Spindle, Matt Black, Mobile Access	H100B8R-MBK-AU
Aperio H100 Handle, Right, 8mm Spindle, Satin Pearl, Mobile Access with 3772 Mortice Lock	H100B8R-SC-AU-B
Aperio H100 Handle, Right, 8mm Spindle, Satin Pearl, Mobile Access with 3773 Sliding Door Mortice Lock - Timber	H100B8R-SC-AU-SB
Aperio H100 Handle, Left, 8mm Spindle, Satin Pearl, Mobile Access	H100B8L-SC-AU
Aperio H100 Handle, Left, 8mm Spindle, Matt Black, Mobile Access	H100B8L-MBK-AU
Aperio H100 Handle, Left, 8mm Spindle, Satin Pearl, Mobile Access with 3772 Mortice Lock	H100B8L-SC-AU-B
Aperio H100 Handle, Left, 8mm Spindle, Satin Pearl, Mobile Access with 3773 Sliding Door Mortice Lock - Timber	H100B8L-SC-AU-SB

Accessories

Product Description	Part Number
Aperio USB Firmware Adaptor for use in Battery Compartment	AH100-010
H100 Distance Ring for inner doors thinner than 35mm	AH100-020
U-Handle or RTD Adapter (set of 2 - Battery Holder End Cap & Dummy End Cap) - Satin Pearl	AH100-002
H100 DDA Grip for Disability Access	AH100-005
Kit comprising AH100-001 'U-Handle' Satin Chrome & AH100-005 DDA Grip	AH100-006
Kit comprising AH100-001 'U-Handle' Satin Pearl & AH100-005 DDA Grip	AH100-106
H100 530 Latch 8mm plus Adaption Plate - Large, 60mm Backset	AH100-086
H100 530 Latch 8mm plus Adaption Plate - Large, 70mm Backset	AH100-096
H100 Cylinder Escutcheon - Matt Black	AH100-072
H100 Cylinder Escutcheon - Satin Pearl	AH100-071
Aperio Hub 1:16 RS485 Hub	AH30-3-0
Aperio 1:64 IP (Ethernet) Hub	AH40-4-0



Aperio C100 Wireless Cylinder

Aperio C100 Wireless Cylinder

Technical information

The non-disruptive way to extend access control

The ASSA ABLOY Aperio C100 is the quickest way to upgrade access control: It is fitted without wiring or drilling at the door and works with almost any system, via Online, Offline* or OSS-standard offline integration.

Metal single knob cylinder
Australian profile – for use in
indoors.

Main electronics (RFID + radio)
in the external knob – secure
electronics inside cylinder core.

Freely rotating lock cam.

Inbuilt LED instantly
communicates if access
is granted or denied.



Real time access control

Users enjoy real-time access control, meaning credentials can be updated instantly without physical rekeying.



Quick installation

Quick and non-invasive installation, minimizing disruption and downtime



Seamless entry

The C100 supports mobile and card-based access, offering a seamless and modern entry experience.



Convenience

Its battery-powered operation ensures reliability even during power outages, and the visual LED indicators provide clear feedback on door status, improving user confidence and ease of use.



*Panel dependant

Aperio C100 Wireless Single Knob Cylinder

Technical information

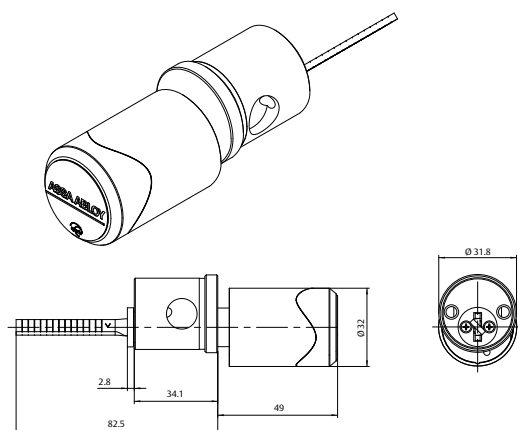
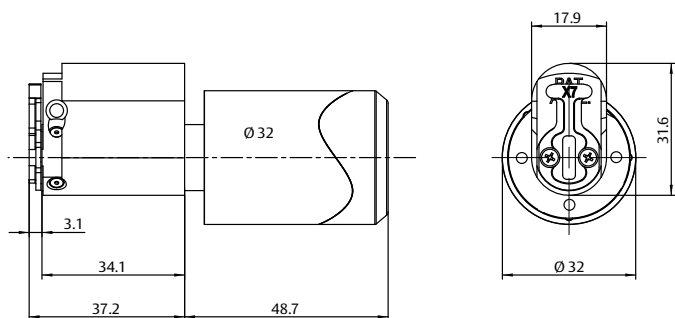

C100 201 Cylinder

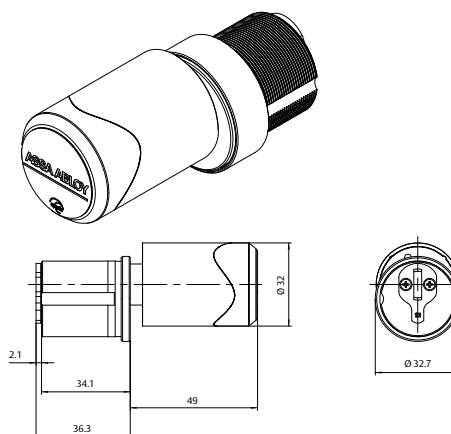

C100 Kawneer Cylinder

C100 Technical Information

Battery type	1 x Lithium CR2
Battery lifetime	<30,000 cycles (max 2 years)
Radio standard	IEEE 802.15.4 (2.4GHz)
Encryption	AES 128 Bit
Wireless range: Cylinder to Hub	5-25m depending on location of Hub & environment
RFID technology**	MIFARE Classic®, MIFARE Ultralight®, MIFARE® DESFire®, MIFARE Plus®, MIFARE® SE, MIFARE® DESFire® SE; iCLASS SE; iCLASS Seos®, iCLASS Seos Elite
RFID reading	UID / Sector / Block / Application / File
Card reading range	< 4cm
Operating temperature	-20° to +55°C
Knob colour	Black / Satin Chrome
Cylinder Colour	Satin Chrome
Cylinder format	Lockwood Australian oval 570 series
Door thickness	Suits standard doors up to 50mm
Approvals	CE,RCM and R-NZ
Status	LED (red/green/orange)
Mobile Access	BLE & NFC

Aperio C100 Wireless Single Knob Cylinder

Ordering information

Ordering Information

Product Description	Part Number
Aperio C100 V3 Cylinder, with Mobile Access (BLE), to suit Lockwood 570 series cylinder	C103BHFASS
Aperio C100 V3 Cylinder, with Mobile Access (BLE), to suit Lockwood 201 series cylinder	C103BHF201SS
Aperio C100 V3 Cylinder, with Mobile Access (BLE), to suit Lockwood 8466 Kawneer cylinder	C103BHFKAWSS

Accessories

Product Description	Part Number
Aperio Hub 1:16 RS485 Hub	AH30-3-0
AH40 Aperio 1:64 IP (Ethernet) Hub	AH40-4-0



Aperio ES100 Wireless Reader & Integrated Strike

Aperio ES100 Series Wireless Electric Strikes

Technical information

The The ES100 Series Wireless Electric Strikes make online access control simple and affordable.

2.4 GHz Aperio wireless technology

Integrates with existing access control systems and credentials

Audit trail limited by access control system

SecuriCare three-year, no-fault, no questions asked warranty



Flexibility

Universal compatibility with traditional electromechanical locking devices



Easy integration

Aperio ES100 works seamlessly with access control systems integrated to Aperio via AADP protocol or the Wiegand hub. No database integration required.



Easy installation

Easy surface-mounted, no-cut installation



Convenience

Aperio ES100 reads industry-leading RFID credentials, as well as mobile (NFC and BLE).

Aperio ES100 Series Wireless Electric Strikes

Technical information

ES100 Technical Information

Certifications	UL 294 listed; FCC Part 15 & Industry Canada Compliant; CE Red – Radio Equipment Directive – 2014/53/EU; UL 1034 burglary-resistant; UL 10C fire rated, 3-hour single door (fail secure only); UL 10C fire rated, 1-1/2 hour double door (fail secure only); CAN/ULC-S2014 fire door conformant; NFPA-252 fire door conformant; ASTM-E152 fire door compliant; California Fire Marshall listed; ANSI/SDI A250.13 windstorm resistant; Florida Building Code approved TAS 201, 202, 203; ANSI-ASTM E330; RoHS compliant
Frame Application	Metal, Wood
Electrical	Estimated Battery Life: 45,000 Cycles* (2) “AA” lithium batteries (included) » AA LR6 (1.5 V) Lithium Ion Batteries required. Use of other types of batteries, such as alkaline, will significantly decrease battery life. MicroUSB port for emergency power
Environmental	Electric Strike Operating Temperature -25° to 60° C Operating Humidity 0 to 90% relative humidity non-condensing Card Reader Operating Temperature -10° to 60° C Operating Humidity 0 to 90% relative humidity non-condensing Tested to IP65
Card Technology HID® multiCLASS SE®	Electric Strike Operating Temperature -25° to 60° C Operating Humidity 0 to 90% relative humidity non-condensing Card Reader Operating Temperature -10° to 60° C Operating Humidity 0 to 90% relative humidity non-condensing Tested to IP65
Card Technology HID® multiCLASS SE®	High Frequency (13.56 MHz): HID iCLASS®; HID iCLASS SE® (SIO®-enabled); HID iCLASS® Seos®; HID MIFARE® SE; HID DESFire® EV1 SE; MIFARE CLASSIC; DESFire® EV1; DESFire® EV2 (legacy mode) Low Frequency (125 kHz): HID Prox®; AWID; EM4102; IOProx Mobile Access Credentials: NFC; HID BLE Mobile Access ; SEOS iOS Apple Wallet
Approvals	RCM and R-NZ

Aperio ES100 Series Wireless Electric Strikes

Ordering information

Accessories

Product Description	Part Number
Aperio Wireless Electric Strike & Reader, Suits Latch Bolts, Monitoring, BLE, SS	ES100-15LM-BIPS-630
Torx screws	157
Metal template kit	HESCU-MTK
Spring replacement kit	OPT-15RK
Single lock monitor	OPT-1LM
Aperio® Hub External Antenna (Omni-directional)	500ZB-EXTANT-00
Aperio Radio Dongle*	APRD1/PAP1
Lip extension trim adapter	APD10USB

For use with 1500 models (XXX – finished to match)

Product Description	Part Number
Lip extension trim adapter	1500-104-XXX
4500 adapter and trim enhancer kit	1500-106-XXX

For use with 1600 models* (XXX – finished to match)

Product Description	Part Number
Lip extension trim adapter	1600-104-XXX
1006 adapter and trim enhancer kit	1600-106-XXX

*Note: The 1600 strike is not available in Australia & New Zealand

Aperio ES100 Series Wireless Electric Strikes

Technical information

ES100-15 Dimensions

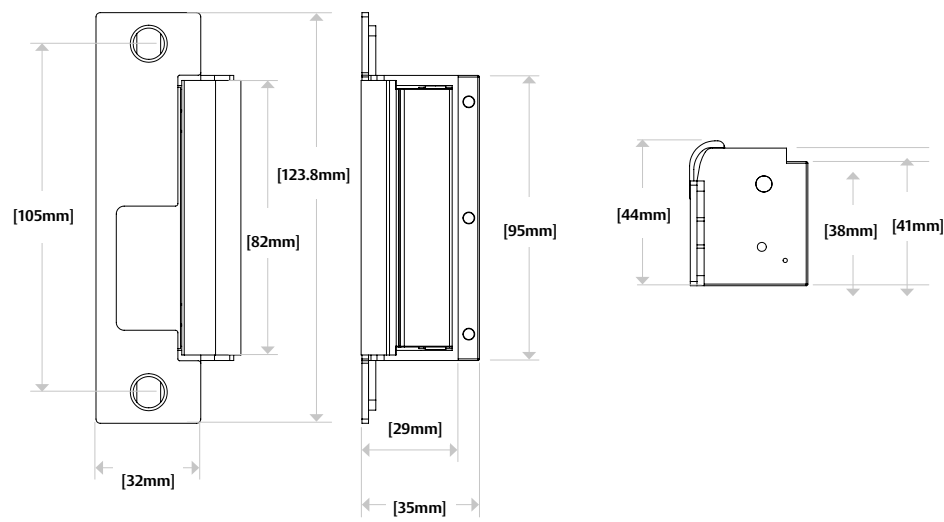

ES100-16* Dimensions

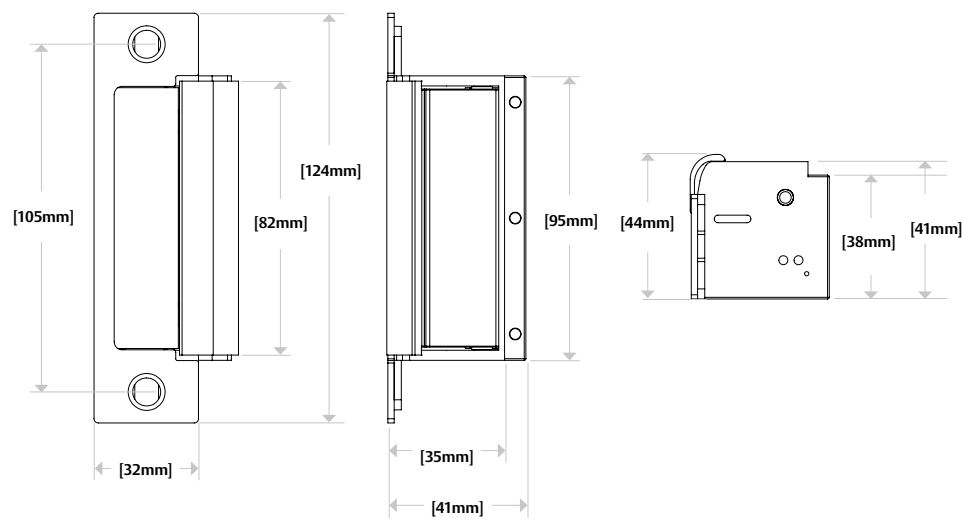

ES100 Reader Dimensions

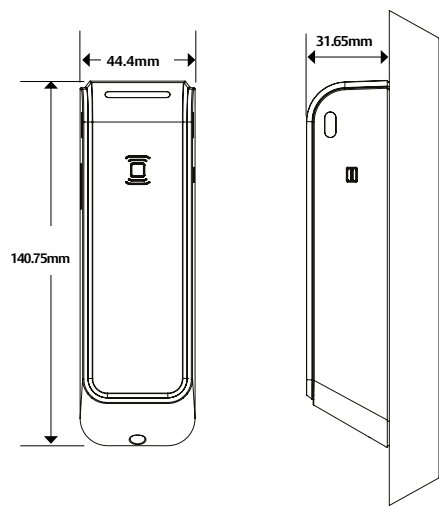



Aperio DR100 Wireless Reader with Relay

Aperio DR100 Wireless Wall Reader with Relays

Technical information

Robust access management for high traffic doors

The ASSA ABLOY Aperio DR100 is the quickest way to upgrade access control: It works with almost any system, via Online, Offline or OSS-standard offline integration.



Flexibility

Universal compatibility with traditional electromechanical locking devices



Easy integration

Aperio DR100 works seamlessly with access control systems integrated to Aperio via AADP protocol or the Wiegand hub. No database integration required.



Easy installation

Easy surface-mounted, no-cut installation



Convenience

Aperio DR100 reads industry-leading RFID credentials, as well as mobile (NFC and BLE).

Aperio DR100 Wireless Wall Reader with Relays

Technical information

DR100 Technical Information

Authentication	CARD/Mobile
RFID technologies (based on reader type)	iCLASS, iCLASS SE, iCLASS Seos, MIFARE Classic, Mifare Classic SE, Mifare Ultralight, Mifare Plus, Mifare DESFire 0.6, Mifare DESFire EV1, Mifare DESFire EV2, Mifare DESFire EV3 (EV2 and EV3 only in Legacy mode), Mifare DESFire SE, PicoPass, ISO 14443A UID, ISO 14443B UID, ISO 15693 UID
RFID reading	UID / Sector / Block / Application / File Segment Data – Depending on the RFID technology
RFID reading range	Up to 4 cm
Mobile technologies	Seos, STid and Gallagher-enabled mobile credentials via BLE and NFC Seos and DESFire mobile credentials in Apple Wallet and Google Wallet
Approvals	CE, UKCA, RCM and R-NZ
Dimensions	Reader: 140,8 x 45,5 x 32,5 mm (H x W x D) Relay: 150,8 x 45,5 x 27,5 mm (H x W x D)
Surface	UV resistant ABS plastic
Door leaf thickness	Up to 355,6 mm (14")
Battery	Hard-powered: 12-24 VDC
Radio standard	IEEE 802.15.4 (2.4 GHz)
Encryption (radio communication)	AES 128 bits
Distance between device and hub	Up to 25m depending on the building environment
Class of protection	IP 65 makes it durable and appropriate for outdoor use
Operating temperature range	-10°C to 60° C
Relative humidity	93 % RH at 32° C
Status	LED (red/green/orange)
Door sensor information	Tamper detection Doors position (open/closed) Request to exit input
Communication interfaces	Communication via radio (USB dongle) or micro-USB cable (accessory)
Offline and Online operation modes	Aperio Online; Aperio Offline; OSS-standard Offline

Aperio DR100 Wireless Wall Reader with Relays

Technical information

Dimensions

Wall reader (outside)

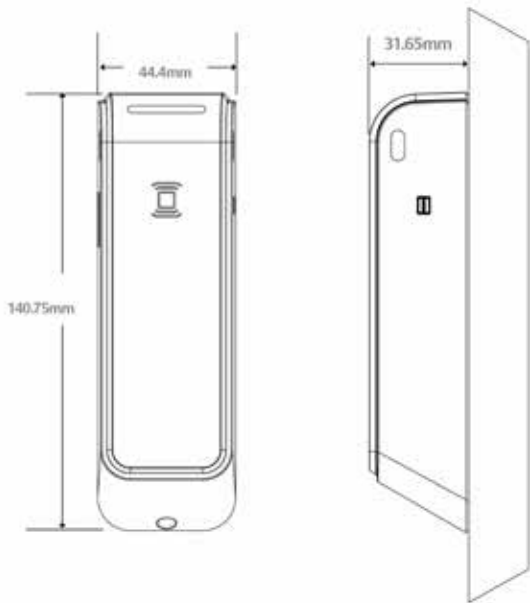

Relay board (inside)

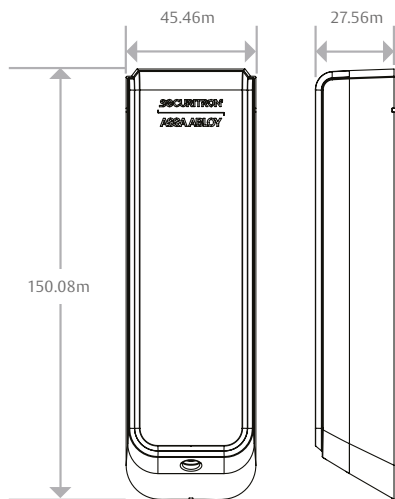

Aperio DR100 Wireless Wall Reader with Relays

Ordering information

Article code	Description
DR100C-BIPSXXXX-EU	Aperio V3 Wall Reader with Relays IP65



Aperio KL100 Wireless Locker/Cabinet Lock

Aperio KL100 Wireless Locker/Cabinet Lock

Technical information

Wireless protection for your lockers and cabinets

The ASSA ABLOY Aperio KL100 is the easiest way to upgrade access control at many openings beyond doors.

It is fitted without wiring or drilling the cabinet door and works with almost any system, via Online, Offline or OSS-standard offline integration.

Battery, located inside the door, is easy to replace in seconds with a single screw.

Discreet, with a minimal visual footprint and contemporary design.

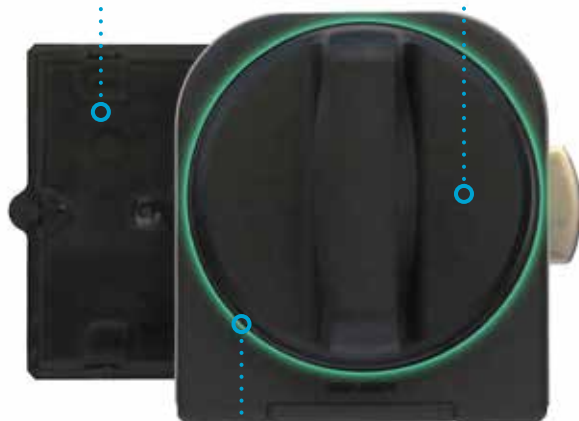

Inbuilt LED instantly communicates if access is granted or denied.

Four locking positions for both cabinets and drawers.

Four lock versions available to fit metal and wooden doors.

Several cams available.

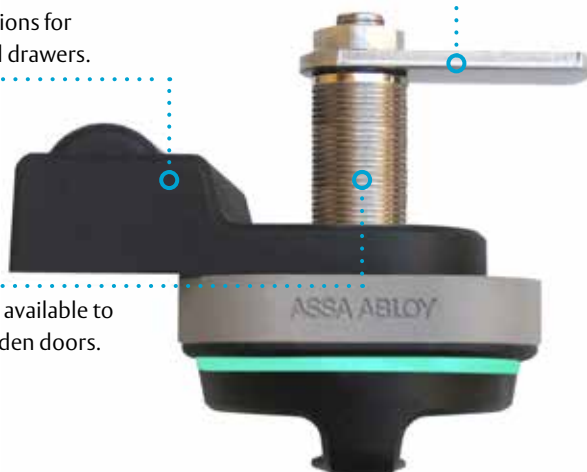

Easy integration

Aperio KL100 works seamlessly with access control systems integrated with Aperio via the AADP protocol or Wiegand hub. No database integration required.



Quick installation

It only takes a few minutes to swap a mechanical cylinder for an Aperio KL100.



Flexibility

Ideal for retrofit projects, KL100 allows you to tailor your solution with a wide range of cam types.

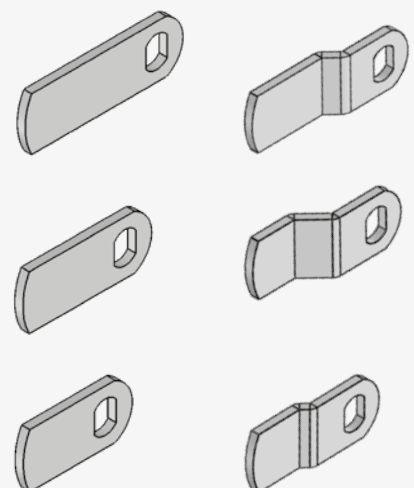

Aperio KL100 Wireless Locker / Cabinet lock

Technical information

Specifications

Battery Type	1 x Lithium CR123A
Battery Lifetime	25 openings per day for 106 months
Emergency Power	Via micro-USB socket
Environment:	0 to 55 Degrees Celsius
Status Indication	Red/Green/Yellow LED
Operating Modes	Aperio Online, Aperio Offline, Standard OSS Offline
Radio Standard	IEEE 802.15.4 (2.4GHz)
Encryption	AES 128 bits
RFID Technologies	iCLASS, iCLASS SE, iCLASS Seos, MIFARE Classic, Mifare Classic SE, Mifare Ultralight, Mifare Plus, Mifare DESFire 0.6, Mifare DESFire EV1, Mifare DESFire EV2, Mifare DESFire EV3 (EV2 and EV3 only in Legacy mode), Mifare DESFire SE, PicoPass, ISO 14443A UID, ISO 14443B UID, ISO 15693 UID
RFID Reading	UID / Sector / Block / Application / File / Depending on the RFID technology
Approvals	CE, UKCA, RCM, R-NZ
RFID Read range:	Up to 4cm
Dimensions	Front: 57W x 63Hmm x 31D

Dimensions in mm

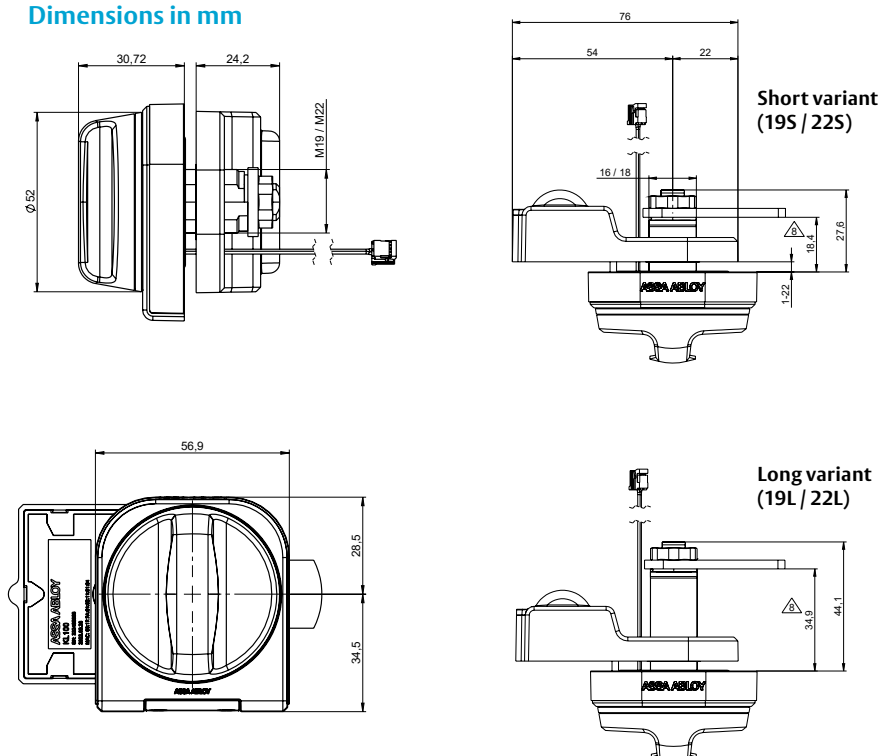

Drilling dimensions

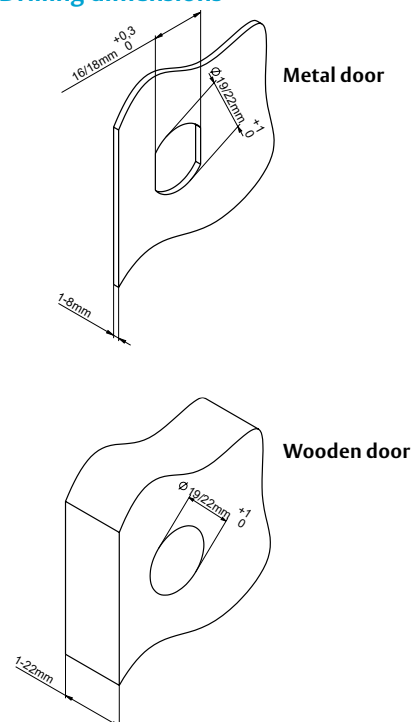

Aperio KL100 Wireless Locker / Cabinet lock

Ordering information

Ordering Information

Product Description	Part Number
ASSA ABLOY Aperio KL100 Cabinet Lock, Long, 19mm Diameter	KL100-19L
ASSA ABLOY Aperio KL100 Cabinet Lock, Short, 19mm Diameter	KL100-19S
ASSA ABLOY Aperio KL100 Cabinet Lock, Long, 22mm Diameter	KL100-22L
ASSA ABLOY Aperio KL100 Cabinet Lock, Short, 22mm Diameter	KL100-22S

Accessories

Product Description	Part Number
ASSA ABLOY Aperio KL100 Backing Plate, 19mm (10 pieces)	AKL100-10
ASSA ABLOY Aperio KL100 Backing Plate, 22mm (10 pieces)	AKL100-11
ASSA ABLOY Aperio KL100 CAM, Straight, 05 A38 D0 (10 pieces)	AKL100-20
ASSA ABLOY Aperio KL100 CAM, Straight, 17 A30 5 D0 (10 pieces)	AKL100-21
ASSA ABLOY Aperio KL100 CAM, Offset, 86 A49 B5 D0 (10 pieces)	AKL100-22
ASSA ABLOY Aperio KL100 CAM, Offset, 76 A41 B8 5 D0 (10 pieces)	AKL100-23
ASSA ABLOY Aperio KL100 CAM, Offset, 109 A38 B3 D0 (10 pieces)	AKL100-24
ASSA ABLOY Aperio KL100 CAM, Straight, 71 A50 D0 (10 pieces)	AKL100-25
ASSA ABLOY Aperio KL100 Plastic Rose Assembly	AKL100-30
ASSA ABLOY Aperio KL100 Battery Holder Assembly	AKL100-31
ASSA ABLOY Aperio KL100 Back Cover	AKL100-32
ASSA ABLOY Aperio KL100 USB Cover Assembly	AKL100-33
ASSA ABLOY Aperio KL100 Turn Stop Washer	AKL100-40
ASSA ABLOY Aperio KL100 Screw 2.5 x 8mm	AKL100-41
ASSA ABLOY Aperio KL100 Insert	AKL100-42
ASSA ABLOY Aperio KL100 Nut M11 x 1	AKL100-43
ASSA ABLOY Aperio KL100 Nut M22 x 1	AKL100-44
ASSA ABLOY Aperio KL100 Nut M19 x 1	AKL100-45



Aperio P100 Wireless Padlock

Aperio P100 Wireless Padlock

Technical information

Convenient and flexible protection for sensitive indoor and outside areas

The ASSA ABLOY Aperio P100 is the quickest way to upgrade access control: It is fitted without wiring or drilling and works with almost any system, via Online, Offline or OSS-standard offline integration.



Flexibility

P100 protects fences, gates, storage cages, racks, containers, tool cabinets and other non-standard openings.



Easy integration

Aperio P100 works seamlessly with access control systems integrated with Aperio via the AAPD protocol or Wiegand hub. No database integration required.



Easy installation

It takes seconds to swap a mechanical padlock for an Aperio P100.



Convenience

Aperio P100 reads industry-leading RFID credentials, as well as mobile (NFC and BLE).

Aperio P100 Wireless Padlock

Technical information

P100 Technical Information

Battery type	1 x Lithium CR2
Battery lifetime	<30,000 cycles (max 2 years)
Radio standard	IEEE 802.15.4 (2.4GHz)
Encryption	AES 128 Bit
Wireless range: Cylinder to Hub	5-25m depending on location of Hub & environment
RFID technology**	MIFARE Classic®, MIFARE Ultralight®, MIFARE® DESFire®, MIFARE Plus®, MIFARE® SE, MIFARE® DESFire® SE; iCLASS SE; iCLASS Seos®, iCLASS Seos Elite
RFID reading	UID / Sector / Block / Application / File
Card reading range	< 4cm
Operating temperature	-20° to +55°C
IP-degree	IP 66
Case Colour	Black
Approvals	CE and RCM

Dimensions in mm

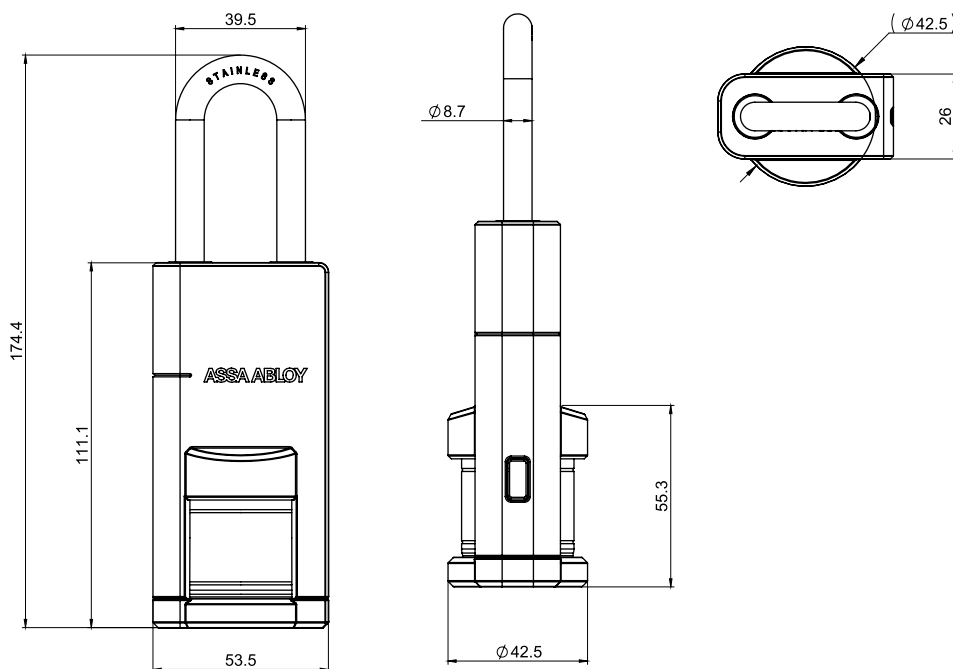

Aperio P100 Wireless padlock

Ordering information

Ordering Information

Product Description	Part Number
Aperio P100 V3, Padlock with Mobile Access (BLE), IP66	P100B-100
Aperio P100 V3 Padlock, with chain and clamp and Mobile Access (BLE), IP66	P100B-200

Accessories

Product Description	Part Number
Aperio Hub 1:16 RS485 Hub	AH30-3-0
AH40 Aperio 1:64 IP (Ethernet) Hub	AH40-4-0



Aperio Communication Hub

Aperio Communication Hub

Technical information

Communication happens in real time

Control up to 64* doors with Aperio communication hubs for indoor use. Easy and cost-effective to install, the hub is the nexus between Aperio devices and the EAC system.

Communication between hubs and Aperio devices happens in real time. Encrypted radio communication.

Integrated antenna with the option to mount an external antenna.

The hubs are easy and cost-effective to install.

Built-in tamper switch. Detection of removal from bracket.

The range of transmission to Aperio devices is up to 25 m.

Event Log in the hub.

For standard electrical installation boxes with 60mm fixing screw distance. They fit in standard flush-mounted boxes.

The user receives a quick overview of the status of the hub and locks connected via an LED signal pattern (communication, activation, status, etc).

Firmware upgrade possibilities.



AH40 Gen5 Communication Hub

- For connection to EAC system
- TCP/IP communication encrypted using TLS 1.1/1.2
- Control up to 64 locks
- PoE (Power over Ethernet) or external power supply

AH30 Gen5 Communication Hub

- Connection to the EAC system via RS485 bus (addressable)
- Control up to 16 locks

AH20 Standard Wiegand Gen5 Communication Hub

- 1-to-1 communication
- For connection to EAC system via Wiegand interface
- Compatible with most access control systems – no protocol integration needed

AH20 Advanced Wiegand Gen5 Communication Hub

- 1-to-1 communication
- For connection to EAC system via Wiegand interface
- Compatible with most access control systems – no protocol integration needed
- Four specific function relay outputs: These relay outputs can be connected to the controller.

*Panel dependant

Aperio Communication Hub

Technical information

Communication Hub Technical

Hub Version	Interface	Max. No. of Locks
AH20	Advanced Weigand	1
AH30	RS-485	16
AH40	IP (Ethernet)	64

Dimensions in mm

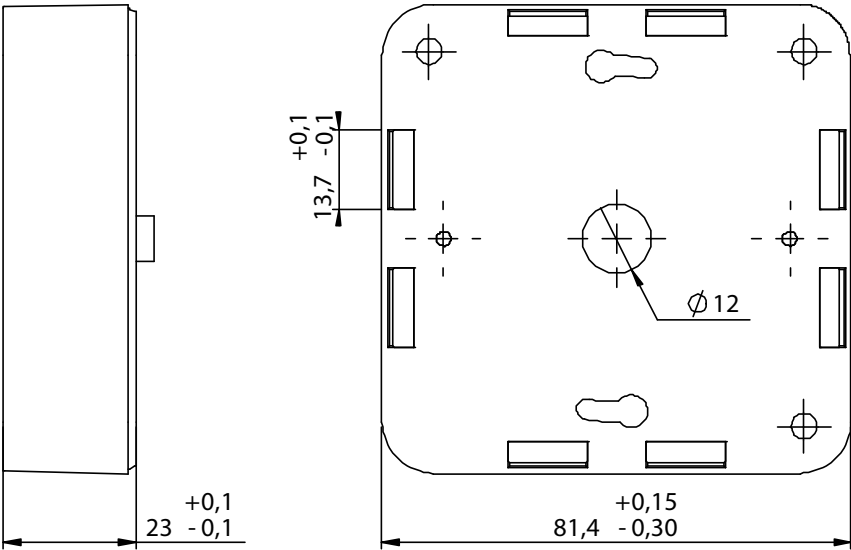

Aperio Communication Hub

Ordering information

Ordering Information

Product Description	Part Number
AH20 Aperio 1:1 Advance Wiegand Hub	AH20-2-0
AH30 Aperio 1:16 RS485 Hub	AH30-3-0
AH40 Aperio 1:64 IP(Ethernet) Hub	AH40-4-0
Aperio® Hub External Antenna (Omni-directional)	500ZB-EXTANT-00

Notes

This image shows a single sheet of white paper with horizontal ruling lines. The lines are evenly spaced and run across the width of the page. There are no margins, text, or other markings on the paper.

Notes

This image shows a single sheet of white paper with horizontal ruling lines. The lines are evenly spaced and run across the width of the page. There are no margins, text, or other markings on the paper.

The ASSA ABLOY Group is the global leader in access solutions. Every day, we help billions of people experience a more open world.

ASSA ABLOY
Opening Solutions

ASSA ABLOY Opening Solutions leads the development within door openings and products for access solutions in homes, businesses and institutions. Our offering includes doors, door and window hardware, locks, access control and service.

Head Office

ASSA ABLOY Australia Pty Limited
235 Huntingdale Road
Oakleigh Victoria 3166
Australia
+61 1300 562 587

assaabloy.com/au

Disclaimer

Whilst every effort has been made to ensure that the information (including product images and drawings) contained in this brochure is accurate at the time of publication, ASSA ABLOY Australia Pty Limited ("ASSA ABLOY") recommends that you consult ASSA ABLOY or its agents prior to placing an order to ascertain current information on specific products, as ASSA ABLOY reserves the right to make changes without notice. ASSA ABLOY will not be liable for any injury, loss or damage whatsoever, arising from any errors or omissions in the information contained in the brochure or arising from the use or application of the information contained herein. © 2025 copyright by ASSA ABLOY All rights reserved