



## Panic Exit Device

**ASSA ABLOY**

The global leader in  
door opening solutions

# ASSA ABLOY Panic Exit Device

## Features & Benefits

### *Panic Exit Devices AAED400 Series*

#### *Key features:*

- Surface mounted, rim type
- Slim, neat design
- 500,000 cycles tested
- Fire rated for 3 hours

#### *Benefits:*

- Ease of installation
- Superior aesthetics
- High durability
- Suitable for fire rated doors
- External cylinder and lever option available

### *Standard & Certification*

*UL 10C and ANSI  
A156.3 Grade 1*

#### *Technical details:*

- Rim type push bar
- Half length, 1045mm as standard
- 304 stainless steel material
- For doors up to 1200 x 2400mm in standard
- Easy installation and adjustment
- Stainless steel or galvanized steel finish
- Compatible accessories
- Standard euro profile cylinder
- UL listed for fire exit hardware up to 3 hours
- Suitable for single leaf and double leaf doors
- With satin chrome external lever trim



# Panic Exit Device - AAED400 Series

ASSA ABLOY

## Panic Exit Device AAED401

### ASSA ABLOY Exit Device 401:

- Panic exit device with central locking point - RIM
- Painted galvanized steel or stainless steel finish
- With AAET411SC external lever trim in satin chrome finish

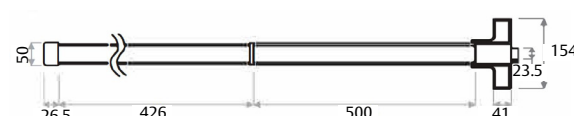

## Panic Exit Device AAED402

### ASSA ABLOY Exit Device 402:

- Panic exit device with double locking points - RIM
- For standard door height 2400mm\*
- Option available for 3000mm door height\*
- Painted galvanized steel or stainless steel finish
- With AAET411SC external lever trim in satin chrome finish

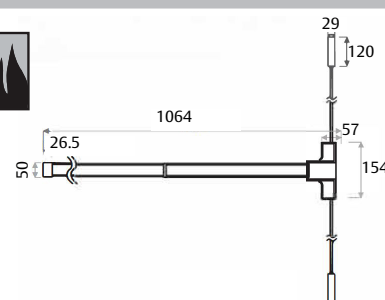
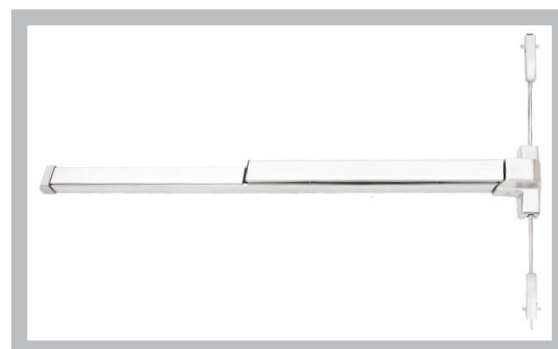

## Panic Exit Trim AAET411SC

### ASSA ABLOY Panic Exit Trim 411:

- Panic exit trim in satin chrome finish

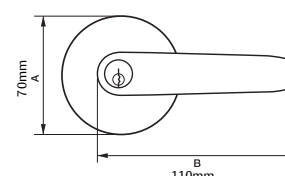

## How to Order

### Code example

AAED401P 2400

#### Finish Code

S - Stainless Steel  
P - Painted

#### Door height

2400 - 2400mm  
3000 - 3000mm

#### Locking Code

1 = Single-point locking  
2 = Double-point locking

# ASSA ABLOY Exit Device

## Features & Benefits

### Exit Devices AA21 Series

#### Key features:

- Surface mounted
- Slim, neat design, surface mounted
- 500,000 cycles tested
- Fire rated
- Wide range of option
- ANSI/BHMA A156.3 Grade 1
- UL Listed

#### Benefits:

- Ease of installation
- Superior aesthetics
- High durability
- Suitable for fire rated doors
- Provide a ready means of escape at all times by the single action of pushing on a horizontal bar fitted across the full width of a door

### Standard & Certification

UL 10C and ANSI  
A156.3 Grade 1

#### Technical details:

##### Door Suitability

- For emergency passage doors and anti-fire doors
- Suitable for single and double doors up to 1220mm wide and 2100mm in height (available up to 3000mm upon request)

##### Material

- Horizontal push bar made of 304 stainless steel
- Latchbolt made of sintering stainless and auxiliary bolt made of die-cast stainless steel
- Lever and trim made of 304 stainless steel
- Strike plate made of die-casting carbon steel with roller to reduce the friction of opening and closing

##### Latchbolt

- Made of sintering stainless steel

##### Finish

- 630 Satin Stainless Steel Types
- AA21R- Rim
- AA21V- Vertical
- AA21M-Mortise

##### Electric Function (For AA21M)

- Fail Safe (FSA)
- Fail Secure (FSE)
- 480mA@12VDC (Standard)
- 240mA@24VDC

##### Electric Function (For Electric Trim ELEC)

- Fail Safe (FSA)
- Fail Secure (FSE)
- 1200mA@12VDC (Standard)
- 600mA@24VDC



### Option

#### Option

- REX (Request to Exit)-An SPDT switch that monitors activation of the free lever (not available with knob trim). REX is available for all mechanical and electrified functions and can be supplied alone or with either LBM or DBM
- LBM (Latchbolt Monitor)-An SPDT switch that monitors full retraction of the main latch. LBM is available for all mechanical and electrified functions and can be supplied alone or with REX
- DBM (Deadbolt Monitor)-An SPDT switch that monitors full retraction of the deadbolt. DBM is available for all mechanical and electrified functions with a deadbolt and can be supplied alone or with REX

## ASSA ABLOY

Technical drawing of the 1000mm long handle (1000mm) showing side and end views with dimensions:









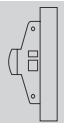
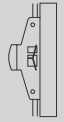

- Side View (Left):**
  - Total length: 1000mm (labeled as Length A).
  - Top width: 79.5mm.
  - Bottom width: 65.3mm.
- End View (Right):**
  - Width: 208mm.
  - Top width: 68mm.

Exit Device Size (inch)	Suitable Door Width (mm)	Length A (mm)
24"	510 - 600	530
30"	610 - 750	683
36"	760 - 910	835
48"	920 - 1200	1130

[illegible]

# ASSA ABLOY ANSI Exit Device

ASSA ABLOY

Function	ANSI Function No.	Model No.	Exit Device Type	Description	Inside Outside
Exit	01	AA21R01	Rim Type	<ul style="list-style-type: none"> <li>Exit only</li> <li>No outside operation</li> </ul>	
		AA21V01	Surface Vertical Type		
		AA21M01	Mortise		
Classroom	08	AA21R08	Rim Type	<ul style="list-style-type: none"> <li>Outside lever retracts latchbolt</li> <li>Key locks and unlocks lever</li> </ul>	
		AA21V08	Surface Vertical Type		
	05	AA21M05	Mortise	<ul style="list-style-type: none"> <li>Entrance by knob or lever</li> <li>Key locks and unlocks knobs or lever</li> </ul>	
Night Latch	03	AA21R03	Rim Type	<ul style="list-style-type: none"> <li>Entrance by Trim when latch is released by key</li> <li>Key removable only when locked</li> </ul>	
		AA21M03	Mortise		
		AA21EM-FSA	Electrified Mortise (Fail Safe)		
		AA21EM-FSE	Electrified Mortise (Fail Secure)		
Passage	14	AA21R14	Rim Type	<ul style="list-style-type: none"> <li>Entrance by Trim</li> <li>Exit by pushing bar inside</li> </ul>	
		AA21V14	Surface Vertical Type		
		AA21M14	Mortise		

## Remarks:

- Electric trims are option for mechanical panic exit device
- Supply cylinder is for door thickness 40-54mm

## Typical Door Installation

### Single Leaf Door

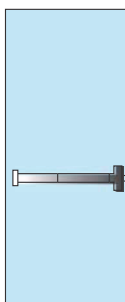

Rim device

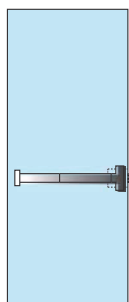

Rim device with mortise

### Double Leaf Door

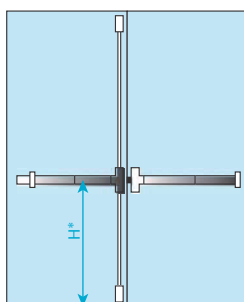

AA21R-D and AA21V  
Pair of rebated doors - 1  
vertical rod device, 1 Rim  
device and 1 double door  
strike - same direction

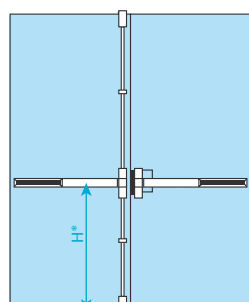

AA21M and AA21V  
Mortise lock and surface  
mounted vertical rod  
device combination -  
same direction

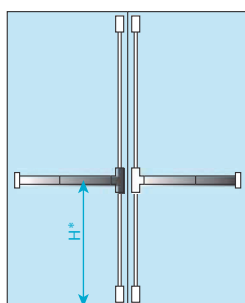

AA21V (2 sets)  
Pair of non-rebated doors  
with 2 vertical devices -  
same direction (do not  
use with overlapping  
astragal)

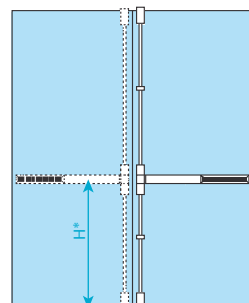

AA21V (2 sets)  
Two vertical rods - double  
egress

### Remarks

- H\* = centerline of chassis and rail
- assembly to finished floor 1014mm for standard application
- Device for door height 2100mm, but available up to 3000mm upon request



## How to order : PED

Model No.	Push Bar Length	Door Handing	Monitor (option)	Finish	Trim & Cylinder (Option)	
<b>Example: AA21R01</b>	<b>24</b>	<b>LHR</b>	<b>REX</b>	<b>630</b>	<b>Trim</b>	<b>Cylinder</b>
AA21R01						
AA21V01						
AA21M01						
AA21R08						
AA21V08						
AA21M05	24 24"	LHR	REX			
AA21R03	30 30"	(Left Hand	LBM	630	See 'How to	See 'How to
AA21M03		- Reverse)	DPS**	Satin Stain-	order: Trims	order: Trims
AA21EM-FSA	36 36"	RHR	ALA	less Steel	and cylinder'	and cylinder'
AA21EM-FSE	48 48"	(Right Hand				
AA21R14		- Reverse)				
AA21V14						
AA21M14						
AA21R-D*						

\* AA21R-D is AA21R device with double strike for double leaf door.

\*\* DPS is only for AA21EM

- Device for door height 2100mm, but available up to 300mm upon request.
- Device installed at centerline of chassis and rail assembly to finished floor 1014mm for standard application.

## How to order : Trims and Cylinder

Escutcheon	Lever	Cylinder (Option)	Finish
<b>Example: LEN</b>	<b>H01</b>		<b>630</b>
LEN for R and V (Passage function)	H01	CY32R*	
LEC – R for R and V (Classroom function)	H02	CY32Q	
LEC – M f or Mortise and Electrified Mortise	H03	CY32E	630 Satin Stainless Steel
ELEC – FSA E lectrical function (Fail Safe) for R and V	H04		
ELEC – FSE E lectrical function (Fail Secure) for R and V	H05	CY32T	

\*CY32R is rim cylinder for outside of rim and surface vertical exit device



# ASSA ABLOY ANSI Exit Device

ASSA ABLOY

## LEC-R

**Model No.:** LEC - R

- For AA21R, AA21V Classroom function
- ANSI Cylinder CY32Q
- Lever H01-H05

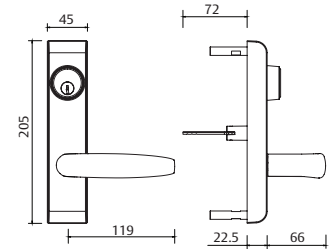

## LEC-M

**Model No.:** LEC - M

- For device with electrified Mortise
- ANSI Cylinder CY32E
- Lever H01-H05

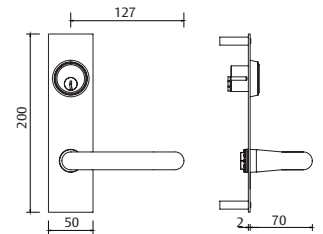

## LEN

**Model No.:** LEN

- For Passage function
- Lever H01-H05

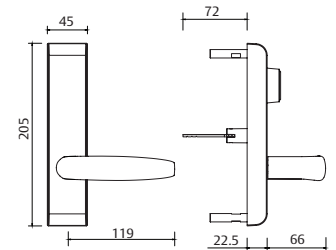

## ELEC-FSA

**Model No.:** ELEC-FSA

- For AA21R, AA21V desive with electrified Mortise (Fail Safe)
- ANSI Cylinder CY32T
- Lever H01-H05

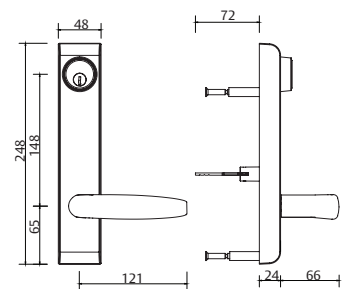

## ELEC-FSE

**Model No.:** ELEC-FSE

- For AA21R, AA21V desive with electrified Mortise (Fail Secure)
- ANSI Cylinder CY32T
- Lever H01-H05

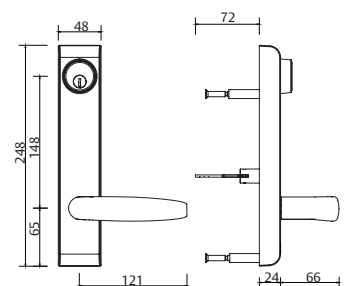

# ASSA ABLOY ANSI Exit Device

ASSA ABLOY

CY-32R

**Model No.:** CY32R - 630  
**Finish:** 630 Satin Stainless Steel  
**Trims:** LEN  
**Device:** Rim & Vertical Passage function

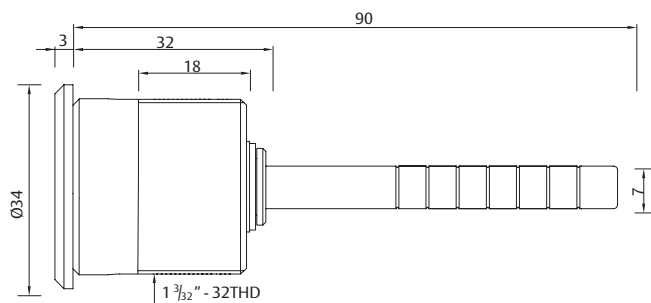

CYR-32Q

**Model No.:** CY32Q - 630  
**Finish:** 630 Satin Stainless Steel  
**Trims:** LEC-R  
**Device:** Rim & Vertical Classroom function

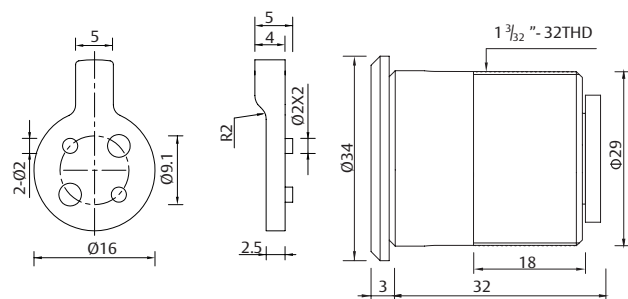

CY-32E

**Model No.:** CY32E - 630  
**Finish:** 630 Satin Stainless Steel  
**Trims:** LEC-M  
**Device:** Mortise and Electrified Mortise

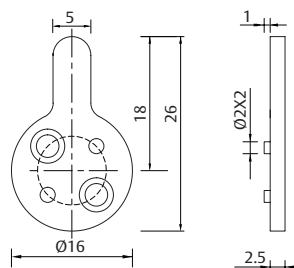

CYR-32T

**Model No.:** CY32T - 630  
**Finish:** 630 Satin Stainless Steel  
**Trims:** ELEC-FSA, ELEC-FSE  
**Device:** Rim & Vertical Electrical function (Fail Safe / Fail Secure)

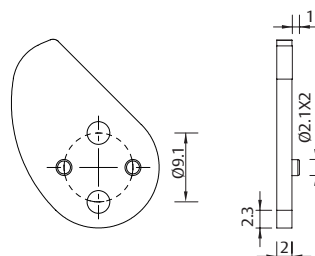

STRIKE

**Model No.:** Double Strike  
**Finish:** 630 Satin Stainless Steel  
**Device:** For AA21 R-D

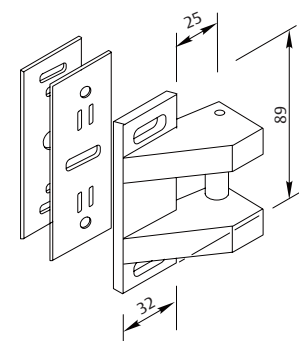

# ASSA ABLOY ANSI Exit Device

ASSA ABLOY

## Lever Design

H01

Model No. : H01

Material : 304 Stainless Steel

Construction : Hollow

Finish : 630 Satin Stainless Steel

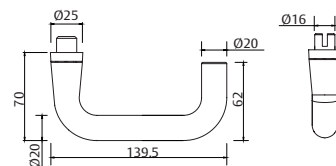

H02

Model No. : H02

Material : 304 Stainless Steel

Construction : Solid

Finish : 630 Satin Stainless Steel

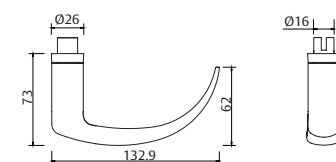

H03

Model No. : H03

Material : 304 Stainless Steel

Construction : Solid

Finish : 630 Satin Stainless Steel

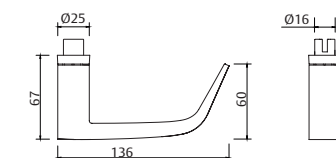

H04

Model No. : H04

Material : 304 Stainless Steel

Construction : Hollow

Finish : 630 Satin Stainless Steel

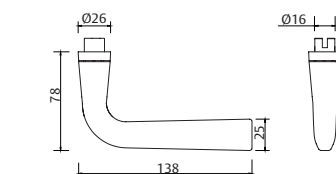

H05

Model No. : H05

Material : 304 Stainless Steel

Construction : Hollow

Finish : 630 Satin Stainless Steel

