

Introducing The new **UNION** cylinder range

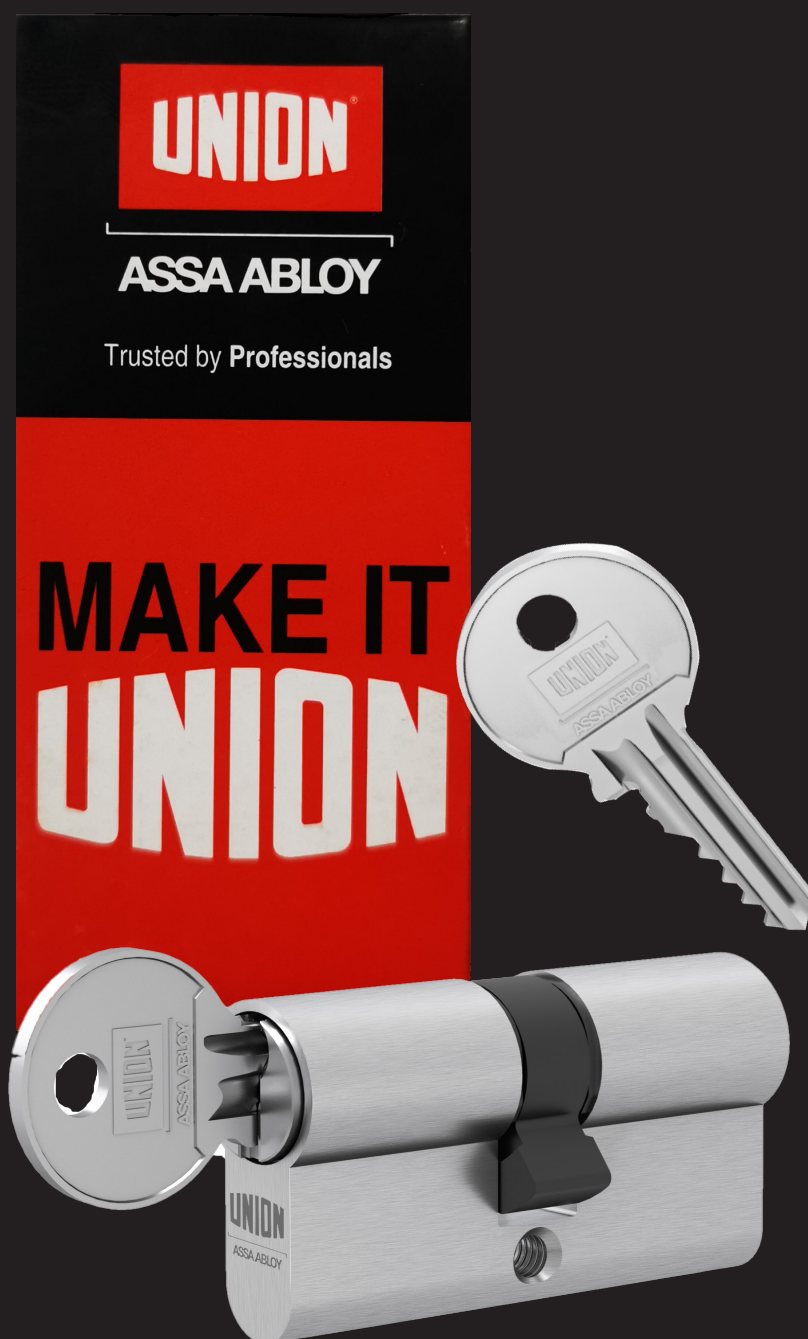

Cylinder for Commercial and Residential Applications

**New Patented Keyway for enhanced
security and peace of mind**

Specifications:

- For use on Euro profile cylinder locks
- Can be used on doors up to 54mm thick
- Available in:
 - 35mm (single)
 - 60mm and 65mm (Double & Thumbturn)
- Paracentric keyway sawn key
- Supplied with 3 steel keys
- Keyed to Differ
- Patented Keyway design until 2036
- Tested to EN1303:2015
- Tested to 300,000 cycles
- High corrosion resistance
- 5 pin cylinder
- Pick resistant
- Fire resistant



**XCY2X18
Double Cylinder**

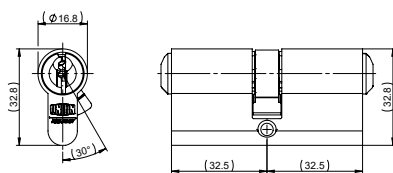

XCY2X18-60SNKD - Satin Nickel 60mm KD
 XCY2X18-60PLKD - Polished Brass 60mm KD
 XCY2X18-65SNKD - Satin Nickel 65mm KD
 XCY2X18-65PLKD - Polished Brass 65mm KD



**XCY2X19
Thumbturn Cylinder**

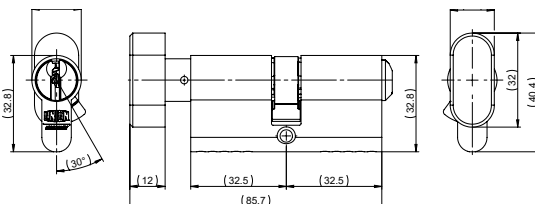

XCY2X19-60SNKD - Satin Nickel 60mm KD
 XCY2X19-60PLKD - Polished Brass 60mm KD
 XCY2X19-65SNKD - Satin Nickel 65mm KD
 XCY2X19-65PLKD - Polished Brass 65mm KD



**XCY2X20
Single Cylinder**

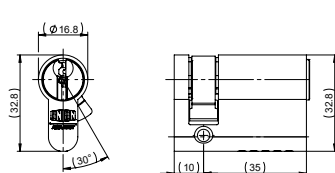

XCY2X20-35SNKD - Satin Nickel 35mm KD
 XCY2X20-35PLKD - Polished Brass 35mm KD



- 21,000 effective key differs
 - Key Blanks: R101 (XCY2X-BLANK-SS)
- *key blanks available in packs of 30*