

Panic Exit Device
PED 300
Push Bar - Rim Device

Description:

- Panic exit device with central locking point - RIM



Classification to EN1125: 2009

3 7 6 B 1 3 2 2 A A



Panic Exit Device
Characteristics of
PED 300

Characteristics:

- Modular push bar type
- For fire and smoke applications
- High durability 2,00,000 cycles
- One central locking point
- For one or double leaf door up to 200 kg
- For all types of door
- For doors up to 1200mm width in standard
- For doors up to 1400mm width in option
- Steel pulman latch in standard
- Dead latch in standard
- Steel or zinc alloy swing latch
- Zinc alloy cover 38mm width
- Aluminium touch bar 1046mm long
- Bar to be cut
- 73mm projection
- HO function in option
- Micro switch version in option

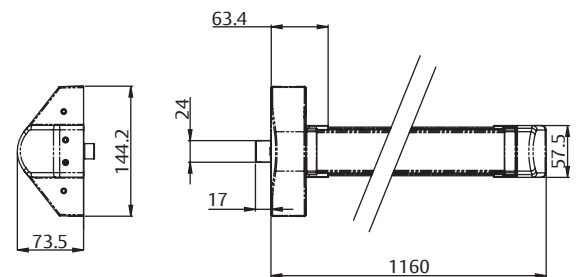

Ordering details

Model No.	Part no.	Type	Description
PED 300/--/GG	MNBT101M02SGGAA	Push bar	Central locking point PED with steel latch and dead latch, 1200mm wide door, silver support and bar
PED 300/--/NR	MNBT101M02SNRAA	Push bar	Central locking point PED with steel latch and dead latch, 1200mm wide door, black support and red bar
PED 300/--/SA	MNBT101M02SSAAA	Push bar	Central locking point PED with steel latch and dead latch, 1200mm wide door, s/steel effect support and s/steel effect bar
PED 300/HO/GG	MNBT111M02SGGAA	Push bar	Central locking point PED with steel latch and dead latch, 1200mm wide door, Silver support and bar - HO function
PED 300/HO/NR	MNBT111M02SNRAA	Push bar	Central locking point PED with steel latch and dead latch, 1200mm wide door, black support and red bar - HO function
PED 300/HO/SA	MNBT111M02SSAAA	Push bar	Central locking point PED with steel latch and dead latch, 1200mm wide door, s/steel effect support and s/steel bar - HO function

Panic Exit Trim Specifications

Outside Device	Blind Plate	Modular Lever Handle
No outside opening	•	
Free passing door		•
Cylinder looking - knob / lever handle opening		•
Cylinder locking - key opening		•