

Panic exit device Cross bar - Rim

Description::

- Panic exit device with central locking point - RIM



Classification to EN1125: 2009

3 7 6 B 1 3 2 2 A A



Panic Exit Device Characteristics of PED 200

Characteristics:

- Modular cross bar type
- For fire and smoke applications
- High durability 2,00,000 cycles
- One central locking point
- For one or double leaf door up to 200 kg
- For all types of door
- For doors up to 1200mm width in standard
- For doors up to 1400mm width in option
- Steel pulman latch in standard
- Dead latch in standard
- Zinc alloy or s/steel cover 38mm width
- Steel or s/steel bar 1075mm long
- Bar to be cut
- 97mm projection
- HO function in option
- Micro switch version in option

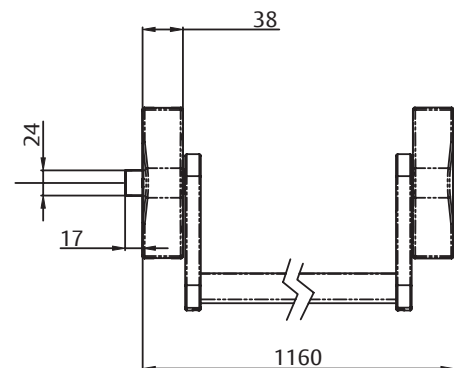
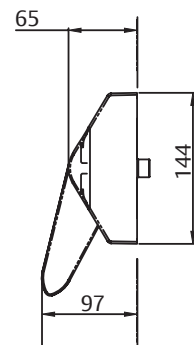

Ordering details

Model No.	Part no.	Description
PED 200/--/GG	MNAT101M02SGGAA	Central locking point PED with steel latch and dead latch, 1200mm wide door, silver support and bar
PED 200/--/NR	MNAT101M02SNRAA	Central locking point PED with steel latch and dead latch, 1200mm wide door, black support and red bar
PED 200/--/SI	MNAT101M02SSIAA	Central locking point PED with steel latch and dead latch, 1200mm wide door, s/steel effect support and s/steel bar
PED 200/--/II	MNAT101M02SIIAA	Central locking point PED with steel latch and dead latch, 1200mm wide door, s/steel support and bar
PED 200/HO/GG	MNAT111M02SGGAA	Central locking point PED with steel latch and dead latch, 1200mm wide door, silver support and bar - HO function
PED 200/HO/NR	MNAT111M02SNRAA	Central locking point PED with steel latch and dead latch, 1200mm wide door, black support and red bar - HO function
PED 200/HO/SI	MNAT111M02SSIAA	Central locking point PED with steel latch and dead latch, 1200mm wide door, s/steel effect support and s/steel bar - HO function
PED 200/HO/II	MNAT111M02SIIAA	Central locking point PED with steel latch and dead latch, 1200mm wide door, s/steel support and bar - HO function

Panic Exit Trim Specifications

Outside Device	Blind Plate	Modular Lever Handle
No outside opening	•	•
Free passing door		•
Cylinder locking - knob / lever handle opening		•